

10			
9			
8	INDICATOR	CARBON STEEL	1
7	LEVER	MALLEBLE IRON	1
6	O-RING	NBR	1
5	BUSHING	PTFE	4
4	SEAT	<input type="checkbox"/> NBR <input checked="" type="checkbox"/> EPDM	1
3	SHAFT	<input checked="" type="checkbox"/> SS410 <input type="checkbox"/> SS316 <input type="checkbox"/> SS304 <input type="checkbox"/> C954	1
2	DISC	<input checked="" type="checkbox"/> DI <input checked="" type="checkbox"/> CF8M <input type="checkbox"/> CF8	1
1	BODY	<input type="checkbox"/> CI <input checked="" type="checkbox"/> DI	1
NO.	PARTS NAME	MATERIAL	QTY

THE HYDROSTATIC TEST						
	PRESSURE (PSI)		DURATION TIME (S)			
	150	200	1.5"-2"	2.5"-6"	8"-12"	14"
SHELL	225	300	15	60	120	300
SEAL	165	220	15	60	120	120

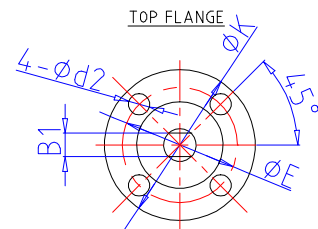

TOP FLANGE DIMENSIONS				
SIZE	ISO5211	ϕK	ϕE	4- $\phi d2$
1.5"-3"	F05	2.56	1.97	4-0.276
4"-6"	F07	3.54	2.76	4-0.39
8"-14"	F10	4.92	4.02	4-0.47

Unit: inch

MAIN DIMENSIONS											<input checked="" type="checkbox"/> 150LB		
DN	SIZE	A	B	C	D	$d0$	$d1$	B1	L	S	D1	N-M	$\&^\circ$
40	1.5"	4.72	2.75	1.34	1.65	0.496	0.496	0.35	1.02	8.66	3.88	4-1/2	90°
50	2"	6.33	3.16	1.65	2.08	0.496	0.496	0.35	1.02	8.66	4.75	4-5/8	90°
65	2.5"	6.88	3.52	1.75	2.53	0.496	0.496	0.35	1.02	8.66	5.49	4-5/8	90°
80	3"	7.12	3.75	1.77	3.10	0.496	0.496	0.35	1.02	8.66	6.00	4-5/8	90°
100	4"	7.87	4.5	2.05	4.10	0.62	0.74	0.50	1.10	10.24	7.50	8-5/8	45°
125	5"	8.38	5.01	2.14	4.86	0.74	0.74	0.50	1.10	10.24	8.50	8-3/4	45°
150	6"	8.89	5.48	2.19	6.13	0.74	0.74	0.50	1.10	10.24	9.50	8-3/4	45°
200	8"	10.23	6.89	2.38	7.97	0.87	1.24	0.94	1.50	13.98	11.75	8-3/4	45°
250	10"	11.49	7.99	2.58	9.87	1.12	1.24	0.94	1.50	13.98	14.25	12-7/8	30°
300	12"	13.26	9.38	3.03	11.87	1.24	1.24	0.94	1.50	19.88	17.0	12-7/8	30°

STANDARD:

- 1.DESIGN CODE : API609 Class A
- 2.FACE TO FACE : API609
- 3.END STANDARD : ANSI B16.5 125LB/150LB
- 4.INSPECTION & TEST: API 598

LEVER LUGGED BUTTERFLY VALVE