

PART NUMBER	A	B (± .03)	C (UNF)	D (NPTF)
10253	7/16"	0.92	5/16"-24	1/8"-27
10254	7/16"	1.00	3/8"-24	1/8"-27
10255L	7/16"	1.06	7/16"-20	1/8"-27
10255	7/16"	1.06	7/16"-20	1/8"-27
10256L	9/16"	1.10	7/16"-20	1/4"-18
10256	9/16"	1.25	7/16"-20	1/4"-18
10257	1 1/16"	1.31	7/16"-20	3/8"-18
10258	7/8"	1.44	7/16"-20	1/2"-14
10259L	1/2"	1.15	1/2"-20	1/8"-27
10259	1/2"	1.16	1/2"-20	1/8"-27
10260L	9/16"	1.31	1/2"-20	1/4"-18
10260	9/16"	1.34	1/2"-20	1/4"-18
10261	1 1/16"	1.38	1/2"-20	3/8"-18
10262	5/8"	1.25	5/8"-18	1/8"-27
10263L	5/8"	1.31	5/8"-18	1/4"-18
10263	5/8"	1.44	5/8"-18	1/4"-18
10264L	1 1/16"	1.37	5/8"-18	3/8"-18
10264	1 1/16"	1.44	5/8"-18	3/8"-18
10265L	1 3/16"	1.44	5/8"-18	1/2"-14
10265	7/8"	1.69	5/8"-18	1/2"-14

PART NUMBER	A	B (± .03)	C (UNF)	D (NPTF)
10266	1-1/16"	1.81	5/8"-18	3/4"-14
10267	3/4"	1.62	3/4"-16	1/4"-18
10268L	3/4"	1.46	3/4"-16	3/8"-18
10268	3/4"	1.62	3/4"-16	3/8"-18
10269L	7/8"	1.62	3/4"-16	1/2"-14
10269	7/8"	1.81	3/4"-16	1/2"-14
10270	1-1/16"	1.94	3/4"-16	3/4"-14
10271	7/8"	1.81	7/8"-14	1/4"-18
10272L	7/8"	1.63	7/8"-14	3/8"-18
10272	7/8"	1.81	7/8"-14	3/8"-18
10273L	7/8"	1.65	7/8"-14	1/2"-14
10273	7/8"	2.00	7/8"-14	1/2"-14
10274	1-1/16"	2.06	7/8"-14	3/4"-14
10275	1-1/16"	2.19	1-1/16"-14	1/2"-14
10276	1-1/16"	2.19	1-1/16"-14	3/4"-14
10277	1-1/4"	2.22	1-1/4"-12	1/2"-14
10278	1-1/4"	2.35	1-1/4"-12	3/4"-14
10279	1-7/16"	2.44	1-3/8"-12	3/4"-14
10280	1-7/16"	2.44	1-3/8"-12	1"-11-1/12

"This drawing contains proprietary and confidential information of Midland Metal Mfg., Co. and shall not be reproduced, copied, loaned, or submitted to outside parties for examination without our consent"

4			TOLERANCES ARE: DECIMALS. .X ± 0.03 .XX ± 0.01 .XXX ± 0.005 ANGLES: ± 1° FRACTIONS ± 1/8
3			
2		B (07/25/03) MIDLAND	
1		A (05/12/03)	
NO.	PCA	Date	Revision

Date:	07/25/03	UNIT:	
Drawn:	Rita Sue	Scale:	
Checked:		PROJECT	
Approved:			

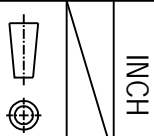

INCH

Material:	CA360 BRASS
-----------	-------------

Part Title:	MALE FLARE * MALE PIPE ADAPTER
-------------	--------------------------------

MIDLAND METAL MFG. CO.
KANSAS CITY, MO

DWG. NO.	
----------	--