

**A171.8-UG-SOC Series
BASE MODEL A171408F-UG-SOC**

BARRIER-FREE, CONCEALED SENSOR OPERATED,
WALL MOUNTED, ELECTRIC WATER COOLER WITH
SENSOR OPERATED BOTTLE FILLER OPTION

STANDARD FEATURES

Electric Water Cooler

- Lead Free
- Hands-Free Sensor with Easy Reach, Wave-on / Wave-off Operation
- Sensor with maximum run time of 10 seconds or less
- Child or Adult ADA Compliant (when properly installed)
- Apron, One-Piece Bottom Wrapper is Satin or Gray Powder Coat Finish
- Flexible, Low Flow, Antimicrobial, Anti-Rotation, Non-Squirt Bubbler
- Rough-Ins Match Other

Bottle Filler (Optional)

- Hands-Free Sensor Operation
- ADA Compliant
- 120VAC/9.0VDC Plug-In Transformer
- Laminar Flow Water Supply
- 1 GPM Fill Rate
- -BF12 Sensor Has a 20 Seconds Maximum Run Time
- 100-Mesh Inlet Strainer

SUGGESTED SPECIFICATIONS

Electric Water Cooler

Model A171108F-UG-SOC is a self-contained, Concealed Sensor Operated Water Cooler that delivers a minimum of **8.0 GPH** (30.3 LPH) of water at 50°F (10°C) cooled from 80°F (26.7°C) inlet water and 90°F (32.2°C) ambient. Unit shall be activated by a 9 Volt Infrared Sensor concealed beneath basin skirt for wave-on and wave-off operation. Bubbler shall deliver a 0.3 GPM flow with maximum run time of 10 seconds. Provide Antimicrobial Flexible Guard with an integrally designed non-squirt feature and operate on a water pressure range of 20-105 PSIG. Basin shall be constructed from 304 Stainless Steel and have an Integral Drain. Cabinet shall be either Galvanized or Galvannealed Steel with Gray Powder Coat Finish or Stainless Steel with Satin Finish. Cooling system shall use R-134a Refrigerant and be Capillary Tube regulated. Unit shall be listed by Underwriters Laboratories for both the US and Canada and is to be compliant to ANSI/ASHRAE 18. Unit shall be certified to Public Law 111-380 (NO-LEAD) and NSF/ANSI/CAN 61. Fixture meets ADA, ADA Standing Person, and ADA Child requirements when mounted appropriately. Unit shall still deliver ambient water temperature to the Bubbler in the absence of electrical power as long as there is a pressurized water supply.

Bottle Filler -Bf12 (Optional)

Bottle Filling unit shall include Sensor Operated activation with a 20 second maximum run time. LED Lights illuminate the Bottle Fill area and brighten when a bottle is detected. Optional -BCD (Bottle Counter Display) indicates the quantity of 16 oz disposable Plastic Bottles saved from a land fill and also displays the Water Filter status.

Bottle Filler housing construction will be 20 gauge Stainless Steel with a satin finish and will also include components manufactured from Antimicrobial, impact resistant ABS. Bottle Filler shall provide approximately 1 GPM flow rate with a Laminar Flow Spout to minimize splashing.

Complies with the following standards:



NSF/ANSI/CAN 61

ANSI/ASHRAE 18

H₂O
to go!



Model A171108F-UG-SOC-BF12-BCD Shown

PATENT# D873,606

“RATED FOR INDOOR USE ONLY”

Model Number	GPH*	Rated Watts	Full Load Amps	Approx. Shipping Weight
A171408F-UG-SOC-BF	8.0	335	4.1	100 lbs.

* GPH of 50°F water at 90°F ambient room temperature and 80°F inlet water temperature
Compressor motor operates on 115 Volt / 60 Hz single phase.

MODEL:

(Must Specify Water Cooler)

FLEXIBLE BUBBLER

- A171108F-UG-SOC Gray Finish Cooler
- A171408F-UG-SOC Satin Stainless Finish

STAINLESS STEEL BUBBLER

- A171108S-UG-SOC Gray Finish Cooler
- A171408S-UG-SOC Satin Stainless Finish

OPTIONS:

(Additional costs may apply.)

- LOGO Customer Specified Logo / Graphics
- 220V 220 Volt / 50 Hz or 60Hz Compressor

ACCESSORIES & BOTTLE FILLERS Satin Finish (only):

(Additional costs may apply. Accessory items are packaged separately.)

- BF12 Bottle Filler with Sensor Operation ¹
- BF12-BAT Bottle Filler with Battery Operated Sensor Operation ¹
- BF12-BCD Bottle Filler with Sensor Operation with Bottle Counter Display ¹
- WF1 1500-Gallon Capacity Water Filter ¹
- WF3 3000-Gallon Capacity Water Filter ¹

NOTES:

1 - Refer to Supplemental Submittal Sheet for Details.

Compatible Mounting Support Carrier

Jay R. Smith Mfg. Co. Figure # 0830 <https://www.JRSmith.com>

WARNING: Cancer and Reproductive Harm - www.P65Warnings.ca.gov

A171.8-UG-SOC-BF Series

BASE MODEL A171408F-UG-BF

**BARRIER FREE, CONCEALED SENSOR OPERATED,
WALL MOUNTED, ELECTRIC WATER COOLER WITH
SENSOR OPERATED BOTTLE FILLER OPTION**

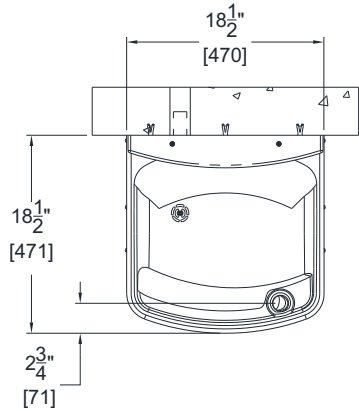

- A. 3/8" O.D. SUPPLY INLET
- B. WASTE OUTLET FOR P-TRAP BY OTHERS FOR PROVIDED 1-1/4" O.D. TAILPIECE
- C. ELECTRICAL SERVICE ROUGH
- D. Ø3/8" HANGER BRACKET PUNCHING, 6 PLACES FOR ANCHORING HARDWARE BY OTHERS
- E. Ø1/4" PUNCHING, 2 PLACES FOR ANCHORING HARDWARE BY OTHERS
- F. BOTTLE FILLER SENSOR
- G. DRINKING FOUNTAIN CONCEALED SENSOR
- H. 1-1/4" [32] O.D. TAILPIECE FOR P-TRAP BY OTHERS
- I. OPTIONAL -BCT BOTTLE COUNTER

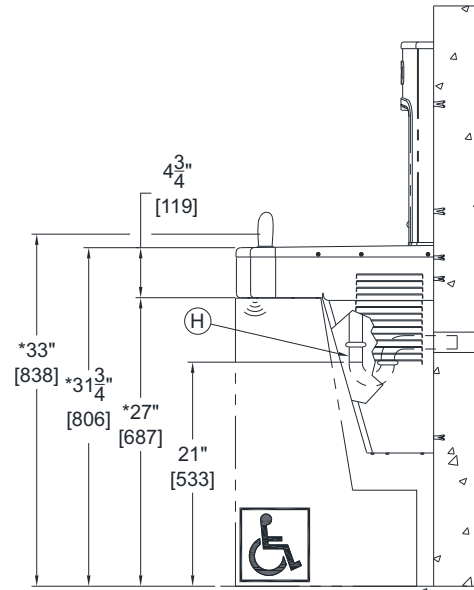
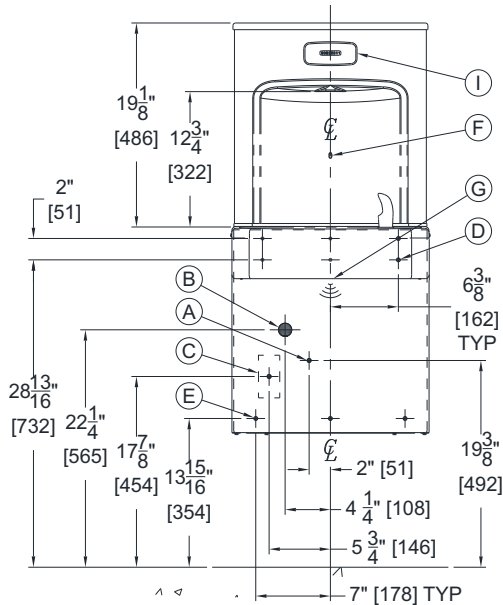

GENERAL NOTES:

1. ALL DIMENSIONS ARE IN INCHES [MM]
2. ALLOW 4 INCHES [102 MM] MINIMUM CLEARANCE PER SIDE FOR VENTILATION
- *3. DIMENSIONS SHOWN ARE FOR ADA ADULT HEIGHT. ADJUST VERTICAL DIMENSIONS AS NECESSARY TO COMPLY WITH FEDERAL, STATE, & LOCAL CODES
4. STOP VALVE, P-TRAP, & ELECTRICAL OUTLET NOT SUPPLIED
5. IMPORTANT: COOLERS MUST BE ATTACHED TO WALL WITH APPROPRIATE ANCHOR SCREWS

IMPORTANT: Dimensions are shown for reference only. Refer to product Installation Manual for complete details prior to Rough-in.

SELECTION SUMMARY & APPROVAL FOR MANUFACTURING

Model Number & Options _____ Quantity _____

Company _____

Contact _____ Title _____

Signature (Approval for Manufacturing) _____ Date _____

All dimensions are subject to manufactures tolerance of plus or minus 1/2" nominal and subject to change without notice. Murdock assumes no responsibility for use of void or superseded data. Dimensions may change with the addition of optional accessories. Murdock Mfg.™, Member of Morris Group International™. Please visit www.murdockmfg.com for most current specifications.