



LD QQPT_X

LARGE DIAMETER Qick Sert CR® BARB X BARB X BARB TEE

SPECIFICATION SHEET

TAG _____

Dimensional Data (inches and [mm]) are Subject to Manufacturing Tolerances and Change Without Notice

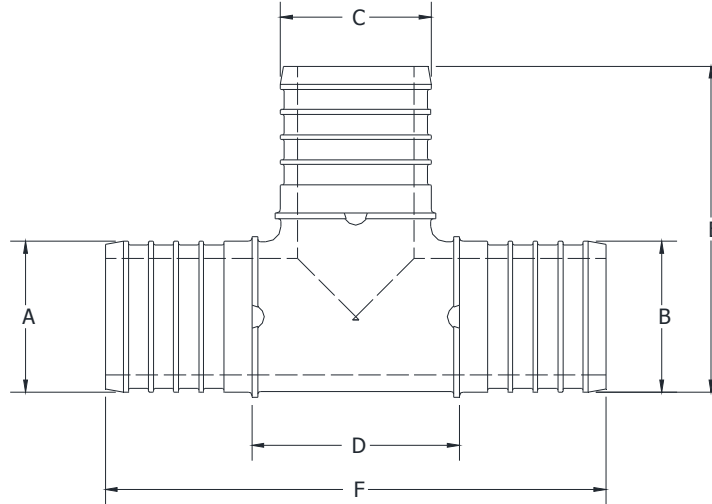

Part Number	Description	A	B	C	D	E	F
		in [mm]	in [mm]	in [mm]	in [mm]	in [mm]	in [mm]
QQPT664X	1-1/4 [32] barb x 1-1/4 [32] barb x 3/4 [19] barb tee	1.045 [26.5]	1.045 [26.5]	0.668 [17.0]	1.500 [38.1]	1.973 [50.1]	3.900 [99.1]
QQPT665X	1-1/4 [32] barb x 1-1/4 [32] barb x 1 [25] barb tee	1.045 [26.5]	1.045 [26.5]	0.856 [21.7]	1.500 [38.1]	2.123 [53.9]	3.900 [99.1]
QQPT666X	1-1/4 [32] barb x 1-1/4 [32] barb x 1-1/4 [32] barb tee	1.045 [26.5]	1.045 [26.5]	1.045 [26.5]	1.500 [38.1]	2.473 [62.8]	3.900 [99.1]
QQPT774X	1-1/2 [38] barb x 1-1/2 [38] barb x 3/4 [19] barb tee	1.233 [31.3]	1.233 [31.3]	0.668 [17.0]	1.004 [25.5]	2.167 [55.0]	3.400 [86.4]
QQPT775X	1-1/2 [38] barb x 1-1/2 [38] barb x 1 [25] barb tee	1.233 [31.3]	1.233 [31.3]	0.856 [21.7]	1.256 [31.9]	2.317 [58.9]	3.660 [93.0]
QQPT777X	1-1/2 [38] barb x 1-1/2 [38] barb x 1-1/2 [38] barb tee	1.233 [31.3]	1.233 [31.3]	1.233 [31.3]	1.700 [43.2]	2.667 [67.7]	4.100 [104.1]
QQPT884X	2 [51] barb x 2 [51] barb x 3/4 [19] barb tee	1.602 [40.7]	1.602 [40.7]	0.668 [17.0]	1.004 [25.5]	2.601 [66.1]	4.004 [101.7]
QQPT885X	2 [51] barb x 2 [51] barb x 1 [25] barb tee	1.602 [40.7]	1.602 [40.7]	0.856 [21.7]	1.256 [31.9]	2.751 [69.9]	4.255 [108.1]
QQPT888X	2 [51] barb x 2 [51] barb x 2 [51] barb tee	1.602 [40.7]	1.602 [40.7]	1.602 [40.7]	2.200 [55.9]	3.401 [86.4]	5.200 [132.1]

Engineering Specification: Zurn PEX® Qick Sert CR® tee.

The QQPT__X tee is used to branch off a main line or change direction. Molded from Radel®. These fittings, as a system with Zurn PEX tube are pressure rated at 160 PSI [1103 kPa] at 73.3°F [22.9°C], 100 PSI [689 kPa] at 180°F [82.2°C], and 80 PSI [552 kPa] at 200°F [93.3°C]. These fittings are listed by NSF as complying with the following standards: NSF/ANSI Standard 14, NSF/ANSI Standard 61, NSF/ANSI Standard 372, ASTM F877 and CSA B137.5.

Accessories

___	QCR4X	3/4 [19] Copper Crimp Ring
___	QCR5X	1 [25] Copper Crimp Ring
___	QCR6X	1-1/4 [32] Copper Crimp Ring
___	QCR7X	1-1/2 [38] Copper Crimp Ring
___	QCR8X	2 [51] Copper Crimp Ring
___	QCR4XPC	3/4 [19] QickCap® Copper Ring w/ Positioning Cap
___	QCR5XPC	1 [25] QickCap® Copper Ring w/ Positioning Cap
___	QCR6XPC	1-1/4 [32] QickCap® Copper Ring w/ Positioning Cap
___	QCR7XPC	1-1/2 [38] QickCap® Copper Ring w/ Positioning Cap
___	QCR8XPC	2 [51] QickCap® Copper Ring w/ Positioning Cap
___	QGA678CR	Go-Go Gauge for Large Diameter CR Fittings
___	QCRTLDM	Large Diameter Compact Crimp Tool
___	QCRBKIT56-14	14V Battery-Powered Crimp Tool Kit (1 [25], 1-1/4 [32])
___	QBJ6	1-1/4 [32] Crimp Head
___	QBJ7	1-1/2 [38] Crimp Head
___	QBJ8	2 [51] Crimp Head

* Regularly furnished unless otherwise specified.