



QEPC_X
CR POLYMER EXPANSION COUPLING

SPECIFICATION SHEET

TAG _____

Dimensional Data (inches and [mm]) are Subject to Manufacturing Tolerances and Change Without Notice

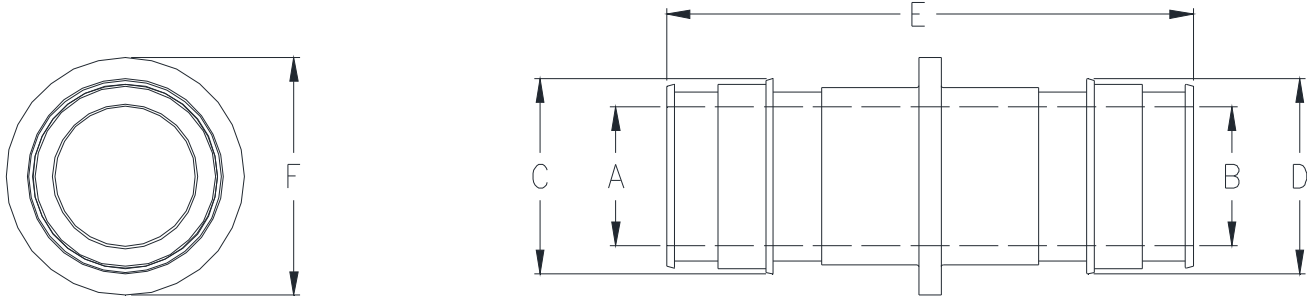

Part Number	CR Expansion Coupling size	Dimensions in Inches [mm]					
		A	B	C	D	E	F
QEPC33X	1/2" PEX x 1/2" PEX	0.39 [10]	0.39 [10]	0.61 [16]	0.61 [16]	1.58 [40]	0.87 [22]
QEPC43X	3/4" PEX x 1/2" PEX	0.59 [15]	0.39 [10]	0.87 [22]	0.61 [16]	1.81 [46]	1.18 [30]
QEPC44X	3/4" PEX x 3/4" PEX	0.59 [15]	0.59 [15]	0.87 [22]	0.87 [22]	2.05 [52]	1.18 [30]
QEPC54X	1" PEX x 3/4" PEX	0.79 [20]	0.59 [15]	1.11 [28]	0.87 [22]	2.34 [59]	1.50 [38]
QEPC55X	1" PEX x 1" PEX	0.79 [20]	0.79 [20]	1.11 [28]	1.11 [28]	2.58 [66]	1.50 [38]
QEPC64X	1-1/4" PEX x 3/4" PEX	0.97 [25]	0.59 [15]	1.36 [34]	0.87 [22]	2.61 [66]	1.70 [43]
QEPC65X	1-1/4" PEX x 1" PEX	0.97 [25]	0.79 [20]	1.36 [34]	1.11 [28]	2.84 [72]	1.70 [43]
QEPC66X	1-1/4" PEX x 1-1/4" PEX	0.97 [25]	0.97 [25]	1.36 [34]	1.36 [34]	3.11 [79]	1.70 [43]
QEPC74X	1-1/2" PEX x 3/4" PEX	1.08 [28]	0.59 [15]	1.49 [38]	0.87 [22]	2.87 [73]	1.81 [46]
QEPC75X	1-1/2" PEX x 1" PEX	1.08 [28]	0.79 [20]	1.49 [38]	1.11 [28]	3.10 [79]	1.81 [46]
QEPC76X	1-1/2" PEX x 1-1/4" PEX	1.08 [28]	0.97 [25]	1.49 [38]	1.36 [34]	3.37 [86]	1.81 [46]
QEPC77X	1-1/2" PEX x 1-1/2" PEX	1.08 [28]	1.08 [28]	1.49 [38]	1.49 [38]	3.63 [92]	1.81 [46]
QEPC87X	2" PEX x 1-1/2" PEX	1.48 [38]	1.08 [28]	2.08 [53]	1.49 [38]	4.03 [104]	2.76 [70]
QEPC88X	2" PEX x 2" PEX	1.48 [38]	1.48 [38]	2.08 [53]	2.08 [53]	4.55 [116]	2.52 [64]

Engineering Specification: Zurn PEX® CR® Polymer Expansion coupling

The QEPC_X is used to connect Zurn Non-Barrier PEX tubing together in potable water applications. Molded from Polyphenylsulfone (PPSU), these fittings, as a system with Zurn PEX® tube and Zurn PEX reinforcing rings are pressure rated at 160 PSI at 73°F, 100 PSI at 180°F, and 80 PSI at 200°F. These fittings are 3rd party certified as complying with the following standards: NSF/ANSI Standard 14, NSF/ANSI Standard 61, NSF/ANSI Standard 372 (Low Lead), ASTM F1960, CSA B137.5.

Accessories

- ___ QER3X 1/2" PEX Expansion Ring
- ___ QER4X 3/4" PEX Expansion Ring
- ___ QER5X 1" PEX Expansion Ring
- ___ QER6X 1-1/4" PEX Expansion Ring
- ___ QER7X 1-1/2" PEX Expansion Ring
- ___ QER8X 2" PEX Expansion Ring
- ___ QEMT345 F1960 Manual Expansion Tool Kit - 1/2" to 1"

* Regularly furnished unless otherwise specified.