



**DIMENSIONAL CATALOG**

# **DWV - PVC**

PVC Drain, Waste & Vent Fittings

# DWV - PVC

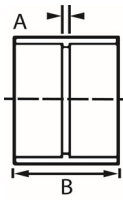

## COUPLING

Part Number	Size	A	B
D100-012	1½	3/32	1 17/32
D100-015	1½	1/8	1 17/32
D100-020	2	1/8	1 5/8
D100-030	3	7/32	3 7/32
D100-040	4	3/32	3 25/32
D100-060	6	1/4	6 9/32
D100-080	8	5/16	9 5/16
D100-100	10	5/16	10 11/32
D100-120	12	5/16	12 3/8

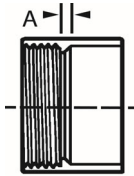

## FEMALE ADAPTER

Part Number	Size	A
D101-012	1½	1/8
D101-015	1½	1/4
D101-020	2	1/4
D101-030	3	11/32
D101-040	4	1/8
D101-060	6	5/16

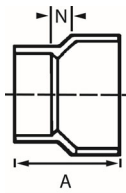

## PIPE INCREASER - REDUCER

Part Number	Size	A	N
D102-251	2 x 1½	2 5/32	9/16
D102-337	3 x 1½	3 11/32	1
D102-338	3 x 2	3 5/32	3/4
D102-420	4 x 2	3 7/8	1 1/4
D102-422	4 x 3	4 9/32	15/16
D102-532	6 x 4	6 19/32	1 1/8
D102-582	8 x 4	8 15/16	2 13/32
D102-585	8 x 6	9	1
D102-626	10 x 6	10 25/32	2 23/32
D102-628	10 x 8	10 25/32	1 3/4
D102-668	12 x 8	12 27/32	2 23/32
D102-670	12 x 10	13	1 15/16

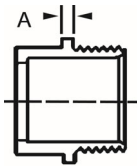

## TRAP ADAPTER, MALE

Part Number	Size	A
D103-015	1½	5/32
D103-020	2	7/32
D103-212	1½ x 1¼	3/16

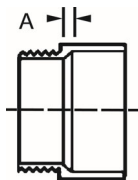

## MALE ADAPTER

Part Number	Size	A
D109-012	1½	7/32
D109-015	1½	7/32
D109-020	2	3/16
D109-030	3	3/8
D109-040	4	7/16
D109-212	1½ x ¼	1/4

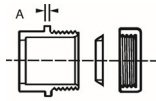

TRAP ADAPTER, MALE		
Part Number	Size	A
D113-012	1¼	3/16
D113-015	1½	5/32
D113-020	2	3/16
D113-212	1½ x 1¼	3/16

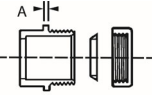

TRAP ADAPTER, MALE		
Part Number	Size	A
D115-015	1½	3/16
D115-020	2	3/16
D115-212	1½ x 1¼	3/16

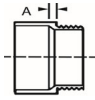

TRAP ADAPTER, FEMALE		
Part Number	Size	A
D114-015	1½	1/4
D114-020	2	5/32
D114-212	1½ x 1¼	1/4

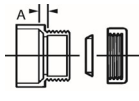

TRAP ADAPTER, FEMALE		
Part Number	Size	A
D104-012	1¼	1/8
D104-015	1½	1/8
D104-020	2	1/8
D104-212	1½ x 1¼	7/32

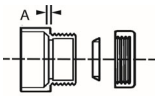

TRAP ADAPTER, FEMALE		
Part Number	Size	A
D116-015	1½	7/32
D116-020	2	5/32
D116-212	1½ x 1¼	7/32

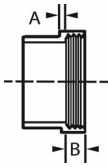

FITTING CLEANOUT ADAPTER			
Part Number	Size	A	B
D105-012	1¼	5/32	1/2
D105-015	1½	3/16	3/4
D105-020	2	3/16	3/4
D105-030	3	3/16	1 7/32
D105-040	4	9/32	1
D105-060	6	11/32	1 1/2

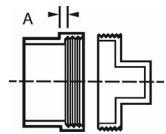

FITTING CLEANOUT ADAPTER + C.O. PLUG		
Part Number	Size	A
D112-012	1¼	5/32
D112-015	1½	3/16
D112-020	2	3/16
D112-030	3	3/16
D112-040	4	9/32
D112-060	6	5/16

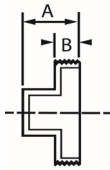

**CLEANOUT PLUG, RAISED NUT**

Part Number	Size	A	B
D106-012	1½	1	17/32
D106-015	1½	1 3/8	5/8
D106-020	2	1 3/8	5/8
D106-030	3	1 23/32	3/4
D106-040	4	1 27/32	7/8
D106-060	6	2	1
D106-080	8	2 9/32	1 3/8

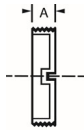

**CLEANOUT PLUG, FLUSH**

Part Number	Size	A	Diameter
D110-020	2	11/16	2 3/16
D110-030	3	7/8	3 9/32
D110-040	4	29/32	4 5/16



**FLUSH BUSHING**

Part Number	Size	C
D107-212	1½ x 1¼	3/16
D107-250	2 x 1¼	13/32
D107-251	2 x 1½	13/32
D107-337	3 x 1½	1 1/16
D107-338	3 x 2	31/32
D107-420	4 x 2	1 9/32
D107-422	4 x 3	15/32
D107-532	6 x 4	1 3/4
D107-582	8 x 4	3 1/4
D107-585	8 x 6	1 11/16
D107-623*	10 x 3	4 3/8
D107-624*	10 x 4	4
D107-626	10 x 6	2 3/8
D107-628	10 x 8	1 13/32
D107-661*	12 x 3	5 13/16
D107-664*	12 x 4	5 5/8
D107-666*	12 x 6	4 1/8
D107-668	12 x 8	2 1/2
D107-670	12 x 10	1 7/16

\*Assembled with two molded components

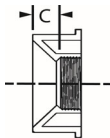

**FLUSH BUSHING**

Part Number	Size	C
D108-251	2 x 1½	5/32

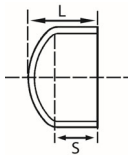

**CAP**

Part Number	Size	L	S
447-015	1½	2	1 5/16
447-020	2	2 3/16	1 3/8
447-030	3	3 5/32	2 1/16
447-040	4	3 15/32	2 1/8
447-060	6	5 1/4	3 1/2
447-080	8	6 3/4	4 5/32
D116-100	10	8 1/4	5 1/4
D116-120	12	9 3/4	6 5/16

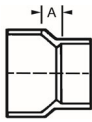

**ADAPTER COUPLING**

Part Number	Size	A
D117-040*	4	5/16
D117-422	4 x 3	3/4

\*Assembled from two molded components

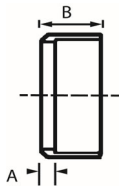

**ADAPTER BUSHING**

Part Number	Size	A	B
D118-030	3	7/32	1 23/32
D118-040	4	7/32	2

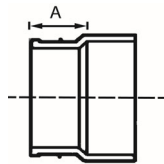

**NO - HUB ADAPTER**

Part Number	Size	A
D119-020	2	1 23/32
D119-030	3	2
D119-040	4	2

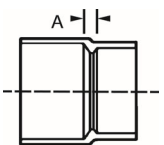

**HUB ADAPTER, CAST IRON SOIL PIPE**

Part Number	Size	A
D122-020	2	3/8
D122-030	3	3/8
D122-040	4	15/32

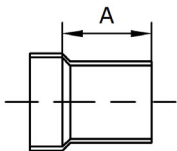

**HUB ADAPTER, CAST IRON SOIL PIPE**

Part Number	Size	A
D123-020	2	3 25/32
D123-030	3	4 5/32
D123-040	4	4 3/8

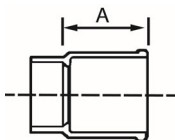

**HUB ADAPTER, CAST IRON SOIL PIPE INCREASE**

Part Number	Size	A
D123-251	2 x 1½	3 15/32
D123-341	3 x 4	4

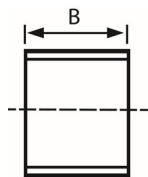

**REPAIR COUPLING**

Part Number	Size	B
D130-015	1½	1 21/32
D130-020	2	1 31/32
D130-030	3	3 1/4
D130-040	4	3 25/32

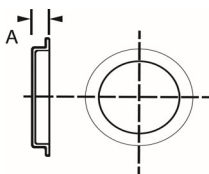

**TEST CAP, INSERT TYPE**

Part Number	Size	A
D131-015	1½	11/32
D131-020	2	11/32
D131-030	3	3/8
D131-040	4	7/16

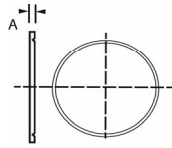

TEST CAP, PIPE		
Part Number	Size	A
D132-015	1½	3/32
D132-020	2	3/32
D132-030	3	1/16
D132-040	4	1/8

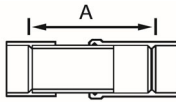

EXPANSION JOINT		
Part Number	Size	A
D133-015*	1½	5 19/32
D133-020*	2	6 1/4
D133-030*	3	7
D133-040*	4	8

\*\*\*Install in neutral position. Fitting has 1" inch travel in each direction\*\*\*

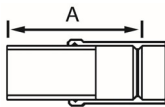

EXPANSION JOINT		
Part Number	Size	A
D134-015	1½	4 13/32
D134-020	2	5 1/8
D134-030	3	5 5/8
D134-040	4	6 13/16

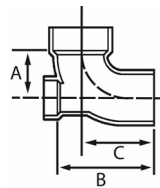

1/4 BEND, STREET w/LOW HEEL INLET				
Part Number	Size	A	B	C
D293-338	3 x 2	2 31/32	6 3/16	4 13/16

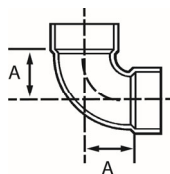

1/4 BEND		
Part Number	Size	A
D300-012	1¼	1 1/2
D300-015	1½	1 23/32
D300-020	2	2 5/16
D300-030	3	3 1/32
D300-040	4	4
D300-060	6	5 5/8
D300-080	8	6 1/16
D300-100	10	11
D300-120	12	12 7/32

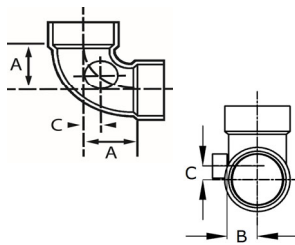

1/4 BEND, w/SIDE INLET				
Part Number	Size	A	B	C
D301-337	3 x 1½	3 1/32	1 21/32	1
D301-338	3 x 2	3 1/32	1 21/32	1

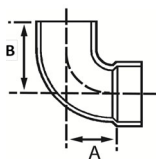

1/4 BEND, STREET				
Part Number	Size	A	B	
D302-012	1¼	1 19/32	2 1/4	
D302-015	1½	1 5/32	2 1/8	
D302-020	2	2 1/32	2 17/32	
D302-030	3	3 1/16	4 5/8	
D302-040	4	3 7/8	5 11/16	
D302-060	6	5 5/8	8 7/8	
D302-080	8	6 3/32	10 1/16	

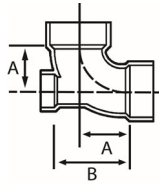

#### 1/4 BEND, w/LOW HEEL INLET

Part Number	Size	A	B
D303-337*	3 x 1½	2 15/16	4 25/32
D303-338	3 x 2	2 15/16	4 1/2
D303-420	4 x 2	3 7/8	5 7/16

\*Assembled from two molded components

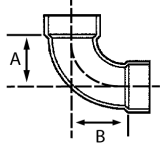

#### LONG SWEEP 1/4 BEND

Part Number	Size	A
D304-015	1½	2 11/16
D304-020	2	3 7/32
D304-030	3	4 3/32
D304-040	4	4 15/16
D304-060	6	7 8/89

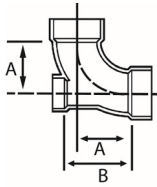

#### LONG SWEEP 1/4 BEND w/LOW HEEL INLET

Part Number	Size	A	B
D307-338	3 x 2	4	4 15/16

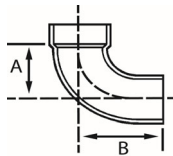

#### LONG SWEEP 1/4 BEND, STREET

Part Number	Size	A	B
D309-015	1½	2 3/4	3 7/16
D309-020	2	3 1/4	4 1/8
D309-030	3	4	5 19/32
D309-040	4	5	6 23/32

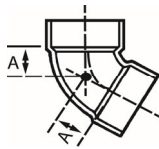

#### 1/6 BEND

Part Number	Size	A
D319-015	1½	15/16
D319-020	2	1 11/32
D319-030	3	1 21/32
D319-040	4	2 1/8

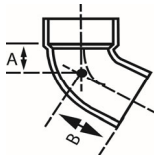

#### 1/6 BEND, STREET

Part Number	Size	A	B
D320-015	1½	1	1 23/32
D320-020	2	1 5/16	2 3/16
D320-030	3	1 11/16	3 3/16
D320-040	4	2 1/16	3 13/16

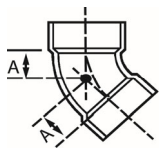

#### 1/8 BEND

Part Number	Size	A
D321-015	1½	1 1/8
D321-020	2	1 1/2
D321-030	3	1 23/32
D321-040	4	2 7/32
D321-060	6	2 1/16
D321-080	8	2 1/16
D321-100	10	3 1/8
D321-120	12	3 1/2

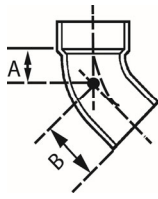

### 1/8 BEND, STREET

Part Number	Size	A	B
D323-015	1½	1 1/8	1 15/16
D323-020	2	1 1/2	2 3/8
D323-030	3	1 27/32	3 3/8
D323-040	4	2 3/16	3 15/16
D323-060	6	2	5 3/8
D323-080	8	2 1/16	6 9/32
D323-100	10	3 3/32	8 3/32
D323-120	12	3 15/32	9 17/32

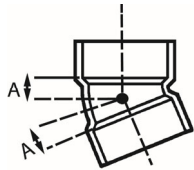

### 1/16 BEND

Part Number	Size	A
D324-015	1½	9/16
D324-020	2	11/16
D324-030	3	29/32
D324-040	4	1
D324-060	6	1 17/32
D324-100	10	1 13/16
D324-120	12	1 25/32

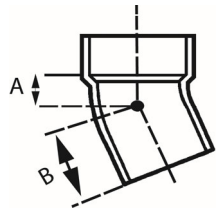

### 1/16 BEND, STREET

Part Number	Size	A	B
D326-015	1½	9/16	1 5/16
D326-020	2	11/16	1 7/16
D326-030	3	27/32	2 3/8
D326-040	4	1	2 3/4
D326-060	6	1 19/32	4 9/16

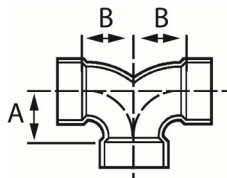

### DOUBLE 1/4 BEND

Part Number	Size	A	B
D327-015	1½	1 23/32	1 11/16
D327-020	2	2 5/16	1 9/32
D327-030	3	3 3/32	3
D327-241	2 x 1½	1 15/16	2 3/32

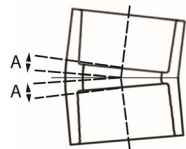

### 1/32 BEND

Part Number	Size	A
D328-100	10	1 1/32
D328-120	12	1 9/16

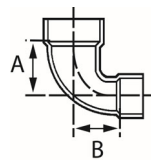

### CLOSET BEND, REDUCING

Part Number	Size	A	B
D329-422	4 x 3	3 1/16	3 5/16

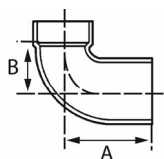

### CLOSET BEND, REDUCING

Part Number	Size	A	B
D330-341	3 x 4	6 1/16	3 11/32



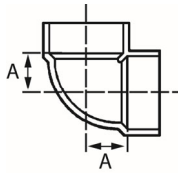

VENT ELL		
Part Number	Size	A
D331-015	1½	1 1/8
D331-020	2	1 15/32
D331-030	3	1 13/16
D331-040	4	2 5/16
D331-060	6	3 15/32
D331-080	8	4 1/2
D331-100	10	6 5/32
D331-120	12	7 3/16

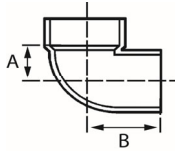

VENT ELL, STREET			
Part Number	Size	A	B
D333-015	1½	1 1/8	1 7/8
D333-020	2	1 15/32	2 3/8
D333-030	3	2 1/8	3 3/4
D333-040	4	2 21/32	5 1/16
D333-060	6	3 3/4	7
D333-080*	8	4 27/32	9 1/16
D333-100*	10	6 5/32	11 1/4
D333-120	12	7 1/16	13 11/32

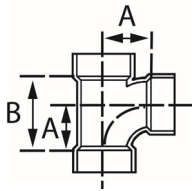

SANITARY TEE			
Part Number	Size	A	B
D400-012	1¼	1 9/16	2 5/16
D400-015	1½	1 11/16	2 11/16
D400-020	2	2 9/32	3 3/4
D400-030	3	3 1/8	4 7/8
D400-040	4	3 29/32	6 5/32
D400-060	6	5 13/32	9
D400-080	8	6	10 1/2

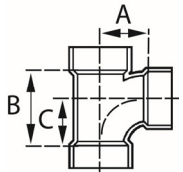

SANITARY TEE, REDUCING				
Part Number	Size	A	B	C
D401-241	2 x 1½ x 1½	2 5/32	3 5/32	1 29/32
D401-242	2 x 1½ x 2	2 9/32	3 23/32	2 11/32
D401-251	2 x 2 x 1½	2 5/32	3 1/8	1 15/16
D401-337	3 x 3 x 1½	2 1/2	2 21/32	1 23/32
D401-338	3 x 3 x 2	2 27/32	3 11/32	2 5/32
D401-420	4 x 4 x 2	3 1/4	3 7/32	2 1/8
D401-422	4 x 4 x 3	3 17/32	4 3/4	3 1/32
D401-532	6 x 6 x 4	4 3/4	6	3 11/16
D401-628*	10 x 10 x 8	6 11/32	10 3/8	5 3/16

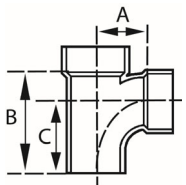

SANITARY TEE, STREET				
Part Number	Size	A	B	C
D403-015	1½	1 11/16	3 13/32	2 7/16
D403-020	2	2 11/32	4 7/16	2 5/16
D403-030	3	3 1/16	6 13/32	4 21/32
D403-040	4	3 13/16	8	5 27/32

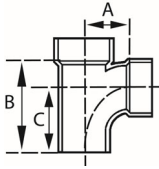

**SANITARY TEE, STREET REDUCING**

Part Number	Size	A	B	C
D404-241	2 x 1½ x 1½	2 1/8	4 5/32	2 27/32
D404-242	2 x 1½ x 2	2 11/32	4 1/2	3
D404-251	2 x 2 x 1½	2 1/8	4	2 27/32
D404-337	3 x 3 x 1½	2 1/2	4 1/8	3 9/32
D404-338	3 x 3 x 2	2 13/16	4 7/8	3 11/16
D404-420	4 x 4 x 2	3 9/32	4 29/32	3 25/32

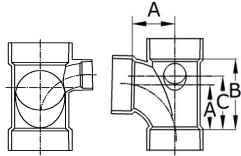

**SANITARY TEE w/LEFT SIDE INLET**

Part Number	Size	A	B	C
D416-337*	3 x 1½	3 1/16	4 27/32	3 11/16
D416-338	3 x 2	3 1/16	4 27/32	3 11/16
D416-420	4 x 2	3 29/32	6 1/8	5

\*Assembled from two molded parts

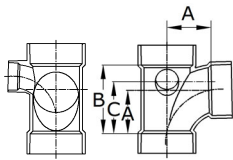

**SANITARY TEE w/RIGHT SIDE INLET**

Part Number	Size	A	B	C
D417-337*	3 x 1½	3	4 27/32	3 21/32
D417-338	3 x 2	3	4 27/32	3 11/16
D417-420	4 x 2	3 7/8	6 1/8	5

\*Assembled from two molded parts

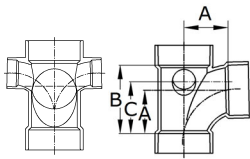

**SANITARY TEE w/R & L SIDE INLET**

Part Number	Size	A	B	C
D418-337	3 x 1½	3	4 25/32	3 23/32
D418-338	3 x 2	3	4 27/32	3 11/16
D418-420	4 x 2	3 7/8	6 1/8	5

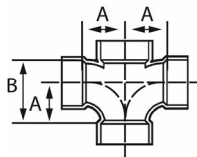

**DOUBLE SANITARY TEE**

Part Number	Size	A	B
D428-015	1½	1 3/4	2 3/4
D428-020	2	2 5/16	3 5/8
D428-030	3	3 3/32	4 7/8
D428-040	4	3 7/8	6 1/8

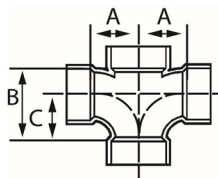

**DOUBLE SANITARY TEE, REDUCING**

Part Number	Size	A	B	C
D429-252	2 x 1½	2 1/8	3 5/32	2
D429-337	3 x 1½	2 1/2	2 25/32	2
D429-338	3 x 2	2 27/32	3 9/32	2 3/16
D429-420	4 x 2	3 7/32	3 1/8	2
D429-422	4 x 3	3	4 21/32	3

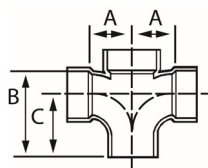

**DOUBLE SANITARY TEE, STREET**

Part Number	Size	A	B	C
D431-030	3	3 1/16	6 3/8	4 9/16
D431-251	2 x 1½	2 7/32	3 31/32	2 25/32
D431-338	3 x 3 x 2 x 2	2 25/32	4 11/16	3 19/32

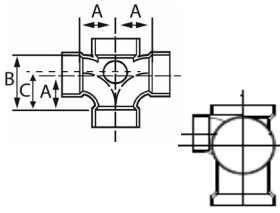

#### DOUBLE SANITARY TEE, w/SIDE INLET

Part Number	Size	A	B	C
D438-337	3x1½	3 3/32	4 27/32	3 21/32
D438-338	3 x 2	3 3/32	4 27/32	3 11/16
D438-420	4 x 2	3 7/8	6 3/32	4 31/32

\*Assembled from two molded parts

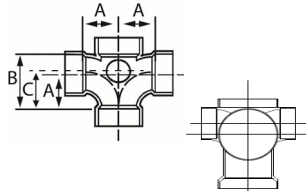

#### DOUBLE SANITARY TEE, w/R & L SIDE INLET

Part Number	Size	A	B	C
D439-337*	3x1½	3 1/32	3 29/32	3 11/16
D439-338	3 x 2	3 1/16	4 27/32	3 11/16
D439-420	4 x 2	3 7/8	6 1/16	5

\*Assembled from two molded parts

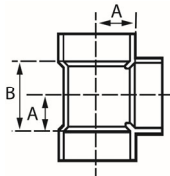

#### VENT TEE

Part Number	Size	A	B
D441-015	1½	1 5/32	2 5/16
D441-020	2	1 15/32	3
D441-030	3	1 27/32	3 11/16
D441-040	4	2 9/16	5 3/16
D441-060	6	4	8
D441-080	8	4 1/2	9 1/16
D441-100	10	5 7/8	11 3/4
D441-120	12	7	14

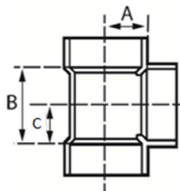

#### REDUCING VENT TEE

Part Number	Size	A	B	C
D441-624	10 x 10 x 4	5 31/32	10 7/8	5 7/16
D441-626	10 x 10 x 6	5 25/32	11	5 1/2
D441-628	10 x 10 x 8	5 15/16	10 7/8	5 15/32
D441-664	12 x 12 x 4	6 27/32	10 29/32	5 1/2
D441-666	12 x 12 x 6	6 27/32	10 29/32	5 1/2
D441-668	12 x 12 x 8	6 29/32	10 27/32	5 13/32
D441-670*	12 x 12 x 10	8 1/2	14 1/16	7

\*Fabricated

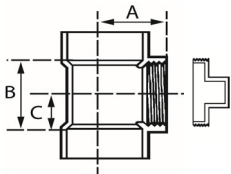

#### CLEANOUT TEE + C.O. PLUG

Part Number	Size	A	B	C
D443-015	1½	1 29/32	2 3/8	1 5/32
D443-020	2	2 7/32	3	1 15/32
D443-030	3	2 7/8	3 25/32	1 7/8
D443-040	4	3 29/32	5	2 1/2
D443-060	6	5 3/8	8	3 15/16
D443-080	8	6 7/8	10 11/32	5 3/16
D443-628	10 x 8	5 3/16	10 11/32	6 9/32
D443-668	12 x 8	6 15/16	10 7/32	5 5/32

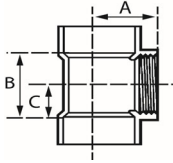

### CLEANOUT TEE

Part Number	Size	A	B	C
D445-015	1½	1 29/32	2 3/8	1 5/32
D445-020	2	2 7/32	3	1 15/32
D445-030	3	2 21/32	3 25/32	1 7/8
D445-040	4	3 1/2	5	2 1/2
D445-060	6	5 11/32	8	3 15/16
D445-080	8	6 27/32	10 1/2	5 3/16
D445-628	10 x 8	5 3/16	10 11/32	6 9/32
D445-668	12 x 8	6 15/16	10 7/32	5 5/32

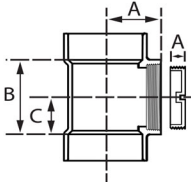

### FLUSH CLEANOUT TEE (Test Tee)

Part Number	Size	A	B	C
D445-020X	2	2 7/32	3	1 15/32
D445-030X	3	2 7/8	3 25/32	1 7/8
D445-030X	4	3 29/32	5	2 1/2

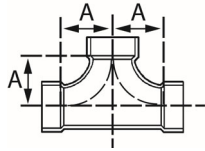

### TWO-WAY CLEANOUT

Part Number	Size	A
D448-030	3	4
D448-040	4	4 15/16

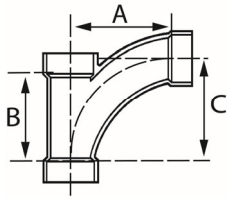

### COMBINATION WYE + 1/8 BEND - LONG TURN

Part Number	Size	A	B	C
D501-015	1½	3 15/16	3 1/2	3 15/16
D501-020	2	5 1/8	4 7/16	5 1/8
D501-030	3	7 17/32	6 15/32	7 15/32
D501-040	4	10 1/16	8 1/2	10 1/32

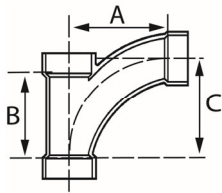

### COMBINATION WYE + 1/8 BEND - LONG TURN, REDUCING

Part Number	Size	A	B	C
D502-241	2 x 1½	4 3/32	3 1/4	3 27/32
D502-251	2 x 1½	4 3/32	3 1/4	3 29/32
D502-337	3 x 1½	4 23/32	3 5/16	3 1/2
D502-338	3 x 2	5 11/16	4 7/16	5 1/8
D502-420	4 x 2	6 3/32	4 13/32	5 3/32
D502-422	4 x 3	7 7/8	6 5/16	7 15/32

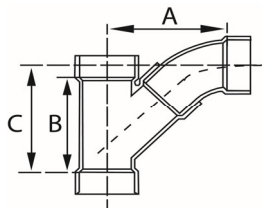

### COMBINATION WYE + 1/8 BEND (Two Piece)

Part Number	Size	A	B	C
D503-015	1½	4 1/2	4	4
D503-020	2	5 13/16	5	5 11/16
D503-030	3	7 21/32	6 5/8	7 17/32
D503-040	4	9 15/32	8 1/4	9 5/32
D503-060	6	11 21/32	10 1/4	11 7/16
D503-080	8	15 1/32	14 1/8	15 13/32
D503-100	10	18 1/2	16 1/2	18 1/2
D503-120	12	21 17/32	19 15/32	21 17/32

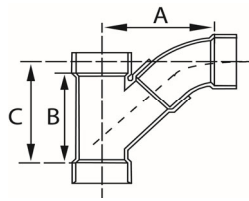

**COMBINATION WYE + 1/8 BEND (Two Piece)**

Part Number	Size	A	B	C
D504-338	3 x 2	6 9/32	5	5 23/32
D504-422	4 x 3	8 11/32	6 5/8	7 23/32
D504-532	6 x 4	10 11/32	6 29/32	8 11/32
D504-582	8 x 4	11 1/16	10 7/16	9 7/32
D504-585	8 x 6	12 15/32	10 7/16	11 1/2
D504-624	10 x 10 x 4	12 1/2	10 1/2	10 1/2
D504-626	10 x 10 x 6	13 23/32	10 15/16	11 15/16
D504-628	10 x 10 x 8	15 3/4	13 3/4	15 1/4
D504-664	12 x 12 x 4	13 15/32	10 15/16	12
D504-666	12 x 12 x 6	14 25/32	10 29/32	13 19/32
D504-668	12 x 12 x 8	16 3/16	16 15/16	16
D504-670	12 x 12 x 10	19 3/8	16 15/16	18 1/8

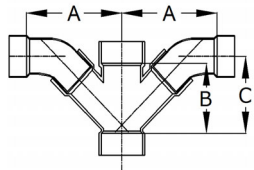

**DOUBLE COMBINATION WYE + 1/8 BEND**

Part Number	Size	A	B	C
D507-030	3	7 1/2	6 19/32	7 15/32
D507-040	4	9 17/32	8 7/32	9 1/4
D507-420	4 x 2	7	5 5/32	6 1/16
D507-422	4 x 3	8 9/32	6 19/32	7 21/32

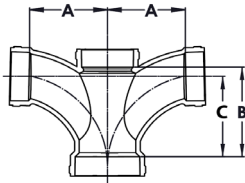

**DOUBLE FIXTURE FITTING**

Part Number	Size	A	B	C
D510-030	3	4 7/8	6 3/4	6 7/32
D510-241	2 x 1 1/2	2 7/8	3 15/32	3 3/16
D510-329	3 x 2 x 3 x 3	4 7/8	6 11/16	6 3/16

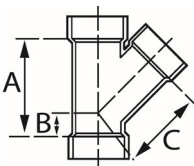

**WYE**

Part Number	Size	A	B	C
D600-015	1 1/2	3 29/32	1 1/8	2 7/8
D600-020	2	4 29/32	1 3/8	3 5/8
D600-030	3	6 5/8	1 5/8	5
D600-040	4	8 9/32	1 7/8	6 3/8
D600-060	6	10 3/16	1 3/4	8 7/16
D600-080	8	14 1/8	2 13/32	11 11/16
D600-100	10	16 1/2	2 27/32	13 21/32
D600-120	12	19 15/32	3 7/16	16 1/16

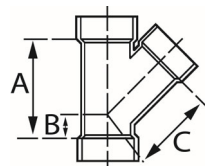

**WYE, REDUCING**

Part Number	Size	A	B	C
D601-241	2 x 1 1/2 x 1 1/2	3 7/8	1	3
D601-251	2 x 2 x 1 1/2	4 3/8	1 1/32	3 7/16
D601-337	3 x 3 x 1 1/2	4 1/4	1/2	4 11/32
D601-338	3 x 3 x 2	5	7/8	4 5/8
D601-420	4 x 4 x 2	5	3/8	5 9/16
D601-422	4 x 4 x 3	6 5/8	1 1/16	6
D601-530	6 x 6 x 3	7 5/32	7/32	7 1/2
D601-532	6 x 6 x 4	6 15/16	1/4	7 7/16
D601-582	8 x 8 x 4	10 7/16	11/32	8 9/16
D601-585	8 x 8 x 6	10 7/16	15/16	9 3/4
D601-624	10 x 10 x 4	10 31/32	1/4	10 7/16
D601-626	10 x 10 x 6	10 15/16	1/4	11 17/32
D601-628	10 x 10 x 8	13 13/16	1 1/4	13 3/32
D601-664	12 x 12 x 4	10 15/16	3/4	11 7/8
D601-666	12 x 12 x 6	10 29/32	3/4	13
D601-668	12 x 12 x 8	16 15/16	1 27/32	13 7/8
D601-670	12 x 12 x 10	16 15/16	1 13/16	14 15/16

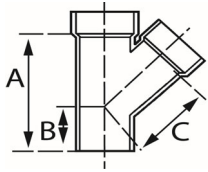

#### WYE, STREET

Part Number	Size	A	B	C
D602-015	1½	4 27/32	2	2 7/8
D602-020	2	6	2 11/32	3 5/8
D602-030	3	6 9/16	3	5
D602-040	4	8 5/32	3 17/32	6 3/8

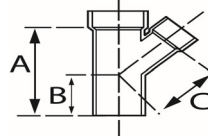

#### WYE, STREET, REDUCING

Part Number	Size	A	B	C
D603-337	3 x 3 x 1½	5 3/8	1 3/4	4 9/32
D603-338	3 x 3 x 2	6 11/16	2 9/16	4 5/8
D603-420	4 x 4 x 2	6 13/16	2 1/8	5 9/16
D603-422	4 x 4 x 3	8 13/32	2 27/32	6

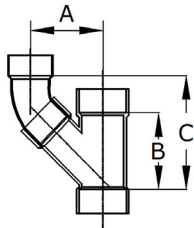

#### UPRIGHT COMBINATION WYE & 1/8 BEND (Two PC)

Part Number	Size	A	B	C
D605-020	2	4 9/32	4 29/32	7 1/8
D605-030	3	5 27/32	6 5/8	9 1/8
D605-100	10	15 13/32	16 1/2	21 5/16
D605-120	12	18 3/32	19 15/32	25

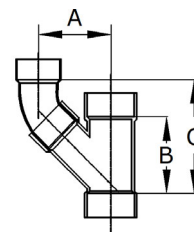

#### LARGE DIAMETER REDUCING UPRIGHT COMBINATION WYE & 1/8 BEND (Two PC)

Part Number	Size	A	B	C
D605-624	10 x 10 x 4	10 7/32	10 31/32	12 5/8
D605-626	10 x 10 x 6	11 23/32	10 15/16	13 15/16
D605-628	10 x 10 x 8	13 9/16	13 15/16	16 7/8
D605-664	12 x 12 x 4	11 1/4	10 15/16	14 7/32
D605-666	12 x 12 x 6	12 25/32	10 29/32	15 19/32
D605-668	12 x 12 x 8	14 1/8	10 15/16	18
D605-670	12 x 12 x 10	16 9/32	16 15/16	21 7/32

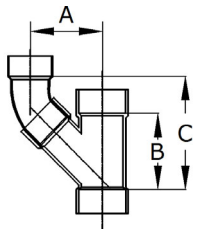

#### REDUCING UPRIGHT COMBINATION WYE & 1/8 BEND (Two PC)

Part Number	Size	A	B	C
D606-251	2 x 2 x 1½	3 23/32	4 11/32	5 13/16
D606-338	3 x 2	4 27/32	5	7 5/32

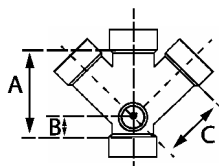

#### DOUBLE COTTAGE WYE w/2" INLET

Part Number	Size	A	B	C
D610-030	3	6 5/8	1 21/32	5
D610-040	4	8 1/4	1 7/8	6 3/8

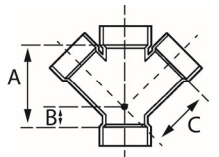

#### DOUBLE WYE

Part Number	Size	A	B	C
D611-015	1½	4	1 1/8	2 13/16
D611-020	2	4 15/16	1 3/8	3 19/32
D611-030	3	6 11/16	1 21/32	5
D611-040	4	8 1/4	1 7/8	6 13/32
D611-060	6	10 5/32	1 3/4	8 15/32

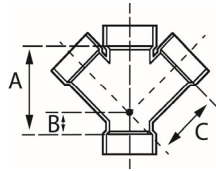

### DOUBLE WYE, REDUCING

Part Number	Size	A	B	C
D612-252	2x1½	4 19/32	1 1/8	3 7/16
D612-337	3 x 1½	4 3/16	1/2	4 9/32
D612-338	3 x 2	5	7/8	4 5/8
D612-420	4 x 2	5 1/4	7/16	5 9/16
D612-422	4 x 3	6 5/8	1 3/32	5 29/32
D612-532	6 x 4	6 29/32	1/4	7 13/32

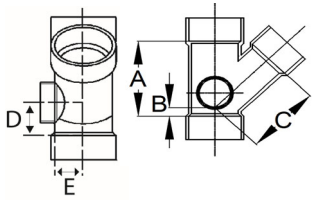

### COTTAGE WYE, LH INLET

Part Number	Size	A	B	C	E
D625-030	3	6 5/8	1 19/32	4 15/16	1.75
D625-040	4	8 7/32	1 7/8	6 3/8	2.21875

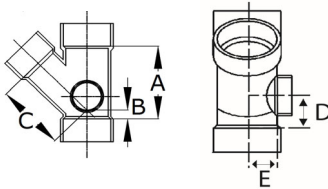

### COTTAGE WYE, RH INLET

Part Number	Size	A	B	C	E
D626-030	3	6 5/8	1 19/32	4 15/16	1.75
D626-040	4	8 7/32	1 7/8	6 3/8	2.21875

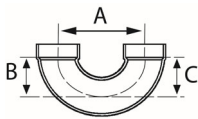

### RETURN BEND

Part Number	Size	A	B	C
D700-015	1½	3 1/2	1 1/2	1 1/2
D700-020	2	5 7/32	2 11/32	2 11/32
D700-030	3	6 23/32	2 29/32	2 29/32
D700-040	4	8 17/32	3 5/8	3 5/8

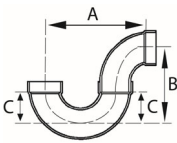

### P-TRAP

Part Number	Size	A	B	C
D706-015	1½	4 7/8	3 29/32	1 1/2
D706-020	2	7 7/16	5 1/8	2 3/8
D706-030	3	8 7/8	6 21/32	2 29/32
D706-040	4	11 3/32	8 11/16	3 5/8

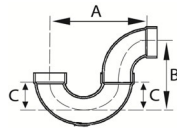

### P-TRAP, LOW PROFILE

Part Number	Size	A	B	C
D706-016	1½	4 19/32	3 3/8	1 1/2
D706-021	2	6 11/16	4 1/2	2 3/8

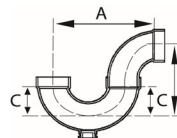

### P-TRAP w/CLEANOUT

Part Number	Size	A	B	C
D707-015	1½	4 21/32	3 11/16	1 15/32
D707-020	2	7 3/16	4 5/8	2 11/32

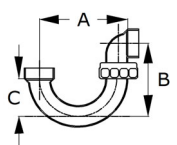

### P-TRAP, UNION

Part Number	Size	A	B	C
D708-015	1½	4 7/8	3 7/8	1 15/32
D708-020	2	7 7/16	5 1/8	2 3/8

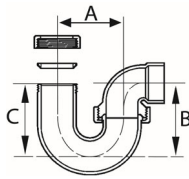

**LA PATTERN P-TRAP**

Part Number	Size	A	B	C
D711-015	1½	4 29/32	3 7/8	3 23/32
D711-212	1½ x 1¼	4 7/8	3 7/8	3 11/32

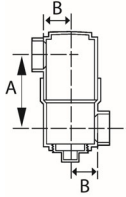

**DRUM TRAP**

Part Number	Size	A	B
D720-015	3 x 6 x 1½	4 19/32	1 23/32

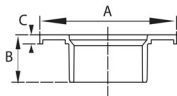

**CLOSET FLANGE (One Piece)**

Part Number	Size	A	B	C
D800-040	4	7	2 1/32	15/32
D800-422	4 x 3	7	2 15/32	7/16

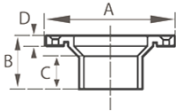

**CLOSET FLANGE (One Piece)**

Part Number	Size	A	B	C
D801-040	4	7	2 3/32	1 13/16
D801-422	4 x 3	7	2 3/4	1 9/16

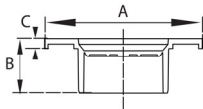

**CLOSET FLANGE w/KNOCK OUT (One Piece)**

Part Number	Size	A	B	C
D810-422	4 x 3	7	2 13/32	7/16

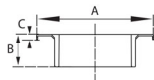

**CLOSET FLANGE, ADJUSTABLE w/METAL RING**

Part Number	Size	A	B	C
D811-040	4	7	2 1/32	11/32

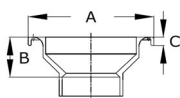

**CLOSET FLANGE, ADJUSTABLE w/METAL RING**

Part Number	Size	A	B	C
D811-422	4x3	7	1 1/4	5/16

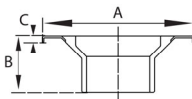

**CLOSET FLANGE, ADJUSTABLE w/METAL RING**

Part Number	Size	A	B	C
D812-040	4	7	2 7/8	5/16
D812-422	4x3	7	2 3/4	5/16

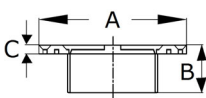

**FLUSH CLOSET FLANGE w/KNOCK OUT**

Part Number	Size	A	B	C
D815-422	4x3	7	2 13/32	7/16

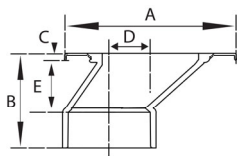

**OFFSET CLOSET FLANGE**

Part Number	Size	A	B	C	E
D822-422	w/Plastic Ring	7	4 7/32	7/16	2.125



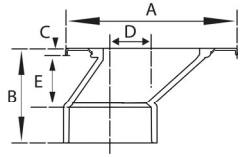

**OFFSET CLOSET FLANGE**

Part Number	Size	A	B	C	E
D823-422					
w/Metal Ring	4x3	7	4 4/21	22/71	2.375

