

Series 909, LF909

Reduced Pressure Zone Assemblies

Sizes 3/4" – 2"

Repair Kits

When ordering specify Ordering Code, Kit No., and Valve Size.

| ORDERING CODE | KIT NO. | SIZE |
|---------------|---------|------|
|---------------|---------|------|

Total Repair Kits

| | | | |
|-----------|---------|------------|-------------|
| LEAD FREE | 0794066 | LFRK 909-T | 3/4" – 1" |
| | 0794071 | LFRK 909-T | 1 1/4" – 2" |

Kit consists of: relief valve repair kit, first check repair kit, second check repair kit

Relief Valve Kits

Relief Valve Kits»

| | | | |
|-----------|---------|---------------|-------------|
| LEAD FREE | 0794059 | LFRK 909 VT | 3/4" – 1" |
| | 0794060 | LFRK 909M1 VT | 1 1/4" – 2" |

Kit consists of: relief valve assembly, seat, seat O-ring, 2 piston O-rings and lubricant.

Rubber Parts for Relief Valve

1 1/4" – 2"

| | | | |
|-----------|---------|---------------|-------------|
| LEAD FREE | 0794061 | LFRK 909 RV | 3/4" – 1" |
| | 0794062 | LFRK 909M1 RV | 1 1/4" – 2" |

Kit consists of: diaphragm, disc assembly, seat O-ring, RV O-ring, 2 piston O-ring, and lubricant.

Seat Kits for Relief Valve

| | | | |
|-----------|---------|-------------|-------------|
| LEAD FREE | 0887372 | RK 909 SV | 3/4" – 1" |
| | 0887371 | RK 909M1 SV | 1 1/4" – 2" |

Kit consists of: seat, seat O-ring, 2 piston O-ring and lubricant.

1 1/4" – 2" 909/909M1 are common kits.

3/4" – 1"

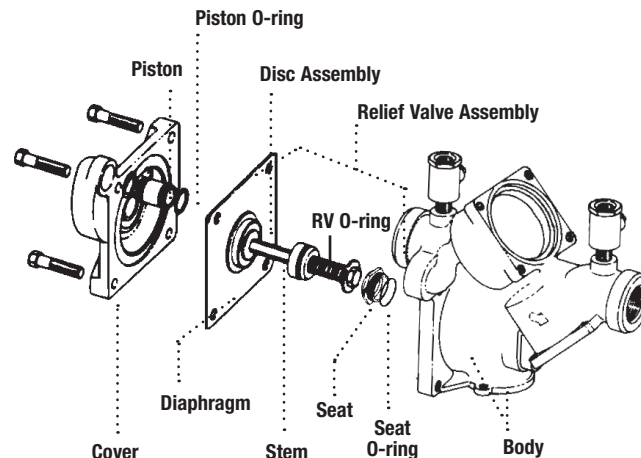

1 1/4" – 2"

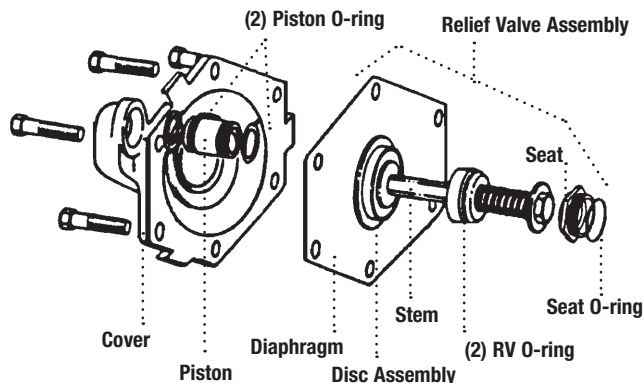

NOTICE

TO PREVENT SHAFT DAMAGE ASSEMBLE AS SHOWN: If cover will not press against body, assembly is crooked and tightening bolts will bend shaft. Do not force the cover into place as damage may result from misalignment.

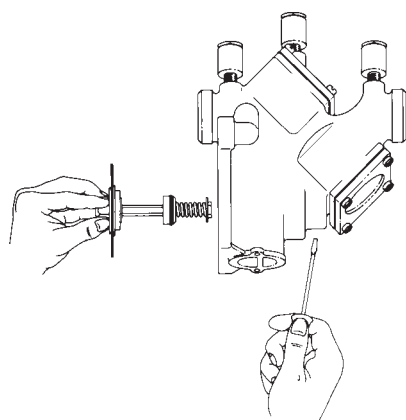

Figure 1:

To assemble the relief valve assembly have a screwdriver ready.

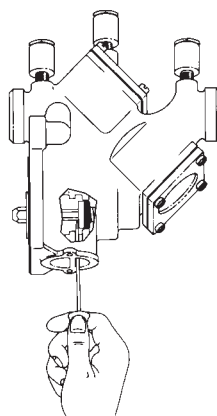

Figure 2:

Depress the relief valve assembly, carefully guiding it against the two pound spring load. When properly aligned, the piston is in the cylinder bore. Insert the screwdriver as shown.

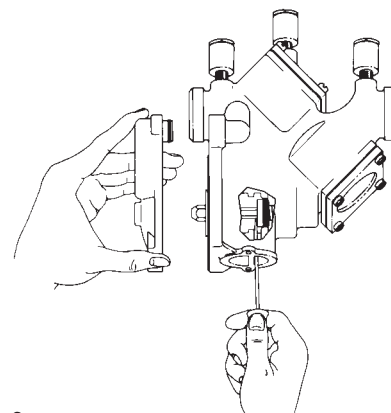

Figure 3:

The relief valve assembly is held encapsulated by the screwdriver. You should now have both hands free to bolt down the cover. Insert and snug two bolts 180° apart to hold the cover. Finish inserting the remaining bolts and snug up evenly alternating until secure. Remove the screwdriver.

Series 909, LF909

Reduced Pressure Zone Assemblies

Sizes 3/4" – 2"

Check valve kits

When ordering specify Ordering Code, Kit No., and Valve Size.

Note: 1 1/4" – 2" 909/909M1 are common kits.

| ORDERING CODE | KIT NO. | SIZE |
|---------------|---------|------|
|---------------|---------|------|

First Check Kits

| | | | |
|-----------|---------|------------------|-------------|
| LEAD FREE | 0887120 | RK 909 CK1 | 3/4" – 1" |
| | 0794063 | LFRK 909M1 CK1 | 1 1/4" – 2" |
| | 0887122 | RK 909 CK1SS** | 3/4" – 1" |
| | 0887135 | RK 909M1 CK1SS** | 1 1/4" – 2" |

Second Check Kits

| | | | |
|-----------|---------|------------------|-------------|
| LEAD FREE | 0887121 | RK 909 CK2 | 3/4" – 1" |
| | 0794064 | LFRK 909M1 CK2 | 1 1/4" – 2" |
| | 0887123 | RK 909 CK2SS** | 3/4" – 1" |
| | 0887136 | RK 909M1 CK2SS** | 1 1/4" – 2" |

Kit consists of: disc assembly, spring, seat, seat O-ring, cover O-ring and lubricant.

Rubber Parts for Both Checks

| | | | |
|-----------|---------|-------------------|-------------|
| LEAD FREE | 0887129 | RK 909 RC3 | 3/4" – 1" |
| | 0887310 | RK 909 RC3 HW | 3/4" – 1" |
| LEAD FREE | 0794065 | LFRK 909M1 RC3 | 1 1/4" – 2" |
| | 0794068 | LFRK 909M1 RC3 HW | 1 1/4" – 2" |

Kit consists of: disc assembly, seat O-ring, cover O-ring and lubricant.

NOTE: HW model has bronze disc assembly.

Complete Rubber Parts

| | | | |
|-----------|---------|---------------|-------------|
| LEAD FREE | 0794069 | LFRK 909 RT | 3/4" – 1" |
| | 0794070 | LFRK 909M1 RT | 1 1/4" – 2" |

Kit consists of: disc assembly, seat O-rings, RV diaphragm, RV O-rings, piston O-rings, cover O-rings and lubricant.

Seat Kits for One Check

| | | | |
|-----------|---------|-----------------|-------------|
| LEAD FREE | 0887124 | RK 909 S | 3/4" – 1" |
| | 0887139 | RK 909M1 S | 1 1/4" – 2" |
| | 0887125 | RK 909 S-SS** | 3/4" – 1" |
| | 0887140 | RK 909M1 S-SS** | 1 1/4" – 2" |

Kit consists of: seat, seat O-ring and lubricant.

Cover Kits

| | | | |
|-----------|---------|---------------|-------------|
| LEAD FREE | 0794072 | LFRK 909 C1 | 3/4" – 1" |
| | 0794073 | LFRK 909 C2 | 3/4" – 1" |
| | 0794074 | LFRK 909 VC | 3/4" – 1" |
| | 0794075 | LFRK 909M1 C4 | 1 1/4" – 2" |
| | 0794076 | LFRK 909M1 VC | 1 1/4" – 2" |

Kit consists of: cover, cover O-ring and lubricant.

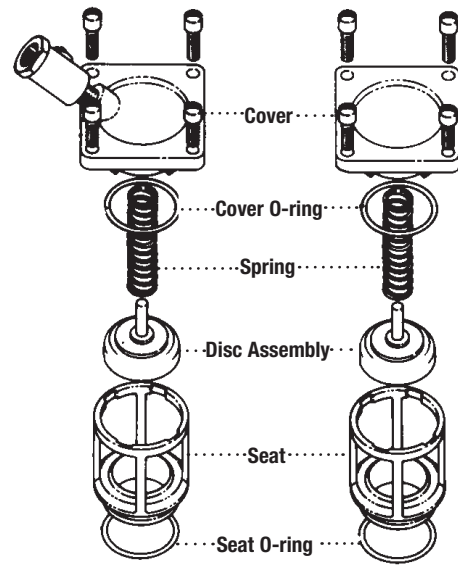

First Check

Second Check

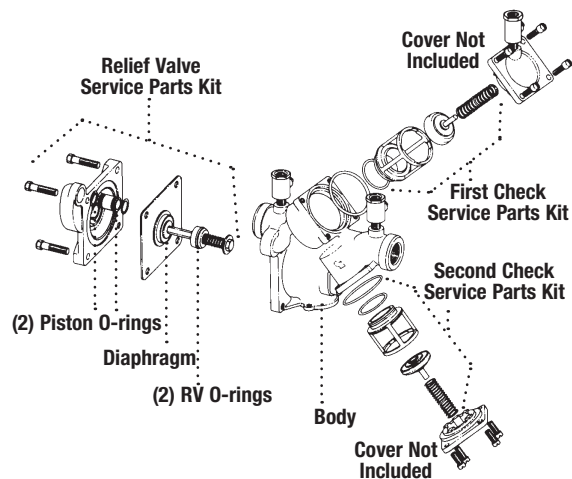

No special tools required to service Series 909.

Rubber seat disc can be replaced. However, disc holder and disc retainer are permanently bonded to prevent failure.

| ORDERING CODE | KIT NO. | SIZE |
|---------------|---------|------|
|---------------|---------|------|

Polymer Coated Valves

| | | | |
|-----------|---------|-----------------|-------------|
| LEAD FREE | 0794079 | LFRK 909-PC-CK1 | 3/4" – 1" |
| | 0794080 | LFRK 909-PC-CK2 | 3/4" – 1" |
| | 0794077 | LFRK 909-PC-CK1 | 1 1/4" – 2" |
| | 0794078 | LFRK 909-PC-CK2 | 1 1/4" – 2" |

Kit consists of: disc assembly, seat, seat O-ring, sleeve, check spring, PC cover and cover O-ring.