

Style 744 FireLock® Flange Adapter

with Vic-Plus™ Gasket System



PRODUCT DESCRIPTION



2 - 8" Sizes

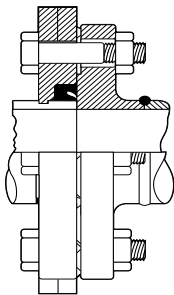

(Exaggerated for clarity)

Style 744 FireLock Flange adapter is designed for directly incorporating flanged components with ANSI CL. 125 or CL. 150 bolt hole patterns into a grooved pipe system. Sizes 2 - 8" (50 - 200 mm) are hinged for easy handling with integral end tabs which facilitate assembly.

The design incorporates small teeth inside the key shoulder I.D. to prevent rotation.

Because of the outside flange dimension, FireLock Flange adapters should not be used on FireLock fittings. When wafer or lug-type valves are used adjoining a Victaulic fitting, check disc dimensions to assure proper clearance.

FireLock Flange adapters should not be used as anchor points for tie-rods across nonrestrained joints. Mating rubber faced flanges, valves, etc., require the use of a FireLock Flange washer.

FireLock Flange adapters with Vic-Plus gaskets do not require lubrication. The gasket must always be assembled with the color coded lip on the pipe and the other lip facing the mating flange.

Style 744 FireLock Flange Adapters with the Vic-Plus™ Gasket System are designed and recommended for use ONLY on fire protection systems.

Vic-Plus Gasket System:

Victaulic® now offers a gasket system which requires no field lubrication on wet pipe systems. The Vic-Plus™ System (patented) is dry, clean, and non-toxic. It reduces assembly time substantially and eliminates the mess and chance of over-lubrication. Please refer to the latest copy of the Victaulic Field Installation Handbook (I-100) for supplemental lubrication requirements.



See Victaulic publication 10.01 for details.

DIMENSIONS

Style 744

Sizes 2 - 8" (50 - 200 mm)
ANSI Class 125 and 150 Flange

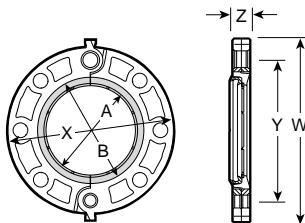

Note: Gray area of mating face must be free from gouges, undulations or deformities of any type for effective sealing.

Pipe Size		Max. Work Press.* PSI kPa	Max. End Load* Lbs. N	No. Bolts † Req'd.	Bolt Size † Inches	Sealing Surface Inches/mm		Dimensions Inches/millimeters				Aprx. Wgt. Each Lbs. kg
Nominal Diameter In./mm	Actual Outside Diameter In./mm					"A" Max.	"B" Min.	W	X	Y	Z	
2 50	2.375 60.3	175 1200	775 3450	4	5/8 X 2 3/4	2.38 60	3.41 87	6.75 172	6.00 152	4.75 121	0.75 19	2.7 1.2
2 1/2 65	2.875 73.0	175 1200	1135 5050	4	5/8 X 3	2.88 73	3.91 99	7.88 200	7.00 178	5.50 140	0.88 22	4.2 1.9
3 80	3.500 88.9	175 1200	1685 7500	4	5/8 X 3	3.50 89	4.53 115	8.44 214	7.50 191	6.00 152	0.94 24	4.8 2.2
4 100	4.500 114.3	175 1200	2780 11045	8	5/8 X 3	4.50 114	5.53 141	9.94 252	9.00 229	7.50 191	0.94 24	7.1 3.2
5 125	5.563 141.3	175 1200	4250 18920	8	3/4 X 3 1/2	5.56 141	6.71 171	11.00 279	10.00 254	8.50 216	1.00 25	8.3 3.8
6# 150	6.625 168.3	175 1200	6030 26840	8	3/4 X 3 1/2	6.63 168	7.78 198	12.00 305	11.00 279	9.50 241	1.00 25	9.3 4.2
8# 200	8.625 219.1	175 1200	10219 45475	8	3/4 X 3 1/2	8.63 219	9.94 252	14.63 372	13.50 343	11.75 298	1.13 29	13.9 6.3

*Refer to notes below.

†Total bolts required to be supplied by installer. Bolt sizes for conventional flange-to-flange connection. Larger bolts are required when Vic-Flange adapter is utilized with wafer-type valves.

Not available with Vic-Plus gasket system. Lubrication is required.

NOTES

* Working Pressure and End Load are total, from all internal and external loads, based on standard weight steel pipe, standard roll or cut grooved in accordance with Victaulic specifications. Contact Victaulic for performance on other pipe.

WARNING: FOR ONE TIME FIELD TEST ONLY, the Maximum Joint Working Pressure may be increased to 1 1/2 times the figures shown.

Style 744 FireLock Flange adapters provide rigid joints when used on pipe with standard roll or cut groove dimensions and consequently allow no linear or angular movement at the joint.

WARNING: Depressurize and drain the piping system before attempting to install, remove, or adjust any Victaulic piping products.



VIC-FLANGE ADAPTER NOTES

- 1 The Style 744 (2 - 8" / 50 - 200 mm) design incorporates small teeth inside the key shoulder I.D. to prevent rotation.
- 2 FireLock Flange adapter should not be used on FireLock fittings. When wafer or lug-type valves are used adjoining a Victaulic fitting, check disc dimensions to assure proper clearance.
- 3 FireLock Flange adapters should not be used as anchor points for tie-rods across nonrestrained joints. Mating rubber faced flanges, valves, etc. require the use of a FireLock Flange washer.
- 4 Area A-B noted in the above drawing must be free from gouges, undulations or deformities of any type for effective sealing.
- 5 FireLock Flange adapter gaskets must always be assembled with the color coded lip on the pipe and the other lip facing the mating flange.
- 6 Flange Washers: FireLock Flange adapters require a smooth hard surface at the mating flange face for effective sealing. Some applications for which the Vic-Flange adapter is otherwise well suited do not provide an adequate mating surface. In such cases, it is recommended that a metal Flange Washer be inserted between the FireLock Flange adapter and the mating flange to provide the necessary sealing surface.

Typical applications where a Flange Washer should be used are:

- A When mating to a serrated flange: a standard flat flange gasket should be used adjacent to the serrated flange and then the Flange Washer is inserted between the FireLock Flange adapter and the flange gasket.
- B When mating to a wafer valve: where typical valves are rubber lined and partially rubber faced (smooth or not), the Flange Washer is placed between the valve and the FireLock Flange adapter.
- C When mating a rubber faced flange: the Flange Washer is placed between the FireLock Flange adapters and the rubber faced flange.
- D When mating AWWA cast flanges to IPS flanges: the Flange Washer is placed between two FireLock Flanges. The hinge points must be oriented approximately 90° to each other. If one flange is not a FireLock Flange adapter (e.g. flanged valve), then a standard flat flange gasket must be placed adjacent to that flange and the Flange Washer inserted between the flange gasket and the FireLock Flange adapter.
- E When mating to components (valves, strainers, etc.) where the component flange face has an insert: follow the same arrangement as in Application 1.
- F When mating to a Series 705-W Butterfly valve, Style 744 may only be used on one side of the connection.

When ordering Flange Washers, always specify product style (Style 744) and size to assure proper Flange Washer is supplied.

MATERIAL SPECIFICATIONS

Flange Housing: Ductile iron conforming to ASTM A-536, grade 65-45-12. Ductile iron conforming to ASTM A-395, grade 65-45-15, is available upon special request.

Coating: Black enamel

- **Optional:** Hot dipped galvanized

Bolts/Nuts: Supplied by installer

Gasket:

- **Grade "E" EPDM - Type A Vic-Plus Gasket System Δ**
(Violet color code). FireLock products have been Listed by Underwriters Laboratories Inc. and Approved by Factory Mutual Research for wet and dry (oil free air) sprinkler services up to the rated working pressure using the Grade "E" Type A Vic-Plus Gasket System, requiring no field lubrication for most installation conditions.

Δ Standard gasket approved for dry pipe systems to -40°F (-40°C). Based on "typical" pipe surface conditions, supplemental lubricant is recommended for services installed below 0°F (-18°C) and for all dry pipe systems or systems to be subjected to air tests prior to being filled with water. Supplemental lubrication may also be required on pipe with raised or undercut weld seams or pipe that has voids and/or cracks at the weld seams.