

# Air Maintenance/Compressor Assembly

## SERIES 7C7



Series 7C7

### 1.0 PRODUCT DESCRIPTION

#### Available Sizes

- For pipe sizes 1 ½" to 8"/DN40-DN200

#### Maximum Air Pressure

- 18 psi/124 kPa/1.2 bar

#### Minimum Air Pressure

- 13 psi/ 90 kPa/ 0.9 bar

#### Available Compressor Capacities

- ⅓ hp
- ¼ hp
- ½ hp
- ¾ hp
- 1 hp

#### System Charge Time Options

- 30 Minutes in accordance with NFPA 13
- 60 Minutes

#### Designed for use With

- Series 768N FireLock NXT™ Dry System Check Valve
- Series 769N FireLock NXT™ Deluge System Check Valve
- Series 769N FireLock NXT™ Preaction System Check Valve
- Series 764 FireLock NXT™ Alternate Wet/Dry Valve
- Series 745 FireLock™ Fire-Pac

### 2.0 CERTIFICATION/LISTINGS

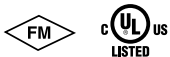

- The Series 757P Air Maintenance Device is UL Listed and FM Approved.
- The engineer/system designer is responsible for sizing the compressor so that the entire system is charged to the required air pressure within NFPA 13 guidelines (30 minutes). DO NOT oversize the compressor to provide more airflow. An oversized compressor will slow down or possibly prevent valve operation.

#### NOTE

- The Series 7C7 Air Maintenance/Compressor Assembly is designed for systems that do not require an accelerator to achieve the required system pressure performance. If an accelerator is required, a tank-mounted compressor with a regulated air maintenance device should be used.

**ALWAYS REFER TO ANY NOTIFICATIONS AT THE END OF THIS DOCUMENT REGARDING PRODUCT INSTALLATION, MAINTENANCE OR SUPPORT.**

### 3.0 COMPRESSOR CAPACITIES

Power Hp kW	Nominal Voltage ± 10% V	Frequency Hz	Current Draw A	Sound Level dB	Maximum Working Pressure psi bar	Time Minutes	Capacity with AutoVent Gallons m <sup>3</sup>	Capacity without AutoVent Gallons m <sup>3</sup>
1/6 0.13	115	60	4.0	< 70	18 1.2	30	187 0.7	276 1.0
						60	374 1.4	552 2.1
	208-230	60	2.0			30	187 0.7	276 1.0
						60	374 1.4	552 2.1
	220-240	50	2.0			30	140 0.5	231 0.9
						60	280 1.1	462 1.7
1/4 0.19	115	60	4.0	< 70	18 1.2	30	256 1.0	406 1.5
						60	512 1.9	812 3.1
	208-230	60	2.0			30	256 1.0	406 1.5
						60	512 1.9	812 3.1
	220-240	50	2.0			30	200 0.8	315 1.2
						60	400 1.5	630 2.4
1/2 0.37	115	60	6.8	< 75	18 1.2	30	456 1.7	600 2.3
						60	912 3.5	1200 4.5
	208-230	60	3.4			30	456 1.7	600 2.3
						60	912 3.5	1200 4.5
	220-240	50	3.4			30	330 1.2	490 1.9
						60	660 2.5	980 3.7
3/4 0.56	115	60	15	< 79	18 1.2	30	675 2.6	840 3.2
			60			1350 5.1	1680 6.4	
	208-230	60	7.5			30	675 2.6	840 3.2
			60			1350 5.1	1680 6.4	
	220-240	50	7.5			30	500 1.9	680 2.6
			60			1000 3.8	1360 5.1	
1 0.75	115	60	15	< 79	18 1.2	30	1020 3.9	1170 4.4
						60	2040 7.7	2340 8.9
	208-230	60	7.5			30	1020.0 3.9	1170 4.4
						60	2040 7.7	2340 8.9
	220-240	50	7.5			30	830.0 3.1	940 3.6
						60	1660 6.3	1880 7.1

**NOTE**

- Refer to the charts on the following pages for minimum required fill capacities to 13 psi/0.9 bar. Low air alarms will clear at 13 psi/0.9 bar. In addition, these charts contain higher capacities to 18 psi/1.2 bar that are not shown in the table above.

## 4.0 DIMENSIONS

### Assembly Dimensions

#### Series 7C7 – 1/8 HP Compressor

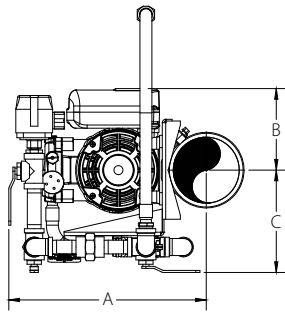

Front

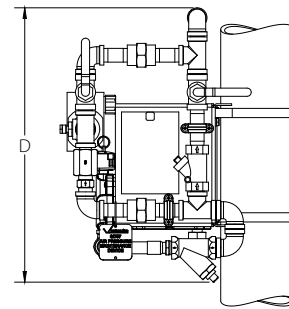

Top

Size		Assembly Dimensions				Weight
Nominal inches DN	Actual Outside Diameter inches mm	A inches mm	B inches mm	C inches mm	D inches mm	Approx. (Each) lb kg
1 1/2 DN40	1.900 48.3	10.75 273	5.00 127	6.25 159	16.88 426	29.0 13.2
2 DN50	2.375 60.3	11.00 279	5.00 127	6.25 159	16.88 426	29.0 13.2
2 1/2	2.875 73.0	11.25 286	5.00 127	6.25 159	16.88 426	29.0 13.2
DN65	3.000 76.1	11.38 287	5.00 127	6.25 159	16.88 426	29.0 13.2
3 DN80	3.500 88.9	11.63 294	5.00 127	6.25 159	16.88 426	29.0 13.2
4 DN100	4.500 114.3	12.13 307	5.00 127	6.25 159	16.88 426	29.0 13.2
	6.500 165.1	13.13 333	5.00 127	6.25 159	16.88 426	29.0 13.2
6 DN150	6.625 168.3	13.25 335	5.00 127	6.25 159	16.88 426	29.0 13.2
8 DN200	8.625 219.1	14.25 361	5.00 127	6.25 159	16.88 426	29.0 13.2

4.0 DIMENSIONS (CONTINUED)

Assembly Dimensions

Series 7C7 – ¼ HP Compressor

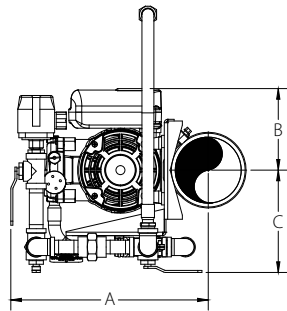

Front

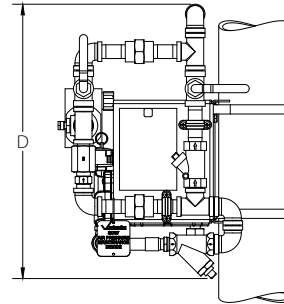

Top

Size		Assembly Dimensions				Weight
Nominal inches DN	Actual Outside Diameter inches mm	A inches mm	B inches mm	C inches mm	D inches mm	Approx. (Each) lb kg
1 ½ DN40	1.900 48.3	10.75 273	5.00 127	6.25 159	16.88 426	29.1 13.2
2 DN50	2.375 60.3	11.00 279	5.00 127	6.25 159	16.88 426	29.1 13.2
2 ½	2.875 73.0	11.25 286	5.00 127	6.25 159	16.88 426	29.1 13.2
DN65	3.000 76.1	11.38 287	5.00 127	6.25 159	16.88 426	29.1 13.2
3 DN80	3.500 88.9	11.63 294	5.00 127	6.25 159	16.88 426	29.1 13.2
4 DN100	4.500 114.3	12.13 307	5.00 127	6.25 159	16.88 426	29.1 13.2
	6.500 165.1	13.13 333	5.00 127	6.25 159	16.88 426	29.1 13.2
6 DN150	6.625 168.3	13.25 335	5.00 127	6.25 159	16.88 426	29.1 13.2
8 DN200	8.625 219.1	14.25 361	5.00 127	6.25 159	16.88 426	29.1 13.2

4.0 DIMENSIONS (CONTINUED)

Assembly Dimensions

Series 7C7 – ½ HP Compressor

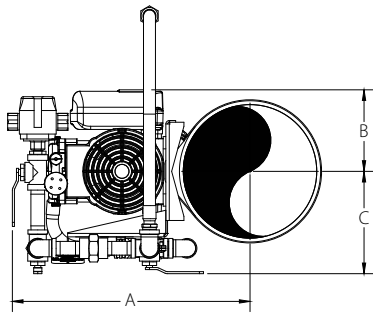

Front

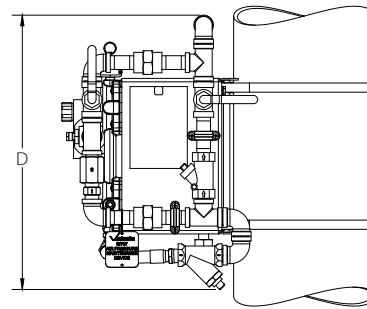

Top

Size		Assembly Dimensions				Weight
Nominal inches DN	Actual Outside Diameter inches mm	A inches mm	B inches mm	C inches mm	D inches mm	Approx. (Each) lb kg
1 ½ DN40	1.900 48.3	10.75 273	5.00 127	6.25 159	16.88 426	34.0 15.4
2 DN50	2.375 60.3	11.00 279	5.00 127	6.25 159	16.88 426	34.0 15.4
2 ½	2.875 73.0	11.25 286	5.00 127	6.25 159	16.88 426	34.0 15.4
DN65	3.000 76.1	11.38 287	5.00 127	6.25 159	16.88 426	34.0 15.4
3 DN80	3.500 88.9	11.63 294	5.00 127	6.25 159	16.88 426	34.0 15.4
4 DN100	4.500 114.3	12.13 307	5.00 127	6.25 159	16.88 426	34.0 15.4
	6.500 165.1	13.13 333	5.00 127	6.25 159	16.88 426	34.0 15.4
6 DN150	6.625 168.3	13.25 335	5.00 127	6.25 159	16.88 426	34.0 15.4
8 DN200	8.625 219.1	14.25 361	5.00 127	6.25 159	16.88 426	34.0 15.4

4.0 DIMENSIONS (CONTINUED)

Assembly Dimensions

Series 7C7 – ¾ HP Compressor

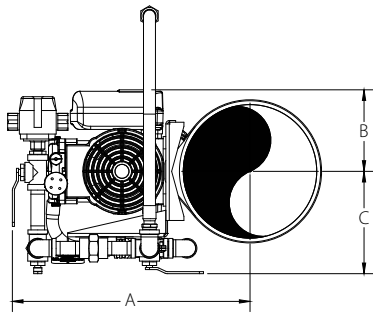

Front

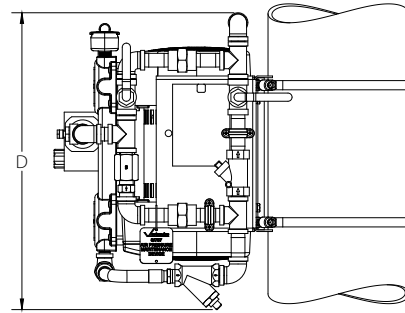

Top

Size		Assembly Dimensions				Weight
Nominal inches DN	Actual Outside Diameter inches mm	A inches mm	B inches mm	C inches mm	D inches mm	Approx. (Each) lb kg
1½ DN40	1.900 48.3	13.50 341	6.75 171	6.25 159	18.25 461	51.7 23.5
2 DN50	2.375 60.3	13.75 347	6.75 171	6.25 159	18.25 461	51.7 23.5
2½	2.875 73.0	14.00 353	6.75 171	6.25 159	18.25 461	51.7 23.5
DN65	3.000 76.1	14.00 355	6.75 171	6.25 159	18.25 461	51.7 23.5
3 DN80	3.500 88.9	14.25 362	6.75 171	6.25 159	18.25 461	51.7 23.5
4 DN100	4.500 114.3	14.75 375	6.75 171	6.25 159	18.25 461	51.7 23.5
	6.500 165.1	15.88 401	6.75 171	6.25 159	18.25 461	51.7 23.5
6 DN150	6.625 168.3	15.88 403	6.75 171	6.25 159	18.25 461	51.7 23.5
8 DN200	8.625 219.1	16.88 429	6.75 171	6.25 159	18.25 461	51.7 23.5

4.0 DIMENSIONS (CONTINUED)

Assembly Dimensions

Series 7C7 – 1 HP Compressor

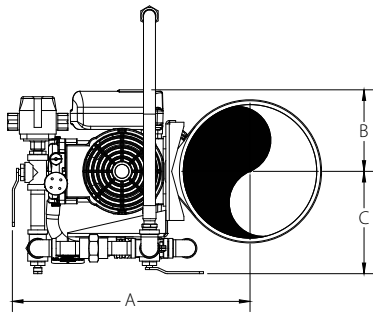

Front

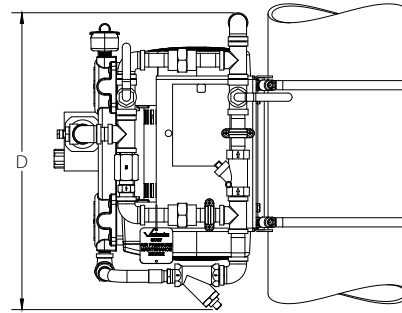

Top

Size		Assembly Dimensions				Weight
Nominal inches DN	Actual Outside Diameter inches mm	A inches mm	B inches mm	C inches mm	D inches mm	Approx. (Each) lb kg
1½ DN40	1.900 48.3	13.50 341	6.75 171	6.25 159	18.25 461	51.9 23.5
2 DN50	2.375 60.3	13.75 347	6.75 171	6.25 159	18.25 461	51.9 23.5
2½	2.875 73.0	14.00 353	6.75 171	6.25 159	18.25 461	51.9 23.5
DN65	3.000 76.1	14.00 355	6.75 171	6.25 159	18.25 461	51.9 23.5
3 DN80	3.500 88.9	14.25 362	6.75 171	6.25 159	18.25 461	51.9 23.5
4 DN100	4.500 114.3	14.75 375	6.75 171	6.25 159	18.25 461	51.9 23.5
	6.500 165.1	15.88 401	6.75 171	6.25 159	18.25 461	51.9 23.5
6 DN150	6.625 168.3	15.88 403	6.75 171	6.25 159	18.25 461	51.9 23.5
8 DN200	8.625 219.1	16.88 429	6.75 171	6.25 159	18.25 461	51.9 23.5

## 4.1 DIMENSIONS

### Exploded view drawing

Series 7C7 air maintenance compressor assembly with 1/6 HP or 1/4 HP compressor

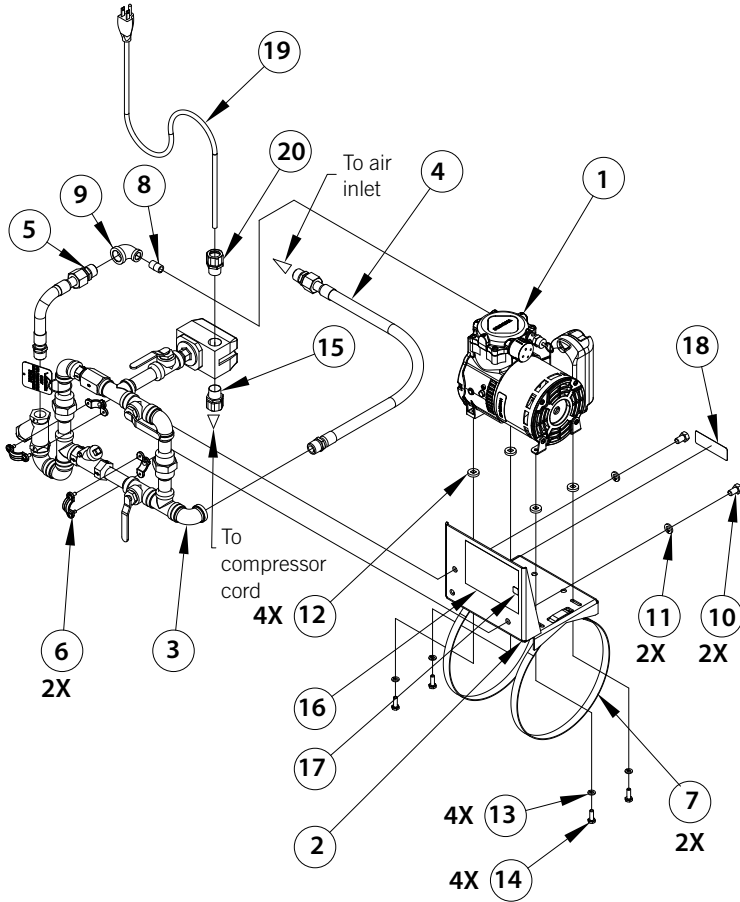

Item	Qty	Description
1	1	Compressor
2	1	Mounting bracket
3	1	Series 757P air maintenance trim with Pressure switch
4	1	Trim hose-26" length
5	1	Trim hose-11" length
6	2	Pipe Hangers
7	2	Hose clamps
8	1	Pipe nipple
9	1	Reducing elbow
10	2	Bolts
11	2	Spring lock washers
12	4	Memory stop washers
13	4	Screws
14	4	Washers
15	1	Cord connector
16	1	Danger/Information Label
17	1	QR Reader Label
18	1	7C7 Compressor, Label
19	1	14 AWG Ground chord with plug (CSA only)
20	1	Connector (CSA Only)



### 4.1 DIMENSIONS (CONTINUED)

Exploded view drawing

Series 7C7 air maintenance compressor assembly with 1/2 hp compressor

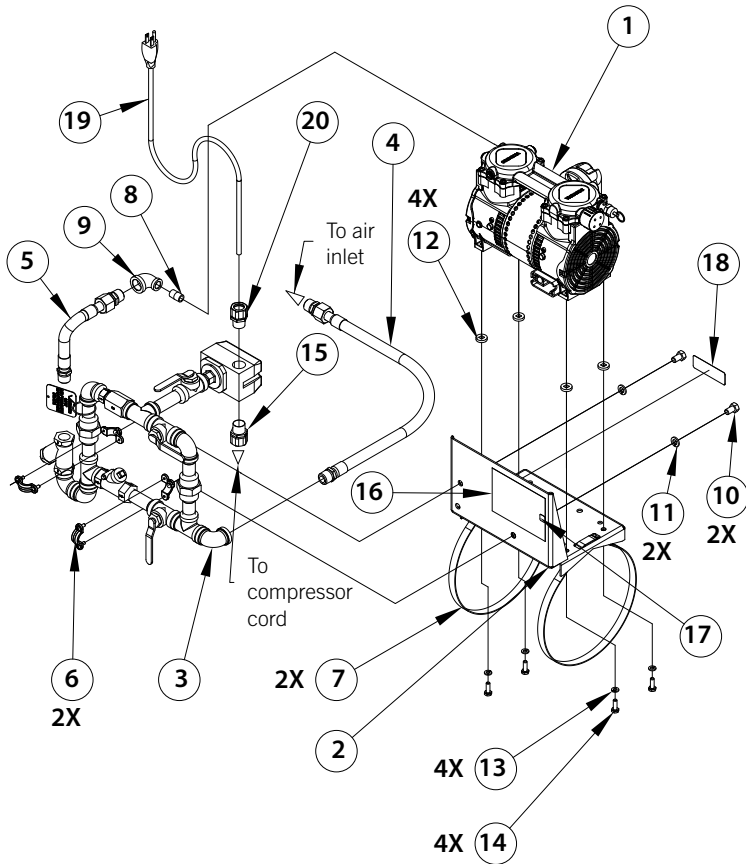

Item	Qty	Description
1	1	Compressor
2	1	Mounting bracket
3	1	Series 757P air maintenance trim with Pressure switch
4	1	Trim hose-26" length
5	1	Trim hose-11" length
6	2	Pipe Hangers
7	2	Hose clamps
8	1	Pipe nipple
9	1	Reducing elbow
10	2	Bolts
11	2	Spring lock washers
12	4	Memory stop washers
13	4	Screws
14	4	Washers
15	1	Cord connector
16	1	Danger/Information Label
17	1	QR Reader Label
18	1	7C7 Compressor, Label
19	1	14 AWG Ground chord with plug (CSA only)
20	1	Connector (CSA Only)

### 4.1 DIMENSIONS (CONTINUED)

Exploded view drawing

Series 7C7 air maintenance compressor assembly with 3/4 HP or 1 HP compressor.

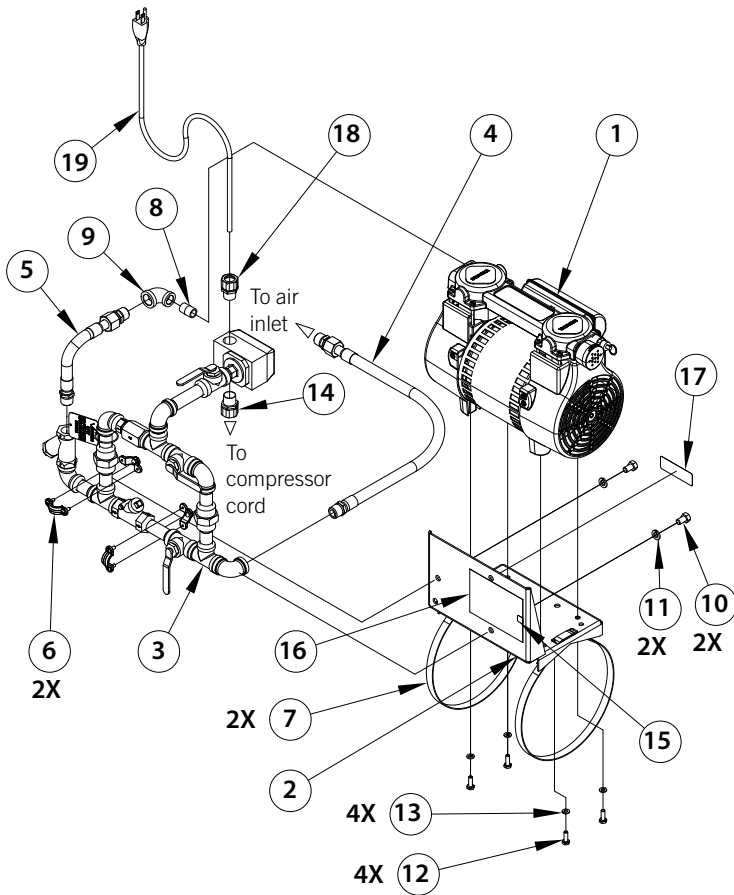

Item	Qty	Description
1	1	Compressor
2	1	Mounting bracket
3	1	Series 757P air maintenance trim with Pressure switch
4	1	Trim hose-26" length
5	1	Trim hose-11" length
6	2	Pipe Hangers
7	2	Hose clamps
8	1	Pipe nipple
9	1	Reducing elbow
10	2	Bolts
11	2	Spring lock washers
12	4	Memory stop washers
13	4	Screws
14	4	Washers
15	1	Cord connector
16	1	Danger/Information Label
17	1	QR Reader Label
18	1	7C7 Compressor, Label
19	1	14 AWG Ground chord with plug (CSA only)
20	1	Connector (CSA Only)

## 5.0 PERFORMANCE

### Assembly Performance (1/6 HP compressor)

**Compressor without AutoVent – Check Valve, 13/18 Pressure Switch – 115V,60HZ**

Time [min]	Pressure		
	13 [psi]	18 [psi]	30 [psi]
0	0	0	0
10	133	92	55
20	265	184	109
30	398	276	164
40	531	368	219
50	663	460	273
60	796	552	328

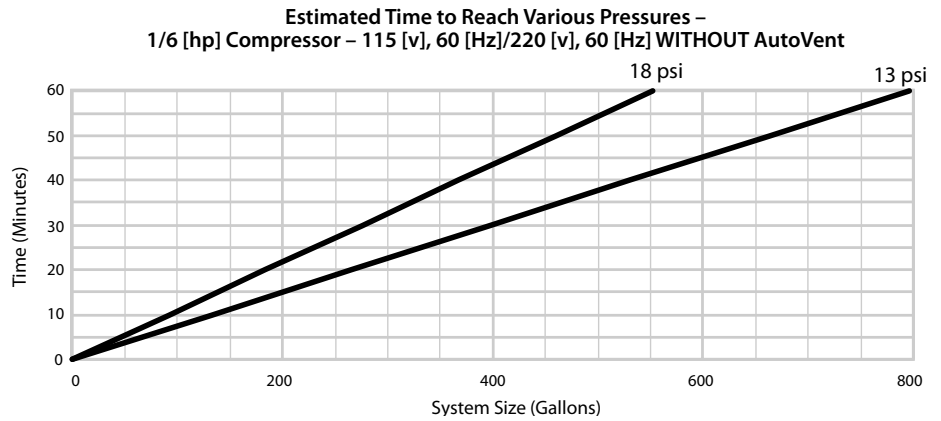

**Compressor with AutoVent – Check Valve, 13/18 Pressure Switch – 115V,60 HZ**

Time [min]	Pressure		
	13 [psi]	18 [psi]	30 [psi]
0	0	0	0
10	90	62	42
20	180	125	85
30	270	187	127
40	360	249	169
50	450	312	212
60	540	374	254

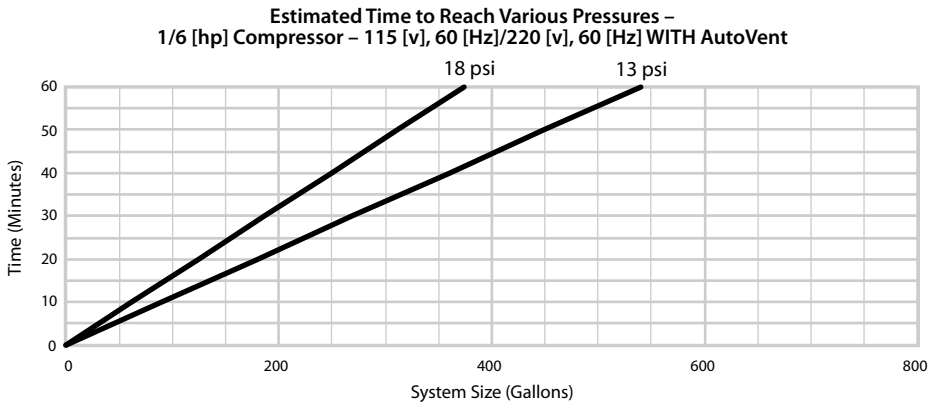

**Compressor without AutoVent – Check Valve, 13/18 Pressure Switch – 230V,50 HZ**

Time [min]	Pressure		
	0.9 [bar]	1.2 [bar]	2.1 [bar]
0	0	0	0
10	478	291	170
20	956	583	341
30	1435	874	511
40	1913	1166	681
50	2391	1457	852
60	2869	1749	1022

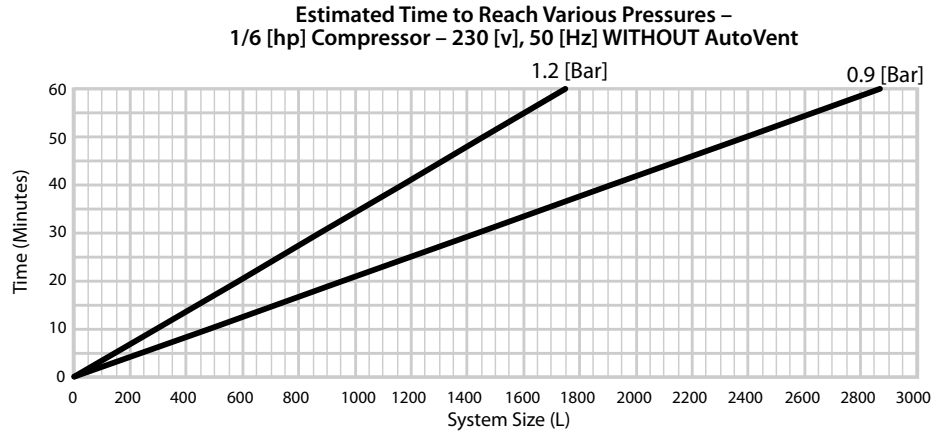

**Compressor with AutoVent – Check Valve, 13/18 Pressure Switch – 230V,50 HZ**

Time [min]	Pressure		
	0.9 [bar]	1.2 [bar]	2.1 [bar]
0	0	0	0
10	290	177	115
20	580	353	230
30	871	530	344
40	1161	707	459
50	1451	883	574
60	1741	1060	689

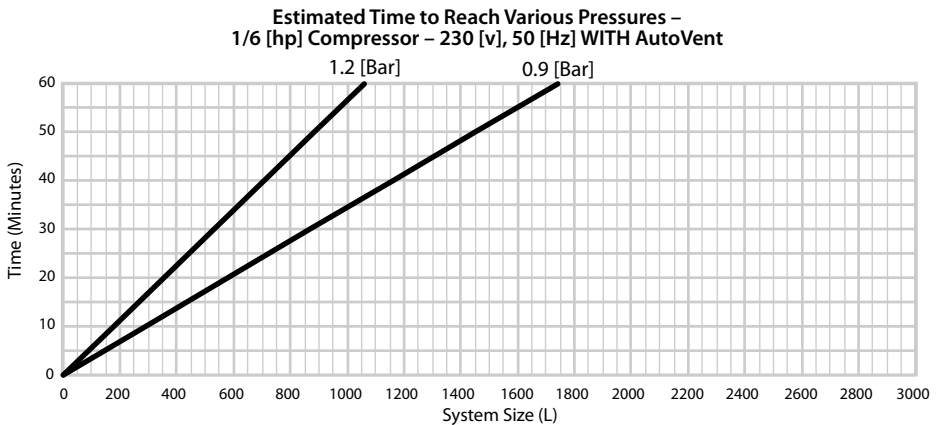

## 5.0 PERFORMANCE (CONTINUED)

### Assembly Performance (1/4 HP compressor)

**Compressor without AutoVent – Check Valve, 13/18 Pressure Switch – 115V,60HZ**

Time [min]	Pressure		
	13 [psi]	18 [psi]	30 [psi]
0	0	0	0
10	195	135	79
20	389	271	158
30	584	406	237
40	779	541	316
50	973	677	395
60	1168	812	474

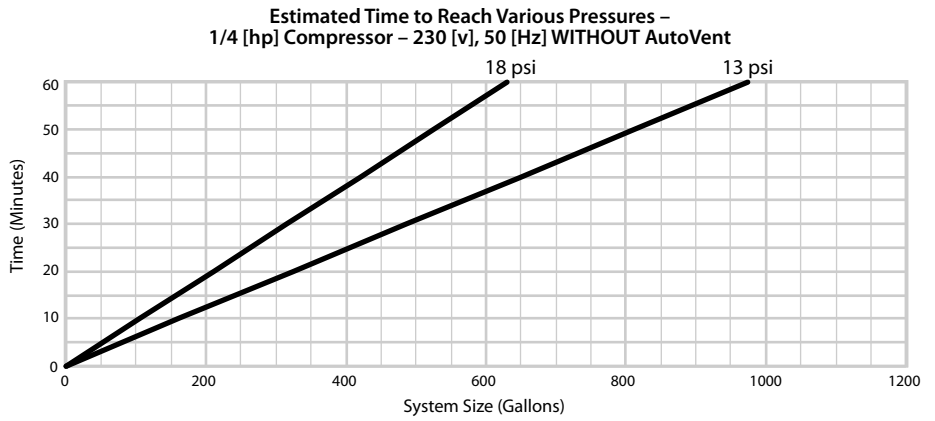

**Compressor with AutoVent – Check Valve, 13/18 Pressure Switch – 115V,60 HZ**

Time [min]	Pressure		
	13 [psi]	18 [psi]	30 [psi]
0	0	0	0
10	123	85	59
20	245	171	118
30	368	256	177
40	491	341	236
50	613	427	295
60	736	512	354

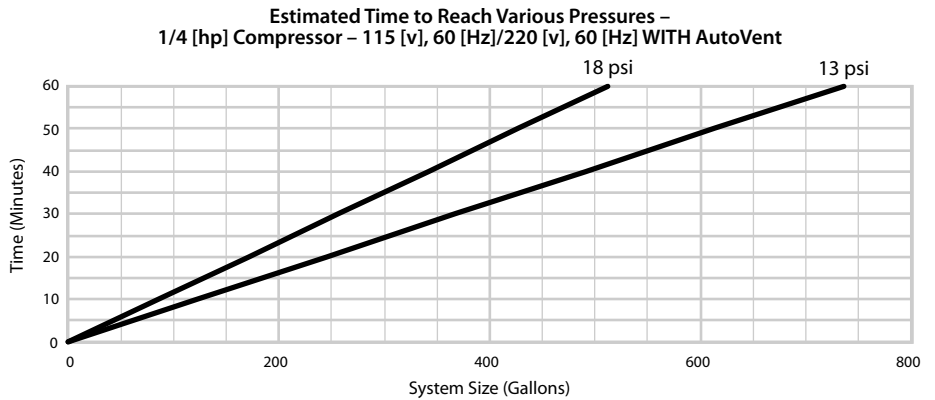

**Compressor without AutoVent – Check Valve, 13/18 Pressure Switch – 230V,50 HZ**

Time [min]	Pressure		
	0.9 [bar]	1.2 [bar]	2.1 [bar]
0	0	0	0
10	614	397	232
20	1229	795	464
30	1843	1192	697
40	2458	1590	929
50	3072	1987	1161
60	3687	2385	1393

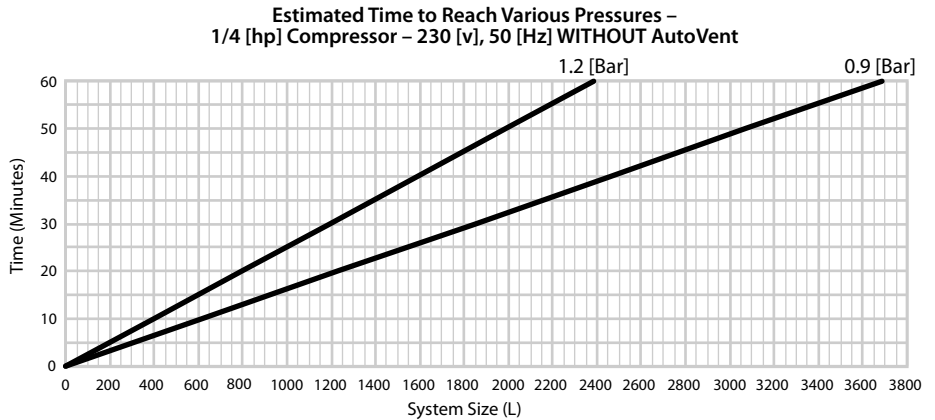

**Compressor with AutoVent – Check Valve, 13/18 Pressure Switch – 230V,50 HZ**

Time [min]	Pressure		
	0.9 [bar]	1.2 [bar]	2.1 [bar]
0	0	0	0
10	390	252	177
20	780	505	353
30	1170	757	530
40	1560	1009	707
50	1949	1262	883
60	2339	1514	1060

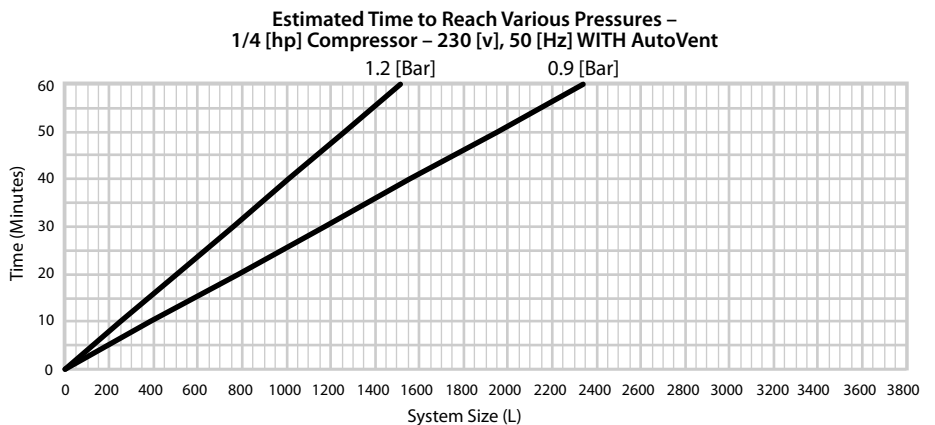

## 5.0 PERFORMANCE (CONTINUED)

### Assembly Performance (1/2 HP Compressor)

**Compressor without AutoVent – Check Valve, 13/18 Pressure Switch – 115V,60 HZ**

Time [min]	Pressure		
	13 [psi]	18 [psi]	30 [psi]
0	0	0	0
10	297	200	113
20	595	400	225
30	892	600	338
40	1189	800	451
50	1487	1000	563
60	1784	1200	676

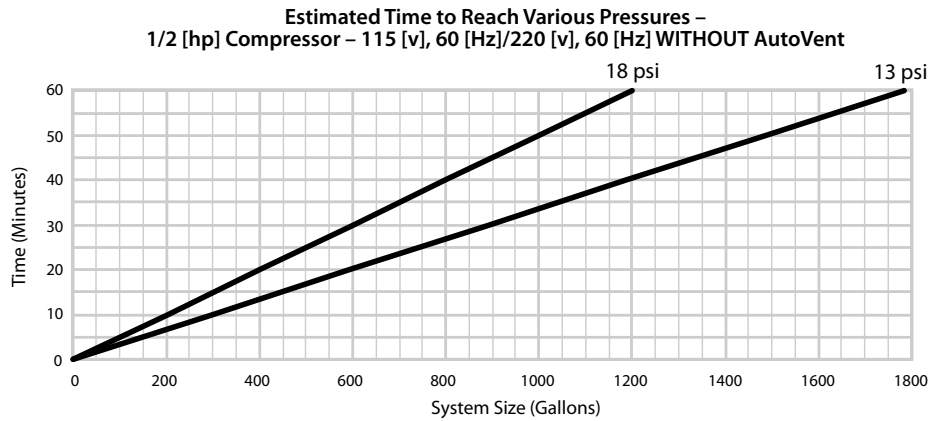

**Compressor with AutoVent – Check Valve, 13/18 Pressure Switch – 115V,60 HZ**

Time [min]	Pressure		
	13 [psi]	18 [psi]	30 [psi]
0	0	0	0
10	226	152	97
20	452	304	194
30	678	456	291
40	904	608	388
50	1130	760	485
60	1356	912	582

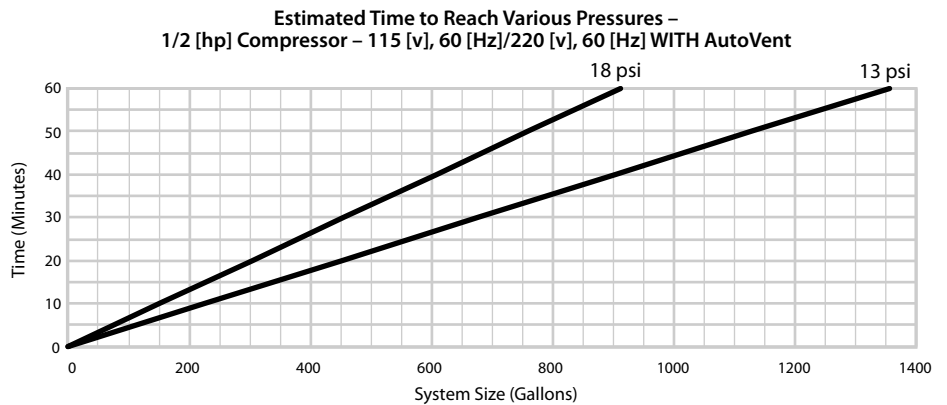

**Compressor without AutoVent – Check Valve, 13/18 Pressure Switch – 230V,50 HZ**

Time [min]	Pressure		
	0.9 [bar]	1.2 [bar]	2.1 [bar]
0	0	0	0
10	898	618	347
20	1797	1237	694
30	2695	1855	1041
40	3594	2473	1388
50	4492	3091	1735
60	5390	3710	2082

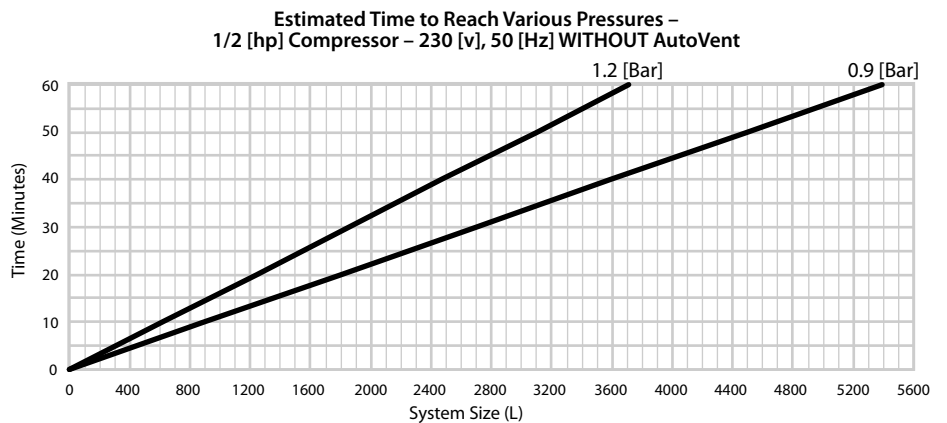

**Compressor with AutoVent – Check Valve, 13/18 Pressure Switch – 230V,50 HZ**

Time [min]	Pressure		
	0.9 [bar]	1.2 [bar]	2.1 [bar]
0	0	0	0
10	606	416	278
20	1211	833	555
30	1817	1249	833
40	2423	1666	1110
50	3028	2082	1388
60	3634	2498	1666

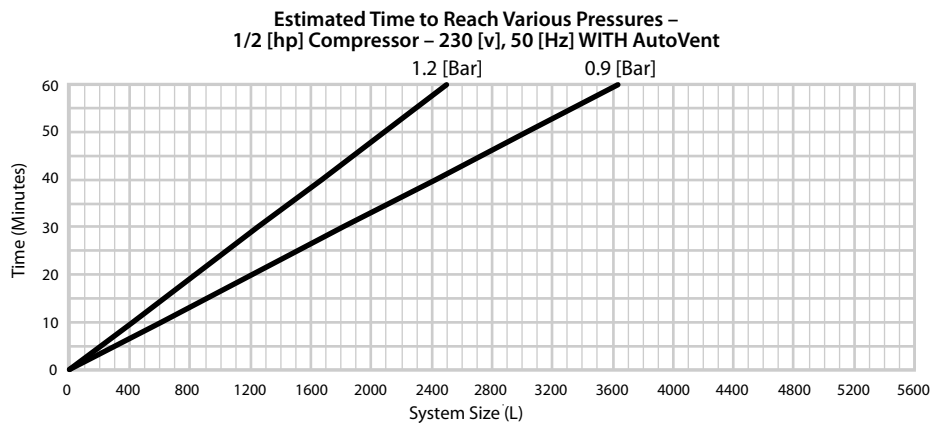

## 5.0 PERFORMANCE (CONTINUED)

### Assembly Performance (3/4 HP Compressor)

**Compressor without AutoVent – Check Valve, 13/18 Pressure Switch – 115V,60HZ**

Time [min]	Pressure		
	13 [psi]	18 [psi]	30 [psi]
0	0	0	0
10	577	280	167
20	1153	560	333
30	1730	840	500
40	2307	1120	667
50	2883	1400	833
60	3460	1680	1000

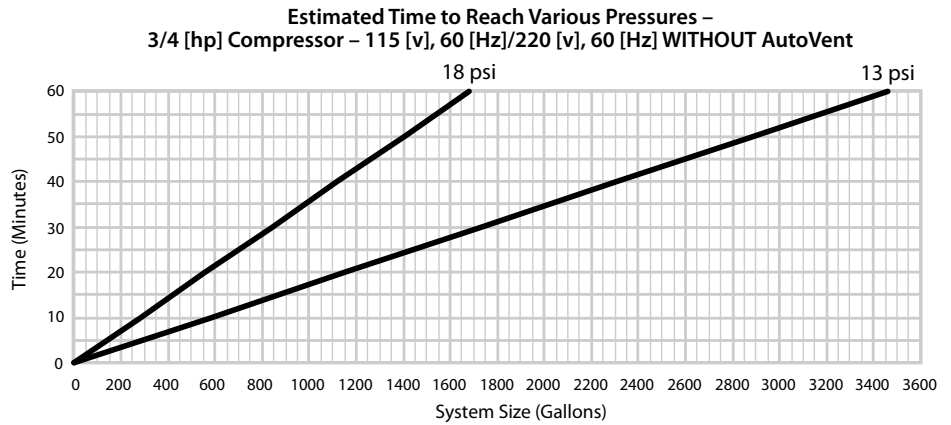

**Compressor with AutoVent – Check Valve, 13/18 Pressure Switch – 115V,60 HZ**

Time [min]	Pressure		
	13 [psi]	18 [psi]	30 [psi]
0	0	0	0
10	463	225	147
20	927	450	293
30	1390	675	440
40	1853	900	587
50	2317	1125	733
60	2780	1350	880

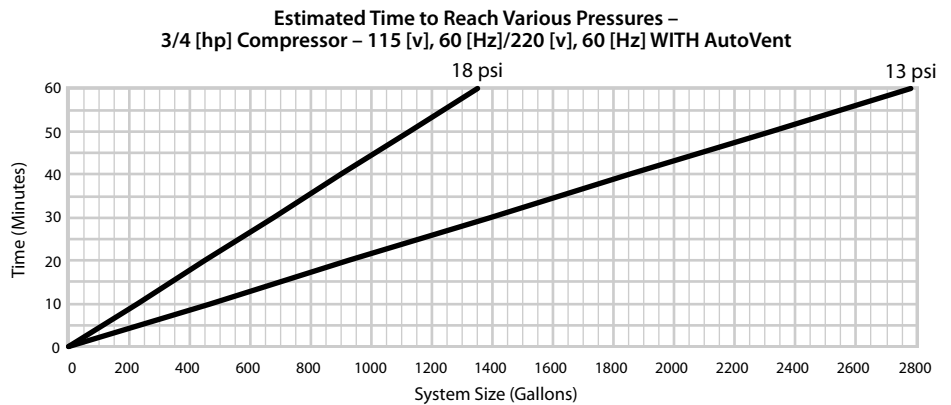

**Compressor without AutoVent – Check Valve, 13/18 Pressure Switch – 230V,50HZ**

Time [min]	Pressure		
	0.9 [bar]	1.2 [bar]	2.1 [bar]
0	0	0	0
10	1812	858	505
20	3624	1716	1009
30	5436	2574	1514
40	7248	3432	2019
50	9060	4290	2524
60	10872	5148	3028

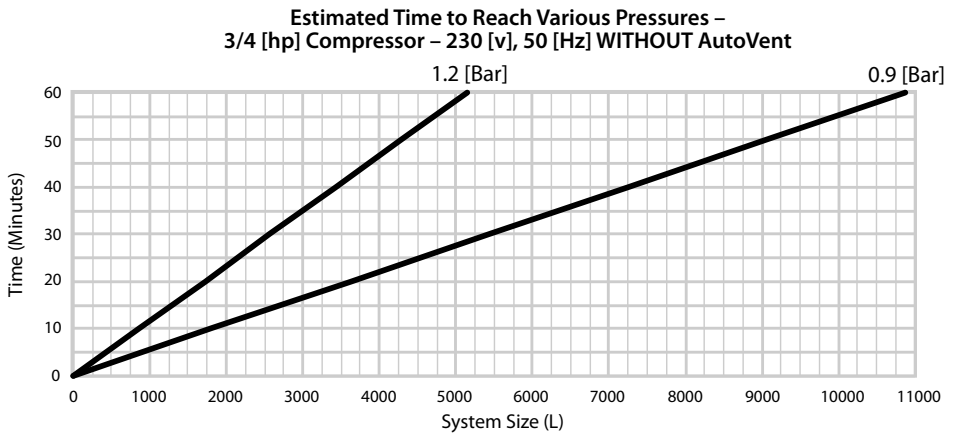

**Compressor with AutoVent – Check Valve, 13/18 Pressure Switch – 230V,50 HZ**

Time [min]	Pressure		
	0.9 [bar]	1.2 [bar]	2.1 [bar]
0	0	0	0
10	1331	631	404
20	2662	1262	808
30	3994	1893	1211
40	5325	2524	1615
50	6656	3155	2019
60	7987	3785	2423

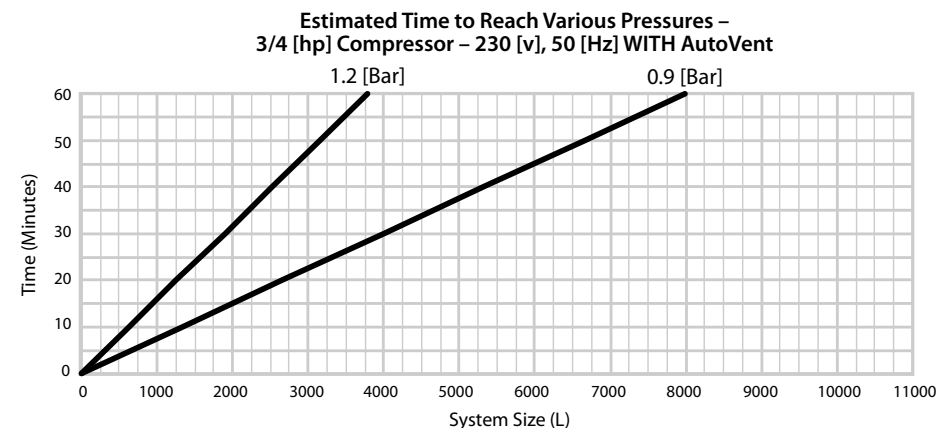

## 5.0 PERFORMANCE (CONTINUED)

### Assembly Performance (1 HP Compressor)

**Compressor without AutoVent – Check Valve, 13/18 Pressure Switch – 115V,60HZ**

Time [min]	Pressure		
	13 [psi]	18 [psi]	30 [psi]
0	0	0	0
10	672	390	230
20	1345	780	460
30	2017	1170	690
40	2689	1560	920
50	3362	1950	1150
60	4034	2340	1380

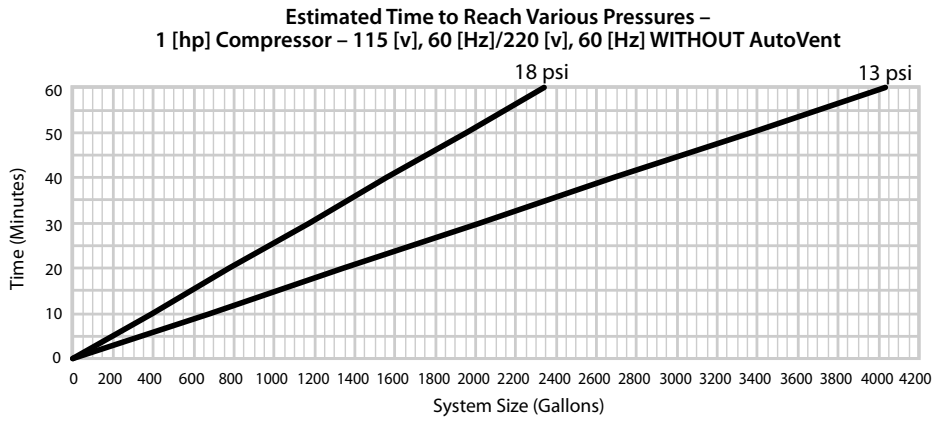

**Compressor with AutoVent – Check Valve, 13/18 Pressure Switch – 115V,60 HZ**

Time [min]	Pressure		
	13 [psi]	18 [psi]	30 [psi]
0	0	0	0
10	586	340	203
20	1172	680	407
30	1758	1020	610
40	2344	1360	813
50	2930	1700	1017
60	3516	2040	1220

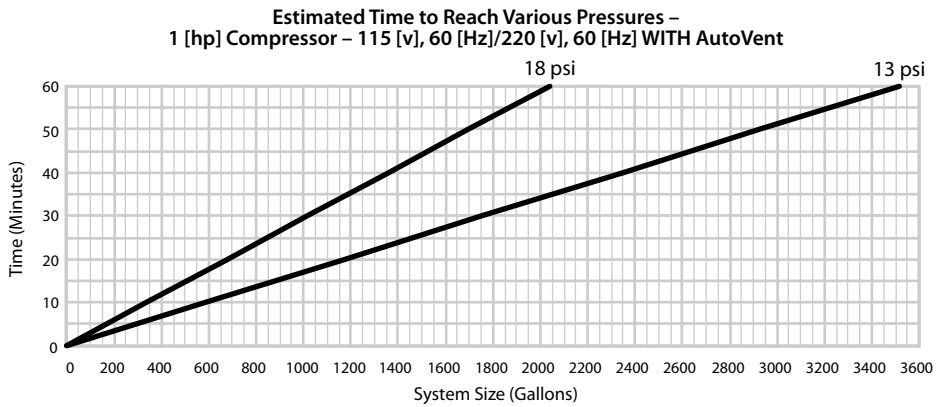

**Compressor without AutoVent – Check Valve, 13/18 Pressure Switch – 230V,50HZ**

Time [min]	Pressure		
	0.9 [bar]	1.2 [bar]	2.1 [bar]
0	0	0	0
10	2112	1186	694
20	4225	2372	1388
30	6337	3558	2082
40	8449	4744	2776
50	10561	5930	3470
60	12674	7117	4164

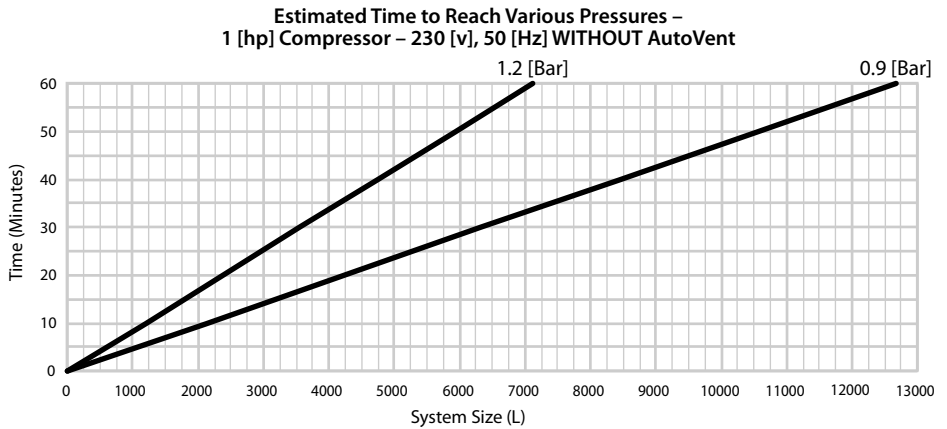





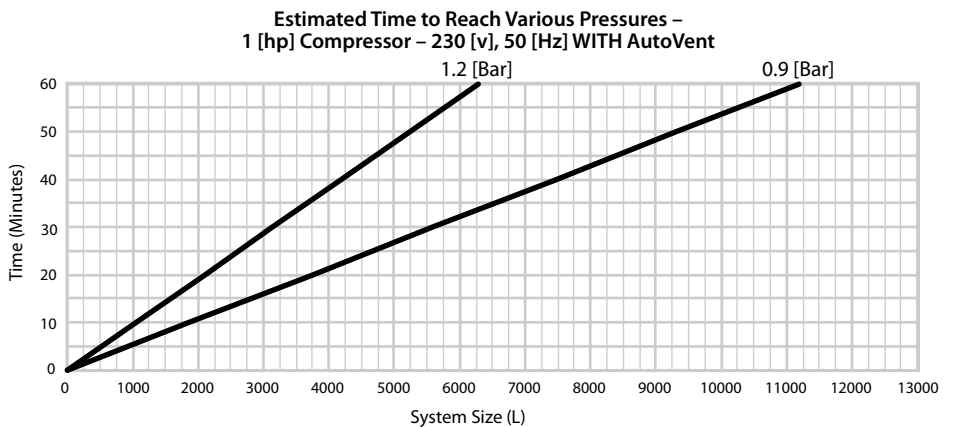

**Compressor with AutoVent – Check Valve, 13/18 Pressure Switch – 230V,50 HZ**

Time [min]	Pressure		
	0.9 [bar]	1.2 [bar]	2.1 [bar]
0	0	0	0
10	1865	1047	618
20	3730	2095	1237
30	5595	3142	1855
40	7460	4189	2473
50	9325	5236	3091
60	11190	6284	3710



## 6.0 NOTIFICATIONS

 <b>WARNING</b>	
    	<ul style="list-style-type: none"> <li>• Read and understand all instructions before attempting to install any Victaulic products.</li> <li>• Always verify that the piping system has been completely depressurized and drained immediately prior to installation, removal, adjustment, or maintenance of any Victaulic products.</li> <li>• Wear safety glasses, hardhat, and foot protection.</li> </ul> <p>Failure to follow these instructions could result in death or serious personal injury and property damage.</p>
<ul style="list-style-type: none"> <li>• These products shall be used only in fire protection systems that are designed and installed in accordance with current, applicable National Fire Protection Association (NFPA 13, 13D, 13R, etc.) standards, or equivalent standards, and in accordance with applicable building and fire codes. These standards and codes contain important information regarding protection of systems from freezing temperatures, corrosion, mechanical damage, etc.</li> <li>• The installer shall understand the use of this product and why it was specified for the particular application.</li> <li>• The installer shall understand common industry safety standards and potential consequences of improper product installation.</li> <li>• It is the system designer's responsibility to verify suitability of materials for use with the intended fluid media within the piping system and external environment.</li> <li>• The material specifier shall evaluate the effect of chemical composition, pH level, operating temperature, chloride level, oxygen level, and flow rate on materials to confirm system life will be acceptable for the intended service.</li> </ul> <p>Failure to follow installation requirements and local and national codes and standards could compromise system integrity or cause system failure, resulting in death or serious personal injury and property damage.</p>	

## 7.0 REFERENCE MATERIALS

- [30.23: FireLock™ Fire-Pac Series 745](#)
- [30.83: Series 764 FireLock NXT™ Alternate Wet/Dry Valve](#)
- [31.80: Series 768N Victaulic® FireLock NXT™ Dry Valve](#)
- [31.81: Series 769N Victaulic® FireLock NXT™ Deluge Valve](#)
- [31.82: Series 769N Victaulic® FireLock NXT™ Preaction Trim](#)
- [I-100: Field Installation Handbook](#)
- [I-7C7 Air Maintenance/Compressor Assembly](#)

### User Responsibility for Product Selection and Suitability

Each user bears final responsibility for making a determination as to the suitability of Victaulic products for a particular end-use application, in accordance with industry standards and project specifications, and the applicable building codes and related regulations as well as Victaulic performance, maintenance, safety, and warning instructions. Nothing in this or any other document, nor any verbal recommendation, advice, or opinion from any Victaulic employee, shall be deemed to alter, vary, supersede, or waive any provision of Victaulic Company's standard conditions of sale, installation guide, or this disclaimer.

### Intellectual Property Rights

No statement contained herein concerning a possible or suggested use of any material, product, service, or design is intended, or should be construed, to grant any license under any patent or other intellectual property right of Victaulic or any of its subsidiaries or affiliates covering such use or design, or as a recommendation for the use of such material, product, service, or design in the infringement of any patent or other intellectual property right. The terms "Patented" or "Patent Pending" refer to design or utility patents or patent applications for articles and/or methods of use in the United States and/or other countries.

### Note

This product shall be manufactured by Victaulic or to Victaulic specifications. All products to be installed in accordance with current Victaulic installation/assembly instructions. Victaulic reserves the right to change product specifications, designs and standard equipment without notice and without incurring obligations.

### Installation

Reference should always be made to I-VICFLEX-AB1-AB2-AB10, I-VICFLEX-AB4, I-VICFLEX-AB7, or I-VICFLEX-AB8 for the product you are installing. Handbooks are included with each shipment of Victaulic products for complete installation and assembly data, and are available in PDF format on our website at [www.victaulic.com](http://www.victaulic.com).

### Warranty

Refer to the Warranty section of the current Price List or contact Victaulic for details.

### Trademarks

*Victaulic* and all other Victaulic marks are the trademarks or registered trademarks of Victaulic Company, and/or its affiliated entities, in the U.S. and/or other countries.