

Victaulic Mover Expansion Joint

Style 150



09.04



1.0 PRODUCT DESCRIPTION

Available Sizes

- 2 – 6"/DN50 – DN150

Maximum Differential Pressure

- 350 psi/2415 kPa/24 bar

Operating Temperature

- Dependent on gasket selection from section 3.0

Function

- Slip-type expansion joint providing up to 3"/76 mm axial end movement
- Expansion joint can be supplied with grooved or plain ends, as specified by the customer
 - For grooved end applications, use Style 07 Zero-Flex™ or Style 107N QuickVic™ rigid couplings
 - For plain end applications, use Style 99 *Roust-A-Bout* couplings

2.0 CERTIFICATION/LISTINGS



ALWAYS REFER TO ANY NOTIFICATIONS AT THE END OF THIS DOCUMENT REGARDING PRODUCT INSTALLATION, MAINTENANCE OR SUPPORT.

System No.		Location	
Submitted By		Date	

Spec Section		Paragraph	
Approved		Date	



3.0 SPECIFICATIONS – MATERIAL

Housing: Ductile iron conforming to ASTM A536, Grade 65-45-12. Ductile iron conforming to ASTM A395, Grade 65-45-15, is available upon special request.

Housing Coating: Orange enamel.

Body, End: Carbon steel, Schedule 40, conforming to ASTM A53, Type E or S, Grade B.

Body/End Coating: Black enamel.

Slide: Schedule 40, cold drawn seamless tubing, conforming to AISI 1015 or 1018.

Slide Coating: Polyphenylene sulfide modified with polytetrafluorethylene (PPS/PTFE).

Gasket: (specify choice¹)

Grade “E” EPDM

EPDM (Green color code). Temperature range –30°F to +230°F/–34°C to +110°C. Recommended for cold and hot water service within the specified temperature range plus a variety of dilute acids, oil-free air and many chemical services. NOT RECOMMENDED FOR PETROLEUM SERVICES.

Grade “T” Nitrile

Nitrile (Orange color code). Temperature range –20°F to +180°F/–29°C to +82°C. Recommended for petroleum products, air with oil vapors, vegetable and mineral oils within the specified temperature range. Not recommended for hot water services over +150°F/+66°C or for hot dry air over +140°F/+60°C.

¹ Services listed are General Service Recommendations only. It should be noted that there are services for which these gaskets are not recommended. Reference should always be made to the latest [Victaulic Seal Selection Guide](#) for specific gasket service recommendations and for a listing of services which are not recommended.

4.0 DIMENSIONS

Style 150 Mover Expansion Joint

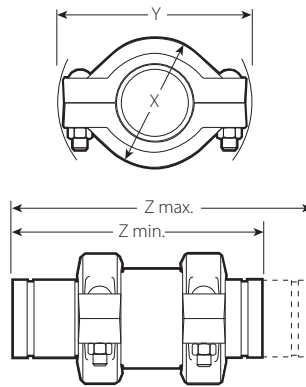

Size		Max. Avail. Movement inches mm	Dimensions				Weight	
Nominal inches DN	Actual Outside Diameter inches mm		Height X inches mm	Width Y inches mm	Length Z		Approximate (Each) lb kg	
					Minimum inches mm	Maximum inches mm		
2 DN50	2.375 60.3	3.00 76.2	3.38 86	5.50 139	11.88 302	14.88 378	15.9 7.2	
DN65	3.000 76.1	3.00 76.2	4.38 111	6.75 171	12.13 308	15.13 384	38.0 17.2	
3 DN80	3.500 88.9	3.00 76.2	4.75 121	7.25 184	12.13 308	15.13 384	25.6 11.6	
4 DN100	4.500 114.3	3.00 76.2	6.25 159	9.00 229	14.13 359	17.13 435	39.6 18.0	
DN125	5.500 139.7	3.00 76.2	6.25 159	9.00 229	14.13 359	17.13 435	56.0 25.4	
5	5.563 141.3	3.00 76.2	7.12 181	10.75 273	14.13 359	17.13 435	55.0 24.9	
	6.500 165.1	3.00 76.2	8.63 219	12.00 305	16.00 406	19.00 483	75.0 34.0	
6 DN150	6.625 168.3	3.00 76.2	8.63 219	12.00 305	16.00 406	19.00 483	75.0 34.0	

5.0 PERFORMANCE

Style 150 Mover Expansion Joint

Size		Max. Work. Pressure
Nominal	Actual Outside Diameter	
inches DN	inches mm	psi kPa
2 DN50	2.375 60.3	350 2415
DN65	3.000 76.1	350 2415
3 DN80	3.500 88.9	350 2415
4 DN100	4.500 114.3	350 2415
DN125	5.500 139.7	350 2415
5	5.563 141.3	350 2415
	6.500 165.1	350 2415
6 DN150	6.625 168.3	350 2415

6.0 NOTIFICATIONS

WARNING

- Read and understand all instructions before attempting to install, remove, adjust, or maintain any Victaulic piping products.
- Always verify that the piping system has been completely depressurized and drained immediately prior to installation, removal, adjustment, or maintenance of any Victaulic products.
- Wear safety glasses, hardhat, and foot protection.

Failure to follow these instructions could result in death or serious personal injury and property damage.

7.0 REFERENCE MATERIALS

- [05.01: Victaulic Seal Selection Guide](#)
- [09.06: Victaulic Expansion Joint Installation Design Data](#)
- [I-100: Victaulic Field Installation Handbook](#)

User Responsibility for Product Selection and Suitability

Each user bears final responsibility for making a determination as to the suitability of Victaulic products for a particular end-use application, in accordance with industry standards and project specifications, and the applicable building codes and related regulations as well as Victaulic performance, maintenance, safety, and warning instructions. Nothing in this or any other document, nor any verbal recommendation, advice, or opinion from any Victaulic employee, shall be deemed to alter, vary, supersede, or waive any provision of Victaulic Company's standard conditions of sale, installation guide, or this disclaimer.

Intellectual Property Rights

No statement contained herein concerning a possible or suggested use of any material, product, service, or design is intended, or should be construed, to grant any license under any patent or other intellectual property right of Victaulic or any of its subsidiaries or affiliates covering such use or design, or as a recommendation for the use of such material, product, service, or design in the infringement of any patent or other intellectual property right. The terms "Patented" or "Patent Pending" refer to design or utility patents or patent applications for articles and/or methods of use in the United States and/or other countries.

Note

This product shall be manufactured by Victaulic or to Victaulic specifications. Victaulic recommends all products to be installed in accordance with current IMI TA installation/assembly instructions. Victaulic and IMI TA reserve the right to change product specifications, designs and standard equipment without notice and without incurring obligations.

Installation

Reference should always be made to the current IMI TA installation/assembly instructions for the product you are installing. For coupling and strainer installation, reference should always be made to the [I-100 Victaulic Field Installation Handbook](#) for the product you are installing. Handbooks are included with each shipment of Victaulic products for complete installation and assembly data, and are available in PDF format on our website at www.victaulic.com

Warranty

Refer to the Warranty section of the current Price List or contact Victaulic for details.

Trademarks

Victaulic and all other Victaulic marks are the trademarks or registered trademarks of Victaulic Company, and/or its affiliated entities, in the U.S. and/or other countries.