

# ProPEX EP elbows

Submittal information

Date submitted :

## Project Information

Job name :	Location :
Engineer :	Date submitted :
Contractor :	Submitted by :
Manufacturer's representative :	Approved by :

## Technical Data

Material	Engineered Polymer
Temp./pressure ratings	73°F (23°C) at 160 psi (11 bar) 180°F (82°C) at 100 psi (6.9 bar) 200°F (93°C) at 80 psi (5.5 bar)

## Product information and application use

ProPEX® engineered polymer (EP) elbows make 90-degree connections for Uponor crosslinked polyethylene (PEX-a) tubing for use in hot and cold domestic potable water systems, residential fire safety and hydronic radiant heating and cooling systems. Each end of the elbow is manufactured with an Uponor ProPEX fitting for connections to Uponor AquaPEX® or Wirsbo hePEX™ tubing.1

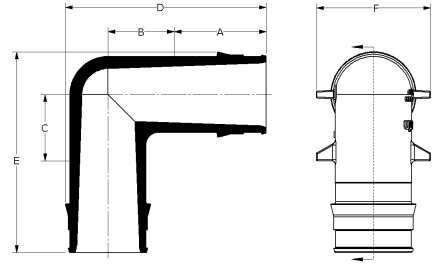

Part name	Part no.	A [inch]	B [inch]	C [inch]	D [inch]	E [inch]	F [inch]	Cv	Weight per UOM [lbs/UOM]	Equivalent length through [ft]	End type 1
ProPEX EP Elbow, 1/2" PEX x 1/2" PEX	Q4760500	0.719	0.55	0.55	1.578	1.578	0.87	2.6	0.02	10.4	ProPEX 1/2"
ProPEX EP Elbow, 3/4" PEX x 3/4" PEX	Q4760750	0.955	0.675	0.675	2.067	2.067	1.22	6.7	0.03	10.8	ProPEX 3/4"
ProPEX EP Elbow, 1" PEX x 1" PEX	Q4761000	1.191	0.86	0.86	2.606	2.606	1.48	11.9	0.07	11.52	ProPEX 1"
ProPEX EP Elbow, 1 1/4" PEX x 1 1/4" PEX	Q4761250	1.455	1.1	1.1	3.236	3.236	1.82	22.2	0.11	10	ProPEX 1-1/4"
ProPEX EP Elbow, 1 1/2" PEX x 1 1/2" PEX	Q4761500	1.714	1.2	1.2	3.661	3.661	2.07	29.7	0.18	11.52	ProPEX 1-1/2"
ProPEX EP 45 Elbow, 1 1/2" PEX x 1 1/2" PEX	Q4761515	1.714	0.6	0.6	2.851	2.07	4.418	33.1	0.13	9.3	ProPEX 1-1/2"
ProPEX EP Elbow, 2" PEX x 2" PEX	Q4762000	2.157	1.6	1.6	4.797	2.82	4.797	50.2	0.3	17.1	ProPEX 2"
ProPEX EP 45 Elbow, 2" PEX x 2" PEX	Q4762020	2.157	0.75	0.75	3.767	2.82	5.634	68.9	0.32	8.8	ProPEX 2"
ProPEX EP Elbow, 2 1/2" PEX x 2 1/2" PEX	Q4762500	2.83	2.1	2.1	6.22	6.22	3.6	86	0.85	20	ProPEX 2-1/2"
ProPEX EP 45 Elbow, 2 1/2" PEX x 2 1/2" PEX	Q4762525	2.83	1	1	4.813	3.6	7.353	136.8	0.65	7	ProPEX 2-1/2"
ProPEX EP Elbow, 3" PEX x 3" PEX	Q4763000	3.38	2.5	2.5	7.417	7.417	4.2	125	1.44	23.2	ProPEX 3"
ProPEX EP 45 Elbow, 3" PEX x 3" PEX	Q4763030	3.38	1.1	1.1	5.68	4.2	8.623	195.5	1.07	8.3	ProPEX 3"

Part name	Part no.	End type 2
ProPEX EP Elbow, 1/2" PEX x 1/2" PEX	Q4760500	ProPEX 1/2"
ProPEX EP Elbow, 3/4" PEX x 3/4" PEX	Q4760750	ProPEX 3/4"
ProPEX EP Elbow, 1" PEX x 1" PEX	Q4761000	ProPEX 1"
ProPEX EP Elbow, 1 1/4" PEX x 1 1/4" PEX	Q4761250	ProPEX 1-1/4"
ProPEX EP Elbow, 1 1/2" PEX x 1 1/2" PEX	Q4761500	ProPEX 1-1/2"
ProPEX EP 45 Elbow, 1 1/2" PEX x 1 1/2" PEX	Q4761515	ProPEX 1-1/2"
ProPEX EP Elbow, 2" PEX x 2" PEX	Q4762000	ProPEX 2"

ProPEX EP 45 Elbow, 2" PEX x 2" PEX	Q4762020	ProPEX 2"
ProPEX EP Elbow, 2 1/2" PEX x 2 1/2" PEX	Q4762500	ProPEX 2-1/2"
ProPEX EP 45 Elbow, 2 1/2" PEX x 2 1/2" PEX	Q4762525	ProPEX 2-1/2"
ProPEX EP Elbow, 3" PEX x 3" PEX	Q4763000	ProPEX 3"
ProPEX EP 45 Elbow, 3" PEX x 3" PEX	Q4763030	ProPEX 3"

Installation	Related applications
Use the appropriate ProPEX ring for PEX-a tubing. Refer to the Uponor Piping Pocket Guide, AquaSAFE™ Residential Fire Sprinkler Installation Guide or Uponor Radiant Installation Handbook for additional information.	PEX-a Plumbing Systems Hydronic Radiant Heating and Cooling Systems Turf Conditioning Systems Permafrost Prevention Systems AquaSAFE™ Fire Safety Systems

Codes	Standards	Listings
IMC UPC IBC IRC IPC NPC of Canada UMC NSPC	ASTM F1960 ASTM E119/UL 263 ASTM E84 ASTM E814/ULC S115 ASTM F877 CSA B137.5 ULC S102.2 NSF-61 ULC S101 NSF-14*	IAPMO-ES ICC-ES-PMG cNSFus-pw UL U.P.Code cQAlus P321 HUD MR 1269*

Trademark Information	Contact information	
ProPEX® is a registered trademark of Uponor Inc. ProPEX™ is a trademark of Uponor Ltd. * Some SKUs in this family have additional codes, standards, or listings. Please see uponor.com for complete information.	Uponor Inc. 5295 148th Street West Apple Valley, MN 55124 T 800.321.4739 F 952.891.2008	Uponor Ltd. 6510 Kennedy Road Mississauga, ON L5T 2X4 T 888.594.7726 F 800.636.9517