



SharkBite[®]

Plumbing Solutions





THE SHARKBITE® CONNECTION SYSTEM

Includes Push-Fit and Barb Products and PEX Tubing

Contents

Introduction	2-3
SharkBite® Push-Fit Fittings	4-6
Stops and Fixture Supply Fittings	7
Push-Fitting Tools	7-8
Valves with Push-Fit Connectors	8-9
Temperature and Pressure Gauges	8
SharkBite® PEX Tubing	9-10
SharkBite® Barb Fittings	10-13
Valves with Barb Connectors	12
Barb Angle & Straight Stops	12
PEX/Barb Accessories	12-14
Clamp and Crimp Tools	14
Applications	15
Certifications	16

INSTALLATION AND DISCONNECTION



EASY INSTALLATION

Ensure the pipe is cut square, using the deburr tool (U702) – remove rough edges/debris and mark the pipe for correct depth. Push pipe and fitting together up to the depth mark.

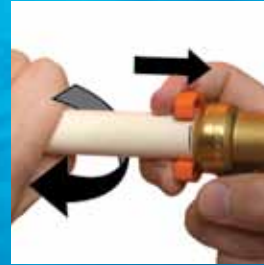

FAST DISASSEMBLY

Using the simple disconnect clip or tongs, fittings can be easily changed and reused.

THE SHARKBITE® CONNECTION SYSTEM

Lightning Fast. Won't Let Go.

- Connects copper, CPVC and PEX pipe in any combination.
- No soldering, clamps, unions or glue.
- Certified to 200 psi and 200°F.
- Certified for underground and behind the wall applications and as a manufactured joint without access panels.
- All SharkBite® Brass Products including, Lead Free, are DZR Brass.
- Certified for potable water and hydronics.
- Integral tube liner for PEX installations.
- Fittings can even be rotated after assembly for easier installation in tight spaces.
- Easy to disconnect if needed.



Reliance Worldwide USA
Phone: **1-877-700-4242**
Fax: **1-877-700-4280**

Reliance Worldwide Canada
Phone: **1-888-820-0120**
Fax: **1-905-265-2775**

SharkBite® Push-Fit Products

SharkBite® continues to lead the industry with an expansive line of fittings, valves and other innovative, labor saving products for plumbing projects. SharkBite® push-fit fittings are the fastest, easiest way to join copper, CPVC and PEX in any combination with no soldering or glue. Certified: 200 psi & 200°F (93°C). Use for new installation and repair of potable water distribution systems. See certifications & approvals on page 16.



Couplings

SIZE	P/N	P/N (Lead Free)
1/4" (3/8" OD)	U004	U004LF
3/8" (1/2" OD)	U006	U006LF
1/2"	U008	U008LF
5/8"	U012	-
3/4"	U016	U016LF
1"	U020	U020LF



Reducing Couplings

SIZE	P/N	P/N (Lead Free)
1/4" (3/8"OD) X 1/2"	U050 NEW	U050LF
3/8" (1/2" OD) X 1/2"	U009	U009LF
3/4" X 5/8"	U057	-
3/4" X 1/2"	U058	U058LF
1" X 3/4"	U060	U060LF



Slip Couplings Only suitable for Copper and CPVC

SIZE	P/N	P/N (Lead Free)
1/2"	U3008	U3008LF
3/4"	U3016	U3016LF
1"	U3020	U3020LF



Polybutylene Conversion Couplings

SIZE	P/N	P/N (Lead Free)
1/2" PB X 1/2" SB	U4008	U4008LF
3/4" PB X 3/4" SB	U4016	U4016LF



Female Connectors

SIZE	P/N	P/N (Lead Free)
1/4" (3/8" OD) X 1/2" FNPT	U066	U066LF
3/8" (1/2" OD) X 1/2" FNPT	U070	U070LF
1/2" X 3/4" FNPT	U068	U068LF
1/2" X 1/2" FNPT	U072	U072LF
3/4" X 3/4" FNPT	U088	U088LF
3/4" X 1/2" FNPT	U092	U092LF
1" X 1" FNPT	U094	U094LF



Male Connectors

SIZE	P/N	P/N (Lead Free)
1/4" X 1/2" MNPT	U110	U110LF
3/8" (1/2" OD) X 1/2" MNPT	U118	U118LF
1/2" X 3/4" MNPT	U116	U116LF
1/2" X 1/2" MNPT	U120	U120LF
5/8" X 3/4" MNPT	U126	-
3/4" X 3/4" MNPT	U134	U134LF
3/4" X 1/2" MNPT	U138	U138LF
3/4" X 1" MNPT	U139	U139LF
1" X 1" MNPT	U140	U140LF
1" X 3/4" MNPT	U142	-



Elbows

SIZE	P/N	P/N (Lead Free)
1/4" (3/8" OD)	U244	U244LF
3/8" (1/2" OD)	U246	U246LF
1/2"	U248	U248LF
5/8"	U252	-
3/4"	U256	U256LF
1"	U260	U260LF



Female Elbows

SIZE	P/N	P/N (Lead Free)
1/4" (3/8"OD) X 3/4" GH	U2276	U2276LF
1/2" X 1/2" FNPT	U308	U308LF
3/4" X 3/4" FNPT	NEW U314	U314LF



Male Elbows

SIZE	P/N	P/N (Lead Free)
1/4" (3/8"OD) X 3/8" MNPT	U276	U276LF
1/2" X 3/8" MNPT	U281	U281LF
1/2" X 1/2" MNPT	U280	U280LF
3/4" X 3/4" MNPT	NEW U286	U286LF



Reducing Elbows

SIZE	P/N	P/N (Lead Free)
1/2" X 3/8"(1/2" OD)	U272	U272LF
3/4" X 5/8"	U273	-
3/4" X 1/2"	U274	U274LF
1" X 3/4"	U278	U278LF



Dishwasher Elbows

SIZE	P/N	P/N (Lead Free)
1/4" X 3/8" MNPT	U276	U276LF
1/4" (3/8" OD) X 3/4" GH	U2276	U2276LF
1/2" X 3/8" MNPT	U281	U281LF



Drop Ear Elbows

SIZE	P/N	P/N (Lead Free)
3/8" (1/2" OD) X 1/2" FNPT	U332	U332LF
1/2"	U249	U249LF
1/2" X 1/2" FNPT	U334	U334LF
3/4" X 3/4" FNPT	U340	U340LF



Female Centre Slip Tees

Slip Run is only suitable for Copper and CPVC

SIZE	P/N	P/N (Lead Free)
1/2" FNPT (SLIP)	U3482	U3482LF
3/4" FNPT	U462	U462LF
3/4" FNPT (SLIP)	U3486	U3486LF
1" FNPT	U464	U464LF



Hy-Ear Elbows

SIZE	P/N	P/N (Lead Free)
1/2" X 1/2" FNPT	U335	U335LF



End Stops

SIZE	P/N	P/N (Lead Free)
3/8" (1/2" OD)	U512	U512LF
1/2"	U514	U514LF
5/8"	U516	-
3/4"	U518	U518LF
1"	U520	U520LF

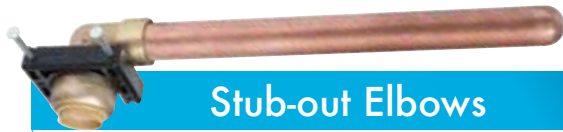

Stub-out Elbows

The NEW SharkBite® STUB-OUT with pre-fitted Mounting Bracket offers 4 fixing positions to all wooden surfaces, studs, joists and subfloor, by simply rotating or repositioning the mounting bracket. Spun closed for pressure testing and like all SharkBite® connections suitable for use on Copper, PEX and CPVC piping systems.

SIZE	P/N	P/N (Lead Free)
1/2" Copper Tube 8" LG	U351A	U351LFA



Threaded Adapters

SIZE	P/N	P/N (Lead Free)
3/4" CTS X 3/4" FNPT	U766	U766LF
1" CTS X 1" FNPT	U772	U772LF



Tees

SIZE	P/N	P/N (Lead Free)
1/4" (3/8" OD)	U358	U358LF
3/8" (1/2" OD)	U360	U360LF
1/2"	U362	U362LF
5/8"	U366	-
3/4"	U370	U370LF
1"	U374	U374LF



Fitting Reducers

(Use to connect to smaller pipe sizes)

SIZE	P/N	P/N (Lead Free)
3/8" (1/2" OD) X 1/2" CTS	U719	U719LF
3/8" (1/2" OD) X 3/4" CTS	U721	U721LF
1/2" X 1" CTS	U722	U722LF
3/4" X 1" CTS	U724	U724LF



Reducing Tees

SIZE	P/N	P/N (Lead Free)
1/2" X 1/2" X 1/4" (3/8" OD)	U359	U359LF
1/2" X 1/2" X 3/8" (1/2" OD)	U363	U363LF
3/8" (1/2" OD) X 3/8" (1/2" OD) X 1/2"	U364	U364LF
3/4" X 3/4" X 1/2"	U412	U412LF
3/4" X 1/2" X 3/4"	U444	U444LF
3/4" X 1/2" X 1/2"	U454	U454LF
1" X 1" X 3/4"	U416	U416LF

Water Hammer Arrestors

Provides maintenance-free, continuous protection against water hammer. Can be positioned vertically or horizontally and the SharkBite® connectors allow the arrestor to be installed in seconds, even on wet pipe.

SIZE	P/N	P/N (Lead Free)
1/2" Residential	22630	22630LF
1/2" Commercial	22631	22631LF
3/4" Residential	22632	22632LF
1" Commercial	22633	22633LF



Slip Tees

Slip Run is only suitable for Copper or CPVC

SIZE	P/N	P/N (Lead Free)
1/2"	U3362	U3362LF
3/4"	U3370	U3370LF

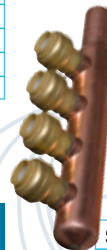

Manifolds with SharkBite® Push-fit Branches

Manifolds are traditionally used in PEX systems, but this new SharkBite® manifold will allow easy incorporation into copper or CPVC systems. Use SharkBite® push fittings to install these manifolds anywhere in a plumbing system. All manifolds have a 1" trunk with 3/4" tube inlets & outlets and 1/2" push-fit ports (2" on center).

SIZE	P/N	P/N (Lead Free)
3 port open	22995	22995LF
3 port closed	22996	22996LF
4 port open	22997	22997LF
4 port closed	22998	22998LF

Slip Fittings

Slip Run is only suitable for Copper or CPVC

Slip fittings simplify repair by doing the job that two couplings and extra pipe used to do. Only one end of the coupling has a stop, allowing the other end to slide freely over the end of a pipe. The fitting can be released with a disconnect tool and slid back onto the other end of the pipe for successful leak repair.



Slip Couplings

Only suitable for Copper and CPVC

SIZE	P/N	P/N (Lead Free)
1/2"	U3008	U3008LF
3/4"	U3016	U3016LF
1"	U3020	U3020LF



Slip Tees

Slip Run is only suitable for Copper or CPVC

SIZE	P/N	P/N (Lead Free)
1/2"	U3362	U3362LF
3/4"	U3370	U3370LF



Service Slip Tee Adapters

Slip Run is only suitable for Copper or CPVC

SIZE	P/N	P/N (Lead Free)
1/2" X 1/2" X 1/2" CTS	U4482	U4482LF



Female Centre Slip Tees

Slip Run is only suitable for Copper and CPVC

SIZE	P/N	P/N (Lead Free)
1/2" FNPT (SLIP)	U3482	U3482LF
3/4" FNPT	U462	U462LF
3/4" FNPT (SLIP)	U3486	U3486LF
1" FNPT	U464	U464LF

Flexible Connectors

The stainless steel braided flexible hose and the rotatability of the SharkBite® fitting allow making connections in tight spaces without additional fitting, soldering or glue. Available with integral ball valve. SharkBite® Flex Hoses for Installation in accessible locations - WATER ONLY.



Water Heater Connectors

SIZE	P/N	P/N (Lead Free)
1/2" X 3/4" FIP, 12"	U3068FLEX12	U3068FLEX12LF
1/2" X 3/4" FIP, 15"	U3068FLEX15	U3068FLEX15LF
1/2" X 3/4" FIP, 18"	U3068FLEX18	U3068FLEX18LF
1/2" X 3/4" FIP, 24"	U3068FLEX24	U3068FLEX24LF
3/4" X 3/4" FIP, 12"	U3088FLEX12	U3088FLEX12LF
3/4" X 3/4" FIP, 15"	U3088FLEX15	U3088FLEX15LF
3/4" X 3/4" FIP, 18"	U3088FLEX18	U3088FLEX18LF
3/4" X 3/4" FIP, 24"	U3088FLEX24	U3088FLEX24LF



Water Heater Connectors with Ball Valves

SIZE	P/N	P/N (Lead Free)
1/2" BV X 3/4" FIP, 18"	U3068FLEX18BV	U3068FLEX18BVLf
3/4" BV X 3/4" FIP, 18"	U3088FLEX18BV	U3088FLEX18BVLf

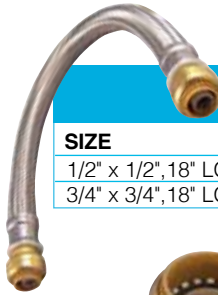

Coupling Hoses

SIZE	P/N	P/N (Lead Free)
1/2" x 1/2", 18" LG	U3008FLEX18	U3008FLEX18LF
3/4" x 3/4", 18" LG	U3016FLEX18	U3016FLEX18LF



Water Heater Installation Kits

Kits include 2 SharkBite® connector fittings and a disconnect clip.

SIZE	P/N	P/N (Lead Free)
1/2" X 3/4" FNPT	22604	22604LF
3/4" X 3/4" FNPT	22441	22441LF

Contractor Kits

These SharkBite® Kits include a variety of push-fit fittings, disconnect tongs and clips, and a sturdy case for storage and transport. SharkBite® Connection System is a revolutionary solution for connecting or repairing water distribution pipe.



Contractor Kits

Includes 2 each: U008, U016, U058, U072, U088, U120, U134, U248 and U256. **1 each:** U362, U370, U514, U518, U710, U711, U713 and U702

SIZE	P/N	P/N (Lead Free)
-	22486	22486LF
Contractor Kit Case Only	U3001	Lead free compliant



Irrigation Kits

Includes 2 each: U016, U020, U134, U140, U256 and U260. **1 each:** U088, U094, U370, U374, U518, U520, U702, U712, U713, U714, U715, U766, U772 and U3016.

SIZE	P/N	P/N (Lead Free)
-	22795	-

Stop & Fixture Supply Fittings

Connecting supply lines to fixtures and appliances using these new SharkBite® products brings the speed and convenience of push-fit connections to the final phase of your plumbing jobs. Regular and chrome plated fittings are now available, including the newest 1/2" X 1/4" (3/8" OD) SharkBite® stop valves. Stops in 1/2" X 3/8" or 1/4" compression sizes are also available. With these new SharkBite® push-fittings, stop valves and the 5' lengths or 50' coils of 1/4" (3/8" OD) PEX tubing it's easy to make risers the exact length needed for connecting fixtures and appliances. No more problems with flexible lines that are too long or too short. Cut. Push. Done. It's easy with SharkBite®.

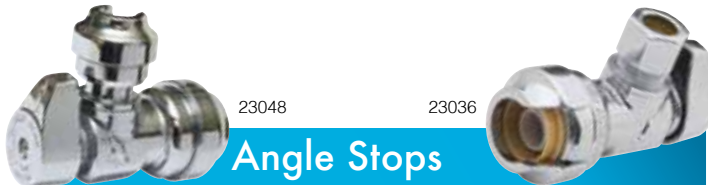

Angle Stops

SIZE	P/N	P/N (Lead Free)
1/2" X 1/4" (3/8" OD)	23048-0000	23048-0000LF
1/2" X 3/8" comp	23036-0000	23036-0000LF
1/2" X 1/4" comp	23336-0000	23336-0000LF
1/2" X 1/2" comp	NEW 23489-0000	Lead free compliant

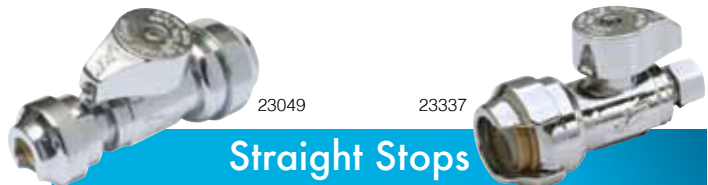

Straight Stops

SIZE	P/N	P/N (Lead Free)
1/2" X 1/4" (3/8" OD)	23049-0000	23049-0000LF
1/2" X 3/8" comp	23037-0000	23037-0000LF
1/2" X 1/4" comp	23337-0000	23337-0000LF
1/2" X 1/2" comp	NEW 23490-0000	Lead free compliant



Stop Valve Connectors

SIZE	P/N	P/N (Lead Free)
1/4" (3/8" OD) X 3/8" compression nut	U3523	U3523LF

Converts 3/8" compression stop to SharkBite®



Stop Valve Tee Adapters

SIZE	P/N	P/N (Lead Free)
1/4" (3/8"OD) X 1/4" (3/8"OD) X 3/8" compression nut	U3358	U3358LF
1/4" (3/8"OD) X 1/4" (3/8" OD) X 1/4" (3/8"OD) tube	U4358	U4358LF



Service Slip Tee Adapters

Slip Run is only suitable for Copper or CPVC

SIZE	P/N	P/N (Lead Free)
1/2" X 1/2" X 1/2" CTS	U4482	U4482LF



Dual Tee Stop Valve Adaptors

Insert onto Stub-Out then fit any of the 8 SharkBite® Stop Valves to create any combination desired.

SIZE	P/N	P/N (Lead Free)
1/2" CTS X 1/2" CTS X 1/2"	U782 NEW	Lead free compliant



Faucet & Toilet Kits

Faucet kits contain 2 connectors, 2 coils of PEX and 2 stops. Toilet kits contain a connector, a straight or angle stop and one 5' coil of 1/4" (3/8" OD) PEX tubing.

SIZE	P/N	P/N (Lead Free)
Faucet w/Angle Stop	23387	Lead free compliant
Faucet w/Straight Stop	23388	Lead free compliant
Toilet w/Angle Stop	23389	Lead free compliant
Toilet w/Straight Stop	23390	Lead free compliant



Faucet Connectors

SIZE	P/N	P/N (Lead Free)
1/4" (3/8" OD) X 1/2" Faucet Valve	U3525	U3525LF



Toilet Connectors

SIZE	P/N	P/N (Lead Free)
1/4" (3/8" OD) X Toilet Valve, Straight	U3531	U3531LF
1/4" (3/8" OD) X Toilet Valve, Elbow	U3537	U3537LF



Safe Seal Tools

Deburring and depth gauge all in one. For 1/4", 3/8", 1/2", 5/8", 3/4" & 1" copper and CPVC pipe.

SIZE	P/N	P/N (Lead Free)
-	U702	Lead free compliant



Disconnect Clips

SIZE	P/N	P/N (Lead Free)
1/4"	U706	Lead free compliant
3/8"	U708	Lead free compliant
1/2"	U710	Lead free compliant
5/8"	U3712	Lead free compliant
3/4"	U712	Lead free compliant
1"	U714	Lead free compliant



Disconnect Tongs

SIZE	P/N	P/N (Lead Free)
1/2"	U711	Lead free compliant
3/4"	U713	Lead free compliant
1"	U715	Lead free compliant

Ball and Check Valves

Full port ball valve now comes with integral SharkBite® connectors for easy installation. The body is composed of highly forged brass and features a single lever control. Use for entire systems, sections or components.



Check Valves

Cash Acme valves with integral or union type SharkBite® push-fit connectors offer a tremendous time and labor saving combination for any plumbing application.

SIZE	P/N	P/N (Lead Free)
1/2"	U2008-0000A	U2008-0000LFA
3/4"	U2016-0000A	U2016-0000LFA
1"	U2020-0000A	U2020-0000LFA



SharkBite® x SharkBite®

SIZE	P/N	P/N (Lead Free)
1/2"	22222-0000	22222-0000LF
3/4"	22185-0000	22185-0000LF
1"	22223-0000	22223-0000LF



SharkBite® x FNPT

SIZE	P/N	P/N (Lead Free)
1/2" X 1/2" FNPT	22182-0000	22182-0000LF
3/4" X 3/4" FNPT	22186-0000	22186-0000LF
1" X 1" FNPT	22187-0000	22187-0000LF



SharkBite® x SharkBite® with Drain/Vent

SIZE	P/N	P/N (Lead Free)
1/2" with drain	22304-0000	-
3/4" with drain	22305-0000	-
1" with drain	22306-0000	-

SharkBite® Gauges

Use to measure or monitor water conditions in water distribution systems. Use for quick push-fit installation as a temporary (reusable) or permanent device in copper, CTS CPVC and PEX plumbing systems.



Pressure Gauges

SIZE	P/N	P/N (Lead Free)
with 1/2" Tee	22770	-
with 3/4" Tee	22772	-
with 1" Tee	22774	-
1/2" Tube Size	22883	-
3/4" Tube Size	22885	-



Temperature Gauges

SIZE	P/N	P/N (Lead Free)
with 1/2" Tee	22771	-
with 3/4" Tee	22773	-
with 1" Tee	22775	-
1/2" Tube Size	22884	-
3/4" Tube Size	22886	-

Regulators

The innovative, labor reducing SoloSet® EB-25, the EB-35, and the EB-45 pressure reducing regulators are available with double union or direct SharkBite® connectors. The EB-25 is set at 45 psi and features a twist cap with a numerical pressure indicator for easy one-man adjustment. The EB-35 is factory set at 45 psi with an adjustment range of 20-90 psi depending on valve size. The EB-45 is factory set at 45 or 60 psi and is adjustable to 10-70 psi.



With SharkBite® Double Unions & 45 psi Set Pressure

SIZE	P/N	P/N (Lead Free)
EB-25 3/4"	22857-0045	-
EB-25 1"	22927-0045	-
EB-35 1/2"	22858-0045	-
EB-35 3/4"	22859-0045	-
EB-35 1"	22928-0045	-
EB-45 1/2"	22860-0045	-
EB-45 3/4"	22861-0045	23252-0045
EB-45 1"	22929-0045	23358-0045



With SharkBite® Direct Connectors

SIZE	P/N	P/N (Lead Free)
EB-35 1/2"	22670-0045	-
EB-35 3/4"	22671-0045	-
EB-35 1"	22672-0045	-
EB-45 1/2"	22673-0045	-
EB-45 3/4"	22674-0045	23394-0045
EB-45 1"	22675-0045	23398-0045



With SharkBite® Double Unions & 60 psi Set Pressure

SIZE	P/N	P/N (Lead Free)
EB-45 3/4"	22950-0060	23395-0060
EB-45 1"	22951-0060	23399-0060



EB-45 Temporary Bypass Kits

Allows for connection to the water supply before pressure regulator installation. A time saving way to flush out all debris and particles from the plumbing system.

SIZE	P/N	P/N (Lead Free)
EB-45 3/4"	22934	-

SharkBite® Thermostatic Valves

Direct or double union SharkBite® push-fit connectors provide a simplified, time and labor saving installation. Heatguard® valves deliver water at a safe 120°F (49°C) or lower from all outlets, while allowing the thermostat to be set at a germ-killing 140°F (60°C) or higher which aids in preventing the growth of legionella bacteria in the water heater. The higher tank temperature means hot water demands can be satisfied longer. Every valve is tested for performance and includes a unique adjuster tool that minimizes tampering with the valve setting. Rugged, simple construction incorporates a precision engineered polymer piston and the latest in thermostatic technology.



Thermostatic Valves with SharkBite® Unions

SIZE	P/N	P/N (Lead Free)
HG-110D 1/2"	24104-0000	24353-0000
HG-110D 3/4"	24105-0000	24358-0000
HG-115H 3/4"	24326-0000	-
HG-115D 3/4"	24328-0000	-
HG-160 1/2"	24343-0000	-
HG-160 3/4"	24345-0000	-



With SharkBite® Unions and Check Valves

SIZE	P/N	P/N (Lead Free)
HG-110D 1/2" with checks	24341-0000	24354-0000
HG-110D 3/4" with checks	24342-0000	24359-0000
HG-115H 3/4" with checks	24327-0000	-
HG-115D 3/4" with checks	24329-0000	-
HG-160 1/2" with checks	24344-0000	-
HG-160 3/4" with checks	24346-0000	-



Integral Connectors for Thermostatic Valves

Includes 3 CTS tailpieces. Use with SharkBite® push-fit fittings to easily connect a Heatguard valve to 1/2" and 3/4" pipe. Heatguard 110-D with gaskets purchased separately.

SIZE	P/N	P/N (Lead Free)
1/2"	24311-0000	-
3/4"	24312-0000	-

SharkBite® PEX Tubing

SharkBite® PEX tubing is a cross-linked polyethylene tubing for a wide range of residential and commercial plumbing applications. Manufactured without an oxygen barrier for potable water systems and with an oxygen barrier for radiant floor and hydronic heating applications. The oxygen diffusion barrier applied to the exterior limits oxygen permeation through the tubing wall in hydronic heating applications which prevents corrosion of ferrous metal parts in the heating system. A repeating SharkBite® imprint pattern provides a visual aid to determine if the tube has been inserted all the way into the SharkBite® Push-Fit Fitting. This feature only works if the tubing is cut between the SharkBite® imprint pattern.



Approvals: The SharkBite® tubing with and without oxygen barrier is approved for use in all model codes in the US and Canada for use in hydronic and potable water systems and is certified to the following standards: ASTM F876, ASTM F877, CSA B137.5 and AWWA C904.

Standard PEX to ASTM F876, F877 - Straight Lengths and Coils

Use for potable water distribution and other water systems. Available in straight lengths and coils in pipe sizes ranging from 1/4" through 1".

DIAMETER 1/4" (3/8" OD) PEX Gray Color

LENGTH	BLACK TEXT
5' straight	U850G5
50' coil	U850G50

DIAMETER 3/8" (1/2"OD) PEX Blue, Red or White

LENGTH	BLUE	RED	WHITE
5' straight	-	-	U855W5
10' straight	-	-	U855W10
50' coil	-	-	U855W50
100' coil	U855B100	U855R100	U855W100

DIAMETER 1/2" PEX Blue, Red or White

LENGTH	BLUE	RED	WHITE
5' straight	U860B5	U860R5	U860W5
10' straight	U860B10	U860R10	U860W10
20' straight	U860B20	U860R20	U860W20
25' coil	U860B25	U860R25	U860W25
50' coil	U860B50	U860R50	U860W50
100' coil	U860B100	U860R100	U860W100
300' coil	U860B300	U860R300	U860W300
500' coil	U860B500	U860R500	U860W500

DIAMETER 3/4" PEX Blue, Red or White

LENGTH	BLUE	RED	WHITE
5' straight	U870B5	U870R5	U870W5
10' straight	U870B10	U870R10	U870W10
20' straight	U870B20	U870R20	U870W20
25' coil	U870B25	U870R25	U870W25
50' coil	U870B50	U870R50	U870W50
100' coil	U870B100	U870R100	U870W100
300' coil	U870B300	U870R300	U870W300
500' coil	U870B500	U870R500	U870W500

DIAMETER 1" PEX Blue, Red or White

LENGTH	BLUE	RED	WHITE
5' straight	U880B5	U880R5	U880W5
10' straight	U880B10	U880R10	U880W10
20' straight	U880B20	U880R20	U880W20
100' coil	U880B100	U880R100	U880W100
300' coil	U880B300	U880R300	U880W300
500' coil	U880B500	U880R500	U880W500

SharkBite® Insulated PEX Tubing

For use in potable water distribution systems. Available in 100 foot coils ranging in size from 3/8" through 1" with closed cell 3/4" thick polyolefin insulation.

LENGTH	SIZE	BLACK TEXT
100' coil	3/8"	U855I100
100' coil	1/2"	U860I100
100' coil	3/4"	U870I100
100' coil	1"	U880I100

SharkBite® Oxygen Barrier PEX Tubing

Use for radiant floor and hydronic heating applications. The oxygen diffusion barrier is applied to the exterior and limits oxygen permeation through the tubing wall in hydronic heating applications. This prevents corrosion of ferrous metal parts in the heating system.

DIAMETER 3/8" (1/2" OD) PEX Oxygen Barrier

LENGTH	BLACK TEXT
100' coil	U855O100
300' coil	U855O300
500' coil	U855O500

DIAMETER 1/2" PEX Oxygen Barrier

LENGTH	BLACK TEXT
20' straight	U860O20
100' coil	U860O100
300' coil	U860O300
500' coil	U860O500
1000' coil	U860O1000

DIAMETER 5/8" PEX Oxygen Barrier

LENGTH	BLACK TEXT
300' coil	U865O300

DIAMETER 3/4" PEX Oxygen Barrier

LENGTH	BLACK TEXT
20' straight	U870O20
100' coil	U870O100
300' coil	U870O300
500' coil	U870O500
1000' coil	U870O1000

DIAMETER 1" PEX Oxygen Barrier

LENGTH	BLACK TEXT
20' straight	U880O20
100' coil	U880O100
300' coil	U880O300
500' coil	U880O500

SharkBite® Reclaimed Water PEX Tubing

For use with gray water, rainwater harvesting and reclaimed water systems only. Available in 100 and 300 foot purple coils ranging in size from 1/2" through 1".

LENGTH	SIZE	PURPLE
100' coil	1/2"	U860P100
300' coil	1/2"	U860P300
100' coil	3/4"	U870P100
300' coil	3/4"	U870P300
100' coil	1"	U880P100
300' coil	1"	U880P300

SharkBite® Fittings/Tube Size Compatibility

Nominal Size of Fitting	Nominal Size of Tubing	Tubing OD Size	Tubing ID Size
1/4"	1/4" CTS	3/8"	0.305"
3/8"	3/8" CTS	1/2"	0.350"
1/2"	1/2" CTS	5/8"	0.475"
5/8"	5/8" CTS	3/4"	0.652"
3/4"	3/4" CTS	7/8"	0.671"
1"	1" CTS	1"	0.885"
1/4" compression	1/4" ACR	1/4"	0.190"
3/8" compression	3/8" ACR	3/8"	0.311"

SharkBite® PEX/Barb Products

The PEX/Barb Connection System includes fittings, manifolds, valves, clamp rings, crimp rings and tools. Plus SharkBite® PEX tubing in sizes and lengths for any job. All PEX/Barb Brass Fittings including LEAD FREE are made from DZR Brass.



Couplings

SIZE	P/N	P/N (Lead Free)
3/8"	UC006	UC006LF
1/2"	UC008	UC008LF
1/2" (5 Pack)	UC008A5	UC008LFA5
5/8"	UC012	UC012LF
3/4"	UC016	UC016LF
3/4" (5 Pack)	UC016A5	UC016LFA5
1"	UC020	UC020LF



Reducing Couplings

SIZE	P/N	P/N (Lead Free)
3/8" X 1/2"	UC009	UC009LF
1/2" X 3/4"	UC058	UC058LF
3/4" X 5/8"	UC057	UC057LF
3/4" X 1"	UC060	UC060LF



Threaded Adapters

SIZE	P/N	P/N (Lead Free)
3/8" X 1/2" MNPT	UC118	UC118LF
1/2" X 3/4" FNPT	UC068	UC068LF
1/2" X 1/2" FNPT	UC072	UC072LF
1/2" X 1/2" MNPT	UC120	UC120LF
1/2" X 3/4" MNPT	UC116	UC116LF
5/8" X 3/4" MNPT	UC126	UC126LF
3/4" X 3/4" FNPT	UC088	UC088LF
3/4" X 3/4" MNPT	UC134	UC134LF
3/4" X 1/2" MNPT	UC138	UC138LF
3/4" X 1" MNPT	UC139	UC139LF
1" X 1" FNPT	UC094	UC094LF
1" X 1" MNPT	UC140	UC140LF
1" X 3/4" MNPT	UC142	UC142LF



Sweat Adapters

SIZE	P/N	P/N (Lead Free)
3/8" X 1/2" Male	UC593	-
1/2" X 1/2" Female	UC600	UC600LF
1/2" X 1/2" Male	UC607	UC607LF
1/2" X 1/2" Male (5 Pack)	UC607A5	UC607LFA5
3/4" X 3/4" Female	UC606	UC606LF
3/4" X 3/4" Male	UC608	UC608LF
1" X 1" Female	UC605	UC605LF
1" X 1" Male	UC609	-



Polybutylene Adapters (with PB Crimp Rings)

SIZE	P/N	P/N (Lead Free)
3/8" X 3/8" PB	UC4006	UC4006LF
1/2" X 1/2" PB	UC4008	UC4008LF
3/4" X 3/4" PB	UC4016	UC4016LF



Tees

SIZE	P/N	P/N (Lead Free)
3/8"	UC360	UC360LF
1/2"	UC362	UC362LF
1/2" (5 Pack)	UC362A5	UC362LFA5
5/8"	UC366	UC366LF [^]
3/4"	UC370	UC370LF
3/4" (5 Pack)	UC370A5	UC370LFA5
1"	UC374	UC374LF



Bullnose Tees

SIZE	P/N	P/N (Lead Free)
1/2" X 1/2" X 3/4"	UC408	UC408LF
3/4" X 3/4" X 1"	UC413	UC413LF



Reducing Tees

SIZE	P/N	P/N (Lead Free)
3/8" X 3/8" X 1/2"	UC364	UC364LF
1/2" X 1/2" X 3/8"	UC363	UC363LF
1/2" X 3/8" X 1/2"	UC434	-
1/2" X 3/8" X 3/8"	UC452	UC452LF
3/4" X 3/4" X 1/2"	UC412	UC412LF
3/4" X 3/4" X 3/8"	UC417	-
3/4" X 1/2" X 3/4"	UC444	UC444LF
3/4" X 1/2" X 1/2"	UC454	UC454LF
1" X 3/4" X 3/4"	UC414	UC414LF
1" X 1" X 1/2"	UC415	UC415LF
1" X 1" X 3/4"	UC416	UC416LF
1" X 3/4" X 1"	UC418	-



Elbows

SIZE	P/N	P/N (Lead Free)
3/8"	UC246	UC246LF
1/2"	UC248	UC248LF
1/2" (5 Pack)	UC248A5	UC248LFA5
1/2" X 1/2" MNPT	UC280	UC280LF
5/8"	UC252	UC252LF [^]
3/4"	UC256	UC256LF
3/4" (5 Pack)	UC256A5	UC256LFA5
1"	UC260	UC260LF



Reducing Elbows

SIZE	P/N	P/N (Lead Free)
1/2" X 3/8"	UC272	UC272LF
3/4" X 1/2"	UC274	UC274LF
3/4" X 5/8"	UC273	UC273LF [^]



Drop Ear Elbows

SIZE	P/N	P/N (Lead Free)
1/2" X 1/2" FNPT	UC334	UC334LF
3/4" X 3/4" FNPT	UC340	UC340LF
3/4" X 3/4" FNPT	UC342	UC342LF



Adapter Elbows

SIZE	P/N	P/N (Lead Free)
1/2" X 3/4" MNPT	UC278	-
3/4" X 3/4" MNPT	UC286	-
3/4" X 3/4" F sweat	UC626	UC626LF
3/4" X 3/4" M sweat	UC628	UC628LF



Swivel Adapters

SIZE	P/N	P/N (Lead Free)
3/8" X 3/8" FNPT	UC527	UC527LF
1/2" X 1/2" FNPT	UC526	UC526LF
1/2" X 1/2" FNPT	UC534	UC534LF
3/4" X 3/4" FNPT	UC530	UC530LF
3/4" X 1" FNPT	UC529	UC529LF
1" X 1" FNPT	UC594	UC594LF



Swivel Elbows

SIZE	P/N	P/N (Lead Free)
3/8" X 1/2" FNPT	UC531	UC531LF
1/2" X 1/2" FNPT	UC532	UC532LF



Swivel Toilet Connectors

SIZE	P/N	P/N (Lead Free)
1/2" X 7/8" straight	UC528	UC528LF
3/8" X 7/8" elbow	23068	-
1/2" X 7/8" elbow	23067	-



Plugs

SIZE	P/N	P/N (Lead Free)
3/8"	UC512	UC512LF
1/2"	UC514	UC514LF
1/2" (5 Pack)	UC514A5	UC514LFA5
5/8"	UC516	UC516LF [^]
3/4"	UC518	UC518LF
3/4" (5 Pack)	UC518A5	UC518LFA5
1"	UC520	UC520LF



Ball Valves with PEX/Barb Ends

SIZE	P/N	P/N (Lead Free)
1/2"	22461	22461LF
3/4"	22462	22462LF
1"	22463	22463LF



Angle Stops

SIZE	P/N	P/N (Lead Free)
1/2" X 3/8" comp	23060	-
1/2" X 3/8" MHT	23064	23064LF



Regulators with PEX/Barb Ends

SIZE	P/N	P/N (Lead Free)
EB-25 3/4"	22865-0045	-
EB-25-400 3/4"	22866-0045	-
EB-25 1"	22867-0045	23140-0045
EB-25-400 1"	22868-0045	-
EB-35 3/4"	22364-0045	-
EB-35 1"	22365-0045	-
EB-45 3/4"	22798-0045	-
EB-45 1"	22799-0045	-



1/4 Turn Straight Stops

SIZE	P/N	P/N (Lead Free)
3/8"	23382	23382LF
1/2" X 3/8" comp	23057	23057LF

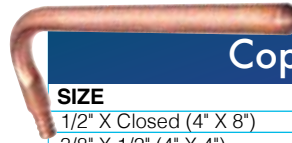

Copper Stubout Elbows

SIZE	P/N	P/N (Lead Free)
1/2" X Closed (4" X 8")	22791	Lead free compliant
3/8" X 1/2" (4" X 4")	23069	Lead free compliant
1/2" X 1/2" (4" X 4")	23070	Lead free compliant



TMV with Barb and Check Valves

SIZE	P/N	P/N (Lead Free)
HG-110-D 1/2" barb with checks	23573-0000	-
HG-110-D 3/4" barb with checks	23574-0000	-

PEX Chrome Plated Stops

The SharkBite® system now includes chrome plated stops for connecting fixture supply lines to PEX tubing. These stops combine PEX/Barb connectors and common supply line connectors into a single fitting.



Straight Stops

SIZE	P/N	P/N (Lead Free)
1/2" X 3/8" comp	23059	-
1/2" X 1/2" MPT	23061	23061LF
1/2" X 3/8"	23062	23062LF
1/2"	23063	23063LF



1/4 Turn Angle Stops

SIZE	P/N	P/N (Lead Free)
1/2" X 1/4" comp	23056	-
1/2" X 3/8" comp	23058	23058LF



1/4 Turn Tee Stops

SIZE	P/N	P/N (Lead Free)
1/2" X 3/8" comp X 3/8" comp	23066	-



Copper Manifolds with Barb Branches

1" Trunk with 3/4" barb inlets & outlets and 1/2" barb ports (2" on center)

SIZE	P/N	P/N (Lead Free)
3 port closed	22783	Lead free compliant
3 port open	22784	Lead free compliant
4 port closed	22785	Lead free compliant
4 port open	22786	Lead free compliant
6 port closed	22787	Lead free compliant
6 port open	22788	Lead free compliant
8 port closed	22789	Lead free compliant
8 port open	22790	Lead free compliant



Barb Manifolds with Ball Valves

SIZE	P/N	P/N (Lead Free)
8 port with Brass Ball Valves	RM22708	-
12 port with Brass Ball Valves	RM22712	-
16 port with Brass Ball Valves	RM22716	-
20 port with Brass Ball Valves	RM22720	-
24 port with Brass Ball Valves	RM22724	-
28 port with Brass Ball Valves	RM22728	-
32 port with Brass Ball Valves	RM22732	-
36 port with Brass Ball Valves	RM22736	-



Polymer Bend Support for PEX pipes

SIZE	P/N	P/N (Lead Free)
1/2" with bracket	23050	Lead free compliant
3/4"	23051	Lead free compliant



Metal Support for PEX pipes

SIZE	P/N	P/N (Lead Free)
1/2"	23053	Lead free compliant
3/4"	23054	Lead free compliant



Polymer Pipe Insulators for PEX

SIZE	P/N	P/N (Lead Free)
1/2" CTS	23074A10	Lead free compliant
3/4" CTS	23075A10	Lead free compliant
1" CTS	23076A10	Lead free compliant



Polymer Insulated Suspension Clamps for PEX

Use for potable water distribution and other water systems. Available in straight lengths and coils in pipe sizes ranging from 1/4" through 1".

SIZE	P/N	P/N (Lead Free)
1/2" CTS	23071A10	Lead free compliant
3/4" CTS	23072A10	Lead free compliant
1" CTS	23073A10	Lead free compliant



J Hooks

SIZE	P/N	P/N (Lead Free)
3/8"	23065	Lead free compliant
1/2"	23220	Lead free compliant
1/2" with concrete nail	24347A	Lead free compliant
3/4"	23221	Lead free compliant
3/4" with concrete nail	24348A	Lead free compliant



Crimp Rings

SIZE	P/N	P/N (Lead Free)
3/8" 100 Pack	23101CP100	Lead free compliant
1/2" 25 Pack	23102CP25	Lead free compliant
1/2" 100 Pack	23102CP100	Lead free compliant
3/4" 25 Pack	23103CP25	Lead free compliant
3/4" 100 Pack	23103CP100	Lead free compliant
1" 25 Pack	23104CP25	Lead free compliant

Polymer Alloy Fittings

Advanced Polymer solution for when corrosion may affect DZR Brass product.



Straight Couplings

SIZE	P/N	P/N (Lead Free)
1/2"	UP008	Lead free compliant
3/4"	UP016	Lead free compliant



Reducing Couplings

SIZE	P/N	P/N (Lead Free)
3/4" X 1/2"	UP058	Lead free compliant



Straight Connectors

SIZE	P/N	P/N (Lead Free)
1/2" X 1/2" MNPT	UP120	Lead free compliant



Reducing Connectors

SIZE	P/N	P/N (Lead Free)
3/4" X 1/2" MNPT	UP138	Lead free compliant



Tees

SIZE	P/N	P/N (Lead Free)
3/8"	UP360	Lead free compliant
1/2"	UP362	Lead free compliant
3/4"	UP370	Lead free compliant
1/2" X 1/2" X 3/4"	UP408	Lead free compliant
3/4" X 3/4" X 1/2"	UP412	Lead free compliant
3/4" X 1/2" X 3/4"	UP444	Lead free compliant
3/4" X 1/2" X 1/2"	UP454	Lead free compliant



Elbows

SIZE	P/N	P/N (Lead Free)
1/2"	UP248	Lead free compliant
1/2" X 1/2" MNPT	UP280	Lead free compliant
3/4"	UP256	Lead free compliant
3/4" X 1/2"	UP274	Lead free compliant



Plugs

SIZE	P/N	P/N (Lead Free)
1/2"	UP514	Lead free compliant
3/4"	UP518	Lead free compliant



Female Swivel Adapters

SIZE	P/N	P/N (Lead Free)
3/8" X 3/8" FNPT	UP527	Lead free compliant
1/2" X 1/2" FNPT	UP526	Lead free compliant



Swivel Elbow Adapters

SIZE	P/N	P/N (Lead Free)
1/2" X 1/2" FNPT	UP532	Lead free compliant



Clamp Rings

SIZE	P/N	P/N (Lead Free)
3/8"	UC952	Lead free compliant
1/2"	UC953	Lead free compliant
5/8"	UC954	Lead free compliant
3/4"	UC955	Lead free compliant
1"	UC956	Lead free compliant



Crimp Ring Gauges

SIZE	P/N	P/N (Lead Free)
3/8", 1/2" & 3/4"	23080	Lead free compliant



PEX Crimp Tools

SIZE	P/N	P/N (Lead Free)
3/8"	23077	Lead free compliant
1/2"	23078	Lead free compliant
3/4"	23079	Lead free compliant
1/2" & 3/4"	23251	Lead free compliant
3/8", 1/2" & 3/4"	23383	Lead free compliant

Note: 23383 Combo Crimp Tool requires using Vise Grips to close the jaws.



Crimp Ring Removal Tools

Use to remove 3/8", 1/2", 3/4" and 1" SharkBite® crimp rings.

SIZE	P/N	P/N (Lead Free)
-	23055	Lead free compliant



PEX Clamp Tools

For use with SharkBite® Barb 3/8", 1/2", 3/4" and 1" fittings and SharkBite® PEX tubing.

SIZE	P/N	P/N (Lead Free)
One-hand Operation	UC961	Lead free compliant
Standard Handles	23081	Lead free compliant



PEX Crimp Ring Tool Kits

Includes Crimp Tool, jaws for 3/8", 1/2", 3/4" and 1" size crimp rings and SharkBite® Barb fittings. And a go-no-go gauge, adjustment tools and case.

SIZE	P/N	P/N (Lead Free)
-	23100	Lead free compliant



PEX Tubing Cutters

Use to cut 1/4", 3/8", 1/2", 3/4" and 1" SharkBite® PEX tubing.

SIZE	P/N	P/N (Lead Free)
-	U701	Lead free compliant

IMPROVE YOUR SKILLS.

SharkBite® Online Training.



www.sharkbite.com/usa/en/how-it-works
[www.youtube.com/sharkbiteplumbing >>>>](http://www.youtube.com/sharkbiteplumbing)



APPLICATIONS



ADD NEW SERVICE LINES AND EQUIPMENT
Use SharkBite® slip tees and other fittings to add a service line or install equipment such as expansion tanks, ice-makers or humidifiers.



WET OR DRY REPAIRS
There's no faster way to make a repair – wet or dry. You can connect copper, CPVC or PEX pipe in any combination. Cut. Push. Done.



WATER HEATER FLEX CONNECTORS
Install or replace a water heater. It's a breeze with SharkBite® flexible connectors or the Water Heater installation kits.



STOPS AND FIXTURE SUPPLY FITTINGS
The SharkBite® system includes a broad range of fittings for installing fixtures and appliances. You can even make custom length risers with SharkBite® 1/4" (3/8" OD) PEX.



HYDRONIC HEATING SYSTEMS
Under the floor or behind a wall, a broad range of SharkBite® push-fit fittings and PEX products gives you confident connections.

IT'S ABOUT TIME

The fastest way to install large bore pipe.

- Quick connect – no tools, soldering or glue
- Quick disconnect – with the innovative Shark Shifter tool
- One person installation
- For use on Copper, PEX and CPVC
- Extensive Range of Fittings and Ball Valves with sizes in 1 1/4", 1 1/2" and 2"



CERTIFICATIONS

The SharkBite® push-fit fittings have been design certified and listed to ASSE 1061/NSF 61. The SharkBite® push-fit fittings are listed by IAPMO and are certified for potable and hydronic heating water distribution (note: Glycol mixture for hydronics is acceptable up to and including 100%). The SharkBite® push-fit fittings have been certified for underground applications and as a manufactured joint without access panels and they meet UPC, IPC and cUPC requirements. Please consult with local plumbing codes concerning specific applications.

The SharkBite® tubing without oxygen barrier is approved for all model codes in the US and Canada for use in potable water systems and is certified to the following standards: ASTM F 876, ASTM F 877, CSA B137.5 and AWWA C904.

The SharkBite® tubing with oxygen barrier is approved for use in all model codes in the US and Canada for use in hydronic and potable water systems and is certified to the following standards: ASTM F 876, ASTM F 877, CSA B137.5 and AWWA C904.

Note: The SharkBite® push-fit fittings are not approved for use with chrome-plated pipe. SharkBite® Polybutylene Couplings are designed to work with ASTM D3309 spec polybutylene, do not install onto damaged or decayed PB pipe.

SharkBite® Fittings / Tube Size Compatibility

Nominal Size of Fitting	Nominal Size of Tubing	Tubing OD Size	Tubing ID Size
1/4"	1/4" CTS	3/8"	0.305"
3/8"	3/8" CTS	1/2"	0.350"
1/2"	1/2" CTS	5/8"	0.475"
5/8"	5/8" CTS	3/4"	0.652"
3/4"	3/4" CTS	7/8"	0.671"
1"	1" CTS	1"	0.885"
1/4" compression	1/4" ACR	1/4"	0.190"
3/8" compression	3/8" ACR	3/8"	0.311"

Note: 1/4" push-fit connector ends require use of 3/8" OD CTS PEX, CPVC or hard drawn Type K, L and M and annealed Type M copper complying with ASTM B 88. SharkBite® connector ends are not approved for use with chrome plated pipe. If it is necessary to use chrome plated tubing, the chrome finish should be completely removed from 1" of the tubing ends.



Reliance Worldwide USA
 2727 Paces Ferry Road SE
 Building Two, Suite 1800
 Atlanta, GA 30339
 1-877-700-4242
 Fax: 1-877-700-4280
 cashacme.com

Reliance Worldwide Canada
 74 Alex Avenue
 Vaughan, Ontario, L4L 5X1
 1-888-820-0120
 Fax: 1-905-265-2775
 cashacme.ca

Distributed by Reliance Worldwide Corporation