



OLYMPIA FAUCETS, INC.
 3325 S. Garfield Ave.
 Commerce, CA 90040
 (888) 772-7701
 www.olympiafaucets.com

INSTALLATION

Tools:



Model Number: P-1131B



Warnings and Notes:

Check with local plumbing code requirements before installation.
 This product should be installed by a local listed plumber.
Do not use plumbers putty on threads.

Installation Steps:

Two Handle Roman Tub Valve Set

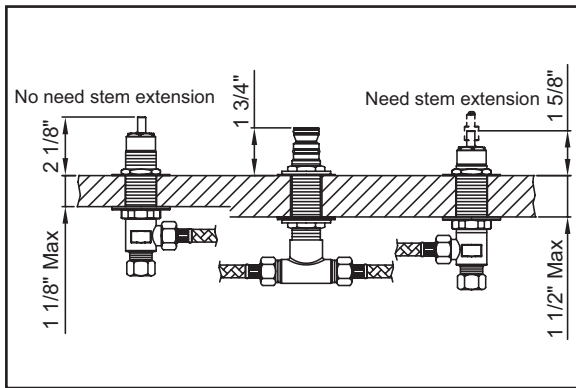

(1) Please refer to the drawing for required valve and shank height from finished surface when install the valve.
 For deck thickness is equal to or less than 1-1/8", you don't need to use stem extension.
 For deck thickness is more than 1-1/8" and up to 1-1/2", you need to use stem extension.

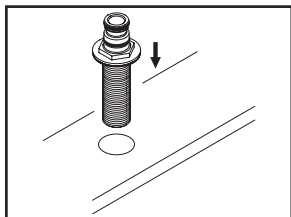

(2) Shut off both water supply lines. Remove test plug from top of the shank. Screw locknut onto shank from the bottom, slide steel washer under locknut and then slide rubber washer under steel washer. Drop shank through spout mounting hole.

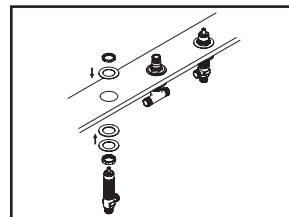

(5) Slide steel washer on valve, insert valve through mounting hole from underneath the deck. Adjust locknut so that the tip of stem is 2-1/8" above finished surface, adjust outlet of the valve to face center to ensure handle operates in proper direction, slide rubber washer, steel washer and tighten locknut from top of the valve. Install the other valve as the same procedure.

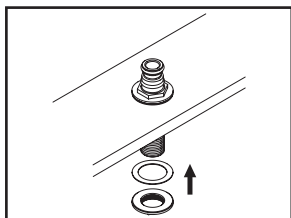

(3) Adjust locknut so that top of the shank is 1-3/4" above finished surface. Slide steel washer and then securely tighten second locknut from bottom of the shank.

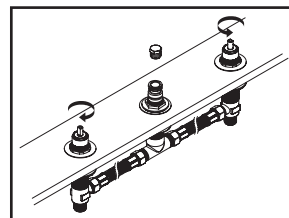

(6) Attach both flex connector hoses to outlet of the valves and "T" connector. Connect water supply lines to inlet of the valves. Apply Teflon tape on thread area of test plug, tighten test plug back to top of the shank. Turn on water supply lines and check for any leaks.

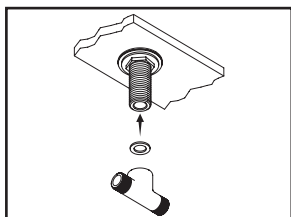

(4) Make sure rubber washer is inside the "T" connector, attach and tighten "T" connector to bottom of the shank.

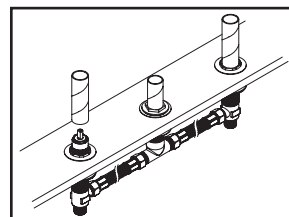

(7) Install mud guard on top of the shank and valves.

Exploded Drawing:

	ITEM #	DESCRIPTION
A	OP-540004	Valve Mounting Kit
B	OP-490006	Bonnet Nut
C	OP-340004C, H	Ceramic Stem-Cold, Hot
D	OP-590001	Supply Nut
E	OP-540006	Shank & Test Plug
F	OP-540005	Spout Mounting Kit
G	OP-440026	"T" Connector & Washer
H	OP-440025	Flex Connector Hose

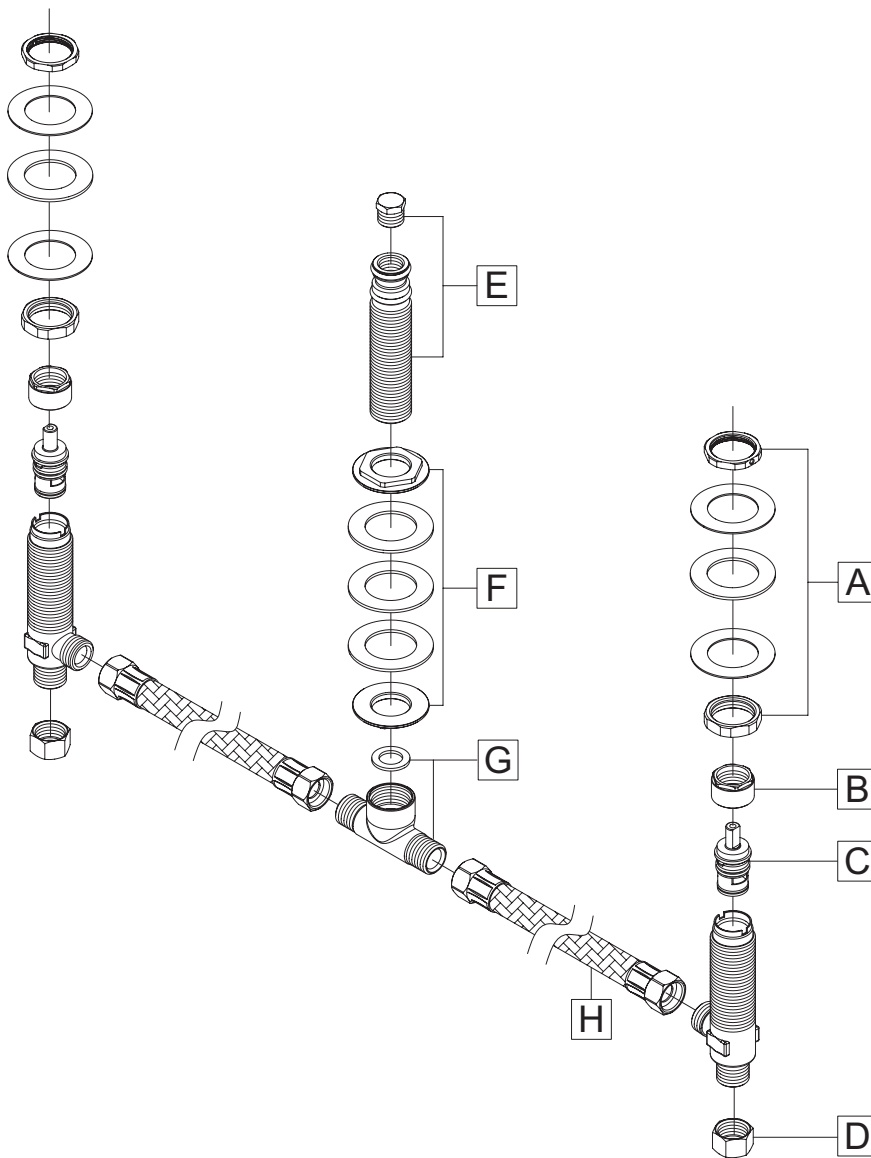

For more care information or trouble shooting inquiries about your Olympia product, Please call:
OLYMPIA FAUCETS, INC. (888) 772-7701
 Monday-Friday 8 AM to 8 PM EST (5 AM to 5 PM PST)
www.olympiafaucets.com