

# NIBCO® PressG



## Submittal Package

Job Name \_\_\_\_\_ Contractor \_\_\_\_\_  
Job Location \_\_\_\_\_ Wholesaler \_\_\_\_\_  
Engineer \_\_\_\_\_ NIBCO Sales Rep \_\_\_\_\_

- |   |  |   |   |
|---|--|---|---|
| <input type="checkbox"/> Heating Fuel Oil | <input type="checkbox"/> Liquid Propane/Butane Gas | <input type="checkbox"/> Natural Gas    | <input type="checkbox"/> Diesel Fuel    |
| <input type="checkbox"/> Compressed Air   | <input type="checkbox"/> Oxygen (non-medical)      | <input type="checkbox"/> Nitrogen       | <input type="checkbox"/> Carbon Dioxide |
| <input type="checkbox"/> Argon            | <input type="checkbox"/> Hydrogen                  | <input type="checkbox"/> Vacuum Systems | <input type="checkbox"/> Lube Oil       |

### PRODUCT DESCRIPTION

NIBCO® PressG copper fittings for use in mechanical applications. The fittings are approved for use with ASTM B88 Type K & L, ASTM B280, and ASTM B837 Type G hard drawn tubing in 1/2" to 2" sizes. In addition, 1/2" and 3/4" sizes are approved for use with annealed tubing in compliance with ASTM B88, ASTM B280, and ASTM B837. When annealed tube is used, rounding and sizing of the tube ends must be performed where needed. PressG fittings are approved for above and below-ground applications (Consult with the local Authority Having Jurisdiction prior to installation).

### STANDARDS AND CODES

- IFGC International Fuel Gas Code
- NFPA 54/Z223.1 National Fuel Gas Code
- NFPA 58 Liquefied Petroleum Gas Code
- UPC Chapter 12 Fuel Piping
- NFPA 30 Flammable and Combustible Liquids Code
- NFPA 30A Code for Motor Fuel Dispensing Facilities and Repair Garages
- NFPA 31 Standard for the Installation of Oil Burning Equipment (supply line only)

### THIRD PARTY LISTINGS AND CERTIFICATIONS

- ANSI LC4/CSA 6.32
- IAPMO/UPC LC-4
- ICC-ES PMG 1502
- American Bureau of Shipping

### OPERATING PARAMETERS

- Operating Pressure: Ranges from 125 to 200 psi max depending on the application
- Air Test Pressure: 15 PSI maximum
- Operating Temperature: -40°F to 180°F

*Visit our website for the most current information.*

NIBCO INC. WORLD HEADQUARTERS • 1516 MIDDLEBURY ST. • ELKHART, IN 46516-4740 • USA • PH: 1.800.234.0227  
TECH SERVICES PH: 1.888.446.4226 • FAX: 1.888.336.4226 • INTERNATIONAL OFFICE PH: +1.574.295.3327 • FAX: +1.574.295.3455  
www.nibco.com

# PressG Fitting Applications Chart

Types of Service	Comments	Pressure	Temperature	Compatible with HNBR Seal
<b>Fuel, Oil and Lubricant</b>				
Heating Fuel Oil		125 PSI	-40°F to 180°F	●
Diesel Fuel	Compliant with NFPA 30 and 30A			●
Liquid Propane Gas, Liquid Butane Gas	Compliant with CSA LC4	125 PSI	-40°F to 180°F	●
Kerosene		125 PSI	68°F	●
Lube Oil		200 PSI	-40°F to 180°F	●

<b>Gases</b>				
Compressed Air		200 PSI		●
Natural Gas	Compliant with CSA LC4	125 PSI	-40°F to 180°F	●
Oxygen - O <sub>2</sub> (non-medical)	Keep Oil and Fat Free/Non-Liquid O <sub>2</sub>	140 PSI	Up to 140°F	●
Nitrogen - N <sub>2</sub>		200 PSI		●
Carbon Dioxide - CO <sub>2</sub>	Dry	200 PSI		●
Argon		200 PSI		●
Cargon		200 PSI		●
Hydrogen - H <sub>2</sub>		125 PSI		●
Vacuum		Max 29.2 inches of Mercury - Hg		●

## Thermal Expansion and Contraction

Thermal expansion and contraction should be accounted for in all system designs. Further guidance on how to account for these stresses can be found in The Copper Development Association's Copper Tube Handbook, Section 3.

Visit our website for the most current information.

# NIBCO® PressG System Approved Tool and Jaw Compatibility Matrix

Pressing tool, jaw and chain sets are an integral part of ensuring a reliable, permanent connection between NIBCO Press System fittings, valves and copper piping. **Only use pressing tools, jaws and chain sets that have been tested and approved for use with NIBCO Press System fittings and valves.**

The following table details compatibility of **approved** pressing tools, chains and jaws with the NIBCO Press System fittings and valves:

PRESSING TOOLS	SIZE	1/2" - 1 1/4"						1/2" - 2"							
		1/2" - 1" NIBCO® Press System Mini Pressing Jaws (PC-1M, PC-2M, PC-3M)	1/2" - 1" RIDGID® ProPress® Compact Pressing Jaws	1/2" - 1-1/4" RIDGID® ProPress® C1 Compact Kit (C1 Actuator & Press Rings)	Rothenberger Compact Pressing Jaws	Stanley® VIRAX® Press Inserts	1/2" - 1 1/4" Milwaukee® M12™ Pressing Jaws	1/2" & 3/4" RIDGID® ProPress® Compact Pressing Jaws	1/2" - 2" NIBCO® Press System Standard Pressing Jaws (PC-10S, PC-11S, PC-12S, PC-13S, PC-14S, PC-15S)	1/2" - 2" RIDGID® ProPress® Standard Pressing Jaws	1/2" - 1-1/4" RIDGID® ProPress® V1 Kit (V1 Actuator & Press Rings)	1/2" - 2" Rothenberger Standard Pressing Jaws	1/2" 2" REMS Standard Pressing Jaws	Stanley® VIRAX® Pressing Jaws	1/2" - 2" Milwaukee® M18® Pressing Jaws
NIBCO® PC-280	—	—	—	—	—	—	—	YES	YES	YES	YES	YES	YES	—	—
NIBCO® PC-100	—	—	—	—	—	—	—	YES	YES	YES	YES	YES	YES	—	—
RIDGID® 320-E	—	—	—	—	—	—	—	YES	YES	YES	—	—	—	—	—
RIDGID® RP 330-B	—	—	—	—	—	—	—	YES	YES	YES	—	—	—	—	—
RIDGID® CT400	—	—	—	—	—	—	—	YES	YES	YES	—	—	—	—	—
RIDGID® RP 330-C	—	—	—	—	—	—	—	YES	YES	YES	—	—	—	—	—
RIDGID® RP 340	—	—	—	—	—	—	—	—	YES	—	—	—	—	—	—
Rothenberger ROMAX® Pressliner	—	—	—	—	—	—	—	—	—	—	YES	—	—	—	—
Rothenberger ROMAX® AC ECO	—	—	—	—	—	—	—	—	—	—	YES	—	—	—	—
REMS Akku-Press	—	—	—	—	—	—	—	—	—	—	—	YES	—	—	—
REMS Power-Press	—	—	—	—	—	—	—	—	—	—	—	YES	—	—	—
Stanley® VIRAX® P20+	—	—	—	—	—	—	—	—	—	—	—	—	YES	—	—
DEWALT DCE200	—	—	—	—	—	—	—	YES	—	—	—	—	—	—	YES
NIBCO® PC-20M Mini	YES	—	—	YES	—	—	—	—	—	—	—	—	—	—	—
NIBCO® PC-10M Mini	YES	—	—	YES	—	—	—	—	—	—	—	—	—	—	—
RIDGID® RP 115	—	—	—	—	—	—	YES	—	—	—	—	—	—	—	—
RIDGID® 100-B Compact	—	YES	YES	—	—	—	—	—	—	—	—	—	—	—	—
RIDGID® RP 210-B Compact	—	YES	YES	—	—	—	—	—	—	—	—	—	—	—	—
RIGID® RP 200-B	—	YES	YES	—	—	—	—	—	—	—	—	—	—	—	—
Rothenberger Compact	YES	—	—	YES	—	—	—	—	—	—	—	—	—	—	—
Stanley® VIRAX® M20+ Compact	—	—	—	—	YES	—	—	—	—	—	—	—	—	—	—
Milwaukee® M12™ Force Logic™	—	—	—	—	—	YES	—	—	—	—	—	—	—	—	—
Milwaukee® M18™ Force Logic-	—	—	—	—	—	—	—	—	—	—	—	—	—	YES	—

For the latest listing of approved pressing tool, jaw and chain combinations, visit [nibco.com](http://nibco.com). NIBCO recommends minor tool service performed once per year and major service every three years. For technical or service assistance, contact NIBCO Technical Services 1-888-446-4226.

RIDGID® is a registered trademark of RIDGID, Inc.

ProPress® is a registered trademark of Viega GmbH & Co

ROMAX® is a registered trademark of ROTHENBERGER

VIRAX® is a registered trademark of Stanley Works

Milwaukee® is a registered trademark of Milwaukee Electric Tool Corporation

FORCE LOGIC™ is a registered trademark of Milwaukee Electric Tool Corporation

DEWALT® is a registered trademark of The Black & Decker Corporation

**CAUTION:**  
NIBCO press fittings and valves (2 1/2", 3", 4" ends) to be installed **ONLY** with NIBCO pressing tools & chains.

Visit our website for the most current information.

# NIBCO PressG™

## 1/2" - 2" Fittings Installation Instructions

For Types K & L hard copper tubing in 1/2" to 2" sizes and annealed copper tubing in 1/2" & 3/4" sizes

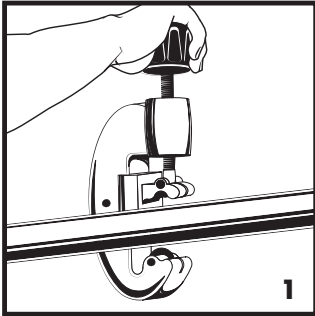

**1.** Select clean, undamaged copper tube and cut to desired length. Cut tube end square using a pipe cutter or fine-toothed steel saw.

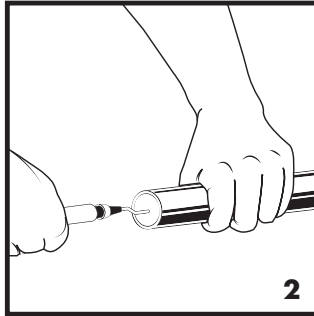

**2.** Deburr the tube inside diameter using a rounded file or a deburring tool.

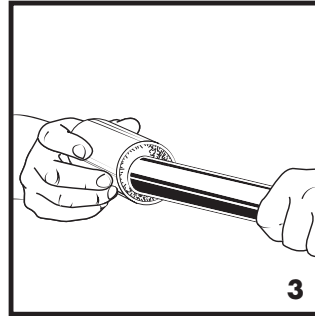

**3.** Deburr the tube outside diameter using a rounded file or a deburring tool. Clean the tube end of all dirt, oil and grease as well as copper dust and chips from sawing.

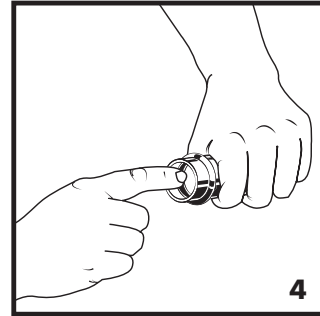

**4.** Check the fitting to make sure that the seal is in place, clean and free of contaminants. Only original NIBCO yellow HNBR seals are to be used. Do not use oils or lubricants.

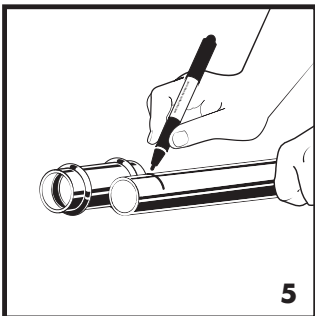

**5.** Mark the tube with the proper insertion depth using a permanent marker as indicated by the Insertion Depth Chart or NIBCO Insertion Depth Tool. Improper insertion depth may result in an improper seal.

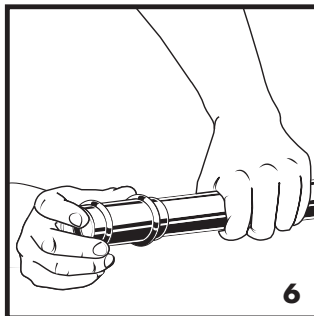

**6.** Insert the tube into the fitting using a twisting motion to the marked depth. NOTE: End of tubing must contact stop.

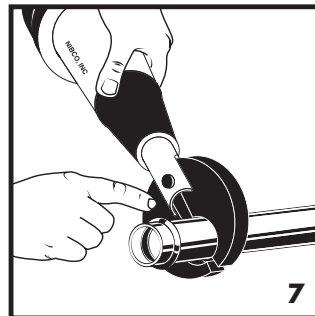

**7.** Ensure that the proper pressing jaws are installed in the pressing tool and squeeze jaw arms to open jaw set. Place open jaws around the fitting end and ensure that the jaw is properly aligned with the contour of the fitting.

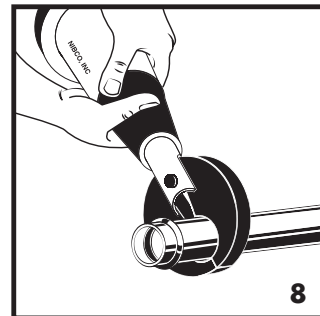

**8.** Make sure the tube is inserted to the proper depth in fitting and with the tool at a right angle to the tube, start pressing procedure.

### Tube Insertion Depth Chart

Tube Size (In.)	Insertion Depth (In.)
1/2	11/16
3/4	7/8
1	7/8
1-1/4	1
1-1/2	1-3/8
2	1-1/2

**Leak Testing:** Unpressed connections are located by pressurizing the system with air. When testing with compressed air the proper maximum pressure is 15 psi. Following a successful leak test, the system may be pressure tested up to 200 psi if required by local code requirements or project specifications. Leak testing with air can be dangerous at high pressures.

**The following standards, codes and instructions should be followed when installing NIBCO PressG fittings for fuel gas:**

- The installation of the fuel gas system shall be in accordance with local codes, or in the absence of local codes, in accordance with the National Fuel Gas Code NFPA 54, the LP-Gas Code NFPA 58 as applicable.
- Copper tubing shall comply with one of the following standards: Type K or L ASTM B88, ASTM B280, or Type G ASTM B837. When annealed tube is used, rounding and sizing of the tube ends must be performed where needed.
- Undue stress or strain on the fittings and the tubing is to be avoided.
- Concealed tubing and fittings shall be protected from puncture threats.
- If the installation requires components in addition to those supplied by the fitting manufacturer, those components shall be specified. The instructions shall state that only the components provided or specified by the manufacturer are to be used in the installation.
- The fitting/tubing system shall not be used as a grounding electrode for an electrical system.
- The inspection, testing and purging of the installation shall be performed using procedures specified in Part 4 of the National Fuel Gas Code NFPA 54, ANSI Z223.1, the LP-Gas Code NFPA 58 section 3.2-10 as applicable or in accordance with the requirements of the applicable local codes.
- For use with natural, propane, mixed and manufactured gasses in the vapor state, not in the liquid state.
- The fitting/tubing system shall not be used as a means of support.

WARNING	MISE EN GARDE !	ADVERTENCIA
Read press tool operator's manual and fitting manufacturer's installation instructions before using. Failure to follow all instructions may result in extensive property damage and/or serious personal injury. Call the NIBCO Technical Service Department at 1.888.446.4226 if you have any questions or need assistance.	Familiarisez-vous avec le mode d'emploi de la presse et les instructions du fabricant des raccords avant d'utiliser l'appareil. Le non-respect de leurs consignes risquerait d'augmenter les risques de dégâts matériels importants et/ou de graves blessures corporelles. Veuillez adresser toutes questions éventuelles ou demandes de mode d'emploi à la NIBCO en composant le 1.888.446.4226.	Antes de usar, lea el Manual del Operario de esta herramienta de presión y las instrucciones de instalación del acoplamiento proporcionadas por su fabricante. Pueden ocurrir daños materiales de gran envergadura y lesiones corporales de gravedad si no se respetan todas las instrucciones. Si tiene alguna pregunta o desea pedir un manual, llame al Departamento de Servicio Técnico de NIBCO al 1.888.446.4226.

Visit our website for the most current information.

# NIBCO® Press System — Installation Instructions

## Minimum Distance Between Joints

To prevent distortion of the tubing, certain fitting sizes require a minimum distance between crimp joints (refer to *Chart 1* below). Failure to provide this minimum distance may result in an improper seal.

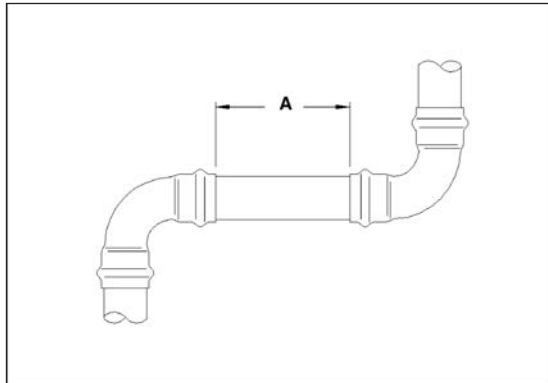

Tube Dia.	A (min.)	
	Inches	mm
1/2**	0	0
3/4**	0	0
1**	0	0
1 1/2**	0	0
1 1/2**	0	0
2**	0	0
2 1/2"	3/8"	10
3"	3/8"	10
4"	3/8"	10

\*No minimum distance required.

## System Support

**CAUTION** — In any installation, the system should be supported to ensure the minimum stress is imposed on the tube and joints. The NIBCO® Press System should be supported in accordance with normal practice and to local jurisdiction piping code.

## Annealing of Copper Tube

A NIBCO Press System installation should not be conducted within 12" of a **brazed** joint. The high temperature required for capillary joinery may cause the copper tube to become annealed and render it too soft for proper crimping. However, a NIBCO Press System product may be crimped adjacent to a **soldered** joint, as normal temperatures created by silver soldering are not hot enough to cause the copper tube to become annealed.

**CAUTION** — Brazing or soldering should not be conducted within 12" of an existing NIBCO Press System connection as this may damage the HNBR seal. If there is any concern about heat damage to the o-ring, a cold, wet cloth should be wrapped around the crimped connection prior to soldering or brazing.

## Spacing

1. Sufficient clearance must be left around each joint to allow room for the pressing tool and jaw to be attached without interference.

Clearance Requirements — Standard Jaw Sets

### Tool perpendicular to wall

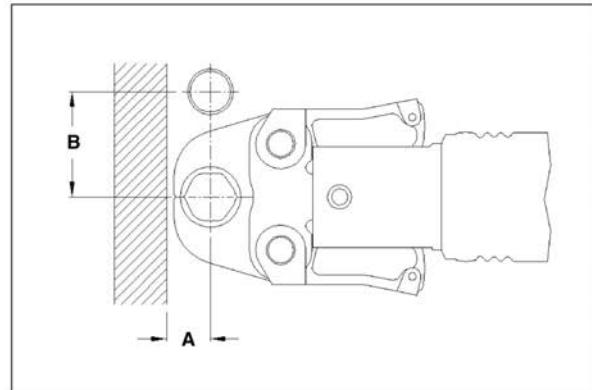

Tube Dia.	A (min.)		B (min.)	
	Inches	mm	Inches	mm
1/2	15/16	24	1 5/8	41
3/4	7/8	22	2 1/8	54
1	1 1/4	31	2 1/2	64
1 1/4	1 1/8	29	2 7/8	73
1 1/2	2	51	4 3/8	111
2	2	51	4 3/8	111

### Tool angled to wall

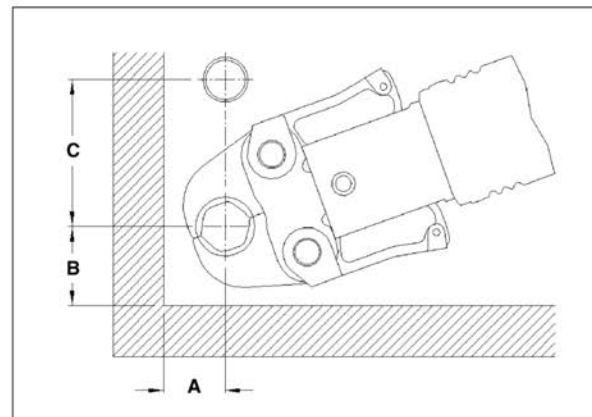

Tube Dia.	A (min.)		B (min.)		C (min.)	
	Inches	mm	Inches	mm	Inches	mm
1/2	1 1/8	28	1 3/8	35	2 1/2	64
3/4	1	26	1 1/2	38	2 1/2	64
1	1 5/16	34	1 3/4	45	3	76
1 1/4	1 1/4	32	2 1/4	57	3 1/8	80
1 1/2	2 1/8	54	3 1/8	80	5	127
2	2 1/8	54	3 1/8	80	5	127

Visit our website for the most current information.

# NIBCO® PressG™ Limited Warranty

## NIBCO INC. LIMITED WARRANTY

Applicable to NIBCO PressG

NIBCO INC. warrants each NIBCO PressG System fitting to be free from defects in materials and workmanship under normal use, service, and maintenance in accordance with the product specifications (including, but not limited to installation recommendations) for a period of twenty-five (25) years from the Warranty Commencement Date. The Warranty Commencement Date shall be the date of installation.

NIBCO Press System tools to be free from defects in materials and workmanship under normal use, service, and maintenance in accordance with the product specifications for a period of two (2) years from the date of purchase.

NIBCO PressG System fittings and tools are referred to herein as "NIBCO Products."

NIBCO will repair or replace – at its option and at no charge – NIBCO Products that have been determined by NIBCO, or an authorized representative or agent thereof, to have failed solely because of a defect in materials or workmanship under normal use, service, and maintenance during the warranty period. Replacements shall be shipped free of charge to the owner.

This limited warranty applies to all NIBCO Products installed, tested, applied, and used in accordance with NIBCO's approved and published recommendations and instructions.

This warranty does not cover any failure or damage for or caused by:

1. any product, parts, or systems which are not manufactured or sold by NIBCO;
2. any NIBCO Product which is used for purposes other than a purpose authorized by NIBCO;
3. any NIBCO Product not installed, tested, applied, used, or maintained in accordance with NIBCO's recommended installation guidelines and instructions;
4. any NIBCO Product not installed or used in accordance with applicable codes;
5. any damage caused by, contributed in whole or in part by, or resulting from, any of the following:
  - a. abuse, misuse, mishandling, alteration, tampering, neglect, or accidental damage such as, without limitation, vandalism;
  - b. natural disasters, such as, without limitation, flooding, windstorm, and lightning;
  - c. attachments or modifications not authorized by NIBCO;
  - d. external, physical or chemical qualities, or an unsuitable or hostile environment,;
  - e. any defects other than those in material or workmanship; or
  - f. any other cause beyond the control of NIBCO.

NIBCO DISCLAIMS ANY AND ALL LIABILITY FOR ANY OTHER DIRECT OR INDIRECT, INCIDENTAL, OR CONSEQUENTIAL DAMAGES OF ANY KIND, INCLUDING BUT NOT LIMITED TO, ECONOMIC LOSS, LOSS OF BUSINESS, LOST PROFITS, PUNITIVE DAMAGES, MOLD INTRUSION, WATER DAMAGE, ETC.

Some states do not allow the exclusion or limitation of damages, so the above limitation or exclusion may not apply to you.

THIS WARRANTY IS THE ONLY WARRANTY FOR THE NIBCO PRODUCTS PROVIDED BY NIBCO, AND IS AND SHALL BE IN LIEU OF ANY AND ALL OTHER WARRANTIES, EXPRESSED OR IMPLIED, INCLUDING, BUT NOT LIMITED TO, AN IMPLIED WARRANTY OF MERCHANTABILITY OR FITNESS FOR A PARTICULAR PURPOSE, AND FOR ALL OTHER OBLIGATIONS OR LIABILITIES ON THE PART OF A MANUFACTURER. NO EMPLOYEE OF NIBCO, OR ANY OTHER DISTRIBUTOR, AGENT, OR OTHER PERSON OR BUSINESS, IS AUTHORIZED TO MAKE ANY OTHER WARRANTY ON BEHALF OF NIBCO.

Some states do not allow limitations on implied warranties, so the above limitation may not apply to you.

In the event any defect occurs which is believed to be covered by this warranty, NIBCO Technical Services must immediately be contacted by calling 888.446.4226 or emailing CS-TechnicalServices@nibco.com. NIBCO Technical Services after being contacted will make further arrangements for the product's return to NIBCO at the customer's expense for review and evaluation.

This warranty gives you specific legal rights, and you may also have other rights which vary from state to state.



Visit our website for the most current information.

## ADAPTERS

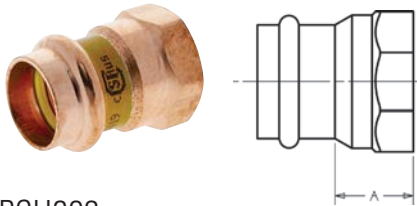

**PCH603**  
Adapter P x F – Wrot

NOM. SIZE	APPROX. NET WT./LBS.	DIM. A INCHES
1/2	.103	13/16
1/2 x 3/8	.081	21/32
3/4	.159	27/32
1	.237	15/16
1 1/4	.374	11/16
1 1/2	.522	11/16
2	.672	1

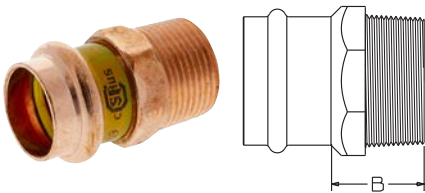

**PCH604**  
Adapter P x M – Wrot

NOM. SIZE	APPROX. NET WT./LBS.	DIM. B INCHES
1/2	.104	7/8
1/2 x 3/8	.106	27/32
3/4	.180	11/16
1	.255	13/32
1 1/4	.467	113/32
1 1/2	.696	11/2
2	.856	17/16

## CAPS

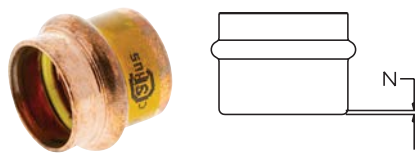

**PCH617**  
Cap P – Wrot

NOM. SIZE	APPROX. NET WT./LBS.	DIM. N INCHES
1/2	.046	5/32
3/4	.087	5/32
1	.124	1/8
1 1/4	.168	3/32
1 1/2	.326	3/32
2	.475	3/32

## COUPLINGS

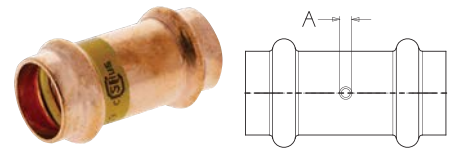

**PCH600-DS**  
Coupling P x P – Wrot

NOM. SIZE	APPROX. NET WT./LBS.	DIM. A INCHES
1/2	.083	3/16
3/4	.157	5/32
1	.198	5/32
1 1/4	.271	5/32
1 1/2	.530	3/16
2	.691	5/32

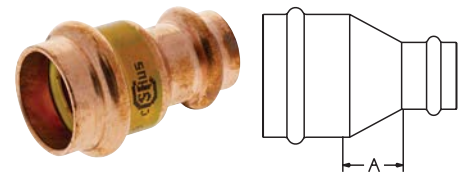

**PCH600-R**  
Reducing Coupling P x P – Wrot

NOM. SIZE	APPROX. NET WT./LBS.	DIM. A INCHES
3/4 x 1/2	.121	1/4
1 x 1/2	.142	7/16
1 x 3/4	.184	13/32
1 1/4 x 3/4	.248	1/2
1 1/4 x 1	.233	7/16
1 1/2 x 1	.370	13/32
1 1/2 x 1 1/4	.399	9/32
2 x 1	.552	11/16
2 x 1 1/2	.662	7/16

Visit our website for the most current information.

**ELBOWS**

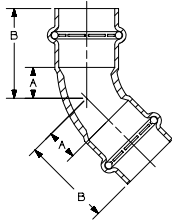

**PCH606**  
45° Elbow P x P – Wrot

NOM. SIZE	APPROX. NET WT./LBS.	DIM. A INCHES	DIM. B INCHES
1/2	.092	13/32	1 1/8
3/4	.181	1/2	1 13/32
1	.251	5/8	1 1/2
1 1/4	.403	25/32	1 25/32
1 1/2	.723	15/16	2 5/16
2	1.063	1 3/16	2 23/32

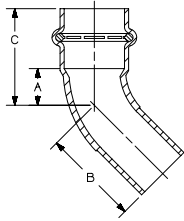

**PCH606-2**  
45° Elbow Ftg x P – Wrot

NOM. SIZE	APPROX. NET WT. LBS.	DIMENSIONS INCHES		
		A	B	C
1/2	.094	7/16	1 5/16	1 1/8
3/4	.171	17/32	1 13/32	1 13/32
1	.270	9/16	1 17/32	1 7/16
1 1/4	.417	1 1/16	1 3/4	1 11/16
1 1/2	.719	1 13/16	2 5/16	2 3/16
2	1.031	1	2 21/32	2 1/2

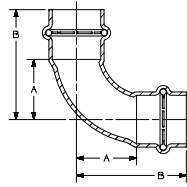

**PCH607**  
90° Elbow P x P – Wrot

NOM. SIZE	APPROX. NET WT./LBS.	DIM. A INCHES	DIM. B INCHES
1/2	.116	23/32	1 15/32
3/4	.223	1 3/32	2
3/4 x 1/2	.201	1 5/32	2
1	.331	1 15/32	2 11/16
1 x 3/4	.321	1 5/16	2 5/16
1 1/4	.528	1 27/32	2 29/32
1 1/2	.895	2 7/32	3 21/32
2	1.480	2 15/16	4 15/32

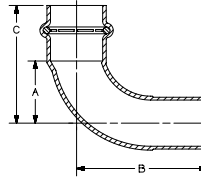

**PCH607-2**  
90° Elbow Ftg x P – Wrot

NOM. SIZE	APPROX. NET WT. LBS.	DIMENSIONS INCHES		
		A	B	C
1/2	.110	25/32	1 21/32	1 15/32
3/4	.219	1 1/16	2 7/32	1 31/32
1	.328	1 13/32	2 5/8	1 1/2
1 1/4	.490	2 7/8	3 3/32	2 29/32
1 1/2	.871	2 7/32	3 15/16	3 11/16
2	1.467	2 29/32	4 17/32	4 15/32

**TEES**

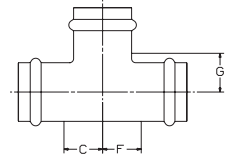

**PCH611**  
Tee P x P x P – Wrot

NOM. SIZE	APPROX. NET WT. LBS.	DIMENSIONS INCHES		
		C	F	G
1/2	.176	23/32	23/32	15/32
3/4	.320	25/32	25/32	21/32
3/4 x 3/4 x 1/2	.276	21/32	21/32	21/32
1	.501	7/8	7/8	29/32
1 x 3/4 x 1/2	.634	13/16	1 1/16	1 5/32
1 x 3/4 x 3/4	.460	25/32	31/32	13/16
1 x 1 x 1/2	.324	21/32	21/32	7/8
1 x 1 x 3/4	.388	3/4	3/4	27/32
1 1/4	.759	1	1	1 5/16
1 1/4 x 1 1/4 x 1	.508	1	1	1 1/4
1 1/2	1.179	1 5/16	1 5/16	1 19/32
1 1/2 x 1 1/2 x 3/4	.740	19/32	19/32	1 3/32
1 1/2 x 1 1/2 x 1	.785	1 5/16	1 5/16	1 3/16
1 1/2 x 1 1/2 x 1 1/4	1.262	7/8	7/8	1 19/32
2	1.789	1 13/32	1 13/32	1 13/32
2 x 2 x 3/4	1.256	3/4	3/4	1 1/2
2 x 2 x 1 1/2	1.770	1 1/8	1 1/8	1 1/2

Visit our website for the most current information.

## UNIONS

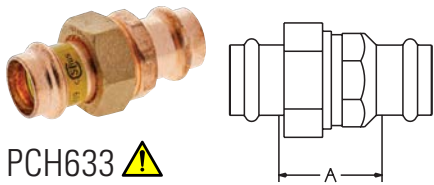

**PCH633** ⚠️  
Union P x P – Wrot

NOM. SIZE	APPROX. NET WT./LBS.	DIM. A INCHES
1/2	.386	1 <sup>5</sup> / <sub>16</sub>
3/4	.527	1 <sup>9</sup> / <sub>32</sub>
1	.810	1 <sup>11</sup> / <sub>32</sub>
1¼	1.093	1 <sup>19</sup> / <sub>32</sub>
1½	1.715	1 <sup>21</sup> / <sub>32</sub>
2	2.394	1 <sup>27</sup> / <sub>32</sub>

## ACCESSORIES



**HNBR Seal (leak detection)**

SIZE	PART No.	
1/2	T048353 PP	Leak Detect
3/4	T048355 PP	Leak Detect
1	T048357 PP	Leak Detect
1¼	T048359 PP	Leak Detect
1½	T048361 PP	Leak Detect
2	T048363 PP	Leak Detect

**NOTE: Do NOT use with PC-FP600A-LF**



**Press Installation Gauge**

SIZE	PART No.
1½ - 2	K700001PC

**⚠️ WARNING:** This product can expose you to chemicals including lead, which is known to the State of California to cause cancer and birth defects or other reproductive harm. For more information go to [www.P65Warnings.ca.gov](http://www.P65Warnings.ca.gov).

Visit our website for the most current information.

Press Webstone PressACR Bench  
system Chemtrol NIBCO  
SURE SEAL FLO-BOSS Press  
NIBCO wrot racer FAST PUSH FITTINGS Bench PressG  
Bench Press Webstone PressACR  
presssystem NIBCO Chem  
PressG SURE SEAL FLO-BOSS  
G NIBCO wrot racer FAST PUSH FITTINGS Bench Press  
Press Webstone PressACR Bench  
system Chemtrol NIBCO pr  
SURE SEAL FLO-BOSS Press  
NIBCO wrot racer FAST PUSH FITTINGS Bench PressG  
R Bench Press Webstone Press  
NIBCO presssystem Chemtro  
OSS PressG SURE SEAL FLO  
essACR Bench

# NIBCO®

NIBCO INC.  
WORLD HEADQUARTERS

1516 MIDDLEBURY STREET  
ELKHART, IN 46516-4740 USA  
WEB: [www.nibco.com](http://www.nibco.com)

DOMESTIC CUSTOMER SERVICE  
PHONE: 800.234.0227  
FAX: 800.234.0557

TECHNICAL SERVICE  
PHONE: 888.446.4226  
FAX: 888.336.4226

INTERNATIONAL OFFICE  
PHONE: +1/574.295.3327  
FAX: +1/574.295.3455