

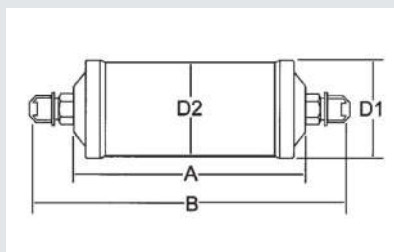

Features:

- Design Pressure (DP) / Maximum abnormal pressure (MAP): 700 psig
- Maximum working temperature: 160°F/70°C
- Compatible with all CFC, HCFC, HFC and HFO refrigerants and oils, and refrigerants requiring XH-11 desiccant
- UL/cUL Listed, Conforms to Pressure Equipment Directive 2014/68/EU
- High retention filter for removal of particulate as small as 25 microns
- High pressure shell and connections
- Powder paint finish approved for marine applications



Flare Connection

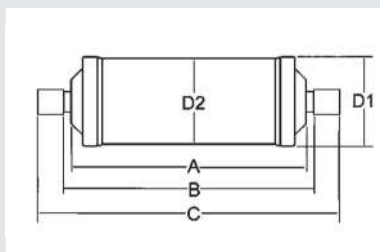

Solder Connection

Flare Connection

Part Number	Model	Des. Cu. In	Size (in)	A (in)	B (in)	D1 (in)	D2 (in)	Wt (lb)	Liquid Capacity (tons)			Water Capacity (drops)											
									R134a	R404A, R507	R22, R407C, R410A	R134a		R404A		R507		R22		R407C		R410A	
												75°F	125°F	75°F	125°F	75°F	125°F	75°F	125°F	75°F	125°F	75°F	125°F
A 19002	HPF-083	8	3/8	3.85	6.09	2.65	2.50	1.34	2.3	1.6	2.5	200	189	206	196	210	196	200	185	194	179	182	167
A 19003	HPF-084	8	1/2	3.85	6.41	2.65	2.50	1.40	2.6	1.8	2.8	200	189	206	196	210	196	200	185	194	179	182	167
A 19007	HPF-163	16	3/8	4.41	6.65	3.15	3.00	2.18	5.2	3.8	5.8	386	368	403	381	409	379	387	357	374	346	352	325
A 19008	HPF-164	16	1/2	4.41	6.97	3.15	3.00	2.28	8.2	5.8	9.3	386	368	403	381	409	379	387	357	374	346	352	325
A 19009	HPF-165	16	5/8	4.41	7.33	3.15	3.00	2.40	10.8	8.4	11.7	386	368	403	381	409	379	387	357	374	346	352	325
A 19013	HPF-304	30	1/2	7.40	9.96	3.15	3.00	3.31	8.0	5.7	8.8	856	809	894	846	910	840	858	793	833	769	780	720
A 19014	HPF-305	30	5/8	7.40	10.32	3.15	3.00	3.41	10.8	8.0	11.9	856	809	894	846	910	840	858	793	833	769	780	720

Solder Connection

Part Number	Model	Des. Cu. In	Size (in)	A (in)	B (in)	C (in)	D1 (in)	D2 (in)	Wt (lb)	Liquid Capacity (tons)			Water Capacity (drops)											
										R134a	R404A, R507	R22, R407C, R410A	R134a		R404A		R507		R22		R407C		R410A	
													75°F	125°F	75°F	125°F	75°F	125°F	75°F	125°F	75°F	125°F	75°F	125°F
A 19000	HPS-083	8	3/8	3.85	4.58	5.31	2.65	2.50	1.23	2.3	1.6	2.5	200	189	206	196	210	196	200	185	194	179	182	167
A 19001	HPS-084	8	1/2	3.85	4.72	5.59	2.65	2.50	1.25	2.6	1.8	2.8	200	189	206	196	210	196	200	185	194	179	182	167
A 19004	HPS-163	16	3/8	4.41	5.14	5.87	3.15	3.00	2.12	5.2	3.8	5.8	386	368	403	381	409	379	387	357	374	346	352	325
A 19005	HPS-164	16	1/2	4.41	5.27	6.14	3.15	3.00	2.07	8.2	5.8	9.3	386	368	403	381	409	379	387	357	374	346	352	325
A 19006	HPS-165	16	5/8	4.41	5.36	6.30	3.15	3.00	2.12	10.8	8.4	11.7	386	368	403	381	409	379	387	357	374	346	352	325
A 19010	HPS-304	30	1/2	7.40	8.26	9.13	3.15	3.00	3.16	8.0	5.7	8.8	856	809	894	846	910	840	858	793	833	769	780	720
A 19011	HPS-305	30	5/8	7.40	8.35	9.29	3.15	3.00	3.18	10.8	8.0	11.9	856	809	894	846	910	840	858	793	833	769	780	720
A 19100	HPS-306	30	3/4	7.40	8.58	9.76	3.15	3.00	3.22	11.5	8.5	12.6	856	809	894	846	910	840	858	793	833	769	780	720
A 19012	HPS-307	30	7/8	7.40	8.42	9.84	3.15	3.00	3.26	12.2	9.1	13.4	856	809	894	846	910	840	858	793	833	769	780	720