

SUBMITTAL SHEET

JOB NAME	ITEM TAG
JOB LOCATION	PART NUMBER
CONTRACTOR	DATE
ENGINEER APPROVAL	DATE

Natural Gas Burner Bar

T-3205

Designed for natural gas only. Not suitable for LP gas applications.

T-style, with ash protector ledge to prevent debris fouling of the frame.

Includes two countersink plugs.

Can be used as the flame source for artificial log sets (continuous flame), or as a log starter source (start-up flame), for conventional log fireplace applications. or as a log starter source (start-up flame), for conventional log fireplace applications.

Rated: 90,000 BTU/Hr. at 1/2-psig.

Available in nominal 1/2" x 1/2" x 1/2" FNPT connections.

Working Pressure, Non Shock (PSI)

Cold working pressure (CWP): Refer to system operating pressure
Saturated steam (WSP): Not suitable for steam service



**Pictured:
T-3205**

MATERIAL SPECIFICATION

PART	MATERIAL	SPECIFICATION
1 Body	Cast iron	ASTM A126
2 Plugs (2)	Carbon steel	ASTM A1015

DIMENSIONS

SIZE	A	B	C	D	E	F
1/2"	12.25	1.25	6.125	1.00	1.56	1.38

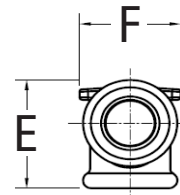

**Pictured:
T-3205
End view**

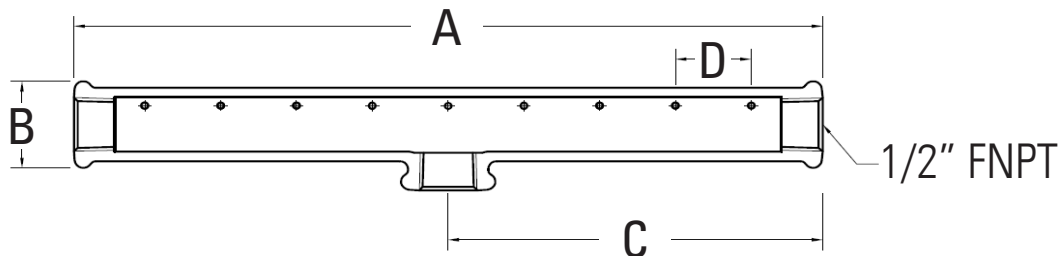

**Pictured:
T-3205
Cut-away view**