

PRODUCT SPECIFICATION DRAWING HOLDRITE® #424, #425 & #426 Inserts

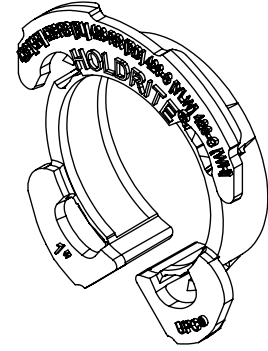

ALL DIMENSIONS IN INCHES

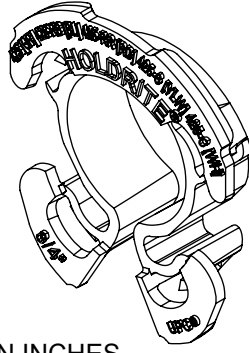
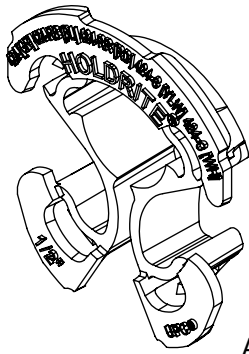
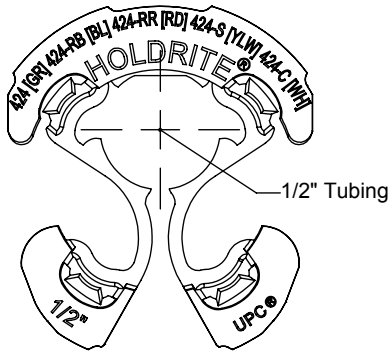
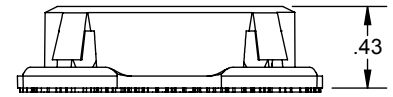
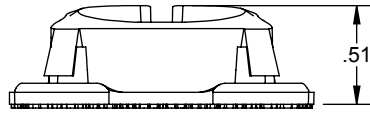
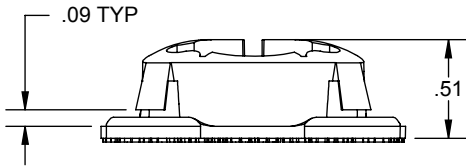

#424

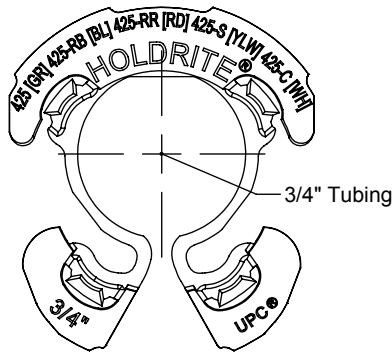

#425

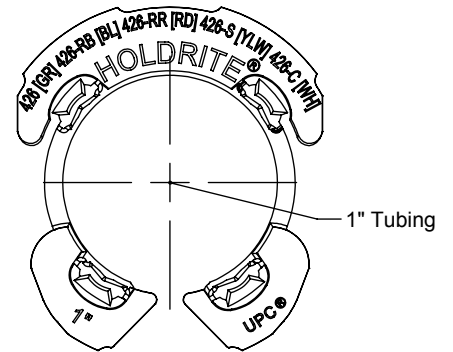

#426

For used with 1-11/32" or 1-3/8" round cut-outs in 14 to 25 gage sheet metal.
Ideal for isolation of Copper, PEX or CPVC tubing.

Product Information:

- Material: Polypropylene, Light Gray, UL94HB
- Temperature range: -10°F to 180°F
- UPC / IPC / IAPMO listed



THIS INFORMATION IS PROPRIETARY TO HOLDRITE AND IS SUBJECT TO CHANGE WITHOUT NOTICE. IT MAY NOT BE REPRODUCED IN PART OR WHOLE WITHOUT WRITTEN AUTHORIZATION.

HOLDRITE®

CONVERTING MAKESHIFT METHODS INTO ENGINEERED SOLUTIONSSM
800-321-0316 OR 760-744-6944 / FAX: 760-744-0507 / WWW.HOLDRITE.COM
spec_424_425_426_RevD

Product Submittal	
Job Name:	
Date:	
Part Number:	Qty:
Architect / Owner:	
Contractor:	
Notes:	