

Position	Count	Description
	1	<p>Product_name: UP 15-10 SU7P/TLC, 1 Comfort valve</p>  <p style="text-align: right;">Product photo could vary from the actual product</p> <p>Product No.: 00595916 EAN_number: 5700394894807 Price: On request</p> <p>Technical: Approvals on nameplate: UL, CSA</p> <p>Materials: Pump housing: Stainless steel Impeller: PES Composite (30% glass-filled)</p> <p>Installation: Maximum ambient temperature: 104 °F Ambient max at 176°F liquid: 176 °F Maximum operating pressure: 145 psi Flange standard: USA Threaded Pipe connection: NPT 3/4" Pressure stage: 10 Port-to-port length: 5 1/8 in</p> <p>Liquid: Pumped liquid: Water Liquid temperature range: 35.6 .. 150.8 °F Liquid temp: 140 °F Density: 61.35 lb/ft³</p> <p>Electrical data: C run: 2 µF Max. power input: 25 W Rated power - P2: 0.04 HP Main frequency: 60 Hz Rated voltage: 1 x 115 V Current in speed 3: 0.23 A Capacitor size - run: 2 µF/400 V Number of poles: 2 Insulation class (IEC 85): F Cable type: Connecting cord with plug Type of cable plug: NEMA 5-15P</p> <p>Others: Gross weight: 5.51 lb</p>



Company name:

Created by:

Phone:

Date:

3/18/2016

00595916 UP 15-10 SU7P/TLC, 1 Comfort valve 60 Hz

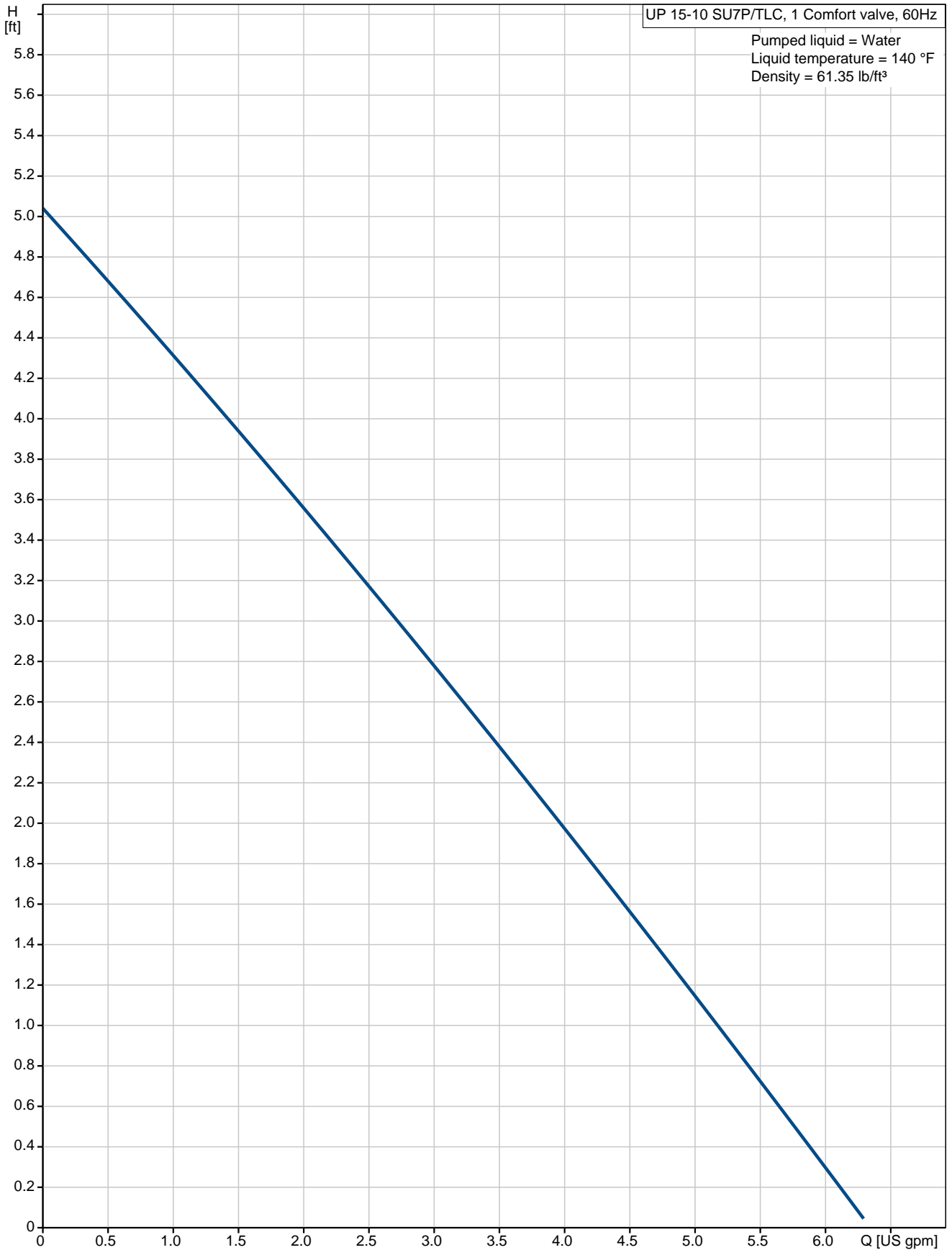

Description	Value
-------------	-------

General information:

Product name:	UP 15-10 SU7P/TLC, 1 Comfort valve
Product No.:	00595916
EAN:	5700394894807
Price:	On request

Technical:

Speed Number:	1
Max flow:	6.16 US gpm
Head max:	5.25 ft
	3.281 ft
Approvals on nameplate:	UL, CSA

Materials:

Pump housing:	Stainless steel
Impeller:	PES Composite (30% glass-filled)

Installation:

Maximum ambient temperature:	104 °F
Ambient max at 176°F liquid:	176 °F
Maximum operating pressure:	145 psi
Flange standard:	USA Threaded
Pipe connection:	NPT 3/4"
Pressure stage:	10
Port-to-port length:	5 1/8 in

Liquid:

Pumped liquid:	Water
Liquid temperature range:	35.6 .. 150.8 °F
Liquid temp:	140 °F
Density:	61.35 lb/ft ³

Electrical data:

C run:	2 µF
Max. power input:	25 W
Rated power - P2:	0.04 HP
Main frequency:	60 Hz
Rated voltage:	1 x 115 V
Current in speed 3:	0.23 A
Capacitor size - run:	2 µF/400 V
Number of poles:	2
Insulation class (IEC 85):	F
Motor protection:	CONTACT
Thermal protec:	internal
Cable type:	Connecting cord with plug
Type of cable plug:	NEMA 5-15P

Controls:

Pos term box:	9H
---------------	----

Others:

Gross weight:	5.51 lb
---------------	---------

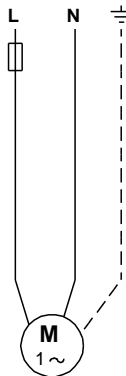
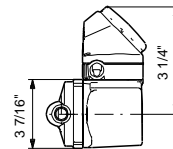
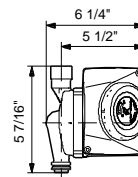
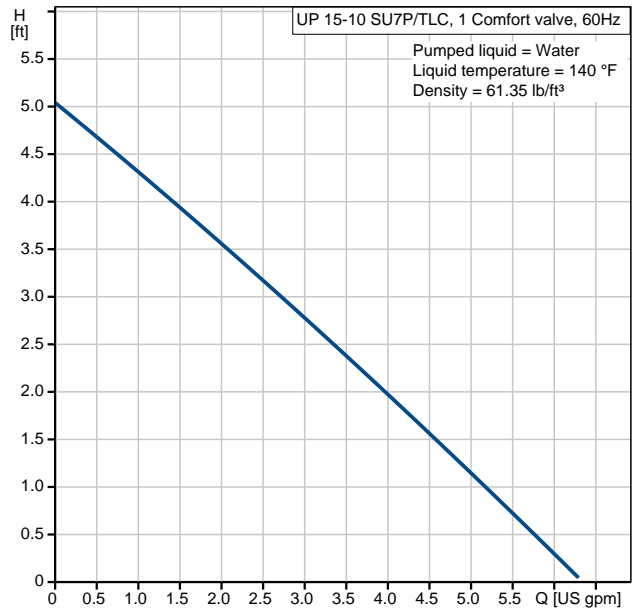

00595916 UP 15-10 SU7P/TLC, 1 Comfort valve 60 Hz

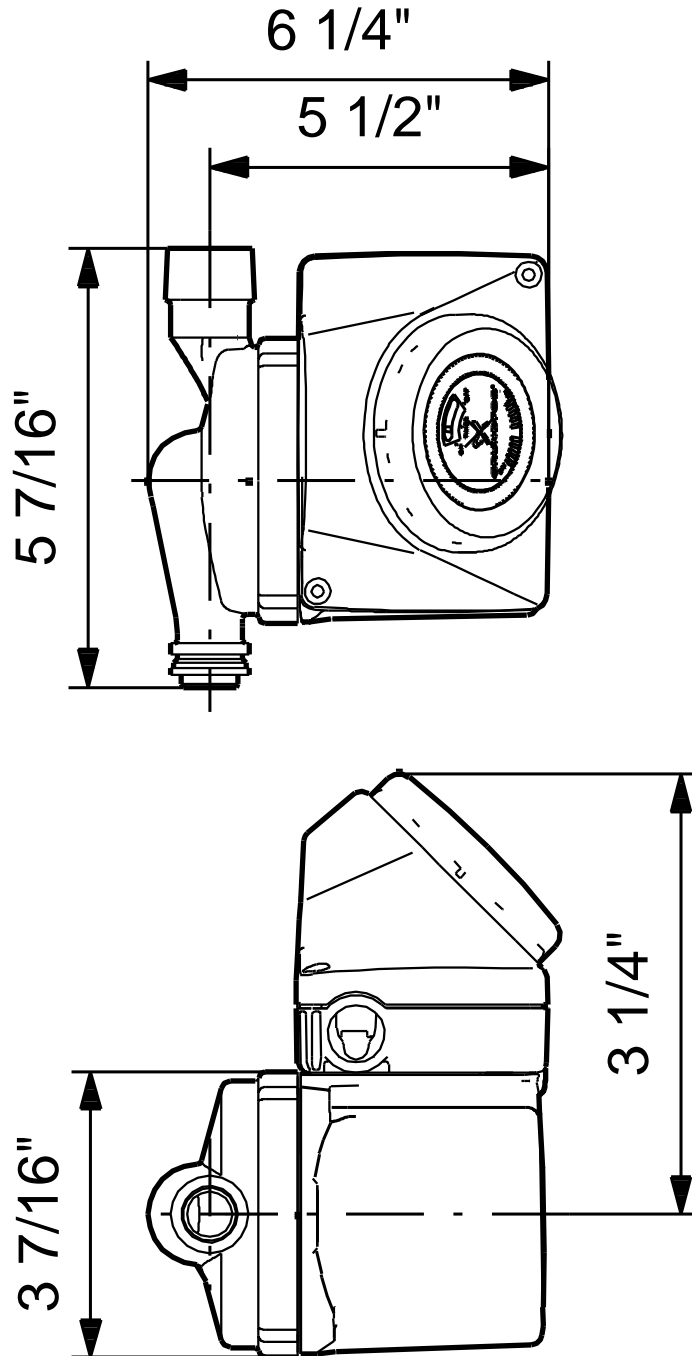

Note! All units are in [mm] unless otherwise stated.
Disclaimer: This simplified dimensional drawing does not show all details.

00595916 UP 15-10 SU7P/TLC, 1 Comfort valve 60 Hz

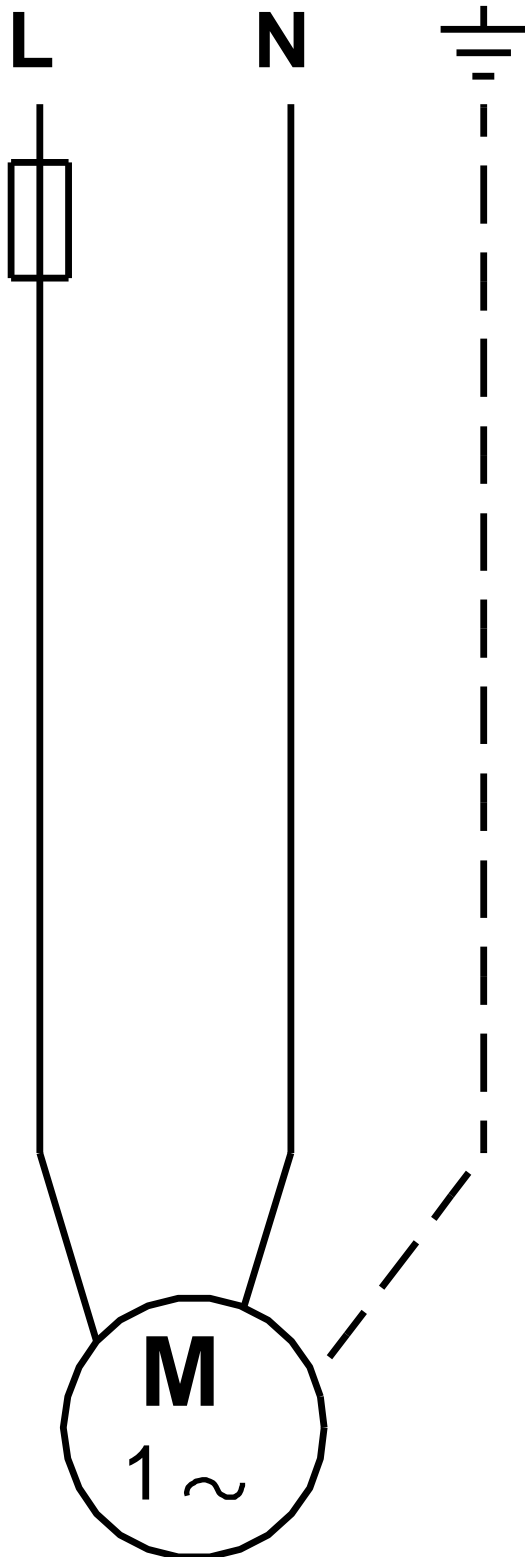

All units are [mm] unless otherwise presented.