



**PROGEF Standard reducer
SDR11/PN10**

Model:

- Material: PP-H
- Conventional butt-welding according to DVS 2207
- IR = Infrared welding compatible

Material:PP-R

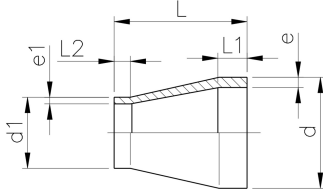

	d	d1	SDR	PN	FM	Code	Weight	L	L1	L2	e	e1
	(mm)	(mm)		(bar)			(kg)	(mm)	(mm)	(mm)	(mm)	(mm)
	25	20	11	10	IR	727 908 537	0.007	50	20	20	2.3	1.9
	32	20	11	10	IR	727 908 542	0.010	50	20	20	2.9	1.9
	32	25	11	10	IR	727 908 541	0.010	50	20	20	2.9	2.3
	40	20	11	10	IR	727 908 548	0.016	58	20	23	3.7	1.9
	40	25	11	10	IR	727 908 547	0.016	55	20	20	3.7	2.3
	40	32	11	10	IR	727 908 546	0.018	55	20	20	3.7	2.9
	50	25	11	10	IR	727 908 554	0.024	60	20	20	4.6	2.3
	50	32	11	10	IR	727 908 553	0.027	60	20	20	4.6	2.9
	50	40	11	10	IR	727 908 552	0.030	60	20	20	4.6	3.7
	63	32	11	10	IR	727 908 560	0.043	65	20	20	5.8	2.9
	63	40	11	10	IR	727 908 559	0.047	65	20	20	5.8	3.7
	63	50	11	10	IR	727 908 558	0.051	65	20	20	5.8	4.6
	75	40	11	10	IR	727 908 566	0.062	68	20	20	6.8	3.7
	75	50	11	10	IR	727 908 565	0.071	65	20	20	6.8	4.6
	90	63	11	10	IR	727 908 571	0.115	75	22	19	8.2	5.8
	75	63	11	10	IR	727 908 564	0.075	65	20	20	6.8	5.8
	90	75	11	10	IR	727 908 570	0.130	75	22	19	8.2	6.8
	110	63	11	10	IR	727 908 572	0.201	90	28	28	10.6	6.2
	110	75	11	10	IR	727 908 577	0.215	90	28	18	10.0	6.8
	110	90	11	10	IR	727 908 576	0.225	90	28	30	10.0	8.2
	125	110	11	10	IR	727 908 580	0.335	100	32	30	11.4	10.0
	140	110	11	10	IR	727 908 585	0.423	110	33	29	12.7	10.0
	140	125	11	10	IR	727 908 584	0.462	110	34	30	12.7	11.4
	160	110	11	10	IR	727 908 590	0.586	120	39	27	14.6	10.0
	160	140	11	10	IR	727 908 588	0.647	120	40	35	14.6	12.7
	180	90	11	10	IR	727 908 149	0.800	145	50	40	16.4	8.8
	180	110	11	10	IR	727 908 150	1.010	150	50	40	16.4	10.0
	180	125	11	10	IR	727 908 151	0.985	145	52	40	16.4	11.4
	180	140	11	10	IR	727 908 152	0.995	135	51	47	16.4	12.7
	180	160	11	10	IR	727 908 153	1.020	135	55	52	16.4	14.6
	200	160	11	10	IR	727 908 592	1.149	145	50	40	18.2	14.6
	200	180	11	10	IR	727 908 158	1.300	145	50	45	18.2	16.4
	225	110	11	10	IR	727 908 595	1.485	160	55	35	20.5	10.0
	225	160	11	10	IR	727 908 596	1.590	160	55	40	20.5	14.6
	225	180	11	10	IR	727 908 162	1.770	163	60	58	20.5	16.4
	225	200	11	10	IR	727 908 597	1.723	160	55	50	20.5	18.2
	250	160	11	10	IR	727 908 165	2.140	170	63	53	22.7	14.6
	250	225	11	10	IR	727 908 168	2.750	180	65	65	22.7	20.5
	280	225	11	10	IR	727 908 172	3.425	203	72	57	25.4	20.5
	280	250	11	10	IR	727 908 173	1.980	206	75	60	25.4	22.7
	315	225	11	10	IR	727 908 176	5.110	237	84	60	28.6	20.5
	315	250	11	10	IR	727 908 177	5.105	231	86	63	28.6	22.7
	315	280	11	10	IR	727 908 178	5.130	222	80	70	28.6	25.4
1	355	250	11	10		727 908 963	5.490	245	90	60	32.3	22.7
1	355	280	11	10		727 908 962	5.462	245	90	70	32.2	25.4
1	355	315	11	10		727 908 961	3.700	245	90	80	32.2	28.6
1	400	315	11	10		727 908 966	5.300	215	95	80	36.3	28.6
1	400	355	11	10		727 908 965	4.800	260	95	90	36.3	32.2
	450	280	11	10		727 908 960	9.000	230	60	70	40.9	25.4
	450	315	11	10		727 908 948	8.000	230	60	80	40.9	28.6

Data sheet

valid from: 7/18/23

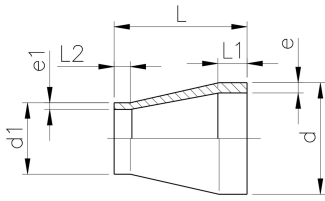

d	d1	SDR	PN	FM	Code	Weight	L	L1	L2	e	e1
(mm)	(mm)		(bar)			(kg)	(mm)	(mm)	(mm)	(mm)	(mm)
450	355	11	10		727 908 950	7.400	230	60	90	40.9	32.2
450	400	11	10		727 908 951	6.000	230	60	95	40.9	36.3
500	315	11	10		727 908 953	12.000	200	60	80	45.4	28.6
500	355	11	10		727 908 954	10.800	230	60	90	45.4	32.2
500	400	11	10		727 908 956	10.000	230	60	95	45.4	36.3
500	450	11	10		727 908 964	8.300	230	60	60	45.4	40.9

The technical data are not binding. They neither constitute expressly warranted characteristics nor guaranteed properties nor a guaranteed durability. They are subject to modification. Our General Terms of Sale apply.

Georg Fischer Piping Systems Ltd, Postfach, CH-8201 Schaffhausen/Switzerland Phone +41 -(0)52-631 1111 e-mail: info.ps@georgfischer.com Internet: <http://www.gfps.com>