

Elementary protection

FUSEAL® Corrosive Waste Piping System

PRODUCT CATALOGUE

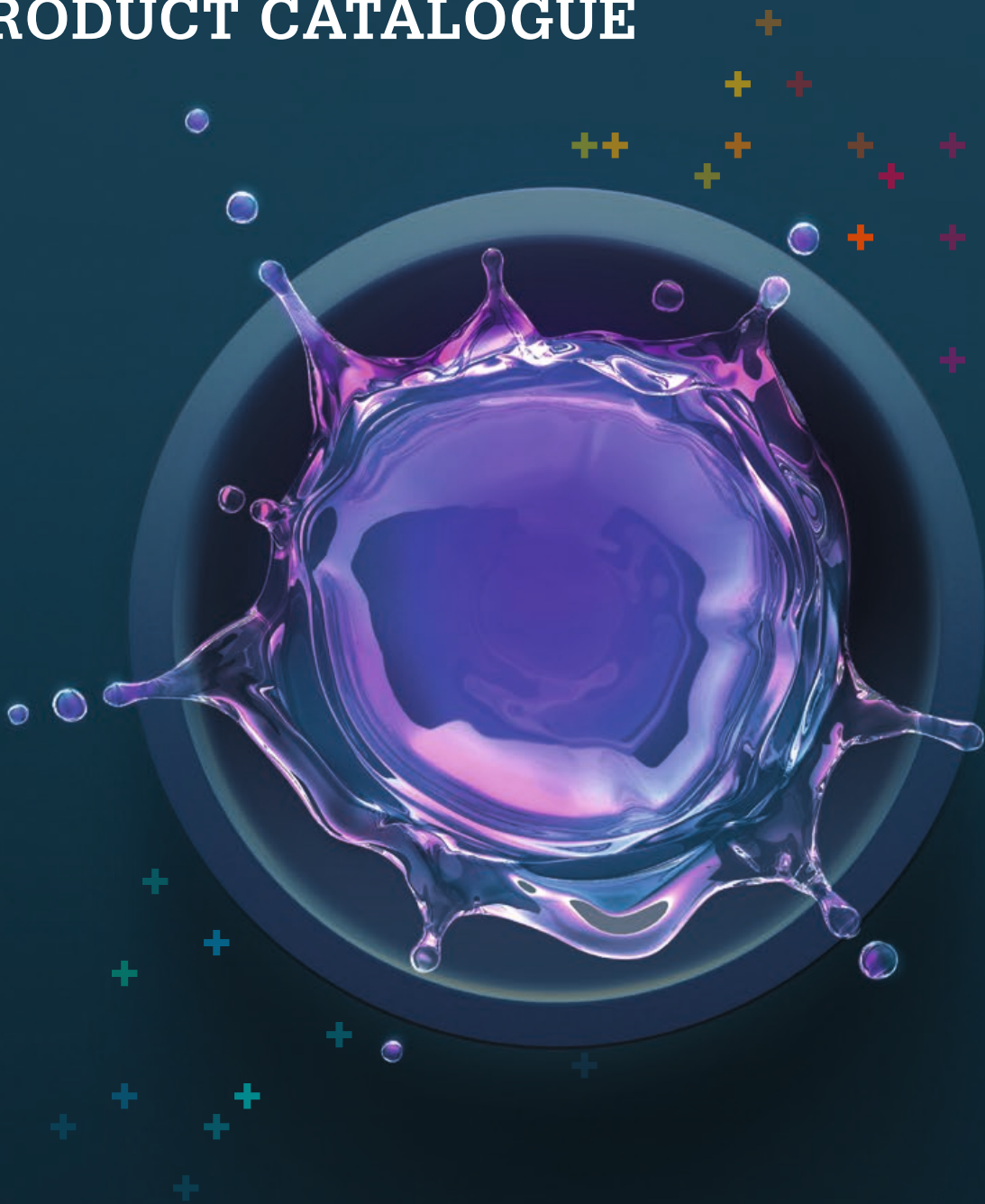

Table of contents

Fuseal PPFR & PPNFR Pipe	4
Fuseal Fusion Fittings PPFR	5
Fuseal Cleanouts & Floor Drains PPFR	17
Fuseal Sinks and Cups	21
Fuseal Gullies	25
Fuseal Pots	26
Fuseal Traps	28
Accessories	31

Fuseal PPFR & PPNFR Pipe



Schedule 40 PPFR

- 38mm - 152mm, 6m lengths as standard

DN (mm)	Size (inch)	Code	Length (m)	avg. od (mm)	min. wall (mm)
38	1 ½	20014M142	6.00	48.26	3.683
51	2	20014M143	6.00	60.33	3.912
76	3	20014M144	6.00	88.90	5.486
102	4	20014M145	6.00	114.30	6.020
152	6	20014M146	6.00	168.27	7.112

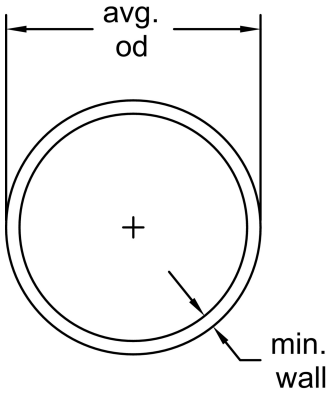

Schedule 40 PPNFR

Note:

Schedule 80 available on request

DN (mm)	Size (inch)	Code	Length (m)	avg. od (mm)	min. wall (mm)
203	8	37B023080	6.00	219.08	8.18
254	10	37B023100	6.00	273.05	9.27
305	12	37B023120	6.00	323.85	10.31
356	14	37B023140	6.00	355.60	11.10
406	16	37B023160	6.00	406.40	12.70
457	18	37B023180	6.00	457.20	14.27

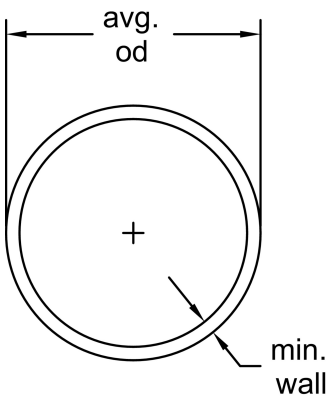

Fuseal Fusion Fittings PPR



Coupling (S x S)

DN (mm)	Size (inch)	Electrofusion Code	Fast-Lock Code	N (mm)
38	1 ½	527001	375 170 001	1.52
51	2	527002	375 170 002	1.52
76	3	527003	375 170 003	3.30
102	4	527004	375 170 004	3.30
152	6	527006		4.83

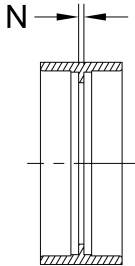

Sleeve Coupling (S x S)

DN (mm)	Size (inch)	Electrofusion Code	L (mm)
38	1 ½	527041	39.62
51	2	527042	45.97
76	3	527043	50.80
102	4	527044	50.80
152	6	527046	68.33

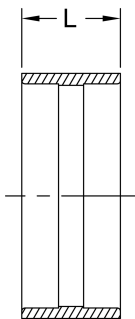

1/4 Bend (91.2°) - Long Sweep (S x S)

DN (mm)	Size (inch)	Electrofusion Code	Fast-Lock Code	G (mm)
38	1 ½	526276	375 162 701	60.85
51	2	526277	375 162 702	82.55
76	3	526278	375 162 703	103.12
102	4	526279	375 162 704	125.48
152	6	526280F		279.40

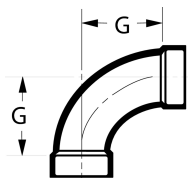

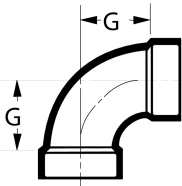

1/4 Bend (91.2°) - Short Sweep (S x S)

DN (mm)	Size (inch)	Electrofusion Code	Fast-Lock Code	G (mm)
38	1 1/2	526251	375 182 501	44.45
51	2	526252	375 182 502	58.67
76	3	526253	375 182 503	77.72
102	4	526254	375 182 504	98.55
152	6	526256		143.00

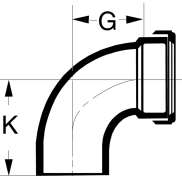

1/4 Bend (91.2°) - Street (S x SPG)

DN (mm)	Size (inch)	Electrofusion Code	Fast-Lock Code	G (mm)	K (mm)
38	1 1/2	526451	375 164 501	44.45	78.99
51	2	526452	375 164 502	58.67	93.98
76	3	526453	375 164 503	77.72	120.65
102	4	526454	375 164 504	98.55	136.65
152	6	526456F		279.40	274.57

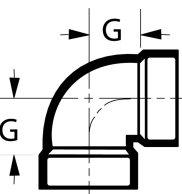

1/4 Bend (90°) - Vent (S x S)

DN (mm)	Size (inch)	Electrofusion Code	Fast-Lock Code	G (mm)
38	1 1/2	526201	375 162 001	30.23
51	2	526202	375 162 002	38.01
76	3	526203	375 162 003	47.75

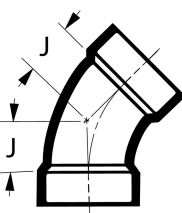

1/6 Bend (60°) (S x S)

DN (mm)	Size (inch)	Electrofusion Code	Fast-Lock Code	J (mm)
51	1 1/2	526601	375 166 001	25.40
38	2	526602	375 166 002	33.27
76	3	526603	375 166 003	42.93
102	4	526604	375 166 004	52.32

1/8 Bend (45°) (S x S)

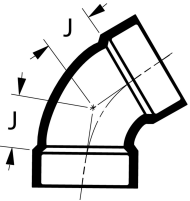

DN (mm)	Size (inch)	Electrofusion Code	Fast-Lock Code	J (mm)
38	1 ½	526501	375 165 001	28.70
51	2	526502	375 165 002	38.10
76	3	526503	375 165 003	44.45
102	4	526504	375 165 004	55.63
152	6	526506		85.60

1/8 Bend (45°) - Street (S x SPG)

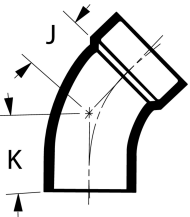

DN (mm)	Size (inch)	Electrofusion Code	Fast-Lock Code	K (mm)	J (mm)
38	1 ½	526401	375 164 001	61.98	28.70
51	2	526402	375 164 002	63.50	38.10
76	3	526403	375 164 003	82.55	44.45
102	4	526404	375 164 004	82.55	55.63
152	6	526406		120.65	85.85

1/12 Bend (30°) (S x S)

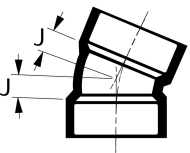

DN (mm)	Size (inch)	Electrofusion Code	Fast-Lock Code	J (mm)
38	1 ½	526951	375 169 501	19.05
51	2	526952	375 169 502	22.35
76	3	526953	375 169 503	31.75
102	4	526954	375 169 504	38.10

1/12 Bend (30°) - Street (S x SPG)

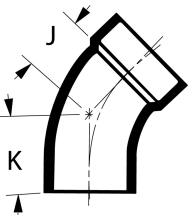

DN (mm)	Size (inch)	Electrofusion Code	Fast-Lock Code	J (mm)	K (mm)
38	1 ½	526461	375 164 601	19.05	47.75
51	2	526462	375 164 602	22.35	57.40
76	3	526463	375 164 603	31.75	65.02
102	4	526464	375 164 604	38.10	71.37

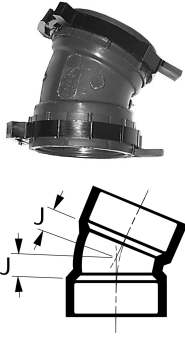

1/16 Bend (22.5°) (S x S)

DN (mm)	Size (inch)	Electrofusion Code	Fast-Lock Code	J (mm)
38	1 ½	526551	375 165 501	12.70
51	2	526552	375 165 502	17.53
76	3	526553	375 165 503	20.57
102	4	526554	375 165 504	25.40
152	6	526556F		158.75

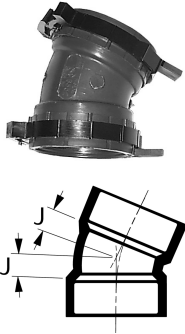

1/24 Bend (15°) (S x S)

DN (mm)	Size (inch)	Electrofusion Code	Fast-Lock Code	J (mm)
38	1 ½	526971	375 169 701	15.75
51	2	526972	375 169 702	16.00
76	3	526973	375 169 703	20.57
102	4	526974	375 169 704	22.10

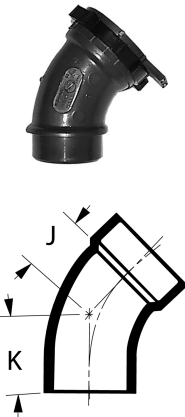

1/24 Bend (15°) - Street (S x SPG)

DN (mm)	Size (inch)	Electrofusion Code	Fast-Lock Code	J (mm)	K (mm)
38	1 ½	526961	375 169 601	15.75	38.35
51	2	526962	375 169 602	16.00	44.45
76	3	526963	375 169 603	20.57	53.85
102	4	526964	375 169 604	22.35	55.37

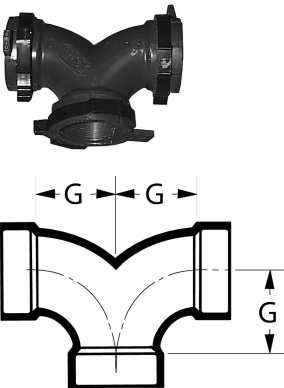

3-Way Ell (91.2°) (S x S x S)

DN (mm)	Size (inch)	Electrofusion Code	Fast-Lock Code	G (mm)
38	1 ½	526261	375 162 601	44.45
51	2	526262	375 162 602	58.67



45° Wye (S x S x S)

DN (mm)	Size (inch)	Electrofusion Code	Fast-Lock Code	GJ (mm)	GN (mm)	N (mm)
38	1 1/2	526301	375 163 001	73.15	28.70	101.60
51	2	526302	375 163 002	92.20	35.05	127.00
76	3	526303	375 163 003	127.00	42.67	177.80
102	4	526304	375 163 004	162.05	47.75	203.20
152	6	526306		231.90	41.40	279.40

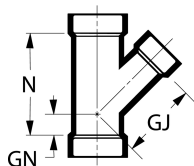

45° Wye Reducing (S x S x S)

DN (mm)	Size (inch)	Electrofusion Code	Fast-Lock Code	GJ (mm)	GN (mm)	N (mm)
51 - 51 - 38	2 - 2 - 1 1/2	526325	375 163 030	87.38	26.92	111.25
76 - 76 - 38	3 - 3 - 1 1/2	526324	375 163 031	158.75	22.35	127.00
76 - 76 - 51	3 - 3 - 2	526326	375 163 032	117.60	22.35	127.00
102 - 102 - 51	4 - 4 - 2	526328	375 163 034	141.22	9.65	128.50
102 - 102 - 76	4 - 4 - 3	526327	375 163 035	152.40	26.92	168.40
152 - 152 - 51	6 - 6 - 2	526342		171.45	-28.70	120.14
152 - 152 - 76	6 - 6 - 3	526343		188.72	4.83	162.05
152 - 152 - 102	6 - 6 - 4	526344		196.85	17.27	196.34

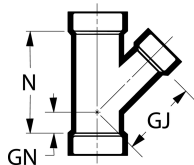

45° Wye - Double (S x S x S x S)

DN (mm)	Size (inch)	Electrofusion Code	Fast-Lock Code	GJ (mm)	GN (mm)	N (mm)
38	1 1/2	526380	375 163 501	89.00	28.70	117.60
51	2	526381	375 163 502	101.60	35.05	136.65
76	3	526382	375 163 503	127.00	41.40	193.80
102	4	526383	375 163 504	162.05	47.75	234.95
152	6	526351F		309.37	156.97	466.85

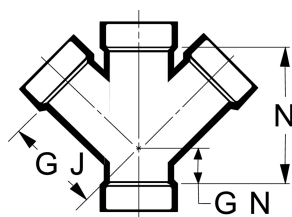

45° Wye - Double Reducing (S x S x S x S)

DN (mm)	Size (inch)	Electrofusion Code	Fast-Lock Code	GN (mm)	GJ (mm)	N (mm)
51 - 51 - 38 - 38	2 x 2 x 1 1/2 x 1 1/2	526384	375 163 530	26.92	87.38	136.65
76 - 76 - 38 - 38	3 x 3 x 1 1/2 x 1 1/2	526389	375 163 531	12.70	109.47	133.35
76 - 76 - 51 - 51	3 x 3 x 2 x 2	526385	375 163 532	22.35	117.60	152.40

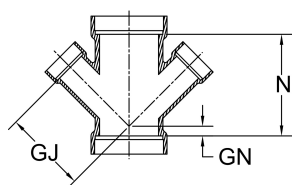

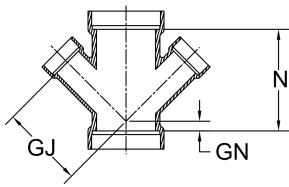

DN (mm)	Size (inch)	Electrofusion Code	Fast-Lock Code	GN (mm)	GJ (mm)	N (mm)
102 - 102 - 51 - 51	4 x 4 x 2 x 2	526386	375 163 534	9.65	152.40	153.92
102 - 102 - 76 - 76	4 x 4 x 3 x 3	526387	375 163 535	26.92	152.40	193.80
152 - 152 - 76 - 76	6 x 6 x 3 x 3	526390T		44.45	254.00	314.45
152 - 152 - 102 - 102	6 x 6 x 4 x 4	526388T		57.14	252.48	314.45



Long Turn Tee Wye (91.2°) (S x S x S)

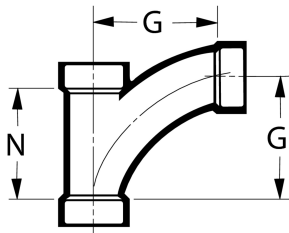

DN (mm)	Size (inch)	Electrofusion Code	Fast-Lock Code	G (mm)	N (mm)
38	1 ½	527301	375 173 001	100.98	92.20
51	2	527302	375 173 002	130.30	112.78
76	3	527303	375 173 003	192.02	165.10
102	4	527304	375 173 004	249.43	222.25



Long Turn Tee Wye (91.2°) - Reducing (S x S x S)

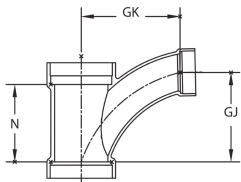

DN (mm)	Size (inch)	Electrofusion Code	Fast-Lock Code	GJ (mm)	GK (mm)	N (mm)
51 - 51 - 38	2 - 2 - 1 ½	527320	375 173 030	100.08	106.43	92.20
76 - 76 - 38	3 - 3 - 1 ½	527326	375 173 031	100.08	120.65	96.77
76 - 76 - 51	3 - 3 - 2	527327	375 173 032	130.30	144.53	120.65
102 - 102 - 51	4 - 4 - 2	527337	375 173 034	130.30	155.70	114.30
102 - 102 - 76	4 - 4 - 3	527338	375 173 035	192.02	204.72	165.10



Combo Wye & 1/8 Blend (90°) (S x S x S)

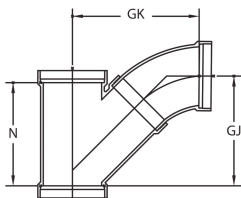

DN (mm)	Size (inch)	Code	GJ (mm)	GK (mm)	N (mm)
152	6	527306F	289.81	334.77	273.05



Combo Wye & 1/8 Bend (90°) - Reducing (S x S x S)

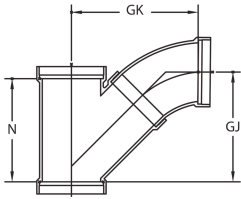

DN (mm)	Size (inch)	Code	GJ (mm)	GK (mm)	N (mm)
152 - 152 - 76	6 - 6 - 3	527339F	177.80	233.43	162.05
152 - 152 - 102	6 - 6 - 4	527340F	214.40	252.48	196.34
152 - 152 - 51	6 - 6 - 2	527344F	138.18	204.72	120.14



Combo Wye (90°) - Double (S x S x S x S)

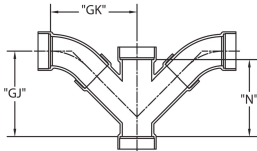

DN (mm)	Size (inch)	Electrofusion Code	Fast-Lock Code	GJ (mm)	GK (mm)	N (mm)
38	1 ½	526801	375 168 201	134.87	134.87	117.60
51	2	526802	375 168 202	151.89	154.94	136.65
76	3	526803	375 168 203	189.74	192.79	193.80
102	4	526804	375 168 204	220.73	228.60	234.95
152	6	526806F		461.77	392.18	466.85



Combo Wye (90°) - Double Reducing (S x S x S x S)

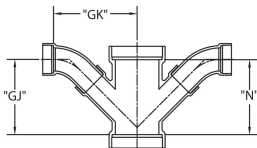

DN (mm)	Size (inch)	Electrofusion Code	Fast-Lock Code
51 - 51 - 38 - 38	2 x 2 x 1 1/2 x 1 1/2	526825	375 168 230
76 - 76 - 38 - 38	3 x 3 x 1 1/2 x 1 1/2	526824	375 168 231
76 - 76 - 51 - 51	3 x 3 x 2 x 2	526826	375 168 232
102 - 102 - 51 - 51	4 x 4 x 2 x 2	526828	375 168 234
102 - 102 - 76 - 76	4 x 4 x 3 x 3	526827	375 168 235
152 - 152 - 76 - 76	6 x 6 x 3 x 3	526843T	
152 - 152 - 102 - 102	6 x 6 x 4 x 4	526844T	

GJ (mm)	GK (mm)	N (mm)
132.59	133.86	136.65
133.86	149.60	133.35
150.11	166.12	152.40
154.43	182.88	153.92
193.29	210.57	193.80
282.97	283.97	314.45
299.97	298.45	314.45



Sanitary Tee (91.2°) (S x S x S)

DN (mm)	Size (inch)	Electrofusion Code	Fast-Lock Code	G (mm)	N (mm)
38	1 ½	526151	375 161 501	44.45	68.85
51	2	526152	375 161 502	58.67	93.73
76	3	526153	375 161 503	77.72	123.95
102	4	526154	375 161 504	98.55	155.70
152	6	526156F		361.95	466.85

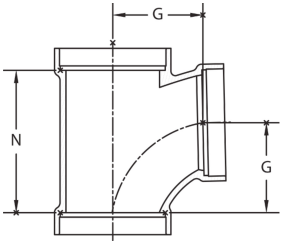

Sanitary Tee (91.2°) - Reducing (S x S x S)

DN (mm)	Size (inch)	Electrofusion Code	Fast-Lock Code	GJ (mm)	GK (mm)	N (mm)
51 - 51 - 38	2 - 2 - 1 ½	526126	375 161 530	49.78	53.13	80.52
76 - 76 - 38	3 - 3 - 1 ½	526131	375 161 531	44.45	65.02	68.07
76 - 76 - 51	3 - 3 - 2	526130	375 161 532	54.10	73.15	84.07
102 - 102 - 51	4 - 4 - 2	526134	375 161 534	52.32	84.07	81.03
102 - 102 - 76	4 - 4 - 3	526136	375 161 535	76.00	90.42	120.65
152 - 152 - 51	6 - 6 - 2	526137F		99.82	152.40	155.70
152 - 152 - 76	6 - 6 - 3	526138F		99.82	162.56	155.70
152 - 152 - 102	6 - 6 - 4	526139		99.82	124.46	155.70

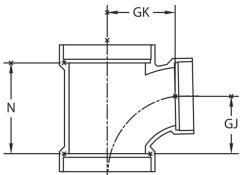

Sanitary Tee (91.2°) - Double (S x S x S x S)

DN (mm)	Size (inch)	Electrofusion Code	Fast-Lock Code	G (mm)	N (mm)
38	1 ½	526187	375 161 901	44	69.85
51	2	526186	375 161 902	59	93.73
76	3	526183	375 161 903	78	123.95
102	4	526185	375 161 904	99	155.70

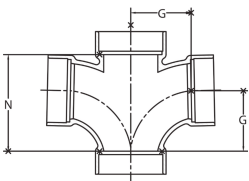

Sanitary Tee (91.2°) - Double Reducing (S x S x S x S)

DN (mm)	Size (inch)	Electrofusion Code	Fast-Lock Code	GJ (mm)	GK (mm)	N (mm)
51 x 51 x 38 x 38	2 x 2 x 1 1/2 x 1 1/2	526188	375 161 930	49.28	55.63	79.50
76 x 76 x 38 x 38	3 x 3 x 1 1/2 x 1 1/2	526184F	375 161 931	54.10	111.25	84.07
76 x 76 x 51 x 51	3 x 3 x 2 x 2	526181	375 161 932	54.10	73.15	84.07
102 x 102 x 51 x 51	4 x 4 x 2 x 2	526190F	375 161 934	98.55	127.25	155.17
102 x 102 x 76 x 76	4 x 4 x 3 x 3	526191F	375 161 935	98.55	136.65	155.17

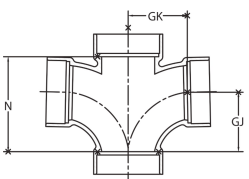

Pipe Increaser (S x S)

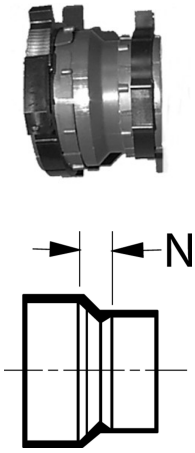

DN (mm)	Inch Size (inch)	Electrofusion Code	Fast-Lock Code	N (mm)
38 - 51	1 ½ - 2	527022	375 170 230	13.46
38 - 76	1 ½ - 3	527023F	375 170 231	66.80
51 - 76	2 - 3	527024	375 170 232	22.35
51 - 102	2 - 4	527025	375 170 234	35.05
76 - 102	3 - 4	527026	375 170 235	23.88
76 - 152	3 - 6	527027F		45.97
102 - 152	4 - 6	527028F		41.40

Reducer Bushing (SPG x S)

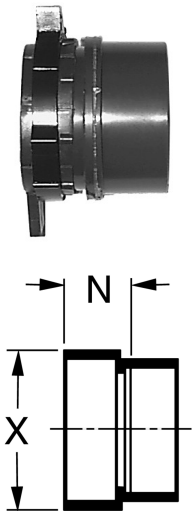

DN (mm)	Inch Size (inch)	Electrofusion Code	Fast-Lock Code	N (mm)	X (mm)
51 - 38	2 - 1 ½	526752	375 187 530	40.89	60.45
76 - 38	3 - 1 ½	526762	375 187 531	38.10	88.90
76 - 51	3 - 2	526754	375 187 532	38.10	88.90
102 - 51	4 - 2	526758	375 187 534	28.70	114.30
102 - 76	4 - 3	526756	375 187 535	38.10	114.30
152 - 102	6 - 4	526767		32.51	168.40

Cap (S)

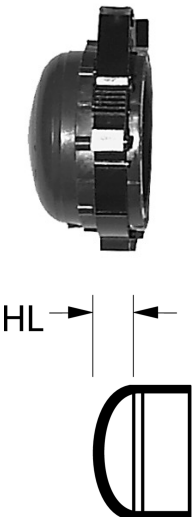

DN (mm)	Size (inch)	Electrofusion Code	Fast-Lock Code	HL (mm)
38	1 ½	527081		13.46
51	2	527082		8.13
76	3	527083		23.11
102	4	527084		27.69
152	6	527087		39.62



Male Adapter (S x MPT)

DN (mm)	Size (inch)	Electrofusion Code	Fast-Lock Code	HL (mm)
38	1 ½	526871	375 168 701	29.97
51	2	526872	375 168 702	31.75
76	3	526873	375 168 703	46.74
102	4	526874	375 168 704	50.80
152	6	526876F		88.90



Female Adapter (S x FPT)

DN (mm)	Size (inch)	Electrofusion Code	Fast-Lock Code	HL (mm)
38	1 ½	526891	375 168 901	28.45
51	2	526892	375 168 902	29.21
76	3	526893	375 168 903	43.69
102	4	526894	375 168 904	45.97
152	6	526896		71.63

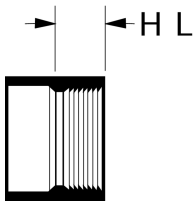

Glass Pipe Adapter (SPG x Glass Pipe Bead)

Compression Coupling and Clamp available from Glass Vendor

DN (mm)	Size (inch)	Electrofusion Code	M (mm)	N (mm)	X (mm)
38	1 ½	527411	52.32	51.00	48.26
51	2	527412	65.53	51.00	60.45
76	3	527413	93.73	63.50	88.90
102	4	527414	122.94	63.50	114.30
152	6	527416	180.85	76.00	168.40

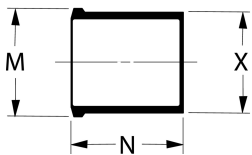

Flange - Van Stone ANSI 150 lb. Pattern (S)

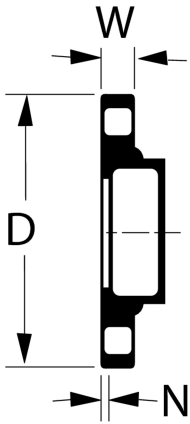

DN (mm)	Size (inch)	Electrofusion Code	Fast-Lock Code
38	1 ½	526931	375 169 301
51	2	526932	375 169 302
76	3	526933	375 169 303
102	4	526934	375 169 304
152	6	526936	

# holes	bolt hole dia. (mm)	bolt circle dia. (mm)	N (mm)	D (mm)	W (inch)
4	0.56	98.55	7.87	127.00	1
4	0.68	120.65	8.64	152.00	1
4	0.75	152.40	11.18	190.50	1
8	0.75	190.50	10.67	228.60	1
8	0.88	241.30	11.43	279.40	1

Union (PPFR x PPFR)/PPFR Nut (S x S)

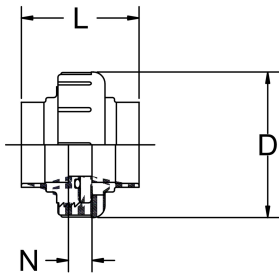

DN (mm)	Size (inch)	EPDM Code	FKM Code	D (mm)	L (mm)	N (mm)
38	1 ½	528291	527271	95.25	85.85	16.00
51	2	528292	527272	117.60	95.25	19.05
76	3	528293	527273	171.45	118.87	22.86
102	4	528294	527274	215.90	140.70	25.40

Expansion Joint (S x SPG)

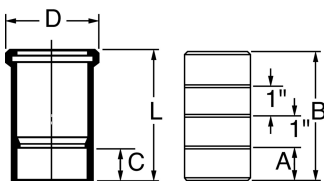

DN (mm)	Size (inch)	Code	A (mm)	B (mm)	C (mm)	D (mm)	L (mm)
38	1 ½	527811A	25	103.87	19.05	67.31	104.14
51	2	527812A	30	115.06	22.35	80.01	114.30
76	3	527813A	40	134.87	23.88	117.86	133.35
102	4	527814A	53	161.04	23.88	146.81	144.53

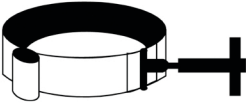

Metal Clamp

DN (mm)	Size (inch)	Code	Pack Qty
152	6	37Z000600	1
203	8	37Z000800	1
254	10	37Z001000	1
305	12	37Z001200	1

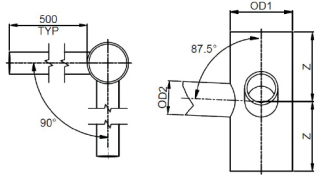

90° Corner Branch (S x S)

DN (mm)	Size (inch)	Code	Weight (kg)	OD1 (mm)	OD2 (mm)	Z (mm)
102 x 38	4 x 1 1/2	20014D035				
102 x 51	4 x 2	20014D036	0.440	114.3	60.3	125

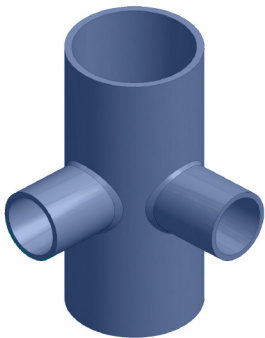

Fuseal Cleanouts & Floor Drains PPRF

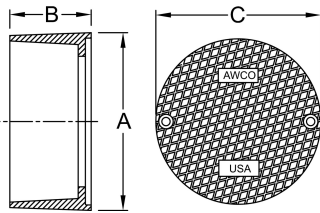

Nickel Bronze Floor Cleanout Housing

DN Size	Code	B	C	A
(mm) (inch)		(mm)	(mm)	(mm)
All All	527715A	71	145	156

Nickel Bronze Floor Cleanout Assembly (S)

2" adjustment



DN Size	Code	A	B	C	N
(mm) (inch)		(mm)	(mm)	(mm)	(mm)
76 3	527713A	155.70	71.37	144.78	70.61
102 4	527714A	155.70	71.37	144.78	77.72

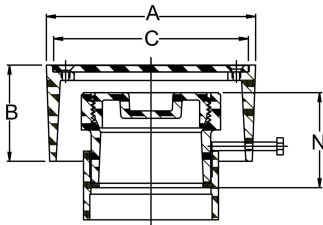

Cleanout Tee with Plug (S x S x FT)

DN Size	Code	HL	N
(mm) (inch)		(mm)	(mm)
38 1 ½	526114A	46.23	53.85
51 2	526115A	54.10	69.60
76 3	526116A	66.80	95.25
102 4	526117A	85.85	127.00
152 6	526118AF	196.85	457.20

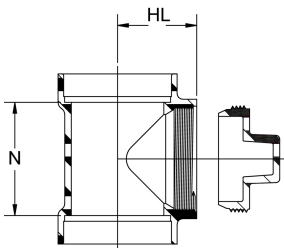

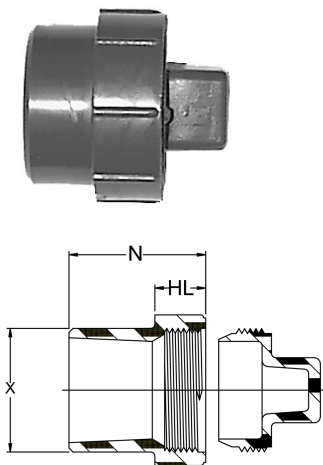

Cleanout Adapter with Plug (SPG x FT)

DN (mm)	Size (inch)	Code	HL (mm)	N (mm)	X (mm)
38	1 ½	527701A	19.81	53.09	48.26
51	2	527702A	19.81	56.38	60.45
76	3	527703A	27.69	67.56	88.89
102	4	527704A	28.70	74.68	114.30
152	6	527706A	33.27	66.80	168.40

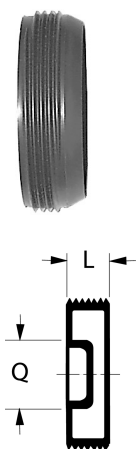

Countersunk Plug for Cleanout (MT)

DN (mm)	Size (inch)	Code	L (mm)	Q (mm)
76	3	527063	26.16	33.27
102	4	527064	29.46	41.40

Plug (MT)

Use with cleanout tees, cleanout adapters and cleanout p-traps only

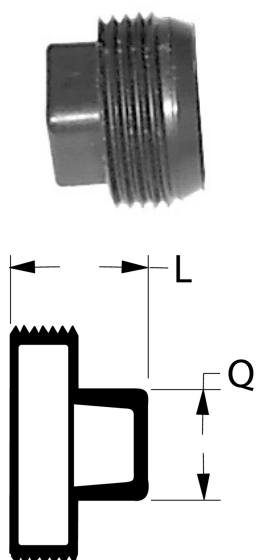

DN (mm)	Size (inch)	Code	L (mm)	Q (mm)	Remarks
25	1	527049	25.15	19.05	Used for 527201A & 527202A
38	1 ½	527051	39.62	25.40	Used for 527203A & 527204A
51	2	527052	39.12	31.75	
76	3	527053	51.56	41.40	
102	4	527054	54.86	50.80	
152	6	527057	60.45	60.45	



Floor Drain (S)

DN (mm)	Size (inch)	Code	A (mm)	B (mm)	C (mm)	D (mm)	E (mm)	F (mm)
51	2	527749F	215.90	304.80	41.40	169.93	128.52	148
76	3	527750	215.90	304.80	41.40	133.35	92.20	109
102	4	527751	215.90	304.80	41.40	133.35	92.20	109
152	6	527752F	215.90	304.80	41.40	184.40	143.00	152

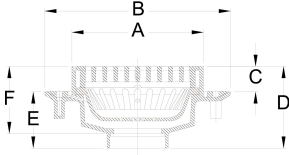

Replacement Strainer for Floor Drain

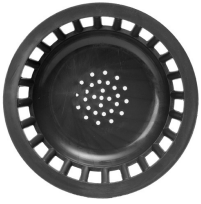

DN (mm)	Size (inch)	Code
All	All	527502A

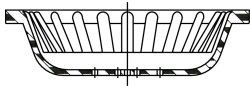

Replacement Grate for Floor Drain



DN (mm)	Size (inch)	Code
All	All	527503A



Anti-Splash Funnel for Floor Drain



DN (mm)	Size (inch)	Code	G (mm)	H (mm)
All	All	527505A	152.40	101.60

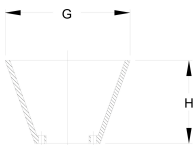

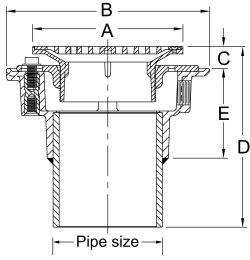

Stainless Steel Adjustable Floor Drain

Drains have a pipe spigot end and come standard with a sediment bucket. Drain design has a section to tap for trap primer. Optional square and round grates are available.

Size (mm)	Code	Description	A (mm)	B (mm)	D (mm)	E (mm)
51	150 999 100	152 mm Round SS drain C = 19 to 63.5 mm	152	213	127	76
76	150 999 101	152 mm Round SS drain C = 19 to 63.5 mm	152	213	157	94
102	150 999 102	152 mm Round SS drain C = 19 to 63.5 mm	152	213	160	97

Fuseal Sinks and Cups

Lab Sink - 560x355x230mm - Central Hole - Concave Bowl

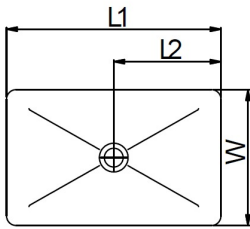

DN	Size	Code	Weight	L1	L2	W	D
(mm)	(inch)		(kg)	(mm)	(mm)	(mm)	(mm)
38	1 ½	20014D065	2.160	560	280	355	230

Lab Sink - 420x320x215mm - Central Hole

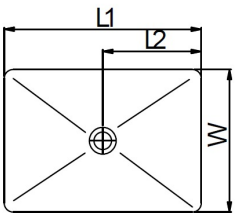

DN	Size	Code	Weight	L1	L2	W	D
(mm)	(inch)		(kg)	(mm)	(mm)	(mm)	(mm)
38	1 ½	20014D063	1.420	420	210	320	215

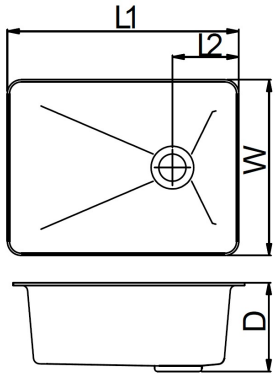

Lab Sink - 418x317x160mm / 552x400x231mm - Side Hole

DN (mm)	Size (inch)	Code	Weight (kg)	L1 (mm)	L2 (mm)	W (mm)	D (mm)
38	1 ½	20014D062	1.280	418	90	317	160
38	1 ½	20014D064	2.160	552	100	400	231

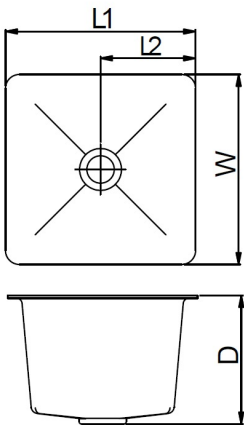

Lab Sink - Square 340x340x230mm - Central Hole

DN (mm)	Size (inch)	Code	Weight (kg)	L1 (mm)	L2 (mm)	W (mm)	D (mm)
38	1 ½	20014D061	1.660	340	170	340	230



Drip Cup - Large Oval

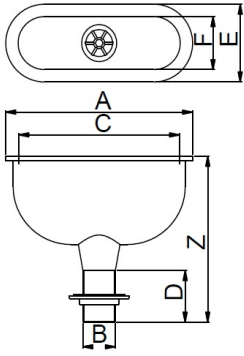

DN	Size	Code	Weight	Z	A	B	C	D	E	F
(mm)	(inch)		(kg)	(mm)	(mm)	(inch)	(mm)	(mm)	(mm)	(mm)
38	1 ½	20014D060	0.450	235	265	1 ½	228	73	110	75



Drip Cup - Small Oval

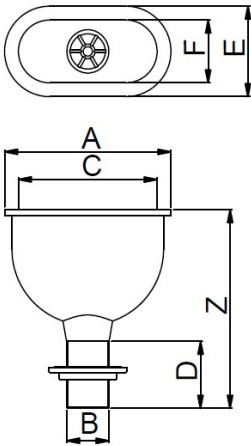

DN	Size	Code	Weight	Z	A	B	C	D	E	F
(mm)	(inch)		(kg)	(mm)	(mm)	(inch)	(mm)	(mm)	(mm)	(mm)
38	1 ½	20014D059	0.360	215	180	1 ½	150	73	98	68



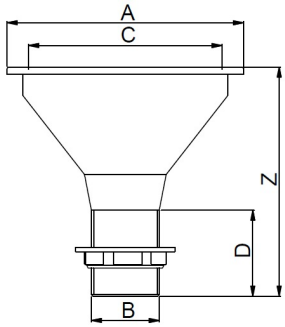

Drip Cup - Large Circular

DN	Size	Code	Weight	Z	A	B	C	D
(mm)	(inch)		(kg)	(mm)	(mm)	(inch)	(mm)	(mm)
38	1 ½	20014D058	0.175	160	165	1 ½	135	60

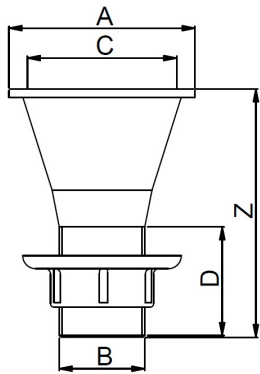

Drip Cup - Small Circular

DN	Size	Code	Weight	Z	A	B	C	D
(mm)	(inch)		(kg)	(mm)	(mm)	(inch)	(mm)	(mm)
38	1 ½	20014D057	0.110	135	101	1 ½	81	60



Fuseal Gullies

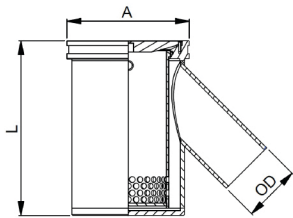

Trapped Floor Gully - 5.0 & 10.0L - with Silt Basket

	DN (mm)	Size (inch)	Code	Weight (kg)	A (mm)	OD (mm)	L (mm)
5 litre	76	3	20014D078	5.740	245	88.9	400
5 litre	102	4	20014D079	6.050	245	114.3	400
10 litre	76	3	20014D080	7.070	245	88.9	560
10 litre	102	4	20014D081	7.490	245	114.3	560

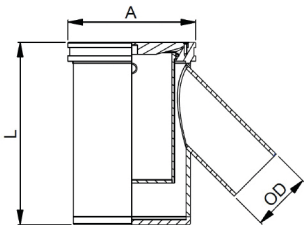
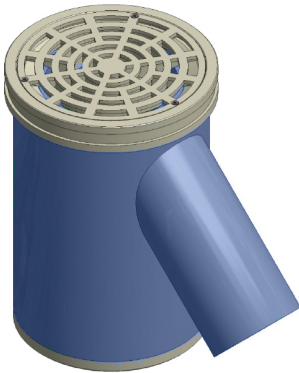

Trapped Floor Gully - 5.0L & 10.0L

	DN (mm)	Size (inch)	Code	Weight (kg)	A (mm)	OD (mm)	L (mm)
5 litre	76	3	20014D074	5.390	245	88.9	400
5 litre	102	4	20014D075	5.700	245	114.3	400
10 litre	76	3	20014D076	6.720	245	88.9	560
10 litre	102	4	20014D077	7.140	245	114.3	560

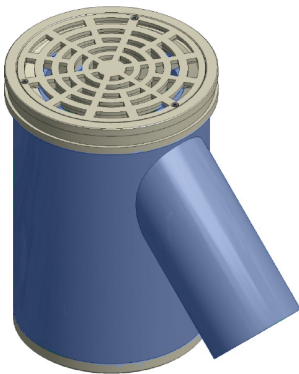

Fuseal Pots

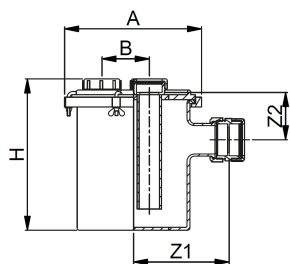

Dilution Pot - 4.5L Borosilicate Glass Base

DN (mm)	Size (inch)	Code	Weight (kg)	INLETS (mm)	Z1 (mm)	Z2 (mm)	A (mm)	B (mm)	H (mm)
38	1 ½	20014D072	2.750	3 x 38	190	100	272	110	306
51	2	20014D073	2.800	3 x 51	190	100	272	110	306

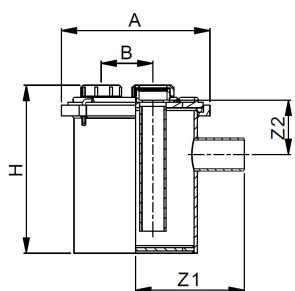

Dilution Pot - 4.5L PP Base

DN (mm)	Size (inch)	Code	Weight (kg)	INLETS (mm)	Z1 (mm)	Z2 (mm)	A (mm)	B (mm)
38	1 ½	20014D070	2.750	3 x 38	198	100	272	110
51	2	20014D071	2.800	3 x 51	198	100	272	110



Dilution Pot - 2.5L Borosilicate Glass Base

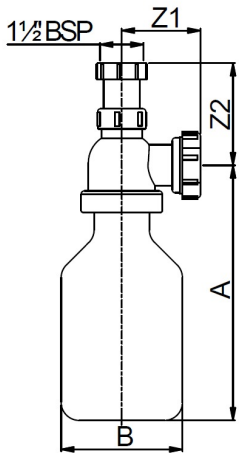

DN (mm)	Size (inch)	Code	Weight (kg)	Z1 (mm)	Z2 Min - Max (mm)	Z2 (min cut dip tube) (mm)	A (mm)	B (mm)
38	1 1/2	20014D069	0.900	89	95 - 140	70	280	135





P-Trap with Union Connection (Slip Joint Inlet x S) (Slip Joint Inlet x FPT)

DN (mm)	Size (inch)	Electrofusion Code	Fast-Lock Code	GJ (mm)	GN (mm)	L1 (mm)	L2 (mm)	L3 (mm)
38	1 ½	527225	375 172 201	114.55	45.72	52.83	92.23	83.82

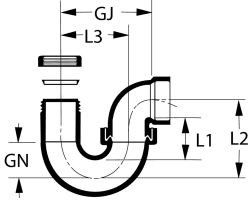

Dilution Pot - 2.2L PP Base

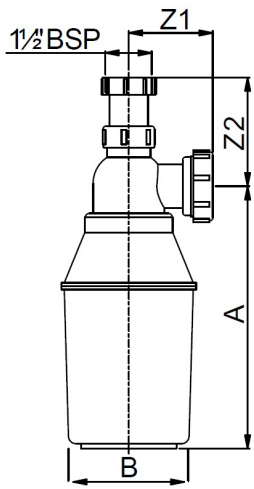

DN (mm)	Size (inch)	Code	Weight (kg)	Z1 (mm)	Z2 Min - Max (mm)	Z2 (min cut dip tube) (mm)	A (mm)	B (mm)
38	1 ½	20014D068	0.520	89	95 - 140	70	275	140



Bottle Trap - Anti-Siphon (With / without Glass Bowl)

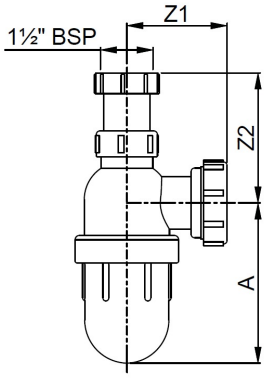

	DN (mm)	Size (inch)	Code	Weight (kg)	Z1 (mm)	Z2 Min - Max (mm)	Z2 (min cut dip tube) (mm)	A (mm)
With PP bowl	38	1 ½	20014D066	0.282	89	95 - 140	70	145
With glass bowl	38	1 ½	20014D067	0.380	89	95 - 140	70	145



Accessories

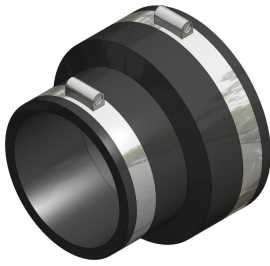

Flexible Adapter Coupling EPDM w/ Clamp

DN x DN (mm)	Size (inch)	Code	Weight (kg)	Range (mm)
51 x 38	2 - 1 ½	20014D045	0.180	53-63 / 40-50
76 x 51	3 - 2	20014D046	0.240	75-89 / 53-63
102 x 76	4 - 3	20014D047	0.320	100-115 / 75-90
102 x 51	4 - 2	20014D048	0.390	110-122 / 60-68
102 x 38	4 - 1 ½	20014D049	0.390	110-122 / 48-56
152 x 102	6 - 4	20014D050	0.630	155-170 / 110-125

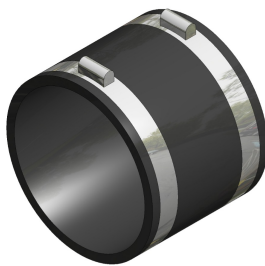

Flexible Drainage Coupling EPDM w/ Clamp

DN (mm)	Size (inch)	Code	Weight (kg)	Range (mm)
38	1 ½	20014D040	0.180	40 - 50
51	2	20014D041	0.250	50 - 65
76	3	20014D042	0.380	80 - 95
102	4	20014D043	0.630	110 - 125
152	6	20014D044	0.780	160 - 175

MSA 2 CF @ 115V - Automatic Electrofusion Unit with protocols retrieval



The MSA 2 CF electro fusion unit combines light weight and high efficiency, thanks to its power switching technology and furthermore provides fusion documentation in PDF. The unit is extremely fast and simple, like COOL-FIT installations, with three basic operations required to the operator: connect, scan, start the fusion.

It is robust, safe and ergonomic.

All is meant to simplify the job: the barcode scanner, for long distance reading, the cooling system to joint in series, the icon system, to keep the interaction between user and machine intuitive. The entire welding process is controlled and regulated with energy output compensation depending on ambient temperature and the indication of cooling time.

The unit has 1000 protocols permanently stored in the internal memory. The user can copy the fusion reports in an USB stick to print them out in PDF format.

Scope of delivery includes: transport box, standard and long angle adapters (4.0 mm), operating instructions, START/STOP badge and USB memory stick with PC applications.

The unit is suitable for welding PE, PP, INSTAFLEX PB d125-225, Fuseald1 1/2"-12" and PPro-Seal 1/2"-3".

Technical Data:

- Operating temperature: -20°C to +50°C
- Mains voltage: 90V - 135V AC
- Mains frequency: 50-60 Hz
- Fusion data input mode: bar code, manual
- Fusion voltage: 3.6-42 V
- Fusion current: 90 A (max)
- Suggested power generators: 3.5 kVA
- Fittings range: d20-d450 (inner diameter) COOL-FIT 2.0/4.0
- Protocols format: PDF and binary (compatible with mini Welding Book)
- USB Port: Type A
- Protection factor: Class 1 / IP 65
- Mains cable: 4 m / Fusion cable: 4 m
- Weight: ca 12.5 kg
- Display: Graphical LCD, adjustable contrast
- Languages support: all

Type	Code	Weight (kg)
Barcode scanner, transport case, mini Welding Book	790 156 023	13.000



SeaDrain/FUSEAL cable adapters

- Ability to joint in parallel up to 4 coils, for SeaDrain, SeaDrain PLUS, Fuseal, PPRo-Seal and Fuseal 25/50
- Compatible with MSA 210-230, MSA 330-340, MSA 250 – 400, MSA 250 – 400 PLUS

Type	Code	Weight (kg)
4 leads cable, 0.6m length	790 156 184	0.400
4 leads cable, 1.6m length	790 156 195	0.400



FUSEAL® benefits

- Low installation cost with maintenance-free service
- Excellent chemical and corrosion resistance
- Flame retardant PP 38mm to 152mm as standard
- Both non-flame and flame retardant PP options 203mm to 457mm
- High temperature, intermittent discharges up to 100°C, continuous up to 82°C
- Electrofusion and mechanical jointing technologies
- Lightweight, easy to use welding machine
- Full system solution
- Off-site fabrications
- Dual containment option

Fields of application

- Corrosive waste drainage
- Education
- Chemical process
- Food and beverage
- Utilities
- Health
- Power generation
- Pharmaceutical
- Industrial

Product range

Fittings	Size	Material	Connection
FUSEAL®	38mm to 152mm	Flame retardant polypropylene	New electrofusion locking collar
FUSEAL® Fast-Lock™	38mm to 102mm	Flame retardant polypropylene	Mechanical joint
FUSEAL®	203mm to 356mm	Flame and non-flame retardant polypropylene	Electrofusion
	406mm to 457mm		Butt fusion

Product range (dual containment)

Pipes	Size	Material
Dual Containment	38mm to 152mm	Flame retardant polypropylene
	203mm to 457mm	Non-flame retardant polypropylene

George Fischer Sales Ltd.
Paradise Way
Coventry, West Midlands
CV2 2ST
+44 (0) 2476 535 535
uk.ps@georgfischer.com
www.gfps.com/uk

CPV Ltd.
Woodington Mill, Woodington Road
East Wellow, Romsey, Hampshire
SO51 6DQ
+44 (0) 1794 322 884
enquiries@cpv.co.uk
www.cpv.co.uk

(12.20) Version 1
© Georg Fischer Piping Systems Ltd
CH-8201 Schaffhausen/Switzerland, 2020