



# 1-1/2" WASTE ARMS WITH SLIP JOINT TECHNICAL SPECIFICATION

Job Name _____	Item # _____
Location _____	
Engineer _____	Contractor _____
PO # _____	Tag _____
Representative _____	

## SPECIFICATIONS

Dearborn Brass 1-1/2" Brass Tubular Waste Arm with Slip Joint Connection are designed for use in tubular drain applications. Available 17, 20, Budget Gauge Brass. Options include Brass Nuts and various lengths for use with Center or End Outlet Waste Assembly.

## DESCRIPTION

- Chrome or Unfinished Brass Finish
- Waste Arm with Slip Joint Connection
  - (1) Waste Arm
  - (1) Nut
  - (1) Rubber Washer

## APPROVALS AND LISTINGS



## DIMENSIONS

[A]:	Outlet A	1.50"	[C]:	Dimension C	0.67"
[B]:	Outlet B	1.50"	[D]:	Length	See Chart A.1

A.1 - LENGTHS					
	Size 7"	Size 11"	Size 15"	Size 20"	Size 23"
<b>Length D:</b>	7"	11"	15"	20"	23"

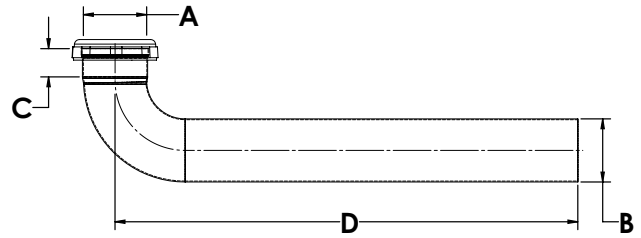

Access BIM/Revit content through [www.oatey.com](http://www.oatey.com)



# 1-1/2" WASTE ARMS WITH SLIP JOINT TECHNICAL SPECIFICATION

## PRODUCT SELECTOR

1-1/2" WASTE ARMS WITH SLIP JOINT				
✓	Product Number	Size	Description	Carton Quantity
	2137-1	7"	Waste Arm for 16" Center Outlet - Budget Gauge	10
	2137B-1	11"	Waste Arm for 24" Center Outlet - Budget Gauge	10
	2137C-1	15"	Waste Arm for 16" Center Outlet - Budget Gauge	10
	137-1	7"	Waste Arm for 16" Center Outlet - 20 Gauge	10
	137C-1	15"	Waste Arm for 16" End Outlet - 17 Gauge	10
	137CBN-3	15"	Waste Arm for 16" End Outlet with Brass Nut - 20 Gauge - Unfinished	10
	137D-1	20"	Waste Arm for 21" End Outlet - 20 Gauge	10
	137E-1	23"	Waste Arm for 24" End Outlet - 20 Gauge	10
	137EBN-3	23"	Waste Arm for 24" End Outlet with Brass Nut - 20 Gauge - Unfinished	10
	137-17BN-1	7"	Waste Arm for 16" Center Outlet with Brass Nut - 17 Gauge	10
	137C-17-1	15"	Waste Arm for 16" End Outlet - 17 Gauge	10
	137C-17BN-3	15"	Waste Arm for 16" End Outlet with Brass Nut - 17 Gauge - Unfinished	10
	137E-17-1	23"	Waste Arm for 24" End Outlet - 17 Gauge	10

Data is subject to manufacturing tolerances.