



# END OUTLET WASTE WITH HI LINE TECHNICAL SPECIFICATION

Job Name _____	Item # _____
Location _____	
Engineer _____	Contractor _____
PO # _____	Tag _____
Representative _____	

## SPECIFICATIONS

Dearborn Brass 1-1/2" Brass Tubular Hi-Line End Outlet Waste is designed for use in tubular drain applications. Available 17, 20, Budget Gauge Brass. Options include 16" or 21" lengths made from Unfinished Brass, Brass Nuts and Baffle Tee.

## DESCRIPTION

- Chrome or Unfinished Brass
- End Outlet Waste with Hi Line
  - (1) Waste Arm
  - (1) Tailpiece
  - (1) Tee
  - (1) Hi Line Nipple
  - (1) Nut
  - (1) Rubber Washer

## APPROVALS AND LISTINGS



## PRODUCT SELECTOR

END OUTLET WASTE WITH HI LINE				
✓	Product Number	Size	Description	Carton Quantity
	2121A-1	1-1/2" x 16"	Center To Center, Hi-Line - Budget Ga.	10
	121A-1	1-1/2" x 16"	Center To Center, Hi-Line - 20 Ga.	10
	121B-1	1-1/2" x 21"	Center To Center, Hi-Line - 20 Ga.	10
	131A-1	1-1/2" x 16"	Center To Center, Hi-Line - 17 Ga.	10

Data is subject to manufacturing tolerances.

## DIMENSIONS

[A]:	Outlet A	1.5"	[E]:	Height B	2.25"
[B]:	Outlet B	1.50"	[F]:	Height C	3"
[C]:	Outlet C	1.50"	[G]:	Tee Height	2.5"
[D]:	Approximate Length A	See Chart A.1			

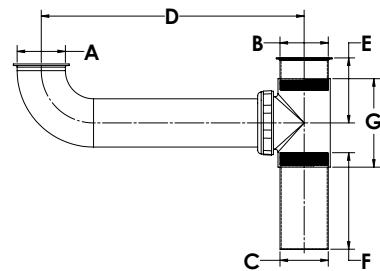

A.1 - WALL TUBE SIZES		
	Size 1-1/2" x 16"	Size 1-1/2" x 21"
<b>Approximate Length A:</b>	16" Center to Center	21" Center to Center

Access BIM/Revit content through [www.oatey.com](http://www.oatey.com)