



Isolation Flanges

NPT AND SWEAT CONNECTIONS



Isolation Flanges

Isolation flanges combine a circulator flange and ball valve to allow the circulator to be isolated from the system for quick and easy removal. Free-floating flanges eliminate the need to align flanges, making pump installation a snap and service or replacement of the circulator simple without the need to drain the system. Lead-free* brass and non-ferrous wetted internal components make the isolation flanges ideal for hydronic heating systems. Capscrews and nuts are included, and the isolation flange fits the Bell & Gossett ecocirc 20-18, ecocirc XL, NRF/NBF/SSF wet rotors, Series PL, Series 100, HV, PR and LR circulators.

Typical Specifications

Furnish and install on plans _____ inches NPT/Sweat x Flange Isolation Flanges each side of the circulator(s). When closed, the isolation flanges isolate the circulator from the rest of the system so the system does not need to be drained when removing the circulator. The isolation valve shall be constructed with a brass body, chrom plate brass ball, chrome plated steel flange and handle, and Teflon packing and seat ring. The mating flange shall be free floating allowing it to rotate eliminating the need to align the bolt holes of the flanges when installing to the system piping. The isolation flange shall be Xylem Bell & Gossett or equal.

Available Sizes: 3/4", 1" 1-1/4" & 1-1/2" (refer to dimension and weight table for details)

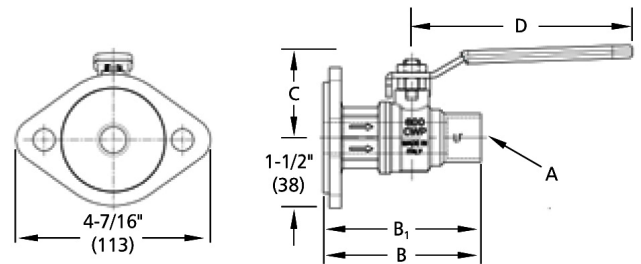

Operating Data

Maximum Working Pressure.....150 psi (10 bar)
Maximum Operating Temperature.....250°F (121°C)

Materials of Construction

Valve Body.....Lead-Free* Brass
Flange.....Chrome Plated Steel
Ball.....Chrome Plated Lead-Free* Brass
Packing.....Teflon®**
Seat Ring.....Teflon
Stem.....Lead-Free** Brass

*CSA certified to NSF/ANSI 372 that product contains less than 0.25% lead content by weight on wetted surface

**Teflon is a registered trademark of E.I. du Pont de Nemours and Company

Dimensions and Weights

Model No.	Size Inches	Use with Following Circulators	DIMENSIONS – in inches (mm)				Approx. Shipping Wt. Lbs. (Kg)	
			A	B	C	D		
101221LF	3/4" NPTF IF	ecocirc 20-18/ecocirc+ 20-18 ecocirc XL 20-35, 36-45, 55-45 NRF/NBF/SSF Wet Rotor Series PL-30, PL-36, PL-55, PL-100 Series 100, PR, and LR	3/4" NPT	2-27/64" (61.5)	2" (50.5)	4-47/64" (120.0)	3.2 (1.2)	
101222LF	1" NPTF IF		1" NPT	2-57/64" (73.3)	2-5/32" (54.7)	4-47/64" (120.0)	4.1 (1.9)	
101223LF	1-1/4" NPTF IF		1-1/4" NPT	3-19/64" (84.0)	3" (75.9)	6-7/32" (158.0)	5.8 (2.6)	
101241LF	1-1/2" NPTF IF		1-1/2" NPT	3-23/64" (85.5)	3" (75.9)	6-7/32" (158.0)	6.1 (2.8)	
101261LF	3/4" SWT IF		3/4" SWT	2-41/64" (67.5)	2" (50.5)	4-23/32" (120.0)	3.2 (1.5)	
101271LF	1" SWT IF		Does not include NRF/NBF-45	1" SWT	3" (75.3)	2-5/32" (54.7)	4-23/32" (120.0)	3.9 (1.8)
101281LF	1-1/4" SWT IF		1-1/4" SWT	3-25/64" (86.0)	3" (75.9)	6-7/32" (158.0)	5.4 (2.5)	
101243LF	1-1/2" SWT IF		1-1/2" SWT	3-35/64" (90.0)	3" (75.9)	6-7/32" (158.0)	6 (2.7)	

IF = Isolation Flange

Dimensions and weights are approximate and subject to change. Contact factory for certified dimensions. The part numbers and shipping weights are for two isolation flanges, capscrews and nuts.



Xylem Inc.
8200 N. Austin Avenue
Morton Grove, Illinois 60053
Phone: (847) 966-3700
Fax: (847) 965-8379
www.xylem.com/bellgossett

Xylem and Bell & Gossett are registered trademarks of Xylem Inc. or one of its subsidiaries. All other trademarks or registered trademarks are property of their respective owners.
© 2022 Xylem Inc. A-117H November 2022