

SSPEX-E SERIES STAINLESS STEEL PEX ELBOW

SPECIFICATION:

- These 90° elbows are formed to create a smooth channel which gives a greater flow area and less restriction
- For use with ASTM F2769, ASTM F2023, (PE-RT) SDR9 pipe
- For use with ASTM F876 PEX pipe
- Fittings are made to ASTM F1807 standard
- Maximum Pressure Rating: 200 PSI
- Temperature Range: Up to 400°F (204°C)



CERTIFICATION:

- cUPC Listed
- NSF/ANSI 61 & 372 Certified



MATERIAL LIST	
Name	Percent of Composition
304 Stainless Steel	
Iron (Fe)	64.0 - 72.0
Carbon (C)	0.08 max
Silicone (Si)	1.00 max
Manganese (Mn)	2.00 max
Phosphorus (P)	0.04 max
Sulfur (S)	0.04 max
Chromium (Cr)	18.0 - 21.0
Nickel (Ni)	8.0 - 11.0

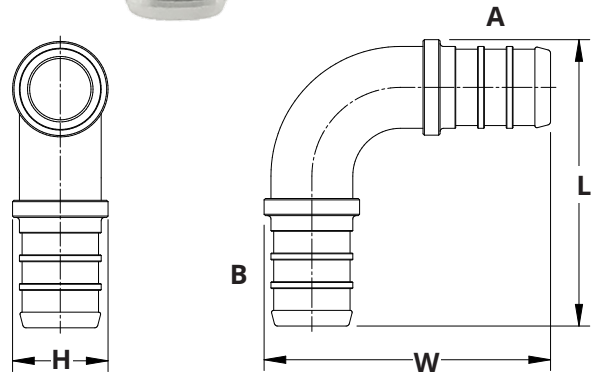

DIMENSIONS										
Part No.	Nominal Pipe Size		L		W		H		Weight	
	A	B	inches	mm	inches	mm	inches	mm	lbs	grams
SSPEX-E05	1/2"	1/2"	1.60	40.64	1.55	39.37	0.60	15.24	0.05	22.68
SSPEX-E0705	3/4"	1/2"	1.70	43.18	1.65	41.91	0.75	19.05	0.08	36.29
SSPEX-E07	3/4"	3/4"	1.90	48.26	1.80	45.72	0.75	19.05	0.09	40.82
SSPEX-E10	1"	1"	2.50	63.5	2.60	66.04	1.00	25.40	0.19	86.18



25 Whaley Avenue, PO Box 310, Milverton, ON CANADA N0K 1M0
Tel: 800-561-3164

boshart.com ♦ blog.boshart.com