

\$13.50

Auwe-co[®]

PRODUCTS

Over 23,000 Items Available



**The Encyclopedia of the
Automotive Body Hardware Industry**

PAN'L BLIND RIVETS

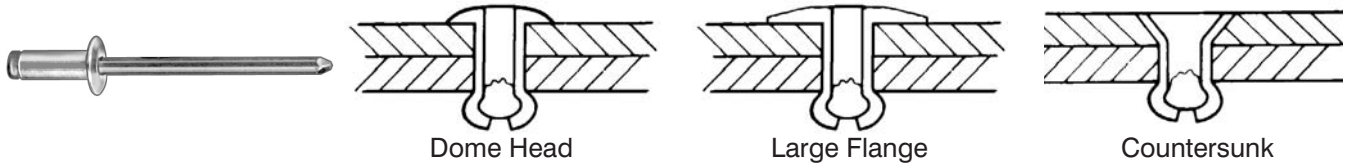

Auveco Part No.				Head (Flange) Type & Diameter	Rivet Diameter	Grip Range	Rivet Length Exc. Flange	Cross Reference	
Unit	Package	Quantity	POP®					Marson Klik-Fast	

Aluminum Rivet • Steel Mandrel

25	50	100	500	1000	Dome 1/4"	1/8"	1/16" - 1/8"	7/32"	AD42BS	AB4-2
					Cntrs nk 7/32"	1/8"	1/16" - 1/8"	7/32"	AK42BS	AC4-2
					Dome 1/4"	1/8"	3/16" - 1/4"	3/8"	AD44BS	AB4-4
					Cntrs nk 7/32"	1/8"	3/16" - 1/4"	3/8"	AK44BS	AC4-4
					Dome 1/4"	1/8"	3/8" - 1/2"	41/64"	AD48BS	AB4-8
					Dome 5/16"	5/32"	3/16" - 1/4"	27/64"	AD54BS	AB5-4
					Dome 3/8"	3/16"	1/16" - 1/8"	9/32"	AD62BS	AB6-2
					Dome 3/8"	3/16"	1/8" - 1/4"	3/8"	AD64BS	AB6-4
					Dome 3/8"	3/16"	1/4" - 3/8"	9/16"	AD66BS	AB6-6
					Lg Flange 5/8"	3/16"	3/8" - 1/2"	11/16"	AD68BSLF	ABL6-8

Aluminum Rivet & Mandrel

					Dome 3/16"	3/32"	1/32" - 1/8"	15/64"	AD32ABS	AB3-2A
					Dome 1/4"	1/8"	1/16" - 1/8"	7/32"	AD42ABS	AB4-2A
					Cntrs nk 7/32"	1/8"	1/16" - 1/8"	7/32"	AK42ABS	AC4-2A
					Lg Flange 3/8"	1/8"	1/16" - 1/8"	7/32"	AD42ABSLF	ABL4-2A
					Dome 1/4"	1/8"	3/16" - 1/4"	3/8"	AD44ABS	AB4-4A
					Cntrs nk 7/32"	1/8"	3/16" - 1/4"	3/8"	AK44ABS	AC4-4A
					Lg Flange 3/8"	1/8"	3/16" - 1/4"	3/8"	AD44ABSLF	ABL4-4A
					Dome 1/4"	1/8"	5/16" - 3/8"	1/2"	AD46ABS	AB4-6A
					Dome 1/4"	1/8"	3/8" - 1/2"	5/8"	AD48ABS	AB4-8A
					Lg. Flange 3/8"	1/8"	3/8" - 1/2"	5/8"		ABL4-8A
					Dome 5/16"	5/32"	1/16" - 1/8"	9/32"	AD52ABS	AB5-2A
					Dome 5/16"	5/32"	1/8" - 3/16"	11/32"	AD53ABS	AB5-3A
					Dome 5/16"	5/32"	3/16" - 1/4"	13/32"	AD54ABS	AB5-4A
					Lg Flange 15/32"	5/32"	3/16" - 1/4"	13/32"	AD54ABSLF	
					Dome 5/16"	5/32"	1/4" - 3/8"	1/2"	AD56ABS	AB5-6A
					Dome 5/16"	5/32"	3/8" - 1/2"	5/8"	AD58ABS	AB5-8A
					Dome 3/8"	3/16"	1/16" - 1/8"	9/32"	AD62ABS	AB6-2A
					Dome 3/8"	3/16"	1/8" - 1/4"	7/16"	AD64ABS	AB6-4A
					Lg Flange 5/8"	3/16"	1/8" - 1/4"	7/16"	AD64ABSLF	ABL6-4A
					Dome 3/8"	3/16"	1/4" - 3/8"	9/16"	AD66ABS	AB6-6A
					Lg Flange 5/8"	3/16"	1/4" - 3/8"	9/16"	AD66ABSLF	ABL6-6A
					Dome 3/8"	3/16"	3/8" - 1/2"	11/16"	AD68ABS	AB6-8A
					Lg Flange 5/8"	3/16"	3/8" - 1/2"	11/16"	AD68ABSLF	ABL6-8A
					Dome 3/8"	3/16"	1/2" - 5/8"	13/16"	AD610ABS	AB6-10A
					Lg Flange 5/8"	3/16"	1/2" - 5/8"	13/16"	AD610ABSLF	ABL6-10A
					Dome 1/2"	1/4"	1/4" - 3/8"	39/64"	AD86ABS	AB8-6A

Stainless Steel Rivet & Mandrel

					Dome 1/4"	1/8"	3/16" - 1/4"	25/64"	SSD44SSBS	SSB4-4S
					Dome 3/8"	3/16"	3/8" - 1/2"	11/16"	SSD68SSBS	SSB6-8S

Stainless Steel Rivet • Steel Mandrel

Replaces Ford No.: 383229-S
To replace welded studs on body. (Use Auveco Rivet Gun 7915 with 7981 Nose Piece.)

					Sm. Flange 3/16"	1/8"	3/16" - 1/4"	5/16"	R4357	SSBN4-3
--	--	--	--	--	------------------	------	--------------	-------	-------	---------



Steel Rivet Washers
Zinc

16791

Outer Diameter: 1/2"
For 1/8" Diameter

UNIT PACKAGE: 100

15973

Outer Diameter: 1/2"
For 5/32" Diameter

UNIT PACKAGE: 100

16792

Outer Diameter: 15/32"
For 3/16" Diameter

UNIT PACKAGE: 100

22409

Economy Rivet Gun

Photo not actual size



Overall Length: 10"
With 3/32", 1/8", 5/32" and 3/16" nose pieces.
Replacement accessories are not available

UNIT PACKAGE: 1

7915

Pan'l Rivet Gun

Photo not actual size



Overall Length: 9-1/2"
With 3/32", 1/8", 5/32" and 3/16" nose pieces

UNIT PACKAGE: 1



19215

Replacement Jaws for
Auveco Rivet Gun 7915

UNIT PACKAGE: 1 Set



Nose Pieces

For Auveco Rivet Gun 7915

Auveco Part No.	Description	Unit Pkg.
7981	Use with 1/8" rivet 11104 to replace welded studs	1
7983	For 1/8" diameter rivets	1
7984	For 5/32" diameter rivets	1
7985	For 3/16" diameter rivets	1

11817

Photo not actual size



Rivet gun for setting 3/16" & 1/4" rivets.
Use to install "Peel-Type" Rivets.
Comes complete with 3/16" and 1/4" standard nose pieces plus a nose piece for 1/4" "Peel Type" rivets.
Length: 22"

UNIT PACKAGE: 1



19132

Nose piece for 1/8" standard rivets
Auveco 11817 Accessory

UNIT PACKAGE: 1



19133

Nose piece for 3/16" standard rivets
Auveco 11817 Accessory

UNIT PACKAGE: 1



19134

Nose piece for 1/4" standard rivets
Auveco 11817 Accessory

UNIT PACKAGE: 1



11853

Nose piece for 1/4" "Peel Type" rivets.
Auveco 11817 Accessory

UNIT PACKAGE: 1



14799

Replacement jaws repair kit for
Auveco Rivet Gun 11817

UNIT PACKAGE: 1



21655

Nose Piece
For 3/16" Monobolts
Auveco 11817 Accessory

UNIT PACKAGE: 1



21656

Nose Piece
For 1/4" Monobolts
Auveco 11817 Accessory

UNIT PACKAGE: 1



13808

For 3/16" Rivets
Nose piece for setting
Auveco Klamp-Tite Rivets with
a Pneumatic Tool.

UNIT PACKAGE: 1



19066
Rivet Gun

Photo not actual size

Overall Length: 21"
With nose pieces for 3/32", 1/8", 5/32",
3/16" & 1/4" diameter rivets.

UNIT PACKAGE: 1



13756

Rivet Setter Gun
For Nylon Rivets

For use with nylon
(plastic) blind rivets.

A durable tool that sets all
sizes with a single stroke.
All steel construction.
Not for use with metal rivets.
Length: 6-1/2"

UNIT PACKAGE: 1

TIPS FOR NAVIGATING THE CATALOG

• Color Coded Pages

Yellow- New Items

Blue- Metric Items

Brown- Electric Accessories

Green- Assortments, Cabinets,
Bins and Racks

Gray- Key Blanks & Accessories

Pink- Import Car Body Hardware

• Specification Charts

Body Bolts- Pages: 88 & 121-122

Special Tapping Screws- Pages: 91-94 & 128-130

License Plate Screws- Pages: 105-106

Retainers- Pages: 475-489

Push-Type Retainers- Pages: 534-545

• Indexes. Located in the front

Pictorial

Alphabetical

Numerical

• Images are actual size unless noted otherwise

• OEM Part Cross Reference: Indexed
according to OEM number and Part Number.
Located in the back

Located in the front after the numerical index

• Screw Identification charts: head styles,
driving recesses, point styles and sizing.

• List of common terminology with brief
descriptions

• Plating and finish types with brief descriptions

Sec. 14

AUTOMOTIVE O.E.M. NYLON BLIND RIVETS

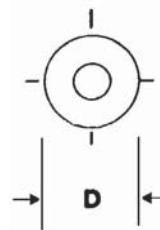
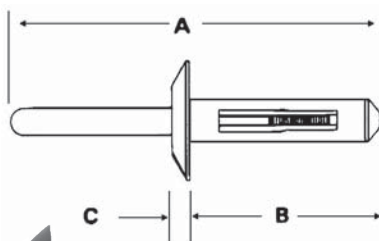
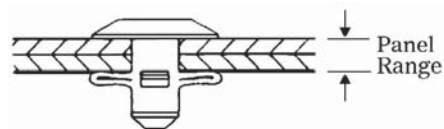

Type 1

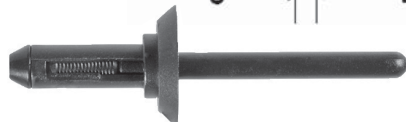

Type 2



Type 3



Type 4



Type 5



Type 6

Auveco Part No.	Type	Color	O.E.M. Number	Hole Diameter	Panel Range (Grip)	A	B	C	D	Unit Pkg.
17220	3	Black	GM: 21094747	5/32"	7/64"-7/32"	1-7/8"	3/4"	3/32"	**	50
15187	6	Black	Ford: N804583S	4mm	6mm-10.5mm	65mm	26mm	2.5mm	***	25
13746	1	Black	GM: 20612732	3/16"	1/16"-9/64"	1-7/8"	23/32"	3/32"	11/32"	25
18501	1	Black	Chry: 6502689	3/16"	5/32"-1/4"	1-27/32"	21/32"	1/16"	11/32"	25
21327	1	Black	GM: 11588308	4.95mm	3mm - 6mm	48mm	18mm	1.7mm	9mm	25
13747	1	Black	GM: 20423647, Ford: N804189S	13/64"	1/16"-11/64"	1-7/8"	23/32"	1/8"	15/32"	25
14005	1	Black	GM: 20465395, Chry: 6004212	13/64"	1/8"-5/32"	1-13/16"	21/32"	1/16"	11/32"	25
13748	1	Black	GM: 20432975, VW:175-853-57701C, Chry: 6503800, Ford: N804343S	13/64"	1/8"-15/64"	1-7/8"	25/32"	1/16"	15/32"	25
13754	1	Black	Chry: 6500859	13/64"	1/8"-3/16"	1-7/8"	25/32"	1/16"	15/32"	25
13755	1	Black	Chry: 6500898 GM: 15718794	13/64"	15/64"-25/64"	2"	1"	1/16"	15/32"	25
14004	1	Black	GM: 25524005	15/64"	11/64"-11/32"	2-3/64"	1-1/8"	3/32"	1/2"	25
14023	1	Black	GM: 10036503	15/64"	5/32"-5/16"	2-1/8"	1-5/32"	3/32"	5/8"	25
18913	1	Black	Chry: 6503938	15/64"	5/32"-9/32"	2-5/32"	1-1/16"	3/32"	1/2"	25
20754	1	Black	BMW: 51-71-7-002-953-2	6mm	2.5mm-4.8mm	53mm	22mm	2.5mm	20mm	25
18028	2	Black	Chry: 4630088	1/4"	1/32"-11/64"	2-3/16"	13/16"	3/32"	21/32"	25
18031	2	Black*	Chry: 4630660	1/4"	1/32"-3/16"	2-1/8"	3/4"	3/32"	21/32"	25
15488	4	Black	GM: 10069112	1/4"	3/64"-5/32"	2-3/16"	15/16"	7/64"	13/16"	50
18242	5	Black	Chry: 6501509	1/4"	3/64"-3/16"	2-7/32"	1-1/8"	3/32"	25/32"	25
13749	1	White	GM: 14070914	1/4"	5/32"-15/64"	2-3/16"	23/32"	3/32"	21/32"	25
21446	1	Black	Chry: 6508444-AA	1/4"	5/32"-15/64"	2-3/16"	1-1/8"	3/32"	1-1/32"	15
18502	1	Black	General Purpose	1/4"	5/32"-1/4"	2-3/16"	23/32"	3/32"	21/32"	25
21028	1	Black	GM: 15614746	1/4"	5/32"-3/8"	2-3/16"	1-1/8"	3/32"	21/32"	25
18108	1	Black	Chry: 34201631	1/4"	5/32"-3/8"	2-7/32"	1-1/8"	3/32"	11/16"	25
17496	1	Gray	AMC: 8934-201-835	1/4"	5/32"-3/8"	2-7/32"	1-1/8"	3/32"	11/16"	25
14012	1	White	GM: 15506827	1/4"	5/32"-13/32"	2"	1-1/8"	3/32"	21/32"	25

* Black Rivet Body, White Mandrel

** 5/16" x 19/32"

*** 8.5mm x 15.5mm

(Continued on next page)

AUTOMOTIVE O.E.M. NYLON BLIND RIVETS

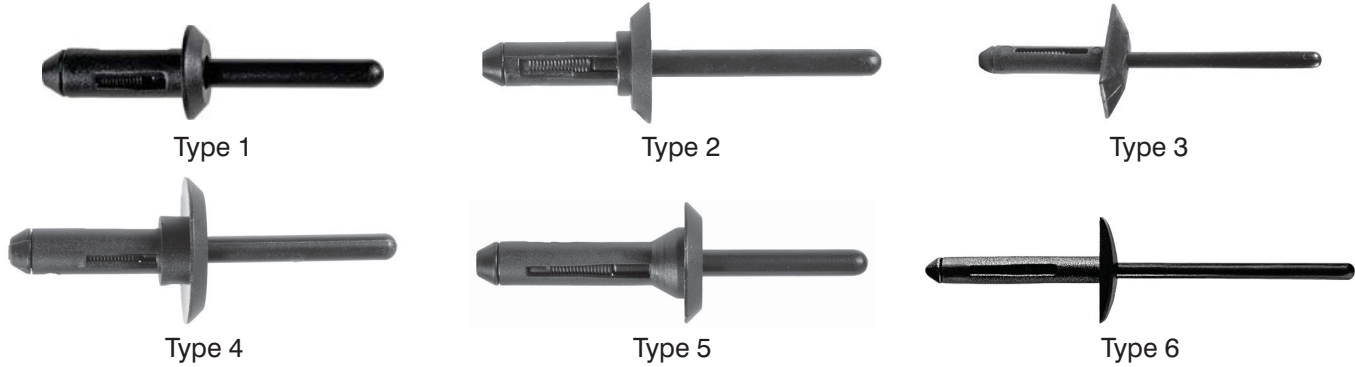

Auveco Part No.	Type	Color	O.E.M. Number	Hole Diameter	Panel Range (Grip)	A	B	C	D	Unit Pkg.
13751	1	Black	GM: 10184895 Ford: N803862-S Chry: 6501559,6506007-AA	1/4"	5/32"-13/32"	2-3/16"	1-3/32"	3/32"	1/2"	25
13750	1	Black	GM: 14063981 Ford: N803043-S Chry: 6500911, 6504700	1/4"	5/32"-13/32"	2-3/16"	1-3/32"	3/32"	21/32"	25
15491	1	Black	Ford: N804759-S	1/4"	19/64"-27/64"	2-1/8"	13/16"	3/32"	21/32"	25
17101	1	Black	Ford: N804675S Chry: 4370138, 6503860	1/4"	5/16"-15/32"	2-9/32"	1-1/4"	3/32"	21/32"	25
22139	4	Black	Ford: N803739-S	6.3mm	.70-.85mm	56mm	20mm	3mm	18mm	25
13752	1	Black	GM: 15955172, 20421672	17/64"	3/32"-3/16"	1-7/8"	25/32"	3/32"	1/2"	25
13753	1	Black	GM: 20433026 VW: 175-853-577A	17/64"	3/32"-3/16"	1-7/8"	25/32"	3/32"	23/32"	25
15490	1	Black	GM: 10109689, 12337915	9/32"	3/32"-15/64"	2-3/16"	15/16"	3/32"	23/32"	25

Note: Use rivet guns 13756 to install all of the above rivets.

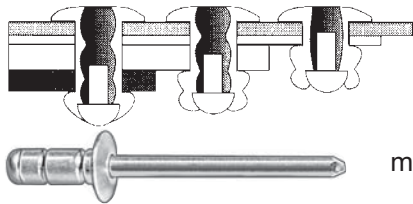

POP® MULTI-GRIP BLIND RIVETS

Functions in a Wide Range of Material Thickness

The Multi-Grip rivet will serve in applications where solid, soft materials and thicknesses normally require several rivet sizes. Oversize, irregular or misaligned holes are automatically compensated for by self-adjusting hole-filling capability. The mandrel head is retained in the rivet body, forming a tight, weather resistant seal.

Auveco Part No.	Head Style & Diameter	Rivet Diameter	Hole Size	Grip Range	Rivet Length Excluding Flange	Unit Pkg.	Pop® No.
Aluminum Rivet • Steel Mandrel							
19033	Large Flange 3/8"	1/8"	.129"-.142"	3/64"-3/16"	21/64"	100	AD41-43BSLF
19025	Dome 1/4"	1/8"	.129"-.142"	5/32"-5/16"	15/32"	100	AD43-45BS
19034	Large Flange 3/8"	1/8"	.129"-.142"	5/32"-5/16"	15/32"	100	AD43-45BSLF
19026	Dome 1/4"	1/8"	.129"-.142"	1/4"-7/16"	39/64"	100	AD45-47BS
18743	Dome 5/16"	5/32"	.160"-.173"	3/64"-1/4"	13/32"	100	AD52-54BS
17468	Large Flange 15/32"	5/32"	.160"-.173"	3/64"-1/4"	13/32"	50	AD52-54BSLF
19027	Dome 5/16"	5/32"	.160"-.173"	1/8"-5/16"	1/2"	50	AD53-55BS
18744	Dome 3/8"	3/16"	.192"-.205"	1/16"-1/4"	7/16"	50	AD62-64BS
19036	Large Flange 5/8"	3/16"	.192"-.205"	1/16"-1/4"	7/16"	50	AD62-64BSLF
19028	Dome 3/8"	3/16"	.192"-.205"	3/16"-3/8"	5/8"	50	AD63-66BS
19029	Dome 3/8"	3/16"	.192"-.205"	1/4"-1/2"	47/64"	50	AD66-68BS
19037	Large Flange 5/8"	3/16"	.192"-.205"	1/4"-1/2"	47/64"	50	AD66-68BSLF
19030	Dome 3/8"	3/16"	.192"-.205"	7/16"-3/4"	1-1/16"	50	AD68-612BS
19031	Dome 1/2"	1/4"	.261"-.275"	5/64"-11/32"	39/64"	25	AD82-86BS

What makes Avex different and better?

The Avex rivet adds important and exclusive features to those offered by ordinary blind rivets. The unique advantages designed into the Avex rivet allow for its use:

In wide-tolerance holes. Since the rivet can expand up to its own head diameter, accurate hole sizing or alignment is not necessary.

To pull sheets together. The extraordinary rivet tail expansion automatically effects superior clamp-up action on the parts being assembled.

Over a vast range of thicknesses. The “dubble-bubble” expansion feature offers the capability to fasten securely in both thick and thin grip ranges with a single length rivet.

While providing a sealed stem. The rivet material flows both behind and in front of the mandrel insuring a positively retained and sealed stem.

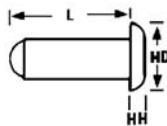

Dome Head

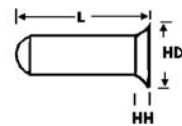

120° Countersunk

Auveco Part No.				Head (Flange) Style	Rivet Diameter	Grip	Length L	Flange Diameter HD	Flange Height HH	Hole Size
Unit	Package	Quantity								
25	100	500	1000							
	10336	10337		Countersunk	1/8"	To 1/4"	15/32"	.205"	.030"	.136"
	10351	10352		Dome	5/32"	To 1/4"	15/32"	.255"	.057"	.166"
	10357	10358	10359	Dome	3/16"	To 7/16"	23/32"	.349"	.070"	.199"
	10345	10346		Countersunk	3/16"	To 1/2"	25/32"	.339"	.050"	.199"
17654	17655			Dome	1/4"	To 11/32"	21/32"	.500"	.094"	.268"

Avex® Brazier Head Rivet



17433
Yellow Zinc

Diameter: 3/16"
Grip: 3/16"-7/16"
Head Diameter: 15/32"
Body Length: 11/16"
Aluminum Rivet & Steel Mandrel

UNIT PACKAGE: 50

Large Head 3/16" Plywood Rivets



Non-Structural
Break Mandrel Rivets
Aluminum Rivet & Steel Mandrel (Plated)

Auveco Part No.	Grip	Head Diameter	Head Thickness	Hole Size & Drill	Unit Pkg.
13805	3/8"-1/2"	5/8"	3/32"	.192 to .196"	50
13807	7/8"-1"	5/8"	3/32"	#11	50

Stavex® Large Flange Rivets

- Large flange head enables soft, pliable materials to be fastened
- All steel construction (zinc plated) provides high shear and tensile values.
- Typical applications:
 - Plastic energy absorbing strip to automotive bumper
 - Plywood liners to both sidewalls and roofs in truck bodies and trailers



Auveco Part No.	Diameter	Grip	Flange Diameter	Hole Size	Unit Pkg.
16988	3/16"	3/64"-1/4"	5/8"	.192-.196"	25
16989	3/16"	1/16"-3/8"	5/8"	.192-.196"	25

Auveco Klamp-Tite Rivets

- Largest Blind Head
 - Fills hole tightly
 - High Clamp-Up
- Water Tight Capability
 - Fully Cored
- Structural- Self Plugging
- Head Style- Protruding

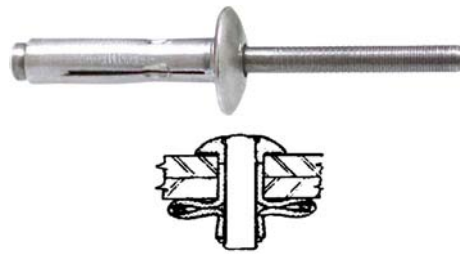

Mandrel breaks flush with top of rivet head anywhere within grip range.

Material: Rivet 5056 Aluminum,
Mandrel 7075 Aluminum
Finish: Wax (Do Not Remove)

Note: For use with pneumatic tool using 13808 (3/16") nose piece on page 296.

Auveco Part No.	Unit Pkg.	Rivet Diameter	Grip Range	Hole & Drill Size	Mandrel Diameter	Head Diameter	Head Thickness	Rivet Length Max
13766	50	3/16	3/64" - 1/4"	.204-.209 (#5)	.103	.445	.088	.890
13767			3/16" - 3/8"					.985
13768			3/8" - 9/16"					1.045
13769	25	1/4	3/64" - 1/4"	.252-.262 (F)	.136	.560	.113	.920
13770			3/16" - 3/8"					1.045

Blind Tacking Rivets

- Steel Rivet: Plated
- Non-Structural: Break mandrel rivets
 - Steel Mandrel: Coated
- Conform to IFI-114 Standards

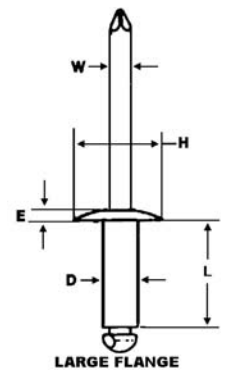
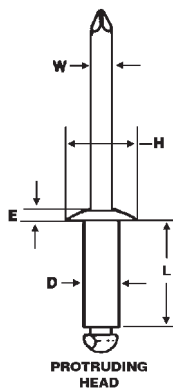

Nom. Rivet Diameter	Hole Size & Drill Number	W Mandrel Diameter	D Rivet Diameter	Protruding Head		Large Flange Head	
				H Head Diameter	E Max.	H Head Diameter	E Max.
1/4"	.257-.261 (F)	.151	.250	.500	.080	.750	.107

Auveco Part No.	Head Style	Rivet Diameter	Grip	Rivet Length L	Unit Pkg.
13796	Large Flange	1/4"	1/2" - 5/8"	13/16"	25

Large Secondary Head Rivets



Rivets that fasten securely into thick and thin materials. Will pull soft or brittle materials. Can be used in an oversized hole.

Auveco Part No.	Head (Flange) Type & Diameter	Rivet Diameter	Grip Range	Rivet Length Excluding Flange	Unit Pkg.
Aluminum Rivet & Mandrel					
17471*	Dome 5/16"	1/8"	5/64"-3/8"	31/32"	25
19062	Dome 5/16"	5/32"	0-1/4"	23/32"	25

* Not a Split Type

Monobolt® Fastening System

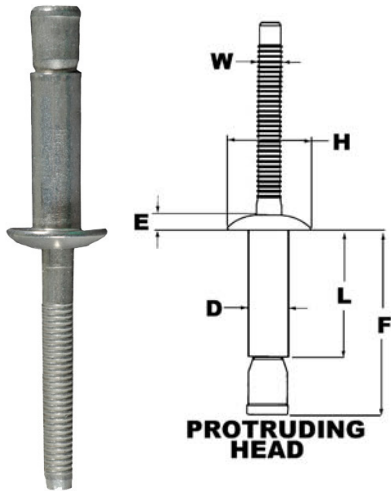

Nom. Rivet Diameter	Hole Size & Drill Number	W Mandrel Diameter	D Rivet Diameter	Protruding Head	
				H Head Diameter	E Head Max.
3/16	.191-.201 (#11)	.118	.187	.390	.070
1/4	.261-.272(G)	.157	.257	.515	.100

Typical Rivet Shear and Tensile Strength (lbs) and Mandrel push-out when installed in Nominal Grip.

Rivet Diameter	Aluminum Rivet & Mandrel			Steel Rivet & Mandrel		
	Shear	Tensile	Mandrel Push-out	Shear	Tensile	Mandrel Push-out
3/16	625	500	50	1300	1000	100
1/4	1300	890	100	2400	2150	250

Auveco Part No.	Diameter	Grip	DIM "L"	DIM "F"	Head Style	Material	Unit Pkg.
12080	3/16"	.062/.270	.406	.748	Protruding	Steel-Zinc Plated	25
12088	3/16"	.062/.270	.406	.748	Protruding	Steel-Zinc Plated	100
12081	3/16"	.214/.420	.531	.882	Protruding	Steel-Zinc Plated	25
12089	3/16"	.214/.420	.531	.882	Protruding	Steel-Zinc Plated	100
12084	1/4"	.080/.375	.550	.971	Protruding	Steel-Zinc Plated	25
12092	1/4"	.080/.375	.550	.971	Protruding	Steel-Zinc Plated	100
12085	1/4"	.350/.625	.855	1.123	Protruding	Steel-Zinc Plated	25
12093	1/4"	.350/.625	.855	1.123	Protruding	Steel-Zinc Plated	100
12086	1/4"	.080/.375	.550	.961	Protruding	Aluminum	25
12094	1/4"	.080/.375	.550	.961	Protruding	Aluminum	100
13773	1/4"	.350/.625	.810	1.174	Protruding	Aluminum	25
13774	1/4"	.350/.625	.810	1.174	Protruding	Aluminum	100

The System

Blind Installation: The single side installation feature of the Auveco Monobolt System allows one operator to produce high quality structural joints in seconds. Use of the Monobolt power tool does not require special skill or training, because the tool completely controls the installation cycle.

Multi-Grip: One size Monobolt fastener will function effectively in a wide range of material thicknesses (Example: .080" to .375"). This versatility decreases the potential for production errors and reduces fastener inventory requirements.

Uniform Clamping Action: Monobolt fasteners are engineered to draw materials together by developing positive clamping action.



Its Advantages

Structural Fastening: An installed Monobolt fastener yields high shear and tensile values. Conventional fasteners can be replaced by Monobolt without compromising structural requirements.

Positive Stem Retention: At the completion of the installation cycle, the stem is mechanically locked into the Monobolt shell, creating a vibration-proof joint of assured structural quality.

Flush Break Stem: Within the specific grip range for each size, Monobolt fastener, the stem is designed to break flush with the low profile head. Secondary finishing operations, such as grinding or milling, are not necessary to achieve good product appearance.

Complete Hole Fill: During installation, the Monobolt shell expands into 360° contact with the walls of the parent material. This feature, in conjunction with positive stem retention, produces weather resistant joints.

Quiet, Safe Installation: The Monobolt System, operating at 85db ("A" Weighted), complies with OSHA regulation governing plant noise levels and operator safety

How it Works



1. The Monobolt fastener is loaded into the nose of the placing tool and inserted in a prepared hole. As the tool is actuated, the pulling jaws grip the Monobolt stem.



2. An axial pull draws the stem through the shell, expanding it radially. During this phase, the hole is completely filled and work pieces are drawn together.



3. When the stem reaches a pre-determined position within the Monobolt shell, it separates flush with the head profile regardless of work piece thickness. Simultaneously, the stem section remaining in the shell is mechanically locked in place by the Monobolt tool.

Interlock® Dome Head High Strength Rivets



High strength Interlock® rivets feature a positive mechanical locking system that provides superior holding power. This system also guarantees 100% mandrel retention that's visually verifiable. Can be set with Auveco Rivet Gun 11817.

Auveco Part No.	Rivet Diameter	Grip Range	Rivet Body Length	Head Diameter	Unit Pkg.	Conversion			
						Interlock®	Cherry Monobolt	Avdel Monobolt	Huck Magna-lock
Aluminum Rivet & Mandrel									
17421	3/16"	1/16" - 17/64"	13/32"	3/8"	25	AD6270UG	BAPV-64	2774-0613	MGLP-B6-4
17422	3/16"	1/16" - 7/16"	9/16"	3/8"	25	AD6437UGX		2774-0617	MGLP-B6-E
17423	1/4"	5/64" - 3/8"	9/16"	1/2"	25	AD8375UG	BAPV-86	2774-0817	MGLP-B8-6
17424	1/4"	5/64" - 5/8"	13/16"	1/2"	15	AD8625UGX		2774-0824	MGLP-B8-E
Steel Rivet & Mandrel									
17425	3/16"	1/16" - 17/64"	13/32"	3/8"	25	SD6270UG	SSPV-64	2771-0613	MGLP-R6-4
17427	1/4"	5/64" - 3/8"	9/16"	1/2"	25	SD8375UG	SSPV-86	2771-0817	MGLP-R8-6
17428	1/4"	5/64" - 5/8"	13/16"	1/2"	15	SD8625UGX		2771-0824	MGLP-R8-E
Stainless Steel Rivet & Mandrel									
17429	3/16"	1/16" - 17/64"	13/32"	3/8"	10	SSD6270UG	CCPV64	2711-0613	MGLP-U6-4



Closed - End Rivets

Can be set with Auveco Rivet Gun 7915

Auveco Part No.	Head (Flange) Type	Head Diameter	Rivet Diameter	Grip Range	Rivet Length Excluding Flange	Unit Pkg.
Black Aluminum Rivet & Mandrel						
17408	Dome	15/64"	1/8"	13/64" - 9/32"	15/32"	50
17410	Dome	3/8"	3/16"	3/8" - 1/2"	11/16"	25
Aluminum Rivet & Mandrel						
17419	Dome	3/8"	3/16"	1/16" - 1/8"	11/32"	50
17420	Dome	3/8"	3/16"	1/8" - 1/4"	15/32"	50
Aluminum Rivet & Steel Mandrel						
17411	Dome	15/64"	1/8"	1/16" - 1/8"	5/16"	50
19065	Countersunk	5/16"	5/32"	1/8" - 3/16"	13/32"	100
17415	Dome	3/8"	3/16"	1/8" - 1/4"	15/32"	50
17416	Dome	3/8"	3/16"	1/4" - 3/8"	19/32"	50

"PEEL - TYPE" SPECIALTY RIVETS

Use 11817 Rivet Gun with 11853 Nose Piece (Page 295) to set all 1/4" "Peel-Type" Rivets



19414
(W525170-S417)

"Peel-Type" Rivet
Diameter: 3/16"
Grip: 1/32"-1/4"
Flange Diameter: 1/2"
Aluminum Rivet (Black) & Steel Mandrel (Zinc)
Side Door Lock Attachment
Mercury Villager 1995 - On

UNIT PACKAGE: 25



11620
(GM: 9436175;
Ford: 385189-S100;
Chry: 6031115)

"Peel-Type" Rivet
Diameter: 1/4"
Grip: 1/32" - 9/64"
Flange Diameter: 1/2"
Aluminum Rivet & Steel Mandrel
Window Regulators
GM, Ford & Chrysler 1971 - On

UNIT PACKAGE: 25

16837

Same as 11620 except for unit package quantity

UNIT PACKAGE: 50

Sec. 14

“PEEL - TYPE” SPECIALTY RIVETS

Use 11817 Rivet Gun with 11853 Nose Piece
(Page 295) to set all 1/4” “Peel-Type” Rivets



19110
(W525172-S)

“Peel-Type” Rivet
Diameter: 1/4”
Grip: 1/32”-7/32”
Flange Diameter: 1/2”
Aluminum Rivet & Steel Mandrel (Zinc)
Glass, Regulator Assembly
& Remote Latch Assembly
Ford Mustang & Lincoln Continental 1994 - On

UNIT PACKAGE: 25



15684
(20713843)

“Peel-Type” Rivet
Diameter: 1/4”
Grip: 7/64” - 11/64”
Flange Diameter: 1/2”
Recess under Head
Aluminum Rivet & Steel Mandrel
Used on Window Regulators
& Door Lock Assemblies
GM A & J Cars

UNIT PACKAGE: 25



19461
(W525172-S417)

“Peel-Type” Rivet
Diameter: 1/4”
Grip: 1/32”-7/32”
Flange Diameter: 1/2”
Aluminum Rivet (Black) & Steel Mandrel (Zinc)
Outside Door Handle
Ford Crown Victoria, Econoline, Explorer,
Grand Marquis, Ranger, Sable,
Taurus & Windstar 1995 - On

UNIT PACKAGE: 15



12655
(GM: 9437486;
Chry: 6032926)

“Peel-Type” Rivet
Diameter: 1/4”
Grip: 9/64” - 3/16”
Flange Diameter: 1/2”
Aluminum Rivet & Steel Mandrel
Window Regulators
GM 1981 - On

UNIT PACKAGE: 25



11852
(Ford: 388047-S100;
GM: 14078435)

“Peel-Type” Rivet
Diameter: 1/4”
Grip: 5/64” - 7/64”
Flange Diameter: 1/2”
Recess under Head
Aluminum Rivet & Steel Mandrel
Attaches Outside Door Handle
Ford 1978 - On
Heat Shield Attachment
GM

UNIT PACKAGE: 25



14486
(GM: 9437486;
Chry: 6032926)

“Peel-Type” Rivet
Diameter: 1/4”
Grip: 9/64” - 3/16”
Flange Diameter: 1/2”
Aluminum Rivet & Steel Mandrel
Used on Window Regulators,
Quarter Vent Handle Assemblies &
Electrical Door Lock Linkage
GM & Chrysler 1981 - On

UNIT PACKAGE: 25



12653
(388047-S102)

“Peel-Type” Rivet
Diameter: 1/4”
Grip: 3/32”-1/8”
Flange Diameter: 1/2”
Aluminum Rivet (Black) & Steel Mandrel
Door Handle Assembly
Ford 1981 - On

UNIT PACKAGE: 25



20402
(9437643)

“Peel-Type” Rivet
Diameter : 1/4”
Grip: 3/16” - 1/4”
Flange Diameter: 1/2”
Aluminum Rivet & Steel Mandrel (Zinc)
Window Regulator
Saturn 1993 - On

UNIT PACKAGE: 25

"PEEL - TYPE" SPECIALTY RIVETS

Sec. 14

Use 11817 Rivet Gun with 11853 Nose Piece
(Page 295) to set all 1/4" "Peel-Type" Rivets

11621

(Ford: 385323-S100; Chry: 6031091; GM: 9437938)



"Peel-Type" Rivet
Diameter: 1/4"
Grip: 33/64" - 19/32"
Flange Diameter: 1/2"
Aluminum Rivet & Steel Mandrel
Window Regulator
GM, Ford & Chrysler 1976 - On

UNIT PACKAGE: 10

16838

Same as 11621 except for unit package quantity

UNIT PACKAGE: 25

12658

(GM: 12338153, 20184399; Ford: 389268-S100)



"Peel-Type" Rivet
Diameter: 1/4"
Grip: 11/16" - 3/4"
Flange Diameter: 1/2"
Aluminum Rivet & Steel Mandrel
Window Regulator
GM & Ford 1979 - On

UNIT PACKAGE: 25

18396

(N808594-S100)
Zinc & Yellow



"Peel-Type" Rivet
Diameter: 1/4"
Grip: 1/8"-5/16"
Flange Diameter: 5/8"
Aluminum Rivet & Steel Mandrel
Door Lock Actuator
Ford

UNIT PACKAGE: 25

19420

(W525174S)



"Peel-Type" Rivet
Diameter: 1/4"
Grip: 13/64"-13/32"
Flange Diameter: 5/8"
Aluminum Rivet & Steel Mandrel (Zinc)
Door Handle
Ford Ranger 1997 - On

UNIT PACKAGE: 25

19456

(W525175-S)



"Peel-Type" Rivet
Diameter: 1/4"
Grip: 25/64" - 21/32"
Flange Diameter: 5/8"
Aluminum Rivet & Steel Mandrel (Zinc)
Front Door Window
Ford Continental, Crown Victoria, Explorer, Grand
Marquis, Mark VIII, Mustang, Ranger, Sable, Taurus,
Town Car & Windstar 1996 - On

UNIT PACKAGE: 15

18167

(Ford: N804193-S100;
GM: 9441592, 15672713)

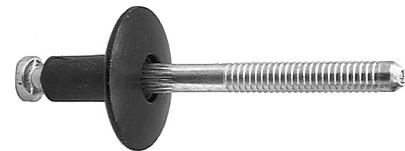

"Peel-Type" Rivet
Diameter: 1/4"
Grip: 3/32"-9/64"
Flange Diameter: 3/4"
Aluminum Rivet (Black) & Steel Mandrel
Front Door Handle & Door Lock Actuator
Tempo, Topaz, T-Bird & Cougar 1984 - On
Rocker Panel Moulding
Chevrolet Beretta & Corsica 1996 - 92

UNIT PACKAGE: 25

19458

(N808689-S417)



"Peel-Type" Rivet
Diameter: 1/4"
Grip: 1/8"-21/64"
Flange Diameter: 3/4"
Aluminum Rivet (Black) & Aluminum Mandrel
Door Lock Actuator
Ford Continental, Crown Victoria,
F Series Truck, Grand Marquis, Mark VII, Mustang,
Ranger, Sable, Taurus, Town Car & Windstar 1995 - On

UNIT PACKAGE: 10



10658

Diameter: 3/32"
Grip: 1/8"-1/4"
Flange Diameter: 3/16"
Aluminum Rivet & Mandrel

Replaces welded studs on body panels.

UNIT PACKAGE: 100



18499

Diameter: 1/8"
Grip: 1/8"-3/16"
Flange Diameter: 3/16"
Aluminum Rivet & Mandrel
Trim Moulding Attachment

UNIT PACKAGE: 100



18500

Diameter: 1/8"
Grip: 3/16"-1/4"
Flange Diameter: 3/16"
Aluminum Rivet & Mandrel
Trim Moulding Attachment

UNIT PACKAGE: 100



11104

(Ford: 383229-S)

Diameter: 1/8"
Grip: 3/16"-1/4"
Flange Diameter: 3/16"

Stainless Steel Rivet & Steel Mandrel

Replaces welded studs on body panels.

Use Auveco Rivet Gun 7915 & Nose Piece 7981

UNIT PACKAGE: 100

11105

Same as 11104 except for unit package quantity

UNIT PACKAGE: 500

11106

Same as 11104 except for unit package quantity

UNIT PACKAGE: 1000



7981

Rivet Gun Nose Piece
**Used to set Auveco Rivet 11104
with Rivet Gun 7915**

UNIT PACKAGE: 1



20788

(90269-04051,
90269-A0006)

Diameter: 1/8" (3.2mm)
Grip: 3/64" - 1/8" (1.2mm - 3.4mm)
Flange Diameter: 15/64" (6mm)
Aluminum Rivet with Plastic Cap
Steel Mandrel

Lexus 1998 - On

UNIT PACKAGE: 10



17408

(N803933-S101)

Diameter: 1/8"
Grip: 13/64"-9/32"
Flange Diameter: 15/64"
Closed End
Black Aluminum Rivet & Mandrel
Luggage Rack
Ford

UNIT PACKAGE: 50



17469

(375936-S)

Diameter: 1/8"
Grip: 1/32"-1/8"
Flange Diameter: 1/4"
Stainless Steel Rivet & Mandrel
Attaches Body Side Mouldings
Sets flush, does not leave a raised stud

UNIT PACKAGE: 100



21418

(6508540-AA)

Diameter: 1/8"
Grip: 1/32" - 3/16"
Flange Diameter: 1/4"
Black Aluminum Rivet & Steel Mandrel (Zinc)
Chrysler General Purpose

UNIT PACKAGE: 25



18303

Diameter: 1/8"
Grip: 1/16"-1/8"
Flange Diameter: 1/4"
Aluminum Rivet (Black) & Aluminum Mandrel
Attachment of Rear Window Trim Moulding
Ford Explorer 1990-On

UNIT PACKAGE: 50



17470

(378527)

Diameter: 1/8"
Grip: 1/8"-3/16"
Flange Diameter: 1/4"
Aluminum Rivet & Mandrel
Attaches Climate Controls
Ford

UNIT PACKAGE: 50



17467

(375203S)

Diameter: 1/8"
Grip: 1/8"-3/16"
Flange Diameter: 1/4"
Stainless Steel Rivet & Steel Mandrel
Attaches Body Side Moulding Retainer
Sets flush, does not leave a raised stud
Ford

UNIT PACKAGE: 100

SPECIALTY RIVETS

Sec. 14



21114
(11610210)

Diameter: 1/8"
Grip: 5/32" - 5/16"
Flange Diameter: 1/4"
Aluminum Rivet & Mandrel
Rear Bumper Fascia
Chevrolet Equinox 2005 - On

UNIT PACKAGE: 50



19406
(6035414)

Diameter: 1/8"
Grip: 1/16"-1/4"
Flange Diameter: 5/16"
Aluminum Rivet & Steel Mandrel (Zinc)
Cladding to Fender Attachment
Chrysler Concorde, Eagle & Intrepid
1997 - On

UNIT PACKAGE: 50



19202

Diameter: 1/8"
Grip: 3/16"-1/4"
Flange Diameter: 1/4"
Aluminum Rivet (Black) & Aluminum Mandrel
GM & General Purpose

UNIT PACKAGE: 100



12656
(20325696)

Diameter: 1/8"
Grip: 1/8" - 3/16"
Flange Diameter: 5/16"
Aluminum Rivet & Steel Mandrel
Rear Window Gasket Attachment
GM 1981 - On

UNIT PACKAGE: 50



19657
(6034848)
Zinc & Yellow

Diameter: 1/8"
Grip: 1/32"-3/16"
Flange Diameter: 5/16"
Aluminum Rivet & Steel Mandrel
Rocker Panel & Cladding
Chrysler LH Series 1993 - On

UNIT PACKAGE: 50



20628
(90269-04050)

Diameter: 1/8" (3.2mm)
Grip: 5/32" - 5/16" (4mm - 8mm)
Flange Diameter: 5/16" (8mm)
Aluminum Rivet with Plastic Cap
Steel Mandrel
Windshield, Side & Trunk Moulding
Lexus GS300, 400, 430 & SC430
1998 - On

UNIT PACKAGE: 15



20787
(90269-04006)

Diameter: 1/8" (3.2mm)
Grip: 3/64" - 5/32" (1.2mm - 4.0mm)
Flange Diameter: 5/16" (8mm)
Aluminum Rivet with Plastic Cap
Steel Mandrel
Lexus 1998 - On

UNIT PACKAGE: 10



17615
(6032856)

Diameter: 1/8"
Grip: 3/16"-3/8"
Flange Diameter: 5/16"
Aluminum Rivet (Black) & Steel Mandrel
Body Side Moulding
& Universal Applications
Chrysler

UNIT PACKAGE: 50



20627
(90269-04053)

Diameter: 1/8" (3.2mm)
Grip: 3/64" - 3/16" (1mm - 4.8mm)
Flange Diameter: 5/16" (8mm)
Aluminum Rivet (Black) with Plastic Cap
Steel Mandrel (Black)
Mouldings
Toyota Land Cruiser 1998 - On

UNIT PACKAGE: 10



18304

Diameter: 1/8"
Grip: 1/16"-1/8"
Flange Diameter: 3/8"
Aluminum Rivet (Black) & Steel Mandrel
Attachment of Door Glass Moulding
Ford 1993 - On

UNIT PACKAGE: 50



21320
(90269-03064)

Diameter: 3.2mm (1/8")
Grip: 1.6mm-3.2mm (1/16"-1/8")
Flange Diameter: 9.5mm (3/8")
Aluminum Rivet & Mandrel
Black Flange
Rocker Moulding
Lexus ES 300 & Others 2002 - On

UNIT PACKAGE: 15



16834
(N805759-S100)

Diameter: 1/8"
Grip: 1/8"-3/16"
Flange Diameter: 3/8"
Aluminum Rivet (Black) & Aluminum Mandrel
Windshield Side Rail
Ford T-Bird & Mercury Cougar 1989-On

UNIT PACKAGE: 50



16686
(9432552)

Multi-Purpose Rivet
Diameter: 1/8"
Grip: 1/8" - 3/16"
Flange Diameter: 3/8"
Aluminum Rivet & Steel Mandrel
Large Flange
GM 1978-On

UNIT PACKAGE: 100



19419
(N811460-S100)

Diameter: 1/8"
Grip: 1/8"-3/16"
Flange Diameter: 3/8"
Steel Rivet (Black) & Steel Mandrel
Door Moulding
Ford Taurus 1996-On

UNIT PACKAGE: 15



21082
(75547-51021)

Diameter: 1/8" (3.2mm)
Nylon Shoulder Diameter: 1/4" (6.3mm)
Grip: 1/32" - 1/16" (.8mm - 1.5mm)
Flange Diameter: 13/32" (10.3mm)
Aluminum Rivet with Plastic Cap
Steel Mandrel
Windshield
Lexus IS 250, IS 350 & IS F 2006 - On
Toyota 2002 - On

UNIT PACKAGE: 15



21714
(Lexus: 90269-04060)

Specialty Rivet
Diameter: 5/32" (4mm)
Grip: 3/64" - 9/32" (1mm - 7mm)
Flange Diameter: 15/64" (6mm)
Steel Rivet & Mandrel
Lexus GS 300, GS 350, GS 430, GS 450h
& GS 460 2006 - On

UNIT PACKAGE: 25



22089
(GM: 92139150)

Front Bumper & Grille Specialty Rivet
Diameter: 5/32" (4mm)
Grip Range: 11/64" - 11/32" (4.4mm - 8.5mm)
Flange Diameter: 9/32" (7.1mm)
Aluminum Rivet & Stainless Steel Mandrel
Chevrolet Camaro 2012 - On

UNIT PACKAGE: 25



22173
(GM: 11611651)
Zinc & Clear Trivalent

Door & Exterior Trim Specialty Rivet
Diameter: 5/32" (4mm)
Grip Range: 3/64" - 5/32" (1mm - 4mm)
Flange Diameter: 5/16" (8mm)
Steel Rivet & Mandrel
Cadillac ATS, CTS, CTS-V & Escalade,
Chevrolet Avalanche, Camaro & Equinox and
GMC Terrain 2010 - On

UNIT PACKAGE: 50



22332
(Subaru: 905920039;
Toyota: 76879-48010)

Roof, Liftgate & Exterior Trim
Specialty Rivet with Plastic Cap
Rivet Diameter: 4mm (5/32")
Diameter of Plastic Cap: 5mm
Flange Diameter: 8mm (5/16")
Plastic Cap Flange Diameter:
10mm (Top), 12mm (Bottom)
Grip Range: .8mm - 2.4mm (.031" - .094")
Aluminum Rivet, Steel Mandrel
Subaru Forester, Impreza, Legacy,
Outback & XV Crosstrek 2015 - 2009
Toyota Prius 2009 - 2004

UNIT PACKAGE: 10

18461

(Ford: N807620-S100; GM: 10131511)



Split-Type Rivet
 Diameter: 5/32"
 Grip: 3/64"-1/4"
 Flange Diameter: 5/16"
 Aluminum Rivet (Black) & Aluminum Mandrel
 Wheel Openings
 Lincoln 1994-On
 Bumper Cover, Grille & Rocker Moulding
 GM 1997 - On

UNIT PACKAGE: 25

20971

(Mazda: BBM450-355;
 Mercedes-Benz: 003-990-94-97)



Split-Type Rivet
 Diameter: 5/32" (4mm)
 Grip: 3/64" - 9/32" (1mm - 7mm)
 Flange Diameter: 5/16" (8mm)
 Aluminum Rivet & Mandrel
 Mazda 2012 - On
 Mercedes-Benz 2004 - On

UNIT PACKAGE: 25



21113
 (01515-0009U)

Split-Type Rivet
 Diameter: 5/32" (4mm)
 Grip: 3/64" - 9/32" (1mm - 7mm)
 Flange Diameter: 5/16" (8mm)
 Aluminum Rivet (Black) & Aluminum Mandrel
 Bumper
 Nissan Pathfinder 2006 - On

UNIT PACKAGE: 25



20383
 (90084-26002)

Diameter: 5/32" (4mm)
 Grip: 1/16" - 1/4" (1.6mm - 6.3mm)
 Flange Diameter: 5/16" (8mm)
 Aluminum Rivet & Mandrel
 Door Window Moulding
 Toyota Camry 1997 - On

UNIT PACKAGE: 50



16687
 (GM: 9432137;
 Chry: 6032138)

Diameter: 5/32"
 Grip: 1/8" - 3/16"
 Flange Diameter: 5/16"
 Aluminum Rivet & Steel Mandrel
 Countersunk Head
 Trunk Lock Swivel Emblem Rivet
 GM 1973-On

UNIT PACKAGE: 25

21864

(Ford: W713819-S900)



Specialty Rivet
 Diameter: 5/32" (4mm)
 Grip: 3/64" - 1/8" (1.2mm - 3.2mm)
 Flange Diameter: 3/8" (9mm)
 Aluminum Rivet (Black) with Plastic Cap
 Steel Mandrel
 Cab & Exterior Trim
 Ford F-150 2014 - 2009

UNIT PACKAGE: 25



20629
 (6036148-AA)

Split-Type Rivet
 Diameter: 5/32"
 Grip: 3/64" - 1/4"
 Flange Diameter: 7/16"
 Aluminum Rivet (Black) & Aluminum Mandrel
 Front Bumper, Trim Panel,
 Instrument Panel & Running Boards
 Chrysler 1999 - On

UNIT PACKAGE: 25



22088
 (GM: 9132667)

Front & Rear Bumper Specialty Rivet
 Diameter: 5/32" (4mm)
 Grip Range: 9/64" - 3/8" (3.6mm - 9.5mm)
 Flange Diameter: 7/16" (11.1mm)
 Aluminum Rivet & Stainless Steel Mandrel
 Buick Regal & Verano; Chevrolet Avalanche, Camaro,
 Cruze, Malibu, Sonic & Volt 2010 - On

UNIT PACKAGE: 25



17468
 (16715497)

Diameter: 5/32"
 Grip: 3/64"-1/4"
 Flange Diameter: 15/32"
 Aluminum Rivet & Steel Mandrel
 Attaches Support Rails to Load Floor
 GM

UNIT PACKAGE: 50



21742
(Toyota: 90269-06054)

Specialty Rivet
Diameter: 5/32" (4mm)
Grip: 3/64" - 3/8" (1mm - 9.5mm)
Flange Diameter: 15/32" (12mm)
Aluminum Rivet (Black) & Steel Mandrel (Black)
European Toyota and Universal

UNIT PACKAGE: 25



21715
(Toyota: 90269-04047)

Specialty Rivet
Diameter: 5/32" (4mm)
Grip: 3/64" - 15/32" (1mm - 12mm)
Flange Diameter: 15/32" (12mm)
Aluminum Rivet & Steel Mandrel (Black)
Black Flange
Toyota RAV4 & 4Runner 1996 - On

UNIT PACKAGE: 25



19376
(979878-6)

Diameter: 5/32" (4mm)
Grip: 1/8"-11/32" (3mm-8.5mm)
Flange Diameter: 15/32" (12mm)
Aluminum Rivet (Black Polyethylene Coating)
Aluminum Mandrel
Bumper & Wheel Housing
Volvo 1993-On

UNIT PACKAGE: 15



17006
(N900-845-01)

Diameter: 5/32"
Grip: 1/4" - 3/8"
Flange Diameter: 15/32"
Aluminum Rivet (Black) & Steel Mandrel
Wheel Opening Moulding Attachment
Jetta, Rabbit & Golf

UNIT PACKAGE: 25



15187
(N804583S)
Black Nylon

Cowl Vent Grille
Retainer Rivet
Diameter: 5/32" (4mm)
Grip: 15/64" - 13/32" (6mm-10.5mm)
Flange Size: 11/32" x 5/8" (8.5mm x 15.5mm)
Ford Aerostar 1986-On

UNIT PACKAGE: 25



18169
(15956062)

Diameter: 3/16"
Grip: 1/8"-1/4"
Flange Diameter: 11/32"
Aluminum Rivet & Steel Mandrel
Door Assembly
GM Trucks C, K Models 1994-On

UNIT PACKAGE: 25



19514
(10125439, 10201332)

Split-Type Rivet
Diameter: 3/16"
Grip: 3/64" - 15/64"
Flange Diameter: 3/8"
Aluminum Rivet (Black) & Aluminum Mandrel
Door Actuator, Door, Body & Fender
Moulding and Dash Panel Insulation
Buick Regal, Chevrolet Lumina APV, K & T Trucks,
Olds Silhouette and Pontiac Trans Sport 1990 - On

UNIT PACKAGE: 25



16864
(10125439)

Split-Type Rivet
Diameter: 3/16"
Grip: 3/64" - 11/32"
Flange Diameter: 3/8"
Aluminum Rivet (Black) & Aluminum Mandrel
Moulding Attachment
APV Vans 1990 - On

UNIT PACKAGE: 25



22333
(Ford: W717984-S417)

Cab & Exterior Trim Countersunk
Closed End Specialty Rivet
Diameter: 4.8mm (3/16")
Flange Diameter: 9.5mm (3/8")
Grip Range: 1.6mm - 3.18mm (.063" - .125")
Black Aluminum Rivet & Mandrel
Ford F-150 2015 - On

UNIT PACKAGE: 15



20830
(N-904-374-01)

Diameter: 3/16" (4.8mm)
Grip: 1/16" - 1/4" (1.6mm-6.4mm)
Flange Diameter: 3/8" (10mm)
Aluminum Rivet & Steel Mandrel
Inner Fender
Volkswagen

UNIT PACKAGE: 25



18912

(22585836, 22641917)

Diameter: 3/16"
 Grip: 1/16" - 17/64"
 Flange Diameter: 3/8"
 Steel Rivet (Black) & Steel Mandrel (Zinc)
 Rear Side Door Outside Handle Attachment
 Cadillac DeVille & Seville, Chevrolet Cavalier and
 Pontiac Sunfire 1994 - On

UNIT PACKAGE: 25



17410

(390428-S100)

Diameter: 3/16"
 Grip: 3/8" - 1/2"
 Flange Diameter: 3/8"
 Closed End
 Black Aluminum Rivet & Mandrel
 Luggage Rack
 Ford

UNIT PACKAGE: 25



19459

(384432-S)

Diameter: 3/16"
 Grip: 1/16" - 1/8"
 Flange Diameter: 3/8"
 Aluminum Rivet & Steel Mandrel
 Outer Moulding
 Ford F Series & Villager
 and Nissan Quest 1995 - On

UNIT PACKAGE: 25



19515

(15704030)

Diameter: 3/16"
 Grip: 3/16" - 3/8"
 Flange Diameter: 25/64"
 Aluminum Rivet (Black)
 Steel Mandrel (Zinc & Yellow)
 Body Moulding, Bumper Fascia,
 Hood Prop Rod and Window Hinge
 Chev. Beretta, Camaro, Corsica &
 Trucks, Olds Silhouette, Pontiac Firebird,
 Grand Am and Trans Sport 1992 - On

UNIT PACKAGE: 25



21184

(003-990-24-97)

Door Handle, Air Bag, Rocker Moulding &
 Window Regulator Rivet
 Diameter: 3/16" (4.8mm)
 Grip: 1/16" - 1/8" (1.6mm - 3.2mm)
 Flange Diameter: 3/8" (9.5mm)
 Steel Rivet & Mandrel
 Mercedes-Benz 1998 - On

UNIT PACKAGE: 100



17121

(GM: 25618730;
 Ford: N805592-S100)

Split-Type Rivet
 Diameter: 3/16"
 Grip: 5/64" - 15/64"
 Flange Diameter: 7/16"
 Aluminum Rivet (Black) & Aluminum Mandrel
 Wheel House Moulding & General Purpose

UNIT PACKAGE: 25



21439

Diameter: 1/4.8 (3/16")
 Grip: 1.5mm - 6mm (1/16" - 15/64")
 Flange Diameter: 9mm (3/8")
 Steel Rivet & Mandrel
 Cadillac CTS; Chevrolet Colorado &
 Equinox and GMC Canyon & Terrain 2004 - On

UNIT PACKAGE: 50



18927

(22569178,
 22579423)

Split-Type Rivet
 Diameter: 3/16"
 Grip: 5/16" - 7/16"
 Flange Diameter: 7/16"
 Aluminum Rivet & Steel Mandrel (Zinc)
 Front & Rear Door Window Sash Attachment
 Buick Skylark, Chevrolet Cavalier,
 Olds Achieva & Pontiac Grand Am 1992-On

UNIT PACKAGE: 25



18329

(3828472)

Diameter: 3/16"
 Grip: 1/4" - 3/8"
 Flange Diameter: 3/8"
 Aluminum Rivet (Black) & Aluminum Mandrel
 Attachment of Front Fender Lower Rocker Moulding
 Chevrolet Astro & GMC Safari Mini-Vans 1995 - On

UNIT PACKAGE: 50



18244
(GM: 15614774)

Split-Type Rivet
Diameter: 3/16"
Grip: 3/16"-3/8"
Flange Diameter: 29/64"
Aluminum Rivet (Black) & Aluminum Mandrel
For Camper Style Mirrors on GM Trucks

UNIT PACKAGE: 10



21713
(Toyota: 90269-05034, 90269-05056)

Specialty Rivet
Diameter: 3/16" (5mm)
Grip: 3/64" - 15/32" (1mm - 12mm)
Flange Diameter: 1/2" (13mm)
Aluminum Rivet with Plastic Cap
Steel Mandrel
Lexus IS 300 and Toyota Celica, Corolla, Matrix, Prius, RAV4, Tercel & Yaris 2000 - On

UNIT PACKAGE: 25



21046
(90269-05065)

Diameter: 3/16" (5mm)
Grip: 5/32" - 9/32" (4mm - 7mm)
Flange Diameter: 1/2" (13mm)
Aluminum Rivet with Plastic Cap
Steel Mandrel
Bumpers & General Purpose
Lexus 2004 - On

UNIT PACKAGE: 10



17641
(9442361, 25609048)

Diameter: 3/16"
Grip: 3/64"-13/64"
Flange Diameter: 9/16"
Aluminum Rivet (Black) & Steel Mandrel (Zinc)
Used in place of screws when attaching new Catalytic Converter Heat Shield
Buick LeSabre & Roadmaster, Cadillac Brougham and Oldsmobile 98 & 88 1986 - On

UNIT PACKAGE: 25



18749
(9439559, 21021319)

Diameter: 3/16"
Grip: 1/16"-1/4"
Flange Diameter: 9/16"
Aluminum Rivet (Black) & Steel Mandrel
Rocker Panel Cover
GM Saturn 1991 - On

UNIT PACKAGE: 50



20834
(90269-06013)

Diameter: 3/16" (4.8mm)
Grip: 1/16" - 1/4" (1.6mm - 6.35mm)
Flange Diameter: 9/16" (14mm)
Aluminum Rivet with Plastic Cap
Steel Mandrel
Gas Filler Door
Toyota Camry & Lexus IS300 2001 - On

UNIT PACKAGE: 15



20626
(90269-05054)

Diameter: 3/16" (5mm)
Grip: 1/8" - 5/16" (3mm - 8mm)
Flange Diameter: 9/16" (14mm)
Aluminum Rivet with Plastic Cap
Steel Mandrel
Windshield Side Moulding & Gas Filler Cap
Toyota Camry & Sienna 1997 - On

UNIT PACKAGE: 10

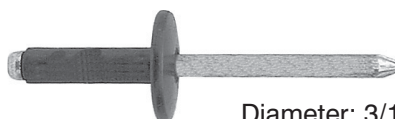

14127
(388664-S100)

Diameter: 3/16"
Grip: 3/8"-1/2"
Flange Diameter: 9/16"
Aluminum Rivet (Black) & Aluminum Mandrel
Fascia & Bumper
Ford 1982 - On

UNIT PACKAGE: 25

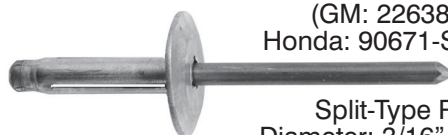

20740
(GM: 22638717; Honda: 90671-SDA-A01)

Split-Type Rivet
Diameter: 3/16" (4.8mm)
Grip Range: 3/64"- 23/64" (1mm - 9mm)
Flange Diameter: 5/8" (16mm)
Aluminum Rivet & Mandrel
Bumper Fascia & General Purpose
GM 1987 - On
Honda Civic 2016 - On

UNIT PACKAGE: 25

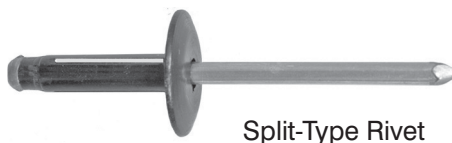

20741
(11516807)

Split-Type Rivet
Diameter: 3/16" (4.8mm)
Grip: 3/64" - 23/64" (1mm-9mm)
Flange Diameter: 5/8" (16mm)
Aluminum Rivet (Black) & Aluminum Mandrel
Bumper Fascia & General Purpose
GM 1990 - On

UNIT PACKAGE: 25



21799
 Split-Type Rivet
 Diameter: 3/16"
 Grip Range: 7/64" - 3/8"
 Flange Diameter: 5/8"
 Aluminum Rivet & Mandrel
 General Purpose
 UNIT PACKAGE: 15



19460
 (385974-S)
 Diameter: 3/16"
 Grip: 3/16"-1/4"
 Flange Diameter: 5/8"
 Aluminum Rivet & Steel Mandrel
 General Purpose
 Ford Econoline & Windstar 1995 - On
 UNIT PACKAGE: 50



22264
 (Ford:W714004-S900)
 Liftgate, Exterior Trim & Quarter Panel Specialty Rivet
 Diameter: 3/16" (4.8mm)
 Grip Range: 3/16" - 3/8" (4.75mm - 9.53mm)
 Flange Diameter: 7/16" (11mm)
 Black Aluminum Rivet & Aluminum Mandrel
 Ford Explorer & Flex 2009 - On
 UNIT PACKAGE: 25



18168
 (9433186)
 Diameter: 3/16"
 Grip 1/4"-3/8"
 Flange Diameter: 5/8"
 Steel Rivet (Zinc) & Steel Mandrel
 Front & Rear Bumper
 GM Saturn 1991 - On
 UNIT PACKAGE: 50



12657
 (9439719)
 Diameter: 3/16"
 Grip: 1/4"-3/8"
 Flange Diameter: 5/8"
 Steel Rivet (Black) & Steel Mandrel
 Attaches Fascia to Underside Bumper
 GM 1981 - On
 UNIT PACKAGE: 50



16940
 (GM: 2085119, 3533539, 3540161;
 Not Supplied by Chrysler O.E.M.)
 Diameter: 3/16"
 Grip: 1/2" - 5/8"
 Flange Diameter: 5/8"
 Aluminum Rivet & Mandrel
 Glass Stop/Roller Rivet
 Chrysler
 Front Bumper Fascia Lower Deflector
 Cadillac 1993 - 87
 UNIT PACKAGE: 25



17466
 (N905150-S)
 Diameter: 3/16"
 Grip: 1/2"-5/8"
 Flange Diameter: 5/8"
 Aluminum Rivet & Steel Mandrel
 Attaches License Plate Bracket
 Ford
 UNIT PACKAGE: 25



18935
 (10160960)
 Diameter: 3/16"
 Grip: 1/2" - 25/32"
 Flange Diameter: 5/8"
 Aluminum Rivet & Steel Mandrel (Zinc)
 Liftgate Strut Gate Side Bracket
 Lumina APV, Silhouette & Trans Sport 1992 - On
 UNIT PACKAGE: 25



17977
 (Not Supplied by O.E.M.)
 Diameter: 3/16"
 Grip: 5/8"-3/4"
 Flange Diameter: 5/8"
 Aluminum Rivet & Mandrel
 Glass Stop/Roller Rivet
 Chrysler
 UNIT PACKAGE: 25



19111
 (N807168-S)
 Diameter: 3/16"
 Grip: 11/16"-13/16"
 Flange Diameter: 3/4"
 Aluminum Rivet & Mandrel
 Grille & Bumper
 Ford Windstar 1995 - On
 UNIT PACKAGE: 25

22122

(Mercedes: 003-990-35-97)



Specialty Rivet
Diameter: 6.3mm (1/4")
Grip Range: 1.0mm - 8.5mm (.039" - .335")
Flange Diameter: 11mm (7/16")
Aluminum Rivet & Steel Mandrel
Mercedes 2012 - 1990

UNIT PACKAGE: 15

21124

(11610383)



Diameter: 1/4"
Grip: 1/64" - 1/8"
Flange Outer Diameter: 1/2"
Steel Rivet (Zinc) & Steel Mandrel
Step Bumper
GM Silverado & Sierra Pick-Ups 2007 - On

UNIT PACKAGE: 25

22266

(GM: 11561334)
Zinc



Rear Compartment, Rocker & Wheelhouse Specialty Rivet
Diameter: 1/4" (6.3mm)
Grip Range: .059" - .138" (1.48mm - 3.50mm)
Flange Diameter: 1/2" (12.70mm)
Steel Rivet & Mandrel
Various GM Models, Cadillac CTS & SRX 2015 - 2009
Cadillac CT6 2016 - On

UNIT PACKAGE: 15

HAVE YOU VISITED US ONLINE?

Auveco's website has been completely renovated. Our new design is user friendly with easy navigation and ordering.

Product is searchable by car make, OEM number and category, as well as, several attribute drop downs within individual categories. All product also has stock availability listed.

Make sure to head over to www.auveco.com to receive up to date information on all our products.

22067

(Ford: W707638-S900C)
Zinc



Cab, Rear Body, Floor, Door, Box, Wheel House & Back Panel Specialty Rivet
Diameter: 1/4" (6.3mm)
Grip: .060"-.138" (1.5mm - 3.5mm)
Flange Diameter: 1/2" (13mm)
Steel Rivet & Mandrel
Ford F-150 Trucks with Aluminum Body 2015 - On

UNIT PACKAGE: 10

18889

(22643056)
Zinc & Yellow Dichromate



Diameter: 1/4"
Grip: 1/16" - 5/32"
Flange Diameter: 1/2"
Steel Rivet & Mandrel
Door Window Regulator
Buick Skylark, Chevrolet Cavalier, Olds Achieva & Aurora, and Pontiac Grand Am & Sunfire 1995-On

UNIT PACKAGE: 25

21315

(90269-A0005, 90269-06017)



Diameter: 1/4" (6.3mm)
Grip: 1/16" - 3/16" (1.6mm - 4.8mm)
Flange Diameter: 1/2" (13mm)
Aluminum Rivet (Black) & Steel Mandrel
Fuel Door & General Purpose
Toyota and Lexus 2000 - On
Scion 2005 - On

UNIT PACKAGE: 10

18938

(2024778)
Zinc



Diameter: 1/4"
Grip: 1/16"-1/4"
Flange Diameter: 1/2"
Steel Rivet & Mandrel
Front Side Door Window Regulator
Chevrolet Lumina APV, Olds Silhouette & Pontiac Trans Sport 1990 - On

UNIT PACKAGE: 25

16939

(10157547)

Yellow Dichromate Coated



Diameter: 1/4"
Grip: 5/64" - 3/8"
Flange Diameter: 1/2"
Aluminum Rivet & Steel Mandrel
Front Door Window Regulator
GM APV Vans 1990 - On

UNIT PACKAGE: 10

18810

(6033688)

Zinc & Yellow



Diameter: 1/4"
Grip: 7/64" - 3/16"
Flange Diameter: 1/2"
Steel Rivet & Mandrel
Glass & Frame Assembly and
Floor Pan Reinforcement Attachment
Dodge Shadow, Plymouth Sundance
& Jeep Cherokee 1991 - On

UNIT PACKAGE: 25

22023

(Ford: W702512-S900C)



Fender, Sill & Radiator Support Specialty Rivet
Diameter: 1/4" (6.3mm)
Grip: .110" - .189" (2.79mm - 4.8mm)
Flange Diameter: 1/2" (13mm)
Steel Rivet & Mandrel
Ford F-150 Trucks with Aluminum Body 2015

UNIT PACKAGE: 10

12654

(372820-S36, S40)



Diameter: 1/4"
Grip: 1/8" - 1/4"
Flange Diameter: 1/2"
Steel Rivet (Zinc & Gold Chrome) & Steel Mandrel
Front Bumper Assembly
Ford 1979 - On

UNIT PACKAGE: 25

22265

(Mercedes: 000-991-59-32)



Front & Rear Door Specialty Rivet
Diameter: 6.3mm (1/4")
Grip Range: 3.5mm - 6.5mm (.138" - .265")
Flange Diameter: 16mm (5/8")
Aluminum Rivet & Steel Mandrel
Mercedes-Benz CLA & GLA Class 2014 - On

UNIT PACKAGE: 15

21286

(Ford: W708777-S900C;
Mercedes: 004-990-16-97)
Zinc



Specialty Rivet
Diameter: 1/4" (6.3mm)
Grip: 3/16" - 17/64" (4.80mm - 6.80mm)
Flange Diameter: 1/2" (13mm)
Steel Rivet & Mandrel
Cab, Radiator, Rail, Floor, Door, Pillar,
Cowl, Box & Back Panel
Ford F-150 Trucks with Aluminum Body 2015 - On
Mercedes Benz 2008 - On

UNIT PACKAGE: 10

22066

(Ford: W702554-S900C)
Zinc



Cab, Floor, Door, Pillar, Box &
Cowl Specialty Rivet
Diameter: 1/4" (6.3mm)
Grip: .268" - .346" (6.8mm - 8.8mm)
Flange Diameter: 1/2" (13mm)
Steel Rivet & Mandrel
Ford F-150 Trucks with
Aluminum Body 2015 - On

UNIT PACKAGE: 10

21245

(W705297-S300)

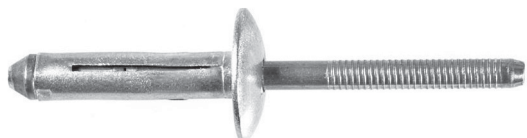

Split-Type Rivet
 Diameter: 1/4"
 Grip Range: 3/16" - 3/8"
 Flange Diameter: 11/16"
 Aluminum Rivet & Mandrel
 Bumper Cover
 Ford Fusion 2009 - On

UNIT PACKAGE: 15

21440

(Not Available from O.E.M.)



Closed End Rivet
 Diameter: 1/4"
 Grip Range: 1/4" - 3/8"
 Flange Diameter: 1/2"
 Aluminum Rivet & Steel Mandrel
 General Purpose

UNIT PACKAGE: 25

18170

(10204266)



Diameter: 1/4"
 Grip: 3/4"-1"
 Flange Diameter: 1/2"
 Aluminum Rivet & Mandrel
 Trunk Lock Cylinder
 Pontiac Firebird 1994 - On

UNIT PACKAGE: 10

19516

(N804851-S100)



Split-Type Rivet
 Diameter: 1/4"
 Grip: 3/64"-1/4"
 Flange Diameter: 9/16"
 Aluminum Rivet (Black) & Aluminum Mandrel
 Front Bumper
 Ford Taurus 1996 - On

UNIT PACKAGE: 15

17639

(Ford: N806830-S100;
 Chry: 6035201)



Split-Type Rivet
 Diameter: 1/4"
 Grip: 3/16"-3/8"
 Flange Diameter: 11/16"
 Aluminum Rivet & (Black) Aluminum Mandrel
 Attachment of Bumper Cover to Bumper &
 Front License Plate Bracket to Bumper Cover
 Ford 1992 - On
 Air Dam to Fascia
 Chrysler 1993 - On

UNIT PACKAGE: 15

19263

Same as 17639 except for unit package quantity

UNIT PACKAGE: 25

18331

(N805995-S100,
 W701566-S417)



Diameter: 1/4"
 Grip: 1/32"-7/32"
 Flange Diameter: 3/4"
 Aluminum Rivet (Black) & Aluminum Mandrel (Yellow)
 Attachment of Power Door Lock Actuator
 Mustang & Lincoln Continental 1994-On

UNIT PACKAGE: 10

12652

(388442-S100)



Diameter: 1/4"
 Grip: 1/8"-1/4"
 Flange Diameter: 3/4"
 Steel Rivet (Black) & Steel Mandrel
 Bumper Assembly
 Escort & Lynx 1981 - On

UNIT PACKAGE: 25

Straight Shank 135° Split Point Black Finish



Auveco Part No.	Unit Pkg.	Size	Dec. Equiv.	Flute Length	Overall Length
13039	5	3/32"	.0938	1-1/4"	2-1/4"
13040	5	7/64"	.1094	1-1/2"	2-5/8"
13041	5	1/8"	.1250	1-5/8"	2-3/4"
13095	5	30	.1285	1-5/8"	2-3/4"
13042	5	9/64"	.1406	1-3/4"	2-7/8"
13043	5	5/32"	.1562	2"	3-1/8"
13044	5	11/64"	.1719	2-1/8"	3-1/4"
13045	5	3/16"	.1875	2-5/16"	3-1/2"
13046	5	13/64"	.2031	2-7/16"	3-5/8"
13047	5	7/32"	.2188	2-1/2"	3-3/4"
13048	5	15/64"	.2344	2-5/8"	3-7/8"
13049	5	1/4"	.2500	2-3/4"	4"
13050	5	17/64"	.2656	2-7/8"	4-1/8"
13051	5	9/32"	.2812	2-15/16"	4-1/4"
13052	5	19/64"	.2969	3-1/16"	4-3/8"
13053	5	5/16"	.3125	3-3/16"	4-1/2"
13054	5	21/64"	.3281	3-5/16"	4-5/8"
13055	5	11/32"	.3438	3-7/16"	4-3/4"
13056	5	23/64"	.3594	3-1/2"	4-7/8"
13057	5	3/8"	.3750	3-5/8"	5"
13058	5	25/64"	.3906	3-3/4"	5-1/8"
13059	5	13/32"	.4062	3-7/8"	5-1/4"
13060	5	27/64"	.4219	3-15/16"	5-3/8"
13061	5	7/16"	.4375	4-1/16"	5-1/2"
13062	5	29/64"	.4531	4-3/16"	5-5/8"
13063	5	15/32"	.4688	4-5/16"	5-3/4"
13064	5	31/64"	.4844	4-3/8"	5-7/8"
13065	3	1/2"	.5000	4-1/2"	6"

Cobalt Steel Spot Weld Drills



Auveco Part No.	Unit Pkg.	Size	Flute Length	Overall Length
20479	3	8mm (5/16")	27mm (1-1/16")	58mm (2-1/4")
20480	3	10mm (3/8")	27mm (1-1/16")	58mm (2-1/4")

High Speed Jobber Length Drill Set Metal Drill Indexes



13136

Jobbers Length Straight Shank
135° Split Point
Sizes 1/16" thru 1/2" by 64th
29 Pieces

UNIT PACKAGE: 1 Set

Screw Machine Length Drills 135° Split Point Straight Shank • Black Finish



Auveco Part No.	Unit Pkg.	Size	Dec. Equiv.	Flute Length	Overall Length
13120	5	1/16"	.0625	5/8"	1-5/8"
13121	5	5/64"	.0781	11/16"	1-11/16"
13124*	5	1/8"	.1250	7/8"	1-7/8"
13128	5	3/16"	.1875	1-1/8"	2-3/16"
13132	5	1/4"	.2500	1-3/8"	2-1/2"
13133	5	5/16"	.3125	1-5/8"	2-13/16"
13134	2	3/8"	.3750	1-13/16"	3-1/8"

* For 1/8" Pop Rivets

12676 Black Finish



Double-End Drill Bit
135° Split Point
Diameter: 1/8" (.125)
Length: 2"

UNIT PACKAGE: 5

AuvecoPak AP448 Retail Merchandiser

AuvecoPak part numbers are the same as standard Auveco part numbers with an “AP” prefix. Thus AP11146 is the AuvecoPak version of 11146.

AP448S (Starter Merchandiser): One package each of 448 part numbers

AP448L (Large Merchandiser): Two packages each of the 224 most popular items and one package each of the other 224 part numbers for a total of 672 packages.



The AuvecoPak merchandisers (AP448S and AP448L) provide 448 of the fastest moving, most popular automotive body hardware and specialty fasteners.

Each of the 7 panels contains 32 part numbers per side.

The AP448S (Starter Merchandiser) consists of one package each of the 448 part numbers. The AP448L (Large Assortment) includes two packages each of the 224 most popular items and one package each of the other 224 part numbers for a total of 672 packages.

Two header signs identify the AP448 as an Auveco merchandiser, along with the phrase automotive body hardware and specialty fasteners. Eye-catching color scheme and graphics make the merchandiser visually appealing and portray the contents of the merchandiser.

Initial set-up is easy. The panels come “pre-dressed” with the AuvecoPaks already in place. Simply position the top and bottom brackets on a gondola or pegboard wall. Insert the panels into the brackets.

An individual panel measures 6-1/2” (wide) x 17-1/2” (front to back) x 44-1/2” (high). Merchandisers (AP448S and AP448L) fit on a gondola with 48” x 48” of pegboard or on any pegboard wall.

A gondola is not included with the AP448S or the AP448L. Auveco customer service reps can recommend a source for gondolas.

AuvecoPak packages feature, contemporary graphics with all the necessary application and descriptive information in trilingual verbiage (English, Spanish and French-Canadian).

Re-ordering is a breeze, the AuvecoPak part number and UPC-A bar code are on the panel back-up boards beneath each hook. Restocking the merchandiser is also quick and easy with the AuvecoPak packages’ locator codes identifying their specific location on the panels.



Refer to contents listing for each panel on following pages