

High Pressure Plugs

Fig. 2122 Square Head Plugs

Fig. 2142 Hex Head Plugs

Fig. 2121 Round Head Plugs

Figure 2122

Square Head Plugs

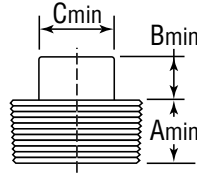

Size		A		B		C		Unit Weight	
NPS	DN	in	mm	in	mm	in	mm	lbs	kg
1/8	6	0.38	10	0.25	6	0.28	7	0.02	0.01
1/4	8	0.44	11	0.25	6	0.38	10	0.03	0.01
3/8	10	0.50	13	0.31	8	0.44	11	0.06	0.03
1/2	15	0.56	14	0.38	10	0.56	14	0.10	0.05
3/4	20	0.62	16	0.44	11	0.62	16	0.18	0.08
1	25	0.75	19	0.50	13	0.81	21	0.38	0.17
1 1/4	32	0.81	21	0.56	14	0.94	24	0.62	0.28
1 1/2	40	0.81	21	0.62	16	1.12	28	0.88	0.40
2	50	0.88	22	0.69	18	1.31	32	1.40	0.63
2 1/2	65	1.06	27	0.75	19	1.50	36	2.20	1.00
3	80	1.12	28	0.81	21	1.69	41	3.40	1.54
4	100	1.25	32	1.00	25	2.50	65	8.50	3.85

Figure 2142

Hex Head Plugs

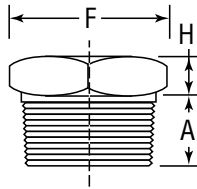

Size		A		F Across Flats		H		Unit Weight	
NPS	DN	in	mm	in	mm	in	mm	lbs	kg
1/8	6	0.38	10	0.44	11	0.25	6	0.03	0.01
1/4	8	0.44	11	0.62	16	0.25	6	0.05	0.02
3/8	10	0.50	13	0.69	18	0.31	8	0.09	0.04
1/2	15	0.56	14	0.88	22	0.31	8	0.13	0.06
3/4	20	0.62	16	1.06	27	0.38	10	0.27	0.12
1	25	0.75	19	1.38	36	0.38	10	0.48	0.22
1 1/4	32	0.81	21	1.75	46	0.56	14	0.94	0.43
1 1/2	40	0.81	21	2.00	50	0.62	16	1.20	0.54
2	50	0.88	22	2.50	65	0.69	18	2.40	1.09
2 1/2	65	1.06	27	3.00	75	0.75	19	3.80	1.72
3	80	1.12	28	3.50	90	0.81	21	4.80	2.18
4	100	1.25	32	4.62	115	1.00	25	13.00	5.90

Figure 2121

Round Head Plugs

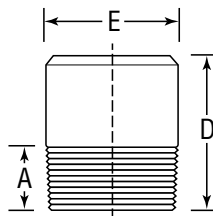

Size		A		D		E		Unit Weight	
NPS	DN	in	mm	in	mm	in	mm	lbs	kg
1/8	6	0.38	10	1.38	35	0.41	10	0.05	0.02
1/4	8	0.44	11	1.62	41	0.53	13	0.10	0.05
3/8	10	0.50	13	1.62	41	0.69	18	0.16	0.07
1/2	15	0.56	14	1.75	44	0.84	21	0.28	0.13
3/4	20	0.62	16	1.75	44	1.06	27	0.42	0.19
1	25	0.75	19	2.00	51	1.31	33	0.82	0.37
1 1/4	32	0.81	21	2.00	51	1.69	43	1.20	0.54
1 1/2	40	0.81	21	2.00	51	1.91	49	1.50	0.68
2	50	0.88	22	2.50	64	2.38	60	3.20	1.45
2 1/2	65	1.06	27	2.75	70	2.88	73	-	-
3	80	1.12	28	2.75	70	3.50	89	-	-
4	100	1.25	32	3.00	76	4.50	114	-	-

Note: Plugs and bushings are not identified by Pressure Class. They may be used for ratings up to Pressure Class 6000 (per ASME B16.11). 2 1/2 inch and larger plugs are cored.

PROJECT INFORMATION	APPROVAL STAMP
Project:	Approved
Address:	Approved as noted
Contractor:	Not approved
Engineer:	Remarks:
Submittal Date:	
Notes 1:	
Notes 2:	