

CATALOG NUMBER  
S1R8CSPB  
1-G BLANK PLATE

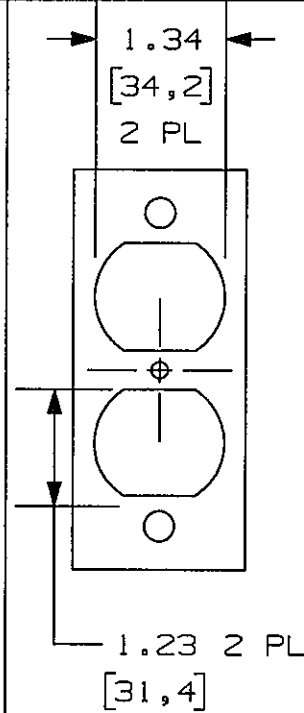

CATALOG NUMBER  
S1R8CSP1  
1-G DUPLEX

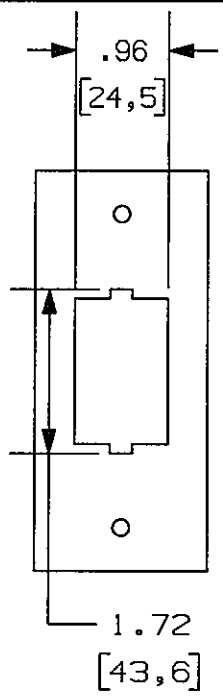

CATALOG NUMBER  
S1R8CSPD  
1-G IU i STATION

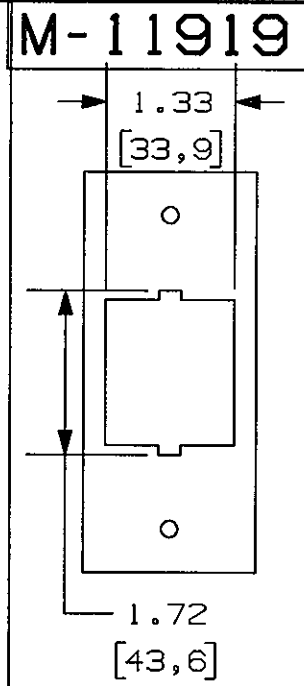

CATALOG NUMBER  
S1R8CSPE  
1-G 1.5U i STATION

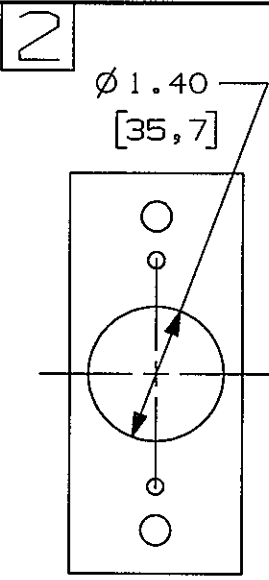

CATALOG NUMBER  
S1R8CSPJ  
1-G 1.4" OPENING

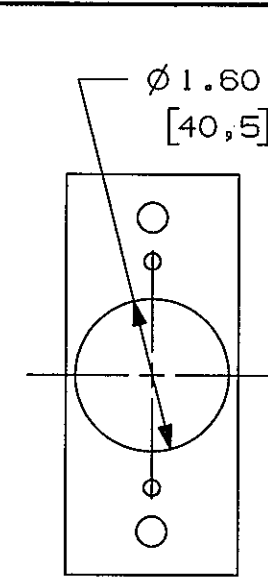

CATALOG NUMBER  
S1R8CSPG  
1-G 1.6" OPENING

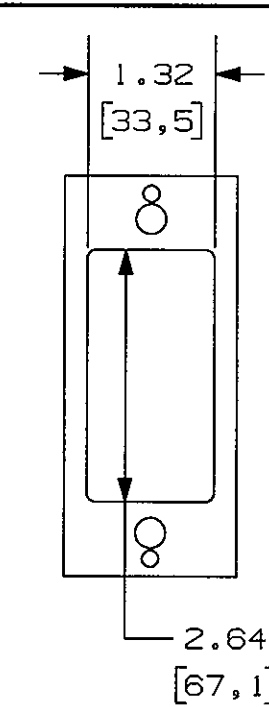

CATALOG NUMBER  
S1R8CSPK  
1-G STYLIN

M-11919 2

LIST OF PARTS

DESCRIPTION	MATERIAL	FINISH
COVER PLATE	STEEL	WHITE
MOUNTING SCREWS	STEEL	WHITE

DIMENSION SHEET FOR CAT. NO. **M-11919**  
 SEE INDIVIDUAL CAT NOS. REPAIRABLE  NON-REPAIRABLE

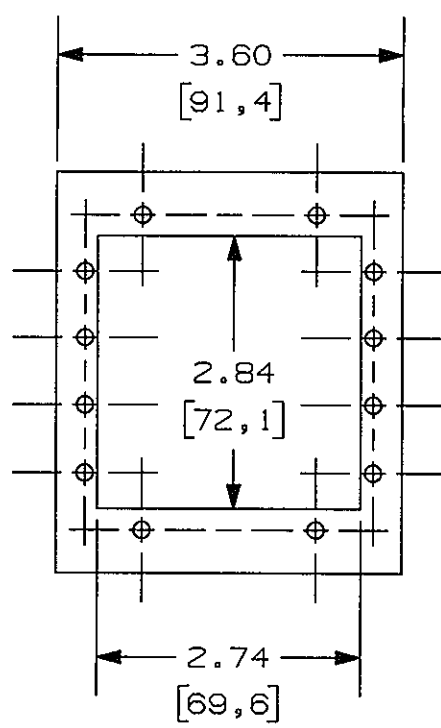

CATALOG NUMBER  
S1R8CSPA  
2-GANG  
(4) EXTRON AXP

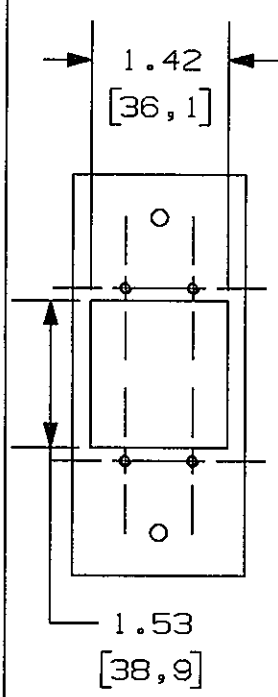

CATALOG NUMBER  
S1R8CSPC  
1-GANG  
(2) EXTRON MAAP

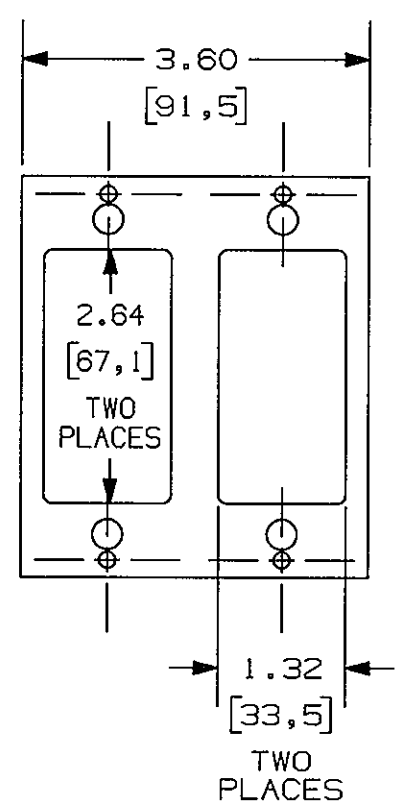

CATALOG NUMBER  
S1R8CSPM  
2-G STYLIN

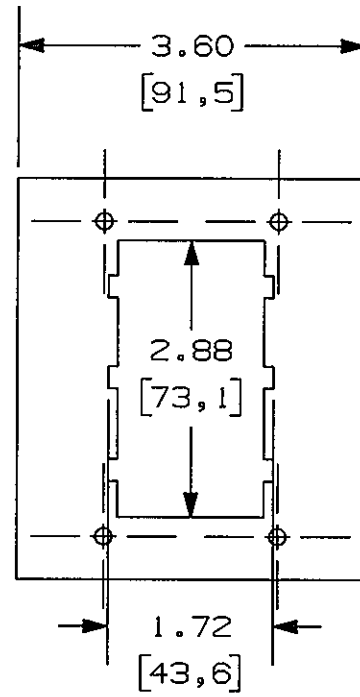

CATALOG NUMBER  
S1R8CSPL  
2 GANG  
3U i STATION

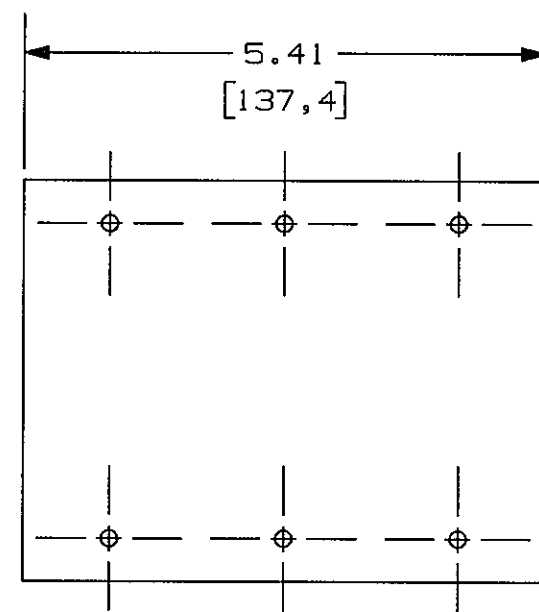

CATALOG NUMBER  
S1R8CSPN  
3 GANG  
BLANK PLATE

2	S1R8CSPA WAS 1-GANG (2) EXTRON AAP DCN19021	8/20/12
1	RELEASED PER DCN18435	12/14/11
SYM	REVISIONS	APP DATE

THE DESIGN AND DIMENSIONS OF THE PRODUCT SHOWN ON THIS DRAWING ARE SUBJECT TO CHANGE WITHOUT NOTICE

TITLE  
COVER PLATES, CENTER, FIRE RATED POKE THROUGH, 8 INCH DIAMETER

NOTES:  
 1) ALL DIMENSIONS ARE IN INCHES AND [MILLIMETERS]  
 2) ALL PLATES ARE THE SAME THICKNESS AND HEIGHT AS 1-G BLANK PLATE S1R8CSPB. SINGLE GANG (1-G) PLATES ARE THE SAME WIDTH AS S1R8CSPB.  
 3) ALL PLATES SHIPPED WITH MOUNTING SCREWS, NOT SHOWN.

TOLERANCES UNLESS OTHERWISE SPECIFIED	WIRING DEVICE-KELLEMS HUBBELL INCORPORATED SHELTON, CT
.XX = ±.01 .XXX = ±.005 ANGLES = ±2°	DR. BY SRE APP. BY <i>fw</i> TR. BY <i>fw</i> SCALE 1:2 CHK. BY DATE 6/15/11