

M-6057 5

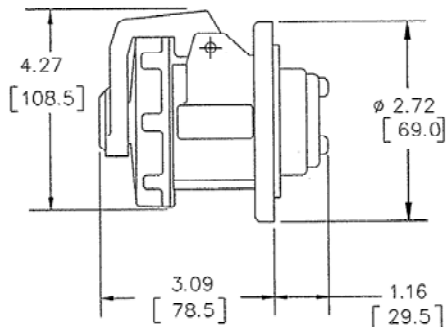
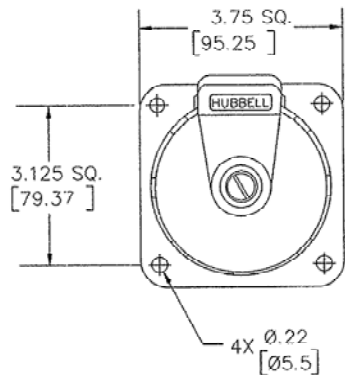

LIST OF PARTS

DESCRIPTION	MATERIAL	FINISH
HOUSING	SEE TABLE	
INTERIOR	THERMOSET	
SLEEVES	BRASS	
PH & NEUT. SPR.	STAIN STEEL	
GRD. INSERT	BERR COPPER	SILVER
TERM. SCRS.	STAIN STEEL	
COVER	POLYESTER	
COVER SCREW.	BRASS	NICKEL
COVER SPRING.	STAIN STEEL	
GASKET	NEOPRENE	
DISC	POLYCARBONATE	
ARM	POLYESTER	
HINGE PIN	STAIN STEEL	
HINGE SPR.	STAIN STEEL	
ASS'Y SCRS	STAIN STEEL	

DIMENSION SHEET FOR CAT. NO.

SEE TABLE

REPAIRABLE

NON-REPAIRABLE

B

M-6057

5

CAT. NO.	CONFIGURATION	RATING	HOUSING		CAT. NO.	CONFIGURATION	RATING	HOUSING	
			MATERIAL	COLOR				MATERIAL	COLOR
					HBL330R7W		30 A 480 VAC	NYLON	RED
					HBL330R8WDC		30 A 550 VAC	NYLON	BLACK
HBL330R4W		30 A 125 VAC	NYLON	YELLOW					
HBL332R4W		32 A 110-130VAC							
HBL330R6W		30 A 250 VAC	NYLON	BLUE					
HBL332R6W		32 A 220-240VAC							

5	ADDED POLARITY TO HBL330R8WDC, CORRECTED PIN CONFIG. ON HBL330R8WDC PER DCN16648 MYA TLS TLS	TL5	5/4/10
4	ADDED CAT. HBL330R8WDC PER DCN 16502 SPN TLS	MJM	4/12/10
3	REDRAWN ON CAD WITH CHANGES, ADDED "HOUSING" AND "COMMENTS" COLUMNS RATING FOR CAT'S HBL332R4W, & HBL332R6W TO TABLE, & "32A" TO DWG TITLE, AND NOTES 1& 2. IN TABLE, REMOVED CAT NO'S 330R3W, 330R5W, & 330R9W; AND "A" WAS "AMP" IN LIST OF PARTS. "SEE TABLE" WAS "NYLON" AND "NEOPRENE" WAS "RUBBER". .22 DIM WAS 7/32. "Ø" WAS "DIA." AND "(XX.X)" WAS "MM". SUPERSEDES DRAWING DATED 4/30/80 PER DCN #12944. JMN	DJP	6/7/06

SYM	REVISIONS	APP	DATE

THE DESIGN AND DIMENSIONS OF THE PRODUCT SHOWN ON THIS DRAWING ARE SUBJECT TO CHANGE WITHOUT NOTICE

TITLE 30A. & 32A 2 POLE 3 WIRE PIN AND SLEEVE RECEPTACLES

TOLERANCES UNLESS OTHERWISE SPECIFIED		WIRING DEVICE - KELLEMS HUBBELL INCORPORATED BRIDGEPORT, CT	
FRACTIONS	±1/64	DR. BY	MJK
DECIMALS	±0.03	TR. BY	JMN
ANGLES	±2°	APP. BY	DJP
		SCALE	NONE
		CHK'D BY	DJP
		DATE	6/13/06

NOTES: (UNLESS OTHERWISE SPECIFIED)
 1) TOLERANCES ARE:
 DECIMALS ±.03
 ANGLES ±2°
 2) DIMENSIONS ARE INCHES [MILLIMETERS]