

TOTO®

2015/2016

**COMMERCIAL
PRODUCTS**
BROCHURE |

TABLE OF CONTENTS

TOTO EVERYWHERE

INNOVATION & TECHNOLOGY HIGHLIGHTS3-5

ECOPOWER® FAUCETS

INNOVATION & TECHNOLOGY HIGHLIGHTS 7
 COMPATIBILITY CHART 8-9
 AXIOM® 10
 GOOSENECK 10
 GOOSENECK WALL-MOUNT 11
 HELIX® 11
 HELIX M 11
 HELIX WALL-HUNG 11
 INTEGRATED FAUCET 12
 LIBELLA™ 12
 LIBELLA M 12
 LIBELLA WALL-MOUNT 12
 LIBELLA WALL-MOUNT M 13
 STANDARD FAUCET 13

TOILETS & URINALS

INNOVATION & TECHNOLOGY HIGHLIGHTS 15
 TOILETS COMPATIBILITY CHART 16
 1G® TOILETS 17
 1.28 GPF TOILETS 18-20
 DRAKE® 18-19
 ENTRADA™ 20
 FLUSHOMETER HET 21
 FLUSHOMETER WALL-HUNG 21
 TOILET SEATS 22
 ECOPOWER HET TOILET FLUSH VALVE 1.28 23
 ECOPOWER FLUSH VALVE 1.6 24
 MANUAL HET FLUSH VALVE 24-25
 URINALS COMPATIBILITY CHART 26
 WASHOUT ULTRA HEU 27
 WASHOUT HEU 28
 ECOPOWER ULTRA HEU FLUSH VALVE 0.125 29
 ECOPOWER HEU FLUSH VALVE 0.5 30
 ECOPOWER FLUSH VALVE 1.0 31

LAVATORIES

LUMINIST® VESSEL 34
 SELF-RIMMING 35-36
 ATHERTON™ 37
 UNDER COUNTER 37-38
 WALL-HUNG 39

SOAP DISPENSERS

INNOVATION & TECHNOLOGY HIGHLIGHTS 41
 SENSOR OPERATED SOAP DISPENSERS 42
 SOAP 42-43

CLEAN DRY® HAND DRYERS

INNOVATION & TECHNOLOGY HIGHLIGHTS 45
 CLEAN DRY HAND DRYERS 46

COLORS & FINISHES 47





TOTO EVERYWHERE



TOTO products can create beautiful, refreshing bathroom experiences in any situation. We design everything from urinals to hand dryers, so even a football stadium or an airport restroom can be a peaceful, inspiring escape.

We're known for consistent high-performance design and a beautiful, global aesthetic in all our products, so wherever you find TOTO you can experience the same reliability, value and style.

- 

SENSOR
FAUCETS
- 

TOILETS
- 

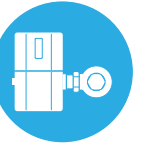
URINALS
- 

FLUSH VALVES
- 

LAVATORIES
- 

HAND DRYERS

In today's fast-paced world, the need for superior performance and reliability means everything. And when it comes to busy commercial buildings, TOTO products are the only choice. We design world-class, eco-friendly plumbing products that help you save water and money without sacrificing an ounce of performance.

LEADERSHIP & VISION

MAKING OUR PLANET
A BETTER PLACE,
DROP BY DROP.



Water is life's most precious element, and at TOTO, we innovate products to help conserve it. All of our high-efficiency showers (2.0 GPM), ultra high-efficiency toilets (1.0 GPF), urinals (0.125 GPF) and Commercial Faucets (0.5GPM / 0.09GPC) meet the California Code of Water Regulations.

CERTIFICATION & COMPLIANCE

TOTO offers a full range of bathroom products that can help professionals in the commercial industry earn LEED points toward certification.

LEED is an internationally recognized green building certification system that provides third-party verification for a building or community. To get maximum LEED points, a new or existing building must reach specified water-usage reduction percentages. The more usage reductions, the more LEED points are earned.



THE AMERICAN DISABILITY ACT (ADA)

The American Disability Act (ADA) was enacted in 1990 to establish design codes to serve people of all ages and abilities. A core principle behind TOTO Total Design, ADA standards consider the needs of everyone without additional adaptation or specialization, optimizing the bathroom experience for all generations in the family home.

By innovating ergonomics and accessibility, and combining them with our global design aesthetic, we give everyone everything that’s great about TOTO.

ENVIRONMENTAL RESPONSIBILITY

TOTO plays a significant role in leading the sustainability charge in our industry. In fact, our active role in leading policy and certification organizations demonstrates how we go beyond products or practices to help ensure environmental responsibility across all company activities.

- ▶ TOTO is the only plumbing manufacturer to receive the EPA’s Water Efficiency Leader Award
- ▶ TOTO was the first plumbing products manufacturer to have employees become sustainability experts by gaining LEED Accredited Professional status
- ▶ TOTO was the first major plumbing products manufacturer to join the United States Green Building Council (USGBC)
- ▶ TOTO was the first plumbing products manufacturer to develop third-party verified LCA Transparency Reports for bath products.



EPA WaterSense Partner



Green Building Initiative



Water Efficiency Leader Award



Environmental Protection Agency



LEED AP



Argon Award



Meets California Water Savings Regulations



Product shown: Libella™ EcoPower® Faucet

COMMERCIAL ECOPOWER® FAUCETS

Innovation & Technology Highlights



EcoPower sensor faucets harness the energy of running water to power itself. It's a simple solution that saves water and energy. That's the TOTO theory of sustainability.

The water-powered turbine in the EcoPower faucet creates an electrical current that is stored in rechargeable cells to power the Smart Sensor System. EcoPower replenishes its charge with as few as five uses a day and is optimized at 10 uses per day. This translates into reduced electricity use, lower maintenance costs and better ecology with hands-free, automatic-shut-off functionality.

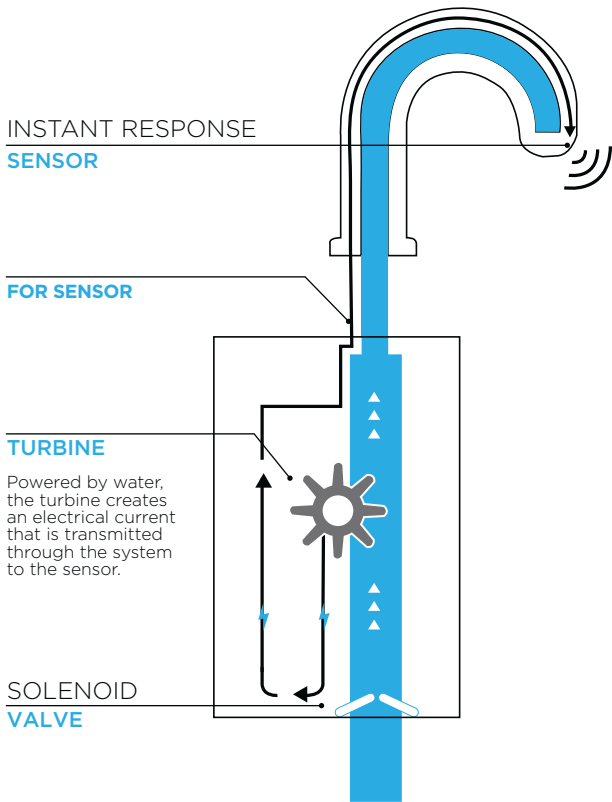

ECOPOWER ADVANTAGE

- ▶ Sustainably engineered to require no external electricity source
- ▶ Hydropower system needs no routine battery replacement which lowers maintenance costs
- ▶ Strategically placed sensor ensures instantaneous water response, minimizing water wastage
- ▶ Hands-free operation reduces the chance of spreading contaminants



TOTO COMMERCIAL PERFORMANCE

A WIN-WIN. Unlike other sensor faucets, EcoPower faucets use hydropower to operate the sensor. The flow of water, which meets the most rigorous water saving standards, spins the high-efficiency turbine to both create and store power for operation. TOTO is the only manufacturer with this proprietary sensor technology.

ECOPOWER® FAUCET IDENTIFICATION CHART

KIT (INCLUDES SPOUT & CONTROLLER)

		0.9 GPC, (10 SEC-ON DEMAND) @ 0.5 GPM			0.19 GPC, (20 SEC-CONTINUOUS) @ 0.5 GPM		
PRODUCT	SKU#	SINGLE SUPPLY	HOT/COLD MIXING VALVE	THERMOSTATIC MIXING VALVE	SINGLE SUPPLY	HOT/COLD MIXING VALVE	THERMOSTATIC MIXING VALVE
Axiom®	TEL145	TEL145-D10E#CP	TEL145-D10EM#CP	TEL145-D10ET#CP	TEL145-C20E#CP	TEL145-C20EM#CP	TEL145-D20ET#CP
Gooseneck®	TEL155	TEL155-D10E#CP	TEL155-D10EM#CP	TEL155-D10ET#CP	TEL155-C20E#CP	TEL155-C20EM#CP	TEL155-D20ET#CP
Gooseneck Wall-Mount	TEL165	TEL165-D10E#CP	TEL165-D10EM#CP	TEL165-D10ET#CP	TEL165-C20E#CP	TEL165-C20EM#CP	TEL165-D20ET#CP
Helix®	TEL115	TEL115-D10E#CP	TEL115-D10EM#CP	TEL115-D10ET#CP	TEL115-C20E#CP	TEL115-C20EM#CP	TEL115-D20ET#CP
Helix M	TEL125	TEL125-D10E#CP	TEL125-D10EM#CP	TEL125-D10ET#CP	TEL125-C20E#CP	TEL125-C20EM#CP	TEL125-D20ET#CP
Helix Wall-Mount	TEL135	TEL135-D10E#CP	TEL135-D10EM#CP	TEL135-D10ET#CP	TEL135-C20E#CP	TEL135-C20EM#CP	TEL135-D20ET#CP
Libella™	TEL1A5	TEL1A5-D10E#CP	TEL1A5-D10EM#CP	TEL1A5-D10ET#CP	TEL1A5-C20E#CP	TEL1A5-C20EM#CP	TEL1A5-D20ET#CP
Libella M	TEL1B5	TEL1B5-D10E#CP	TEL1B5-D10EM#CP	TEL1B5-D10ET#CP	TEL1B5-C20E#CP	TEL1B5-C20EM#CP	TEL1B5-D20ET#CP
Libella Wall-Mount	TEL1C5	TEL1C5-D10E#CP	TEL1C5-D10EM#CP	TEL1C5-D10ET#CP	TEL1C5-C20E#CP	TEL1C5-C20EM#CP	TEL1C5-D20ET#CP
Libella Wall-Mount M	TEL1D5	TEL1D5-D10E#CP	TEL1D5-D10EM#CP	TEL1D5-D10ET#CP	TEL1D5-C20E#CP	TEL1D5-C20EM#CP	TEL1D5-D20ET#CP
Standard	TEL105*	TEL105-D10E#CP	TEL105-D10EM#CP	TEL105-D10ET#CP	TEL105-C20E#CP	TEL105-C20EM#CP	TEL105-D20ET#CP
Integrated	TEL5LI15R	Controller integrated into the spout above the deck, 0.15 GPC (15 Sec. On Demand)					

* Standard spout available in:
Polished Chrome #CP, Brushed Nickel #BN, Polished Nickel #PN

GPC(Gallons Per Cycle) | GPM(Gallons Per Minute)

**ECOPOWER® FAUCET
IDENTIFICATION
CHART**

		KIT (INCLUDES SPOUT & CONTROLLER)			AVAILABLE VALVES	
		0.18 GPC, (10 SEC-ON DEMAND) @ 1.0 GPM				
PRODUCT	SKU#	SINGLE SUPPLY	HOT/COLD MIXING VALVE	THERMOSTATIC MIXING VALVE	HOT/COLD MIXING VALVE	THERMOSTATIC MIXING VALVE
Axiom®	TEL141	TEL141-D10E#CP	TEL141-D10EM#CP	TEL141-D10ET#CP	TLM10	TLT10
Gooseneck®	TEL151	TEL151-D10E#CP	TEL151-D10EM#CP	TEL151-D10ET#CP		
Gooseneck Wall-Mount	TEL161	TEL161-D10E#CP	TEL161-D10EM#CP	TEL161-D10ET#CP		
Helix®	TEL111	TEL111-D10E#CP	TEL111-D10EM#CP	TEL111-D10ET#CP		
Helix M	TEL121	TEL121-D10E#CP	TEL121-D10EM#CP	TEL121-D10ET#CP		
Helix Wall-Mount	TEL131	TEL131-D10E#CP	TEL131-D10EM#CP	TEL131-D10ET#CP		
Libella™	TEL1A1	TEL1A1-D10E#CP	TEL1A1-D10EM#CP	TEL1A1-D10ET#CP		
Libella M	TEL1B1	TEL1B1-D10E#CP	TEL1B1-D10EM#CP	TEL1B1-D10ET#CP		
Libella Wall-Mount	TEL1C1	TEL1C1-D10E#CP	TEL1C1-D10EM#CP	TEL1C1-D10ET#CP		
Libella Wall-Mount M	TEL1D1	TEL1D1-D10E#CP	TEL1D1-D10EM#CP	TEL1D1-D10ET#CP		
Standard	TEL101*	TEL101-D10E#CP	TEL101-D10EM#CP	TEL101-D10ET#CP		

* Standard spout available in:
Polished Chrome #CP, Brushed Nickel #BN, Polished Nickel #PN

GPC(Gallons Per Cycle) | GPM(Gallons Per Minute)

ECOPOWER® FAUCETS OVERVIEW

**AXIOM®
ECOPOWER FAUCET**
TEL145-D10E (0.5GPM / 0.09GPC)
TEL145-C20E (0.5GPM / 0.19GPC)
TEL141-D10E (1.0GPM / 0.18GPC)



CAL Green

NEW



- ▶ Self-generating hydropower EcoPower system
- ▶ No minimum daily usage requirement
- ▶ Micro-sensor positioned underneath the spout head for accurate hand detection ensuring smooth and consistent water distribution
- ▶ Vandal resistant aerator housing
- ▶ Durable chrome plated spout body
- ▶ Single-hole mount
- ▶ Kit includes spout body, controller box, and mounting hardware - less supply lines
- ▶ Equipped with 0.5gpm or 1.0gpm flow control

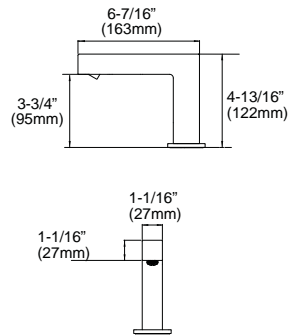

**GOOSENECK
ECOPOWER FAUCET**
TEL155-D10E (0.5GPM / 0.09GPC)
TEL155-C20E (0.5GPM / 0.19GPC)
TEL151-D10E (1.0GPM / 0.18GPC)



CAL Green

NEW

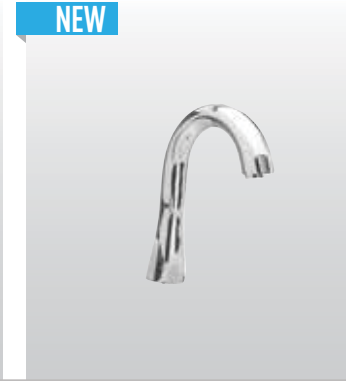

- ▶ Self-generating hydropower EcoPower system
- ▶ No minimum daily usage requirement
- ▶ Micro-sensor positioned underneath the spout head for accurate hand detection ensuring smooth and consistent water distribution
- ▶ Vandal resistant aerator housing
- ▶ Durable chrome plated spout body
- ▶ Single-hole mount
- ▶ Kit includes spout body, controller box, and mounting hardware - less supply lines
- ▶ Equipped with 0.5gpm or 1.0gpm flow control

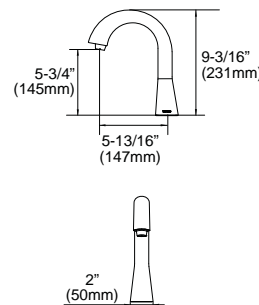

**GOOSENECK WALL-MOUNT
ECOPOWER FAUCET**
TEL165-D10E (0.5GPM / 0.09GPC)
TEL165-C20E (0.5GPM / 0.19GPC)
TEL161-D10E (1.0GPM / 0.18GPC)



CAL Green

NEW



- ▶ Self-generating hydropower EcoPower system
- ▶ No minimum daily usage requirement
- ▶ Micro-sensor positioned underneath the spout head for accurate hand detection ensuring smooth and consistent water distribution
- ▶ Vandal resistant aerator housing
- ▶ Durable chrome plated spout body
- ▶ Single-hole mount
- ▶ Kit includes spout body, controller box, and mounting hardware - less supply lines
- ▶ Equipped with 0.5gpm or 1.0gpm flow control

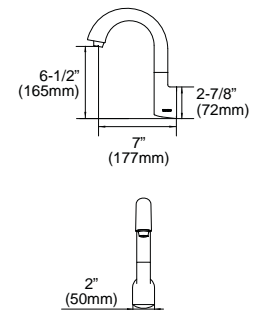

**HELIX®
ECOPOWER FAUCET**
TEL115-D10E (0.5GPM / 0.09GPC)
TEL115-C20E (0.5GPM / 0.19GPC)
TEL111-D10E (1.0GPM / 0.18GPC)



CAL Green

NEW



**HELIX M
ECOPOWER FAUCET**
TEL125-D10E (0.5GPM / 0.09GPC)
TEL125-C20E (0.5GPM / 0.19GPC)
TEL121-D10E (1.0GPM / 0.18GPC)



CAL Green

NEW



**HELIX WALL-MOUNT
ECOPOWER FAUCET**
TEL135-D10E (0.5GPM / 0.09GPC)
TEL135-C20E (0.5GPM / 0.19GPC)
TEL131-D10E (1.0GPM / 0.18GPC)



CAL Green

NEW

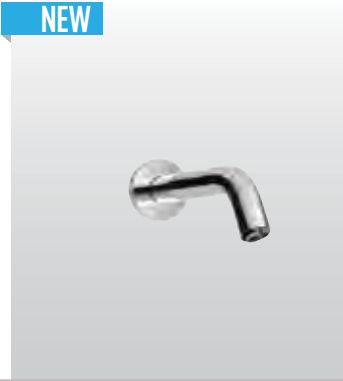

- ▶ Self-generating hydropower EcoPower system
- ▶ No minimum daily usage requirement
- ▶ Micro-sensor positioned underneath the spout head for accurate hand detection ensuring smooth and consistent water distribution
- ▶ Vandal resistant aerator housing
- ▶ Durable chrome plated spout body
- ▶ Single-hole mount
- ▶ Kit includes spout body, controller box, and mounting hardware - less supply lines
- ▶ Equipped with 0.5gpm or 1.0gpm flow control

- ▶ Self-generating hydropower EcoPower system
- ▶ No minimum daily usage requirement
- ▶ Micro-sensor positioned underneath the spout head for accurate hand detection ensuring smooth and consistent water distribution
- ▶ Vandal resistant aerator housing
- ▶ Durable chrome plated spout body
- ▶ Single-hole mount
- ▶ Kit includes spout body, controller box, and mounting hardware - less supply lines
- ▶ Equipped with 0.5gpm or 1.0gpm flow control

- ▶ Self-generating hydropower EcoPower system
- ▶ No minimum daily usage requirement
- ▶ Micro-sensor positioned underneath the spout head for accurate hand detection ensuring smooth and consistent water distribution
- ▶ Vandal resistant aerator housing
- ▶ Durable chrome plated spout body
- ▶ Single-hole mount
- ▶ Kit includes spout body, controller box, and mounting hardware - less supply lines
- ▶ Equipped with 0.5gpm or 1.0gpm flow control

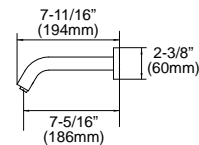
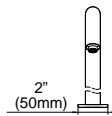
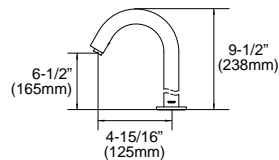
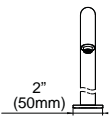
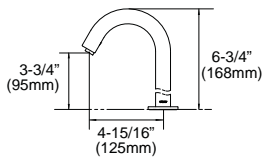

ECOPOWER® FAUCETS OVERVIEW

**INTEGRATED
ECOPOWER FAUCET**
TEL5L115R-D10E (0.5GPM/0.09GPC)
TEL5L115R-C20E (0.5GPM/0.19GPC)
TEL5L115R-D10E (1.0GPM/0.18GPC)



CAL Green



**LIBELLA™
ECOPOWER FAUCET**
TEL1A5-D10E (0.5GPM / 0.09GPC)
TEL1A5-C20E (0.5GPM / 0.19GPC)
TEL1A1-D10E (1.0GPM / 0.18GPC)



CAL Green



**LIBELLA M
ECOPOWER FAUCET**
TEL1A5-D10E (0.5GPM / 0.09GPC)
TEL1A5-C20E (0.5GPM / 0.19GPC)
TEL1A1-D10E (1.0GPM / 0.18GPC)



CAL Green



- ▶ Hydropower self-generating system
- ▶ Micro-sensor positioned underneath the spout head for accurate hand detection
- ▶ Adjustable temperature control
- ▶ Controller integrated into the faucet above the deck for easy installation
- ▶ Thermostatic mixer with SMA technology for superior scald protection
- ▶ Single-hole mount
- ▶ Equipped with 0.5gpm flow control

- ▶ Hydropower self-generating system
- ▶ Consists of spout and controller
- ▶ No minimum daily usage requirement
- ▶ Micro-sensor positioned underneath the spout head for accurate hand detection ensuring smooth and consistent water distribution
- ▶ Vandal resistant aerator housing
- ▶ Sensor faucet with aerated flow
- ▶ Self adjusting faucet with controller box and mounting hardware, less supply lines
- ▶ Single-hole mount
- ▶ Equipped with 0.5gpm or 1.0gpm flow control
- ▶ Available in 2015 Q4

- ▶ Hydropower self-generating system
- ▶ Consists of spout and controller
- ▶ No minimum daily usage requirement
- ▶ Micro-sensor positioned underneath the spout head for accurate hand detection ensuring smooth and consistent water distribution
- ▶ Vandal resistant aerator housing
- ▶ Sensor faucet with aerated flow
- ▶ Self adjusting faucet with controller box and mounting hardware, less supply lines
- ▶ Single-hole mount
- ▶ Equipped with 0.5gpm or 1.0gpm flow control
- ▶ Available in 2015 Q4

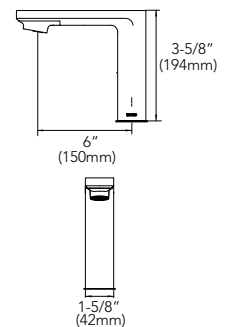
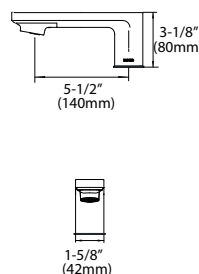
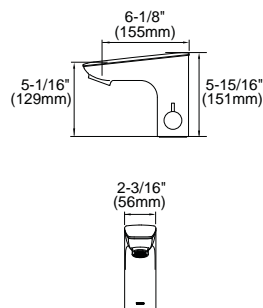

For more information on dimensions please refer to product spec sheet.

LIBELLA WALL-MOUNT ECOPOWER FAUCET

TEL1C5-D10E (0.5GPM / 0.09GPC)
 TEL1C5-C20E (0.5GPM / 0.19GPC)
 TEL1C1-D10E (1.0GPM / 0.18GPC)



CALGreen

NEW



LIBELLA™ WALL-MOUNT M ECOPOWER FAUCET

TEL1D5-D10E (0.5GPM / 0.09GPC)
 TEL1D5-C20E (0.5GPM / 0.19GPC)
 TEL1D1-D10E (1.0GPM / 0.18GPC)



CALGreen

NEW



STANDARD ECOPOWER FAUCET

TEL105-D10E (0.5GPM / 0.09GPC)
 TEL105-C20E (0.5GPM / 0.19GPC)
 TEL101-D10E (1.0GPM / 0.18GPC)



CALGreen

NEW



- ▶ Hydropower self-generating system
- ▶ Consists of spout and controller
- ▶ No minimum daily usage requirement
- ▶ Micro-sensor positioned underneath the spout head for accurate hand detection ensuring smooth and consistent water distribution
- ▶ Vandal resistant aerator housing
- ▶ Sensor faucet with aerated flow
- ▶ Self adjusting faucet with controller box and mounting hardware, less supply lines
- ▶ Single-hole mount
- ▶ Equipped with 0.5gpm or 1.0gpm flow control
- ▶ Available in 2015 Q4

- ▶ Hydropower self-generating system
- ▶ Consists of spout and controller
- ▶ No minimum daily usage requirement
- ▶ Micro-sensor positioned underneath the spout head for accurate hand detection ensuring smooth and consistent water distribution
- ▶ Vandal resistant aerator housing
- ▶ Sensor faucet with aerated flow
- ▶ Self adjusting faucet with controller box and mounting hardware, less supply lines
- ▶ Single-hole mount
- ▶ Equipped with 0.5gpm or 1.0gpm flow control
- ▶ Available in 2015 Q4

- ▶ Hydropower self-generating system
- ▶ Consists of spout and controller
- ▶ No minimum daily usage requirement
- ▶ Micro-sensor positioned underneath the spout head for accurate hand detection ensuring smooth and consistent water distribution
- ▶ Vandal resistant aerator housing
- ▶ Durable chrome plated spout body
- ▶ Single-hole mount
- ▶ Kit includes spout body, controller box, and mounting hardware - less supply lines
- ▶ Equipped with 0.5gpm or 1.0gpm flow control

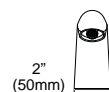
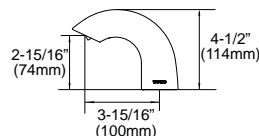
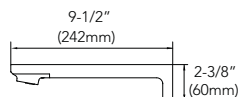
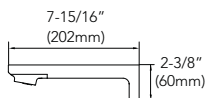

For more information on dimensions please refer to product spec sheet.



ONE GALLON

1G® TOILETS
1.0 GPF

TOTO's 1G toilets are a perfect solution to help owners and managers of hospitality and multi-family housing properties address their water conservation challenges. The powerful, yet quiet 1G system offers a 35 percent savings over 1.6 GPF toilets — a substantial savings without wavering on our renowned performance.



Reduces water use by 35% or more on average over a standard 1.6 GPF toilet



TOTO 1G TOILETS
operating cost
per year.

\$175
5,840 GALLONS

vs.



STANDARD 1.6 GPF TOILETS
operating cost
per year.

\$280
9,344 GALLONS

*The average American flushes five times a day at home. Assuming an average household of 3.2 people over 365 days @ 3¢ per gallon.

COMMERCIAL TOILETS, URINALS & FLUSH VALVES

Innovation & Technology Highlights

THE TOTO ADVANTAGE

- ▶ Thorough and extensive testing to ensure balanced flushing
- ▶ HETs use 1.28 GPF
- ▶ HEUs use as little as 0.125 GPF
- ▶ TOTO toilet and urinal fixtures are designed for efficient operation, ensuring the highest performance with the lowest consumption levels.

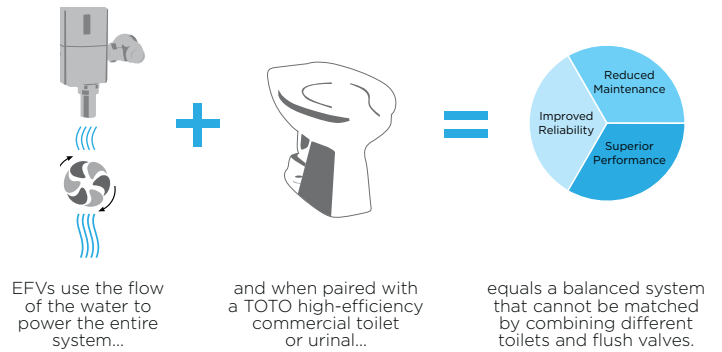

CEFIONTECT™

- ▶ Extraordinarily smooth glaze prevents particulates from adhering to ceramic surfaces
- ▶ The ion-barrier in CeFiONtect keeps surfaces cleaner, longer
- ▶ Less cleaning means less water use and fewer chemicals in the environment

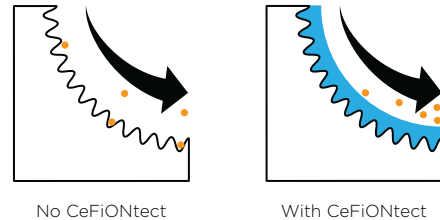

ECOPOWER® FLUSH VALVES

- ▶ Micro-Turbine uses water to create power
- ▶ EcoPower flush valves provide maximum performance in high-traffic commercial spaces
- ▶ Self-powering eliminates costs of installing electrical supplies and wiring
- ▶ No routine battery replacement means less maintenance costs

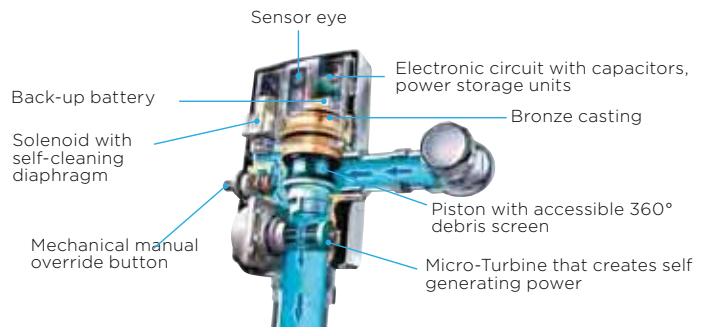

TOILETS COMPARISON CHART

	SKU#			MIN. ROUGH-IN	BOWL			SEAT HEIGHT	RECOM. SEAT	FLUSH. SYSTEM	GPF							
	KIT	BOWL	TANK		ELON.	ROUN.	SD				1G (3.8L)	1.28 (4.8L)	1.6 (6L)	DUAL				
ULTRAMAX II 1G	MS604114CUFG	N/A	N/A	12"	•			UNIVERSAL	SSI14 included		•				•	•	•	•
CARLYLE II 1G	MS614114CUFG	N/A	N/A	12"	•		•	UNIVERSAL	SSI14 included		•				•	•	•	•
DRAKE II 1G	CST454CUF(G)	C454CUF(G)	ST453U	12"	•			UNIVERSAL	SSI14		•				•*	•	•	•
DRAKE II	CST454CEF(G)	C454CUF(G)	ST454E	12"	•			UNIVERSAL	SSI14			•			•*	•	•	•
VESPIN II 1G	CST474CUF(G)	CT474CUF(G)	ST453U	12" (10"-14")	•		•	UNIVERSAL	SSI14		•				•*	•	•	•
ECO DRAKE	CST744EL	C744EL	ST743E	12"	•			ADA	SSI14			•				•	•	•
	CST744SL	C744EL	ST743S	12"	•			ADA	SSI14				•			•	•	
	CST744ELN	C744EL	ST744E	12"	•			ADA	SSI14			•				•	•	•
	CST744EG	C744EG	ST743E	12"	•			REGULAR	SSI14			•			•			•
	CST744E	C744E	ST743E	12"	•			REGULAR	SSI14			•						•
	CST744SG	C744EG	ST743S	12"	•			REGULAR	SSI14				•		•			
	CST744S	C744E	ST743S	12"	•			REGULAR	SSI14				•					
	CST744EGN	C744EG	ST744E	12"	•			REGULAR	SSI14			•			•			•
	CST744EN	C744E	ST744E	12"	•			REGULAR	SSI14			•						•
	CST744EF.10	C744EF.10	ST743E	10"	•			UNIVERSAL	SSI14			•				•	•	•
	CST744SF.10	C744EF.10	ST743S	10"	•			UNIVERSAL	SSI14				•			•	•	
	CST744EFN.10	C744EF.10	ST744E	10"	•			UNIVERSAL	SSI14			•				•	•	•
	CST743E	C743E	ST743E	12"		•		REGULAR	SSI13			•						•
	CST743S	C743E	ST743S	12"		•		REGULAR	SSI13				•					
CST743EN	C743E	ST744E	12"		•		REGULAR	SSI13			•						•	
ENTRADA	CST244EF	C244EF	ST243E	12"	•			UNIVERSAL	SSI14			•				•	•	•
	CST243EF	C243EF	ST243E	12"		•		UNIVERSAL	SSI13			•				•	•	•

* #51: Less CeFIONtect

TOILET FLUSH VALVE COMPATIBILITY CHART

				FLUSHOMETER			
				ECOPOWER®		MANUAL	
PRODUCT		SKU#		1.28 GPF	1.6 GPF	1.28 GPF	1.6 GPF
TOILET	Floor Mounted Top Spud	CT705EN(G)	Exposed	TET1LN32#CP TET6LN32#CP	TET1GNC-32 TET6GNC-32	TMT1LN32#CP	TMT1NNC-32
			Concealed	TET2LN32#SS TET3LN32#SS	TET2GN32#SS TET3GN32#SS		
	Floor Mounted Top Spud	CT705ELN(G)	Exposed	TET1LN32#CP TET6LN32#CP	TET1GNC-32 TET6GNC-32	TMT1LN32#CP	TMT1NNC-32
			Concealed	TET2LN32#SS TET3LN32#SS	TET2GN32#SS TET3GN32#SS		
	Wall-Mounted Top Spud	CT708E(G)	Exposed	TET1LN32#CP TET6LN32#CP	TET1GNC-32 TET6GNC-32	TMT1LN32#CP	TMT1NNC-32
			Concealed	TET2LN32#SS TET3LN32#SS	TET2GN32#SS TET3GN32#SS		
Wall-Mounted Back Spud	CT708EV(G)	Concealed	TET3LN31#SS TET2LN31#SS	TET3GN31#SS TET2GN31#SS			

1G 1.0 GPF TOILETS OVERVIEW

ULTRAMAX® II 1G® ONE-PIECE TOILET 1.0 GPF

MS604114CUFG



CARLYLE® II 1G ONE-PIECE TOILET 1.0 GPF

MS614114CUFG



DRAKE® II 1G TWO-PIECE TOILET 1.0GPF

CST454CUF(R)(G)



VESPIN® II 1G TWO-PIECE TOILET 1.0GPF

CST474CUF(R)(G)



- ▶ Tornado Flush™ system, ultra high-efficiency (1.0GPF/3.8LPPF)
- ▶ CeFiONtect™ ceramic glaze
- ▶ ADA Compliant
- ▶ Universal Height
- ▶ One-piece toilet with high-profile tank
- ▶ Elongated front bowl with SoftClose® seat (SS114)
- ▶ 12" rough-in, less supply
- ▶ Chrome trip lever
- ▶ Meets water efficiency and performance standards
- ▶ Available in #01 Cotton only

- ▶ Tornado Flush system, ultra high-efficiency (1.0GPF/3.8LPPF)
- ▶ CeFiONtect ceramic glaze
- ▶ ADA Compliant
- ▶ Universal Height
- ▶ One-piece toilet with high-profile tank
- ▶ Elongated front bowl with SoftClose seat (SS114)
- ▶ 12" rough-in, less supply
- ▶ Chrome trip lever
- ▶ Meets water efficiency and performance standards
- ▶ Available in #01 Cotton only

- ▶ Tornado Flush system, ultra high-efficiency (1.0GPF/3.8LPPF)
- ▶ CeFiONtect ceramic glaze
- ▶ ADA Compliant
- ▶ Universal Height
- ▶ Two-piece toilet with high-profile tank
- ▶ Elongated front bowl and tank set, less seat
- ▶ 12" Rough-in, less supply
- ▶ Chrome trip lever
- ▶ Meets water efficiency and performance standards

- ▶ Tornado Flush system, ultra high-efficiency (1.0GPF/3.8LPPF)
- ▶ CeFiONtect ceramic glaze
- ▶ ADA Compliant
- ▶ Universal Height
- ▶ Two-piece toilet with high-profile tank
- ▶ Elongated front bowl and tank set, less seat
- ▶ 12" Rough-in, less supply
- ▶ Chrome trip lever
- ▶ Meets water efficiency and performance standards

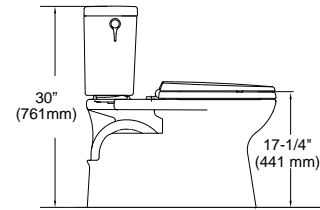
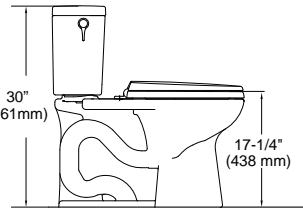
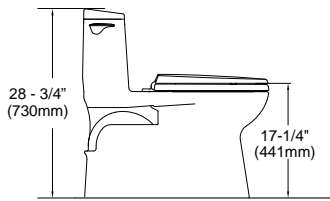
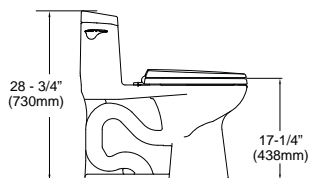
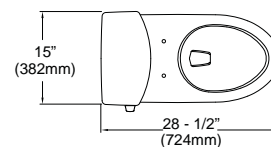
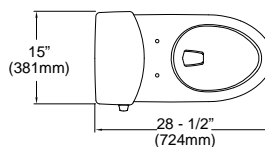
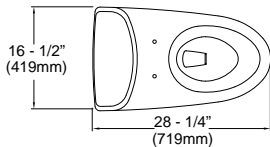
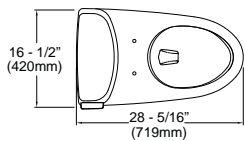

For more information on dimensions please refer to product spec sheet.

AVAILABLE COLORS



1.28 GPF TOILETS OVERVIEW

ECO DRAKE®
TWO-PIECE TOILET
1.28 GPF
CST744E(R)(G)



CALGreen

ECO DRAKE TRANSITIONAL
TWO-PIECE TOILET
1.28 GPF
CST744E(R)(G)N



CALGreen

ECO DRAKE - ADA
TWO-PIECE TOILET
1.28 GPF
CST744EL(R)



CALGreen

ECO DRAKE TRANSITIONAL - ADA
TWO-PIECE TOILET
1.28 GPF
CST744EL(R)N



CALGreen



- ▶ E-Max flushing system, high-efficiency (1.28 GPF/4.8 LPF)
- ▶ Optional CeFiONtect™ ceramic glaze
- ▶ Two-piece toilet with high-profile tank
- ▶ Elongated front bowl and tank set, less seat
- ▶ Chrome trip lever
- ▶ 12" Rough-in, less supply
- ▶ Meets water efficiency and performance standards

- ▶ Transitional Design
- ▶ E-Max flushing system, high-efficiency (1.28 GPF/4.8 LPF)
- ▶ Optional CeFiONtect ceramic glaze
- ▶ Two-piece toilet with high-profile tank
- ▶ Elongated front bowl and tank set, less seat
- ▶ Chrome trip lever
- ▶ 12" Rough-in, less supply
- ▶ Meets water efficiency and performance standards

- ▶ E-Max flushing system, high-efficiency (1.28GPF/4.8LPF)
- ▶ Universal Height
- ▶ Two-piece toilet with high-profile tank
- ▶ Elongated front bowl and tank set, less seat
- ▶ Chrome trip lever
- ▶ 12" Rough-in, less supply
- ▶ ADA compliant
- ▶ Meets water efficiency and performance standards

- ▶ Transitional Design
- ▶ E-Max flushing system, high-efficiency (1.28GPF/4.8LPF)
- ▶ Universal Height
- ▶ Two-piece toilet with high-profile tank
- ▶ Elongated front bowl and tank set, less seat
- ▶ Chrome trip lever
- ▶ 12" Rough-in, less supply
- ▶ ADA compliant
- ▶ Meets water efficiency and performance standards

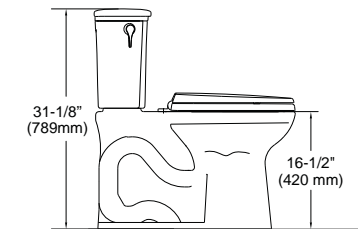
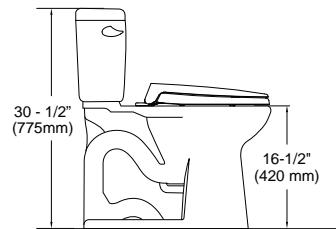
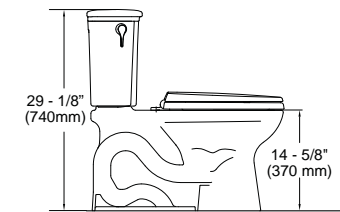
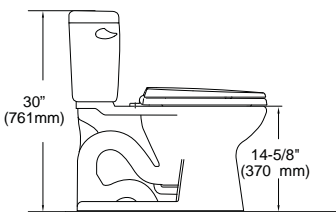
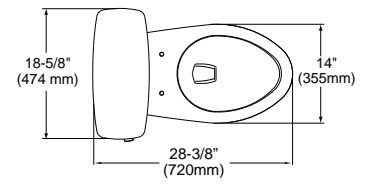
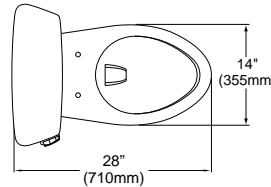
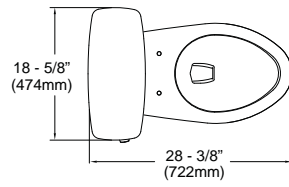
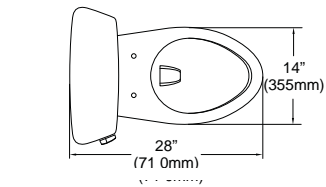

AVAILABLE COLORS



For more information on dimensions please refer to product spec sheet.

ECO DRAKE - 10"
TWO-PIECE TOILET
1.28 GPF
CST744EF(R).10



ECO DRAKE TRANSITIONAL - 10"
TWO-PIECE TOILET
1.28 GPF
CST744EF(R).N.10



ECO DRAKE - ROUND
TWO-PIECE TOILET
1.28 GPF
CST743E(R)



ECO DRAKE TRANSITIONAL -
ROUND
TWO-PIECE TOILET
1.28 GPF
CST743E(R).N



- ▶ E-Max® flushing system, high-efficiency (1.28GPF/4.8LPF)
- ▶ Universal Height
- ▶ Two-piece toilet with high-profile tank
- ▶ Elongated front bowl and tank set, less seat
- ▶ ADA compliant
- ▶ Chrome trip lever
- ▶ 10" Rough-in, less supply
- ▶ Meets water efficiency and performance standards

- ▶ Transitional design
- ▶ E-Max flushing system, high-efficiency (1.28GPF/4.8LPF)
- ▶ Universal Height
- ▶ Two-piece toilet with high-profile tank
- ▶ Elongated front bowl and tank set, less seat
- ▶ ADA compliant
- ▶ Chrome trip lever
- ▶ 10" Rough-in, less supply
- ▶ Meets water efficiency and performance standards

- ▶ E-Max flushing system
- ▶ Two-piece toilet with high-profile tank
- ▶ Round front bowl and tank set, less seat
- ▶ Chrome trip lever
- ▶ 12" Rough-in, less supply
- ▶ Meets water efficiency and performance standards

- ▶ Transitional design
- ▶ E-Max flushing system
- ▶ Two-piece toilet with high-profile tank
- ▶ Round front bowl and tank set, less seat
- ▶ Chrome trip lever
- ▶ 12" Rough-in, less supply
- ▶ Meets water efficiency and performance standards

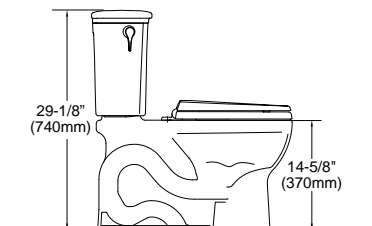
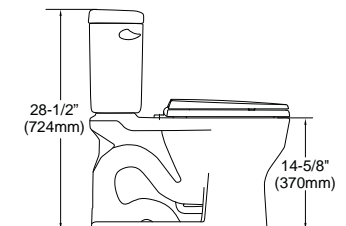
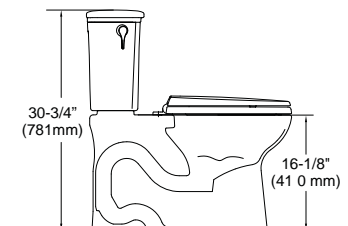
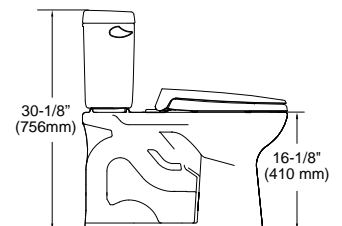
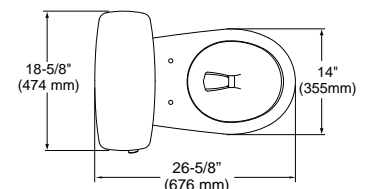
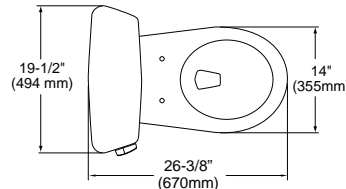
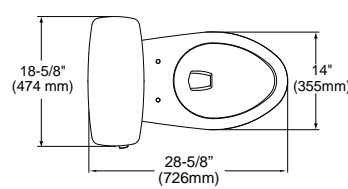
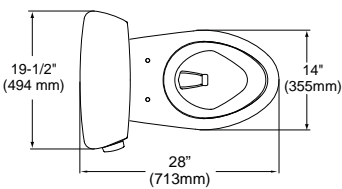

For more information on dimensions please refer to product spec sheet.

AVAILABLE COLORS



1.28 GPF TOILETS OVERVIEW

ENTRADA™
TWO-PIECE TOILET
1.28 GPF
CST244EF(R) (Elongated)



ENTRADA
TWO-PIECE TOILET
1.28 GPF
CST243EF(R) (Round)



- | | |
|--|---|
| <ul style="list-style-type: none"> ▶ E-Max flushing system, high-efficiency (1.28 GPF/4.8 lpf) ▶ Elongated bowl ▶ Universal Height ▶ ADA compliant ▶ Close coupled, elongated front bowl and tank set, less toilet seat ▶ Chrome trip lever ▶ Optional right-hand trip lever(R) ▶ 12" Rough-in | <ul style="list-style-type: none"> ▶ E-Max flushing system, high-efficiency (1.28 GPF/4.8 lpf) ▶ Rounded bowl ▶ Universal Height ▶ Close coupled, round front bowl and tank set, less toilet seat ▶ Chrome trip lever ▶ Optional right-hand trip lever(R) ▶ 12" Rough-in |
|--|---|

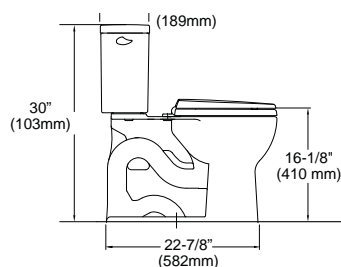
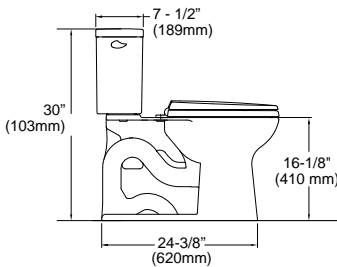
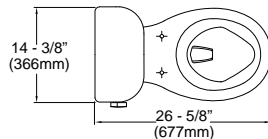
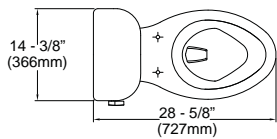

COMMERCIAL TOILETS

OVERVIEW

**COMMERCIAL FLUSHOMETER
HIGH-EFFICIENCY TOILET**
1.28 GPF
CT705EN(G)



**COMMERCIAL FLUSHOMETER
HIGH-EFFICIENCY TOILET**
1.28 GPF
CT705ELN(G)



**COMMERCIAL FLUSHOMETER
HIGH-EFFICIENCY
WALL-HUNG TOILET**
1.28 GPF
CT708E(G)



**COMMERCIAL FLUSHOMETER
HIGH-EFFICIENCY
WALL-HUNG TOILET**
1.28 GPF
CT708EV(G)



- ▶ Floor-mounted
- ▶ Elongated front bowl, less seat
- ▶ Optional CeFiONtect™ ceramic glaze (G) - CeFiONtect prevents debris, mold and bacteria from sticking to ceramic surfaces, leading to fewer chemicals and less water in cleaning
- ▶ 1-1/2" Inlet top spud
- ▶ 10"-12" rough-in
- ▶ For compatible flush valves, see page 16
- ▶ Available in cotton (#01) only

- ▶ Floor-mounted
- ▶ ADA compliant
- ▶ Elongated front bowl, less seat
- ▶ Optional CeFiONtect ceramic glaze(G) - CeFiONtect prevents debris, mold and bacteria from sticking to ceramic surfaces, leading to fewer chemicals and less water in cleaning
- ▶ 1-1/2" Inlet top spud
- ▶ 10"-12" rough-in
- ▶ For compatible flush valves, see page 16
- ▶ Available in cotton (#01) only

- ▶ Wall-mounted
- ▶ ADA compliant
- ▶ Elongated front bowl, less seat
- ▶ Optional CeFiONtect ceramic glaze (G) - CeFiONtect prevents debris, mold and bacteria from sticking to ceramic surfaces, leading to fewer chemicals and less water in cleaning
- ▶ 1-1/2" Inlet top spud
- ▶ For compatible flush valves, see page 16

- ▶ Wall-mounted
- ▶ ADA compliant
- ▶ Elongated front bowl, less seat
- ▶ Optional CeFiONtect ceramic glaze (G) - CeFiONtect prevents debris, mold and bacteria from sticking to ceramic surfaces, leading to fewer chemicals and less water in cleaning
- ▶ 1-1/2" Back spud inlet
- ▶ For compatible flush valves, see page 16

12" rough-in dimensions

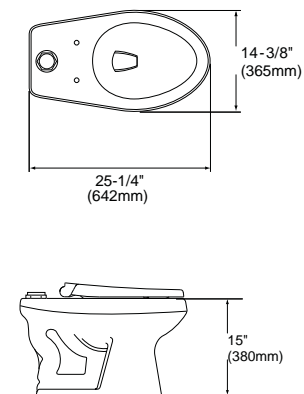

12" rough-in dimensions

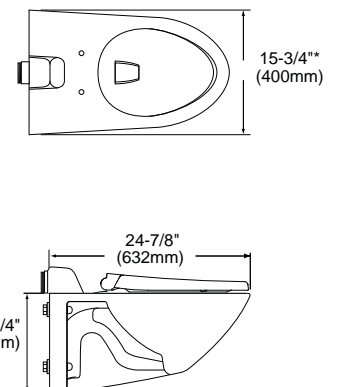
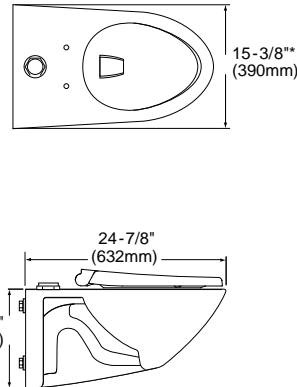
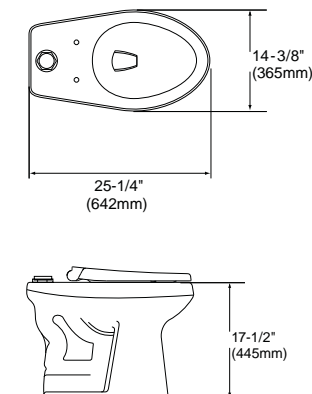

For more information on dimensions please refer to product spec sheet.

**AVAILABLE
COLORS**



TOILET SEATS OVERVIEW

COMMERCIAL
SEAT
SC534

COMMERCIAL
SEAT
SC134



- ▶ Elongated open front toilet seat
- ▶ Mounting hardware included
- ▶ Open front toilet seat and cover
- ▶ Mounting hardware included

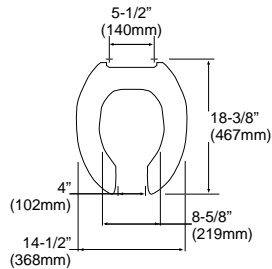
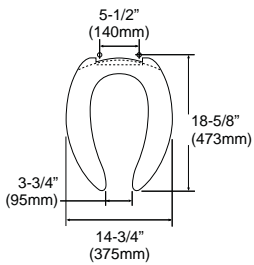

AVAILABLE
COLORS

#01
Cotton

For more information on dimensions please refer to product spec sheet.

TOILET FLUSH VALVES

OVERVIEW

ECOPOWER® HIGH-EFFICIENCY TOILET FLUSH VALVE

1.28 GPF

TET2LN31 / TET2LN32 / TET2LN33



CAL Green



- ▶ Hydropower self-generating system
- ▶ Electronic flush valve complete with 1" angle stop and 1-1/2" vacuum breaker set
- ▶ 1.28 GPF or less
- ▶ Back spud floor, top spud and back spud wall models - concealed 14" x 12" Cover plate, (see below)
- ▶ 24 hour automatic flush for trap seal protection
- ▶ For compatible toilets, see page 16

ECOPOWER HIGH-EFFICIENCY TOILET FLUSH VALVE

1.28 GPF

TET3LN31 / TET3LN32 / TET3LN33



CAL Green



- ▶ Hydropower self-generating system
- ▶ Electronic flush valve complete with 1" angle stop and 1-1/2" vacuum breaker set
- ▶ 1.28 GPF or less
- ▶ Back spud floor, top spud and back spud wall models - concealed 4" x 4" Cover plate, (see below)
- ▶ 24 hour automatic flush for trap seal protection
- ▶ For compatible toilets, see page 16

ECOPOWER HIGH-EFFICIENCY TOILET FLUSH VALVE

1.28 GPF

TET1LN32



CAL Green



- ▶ Hydropower self-generating system
- ▶ Electronic flush valve, neutral rough-in, complete with 1" angle stop and 1-1/2" vacuum breaker set
- ▶ 1.28 GPF or less
- ▶ Manual override button
- ▶ 24 hour automatic flush for trap seal protection
- ▶ For compatible toilets, see page 16

ECOPOWER HIGH-EFFICIENCY TOILET FLUSH VALVE

1.28 GPF FOR USE WITH 24" VACUUM BRAKERS

TET6LN32



CAL Green



- ▶ Hydropower self-generating system
- ▶ Electronic flush valve, neutral rough-in, complete with 1" angle stop and 1-1/2" vacuum breaker set
- ▶ For use with 24" vacuum breakers
- ▶ 1.28 GPF or less
- ▶ Manual override button
- ▶ 24 hour automatic flush for trap seal protection
- ▶ For compatible toilets, see page 16

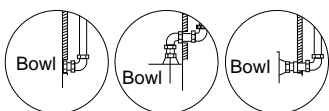
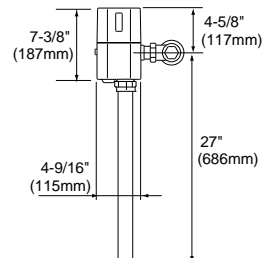
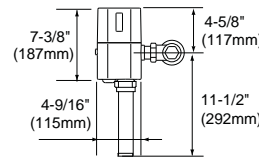
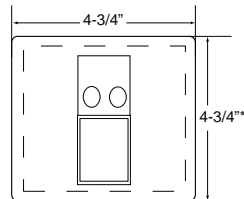
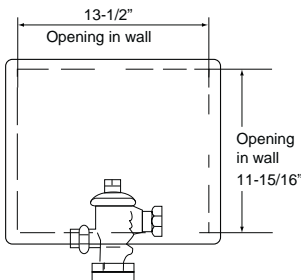

TET2LN31#SS Back Spud Wall Mount
TET2LN32#SS Top Spud
TET2LN33#SS Back Spud Floor Mount

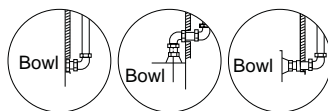

TET3LN31#SS Back Spud Wall Mount
TET3LN32#SS Top Spud
TET3LN33#SS Back Spud Floor Mount

TOILET FLUSH VALVES

OVERVIEW

MANUAL HIGH-EFFICIENCY TOILET FLUSH VALVE

1.28 GPF

TMT1LN32



CAL Green



- ▶ Manual operated, non-hold open, toilet flush valve complete with 1" angle stop and 1-1/2" vacuum breaker set
- ▶ Piston valve action with 1.28 GPF
- ▶ Left/right rough-in
- ▶ For compatible toilets, see page 16

ECOPOWER® TOILET FLUSH VALVE

1.6 GPF

TET2GN32 / TET2GN33 / TET2GN31



- ▶ Hydropower self-generating system
- ▶ Electronic flush valve complete with 1" angle stop and 1-1/2" vacuum breaker set
- ▶ 1.6 GPF or less
- ▶ Back spud floor, top spud and back spud wall models - concealed 14" x 12" cover plate, (see below)
- ▶ 24 hour automatic flush for trap seal protection
- ▶ For compatible toilets, see page 16

ECOPOWER TOILET FLUSH VALVE

1.6 GPF

TET3GN32 / TET3GN33 / TET3GN31



- ▶ Hydropower self-generating system
- ▶ Electronic flush valve complete with 1" angle stop and 1-1/2" vacuum breaker set
- ▶ 1.6 GPF or less
- ▶ Back spud floor, top spud and back spud wall models - concealed 4" x 4" Cover plate, (see below)
- ▶ 24 hour automatic flush for trap seal protection
- ▶ For compatible toilets, see page 16

ECOPOWER TOILET FLUSH VALVE

1.6 GPF

TET1GNC-32



- ▶ Hydropower self-generating system
- ▶ Electronic flush valve, neutral rough-in, complete with 1" angle stop and 1-1/2" vacuum breaker set
- ▶ 1.6 GPF or less
- ▶ Manual override button
- ▶ 24 hour automatic flush for trap seal protection
- ▶ For compatible toilets, see page 16

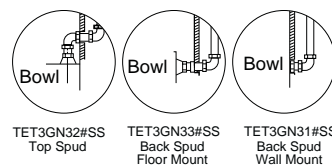
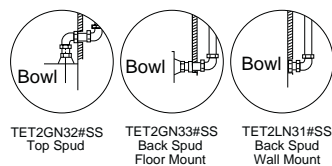
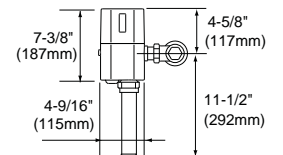
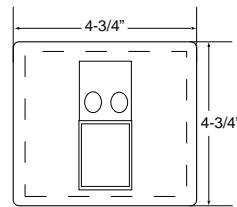
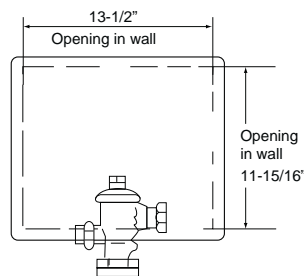

**ECOPOWER
TOILET FLUSH VALVE**
1.6 GPF FOR USE WITH
24" VACUUM BRAKERS
TET6GNC-32



**MANUAL
TOILET FLUSH VALVE**
1.6 GPF
TET1NNC-32



- ▶ Hydropower self-generating system
 - ▶ Electronic flush valve, neutral rough-in, complete with 1" angle stop and 1-1/2" vacuum breaker set
 - ▶ For use with 24" vacuum breakers
 - ▶ 1.6 GPF or less
 - ▶ Manual override button
 - ▶ 24 hour automatic flush for trap seal protection
 - ▶ For compatible toilets, see page 16
- ▶ Manual operated, non-hold open, toilet flush valve complete with 1" angle stop and 1-1/2" vacuum breaker set
 - ▶ Piston valve action with 1.6 GPF
 - ▶ Left/right rough-in
 - ▶ For compatible toilets, see page 16

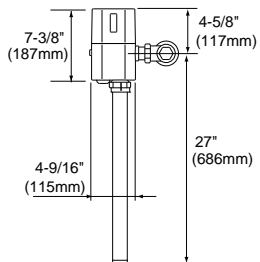

URINAL FLUSH VALVE COMPATIBILITY CHART

				FLUSHOMETER				
				EcoPower			MANUAL	
				0.125 GPF	0.5 GPF	1.0 GPF	0.5 GPF	1.0 GPF
URINAL	PRODUCT	SKU#						
	Full Size Top Spud	UT445U	Exposed	TEU1UN12#CP				
	Full Size Back Spud	UT445UV	Concealed	TEU2UN11SS				
				TEU3UN11#SS				
	Compact Top Spud	UT105U(G)	Exposed	TEU1UN12#CP				
	Compact Back Spud	UT105UV(G)	Concealed	TEU2UN113#SS				
				TEU3UN113#SS				
	Full Size Top Spud	UT447E	Exposed		TEU1LN12#CP	TEU1GNC-12	TMU1LN12#CP	TMU1NNC-12
							TMU1LN22#CP	TMU1NNC-22
	Full Size Back Spud	UT447EV	Concealed		TEU2LN11#SS			
				TEU3LN11#SS				
Compact Top Spud	UT104E	Exposed		TEU1LN12#CP	TEU1GNC-12	TMU1LN12#CP	TMU1NNC-12	
						TMU1LN22#CP	TMU1NNC-22	
Compact Back Spud	UT104EV	Concealed		TEU2LN11#SS				
				TEU3LN11#SS				

COMMERCIAL URINALS OVERVIEW

**WASHOUT ULTRA
HIGH-EFFICIENCY URINAL**
0.125 GPF
UT445U



**WASHOUT ULTRA HIGH-
EFFICIENCY URINAL**
0.125 GPF
UT445UV



**WASHOUT ULTRA HIGH-
EFFICIENCY URINAL**
0.125 GPF
UT105U(G)



**WASHOUT ULTRA HIGH-
EFFICIENCY URINAL**
0.125 GPF
UT105UV(G)



- ▶ Full size urinal with integral trap
- ▶ Washout flush action with 3/4" top spud inlet
- ▶ 0.125 GPF
- ▶ Complete with low profile dome strainer
- ▶ For compatible flush valves, see page 26

- ▶ Full size urinal with concealed integral trap
- ▶ Washout flush action with 3/4" back spud inlet
- ▶ 0.125 GPF
- ▶ Complete with low profile dome strainer
- ▶ For compatible flush valves, see page 26

- ▶ Compact urinal with integral trap
- ▶ Washout flush action with 3/4" top spud inlet
- ▶ Complete with low profile dome strainer
- ▶ Optional CeFiONtect™ ceramic glaze(G) - CeFiONtect glaze prevents debris and mold from sticking to ceramic surfaces, leading to fewer chemicals
- ▶ For compatible flush valves, see page 26

- ▶ Compact urinal with concealed integral trap
- ▶ Washout flush action with 3/4" back spud inlet
- ▶ Complete with low profile dome strainer
- ▶ Optional CeFiONtect ceramic glaze(G) - CeFiONtect glaze prevents debris and mold from sticking to ceramic surfaces, leading to fewer chemicals
- ▶ For compatible flush valves, see page 26

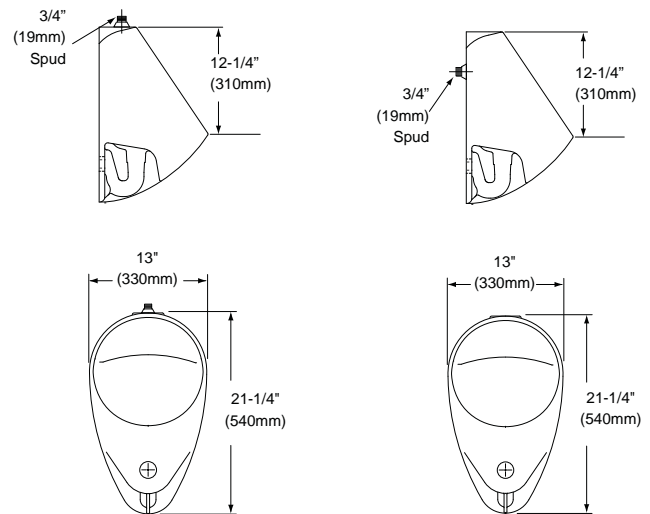
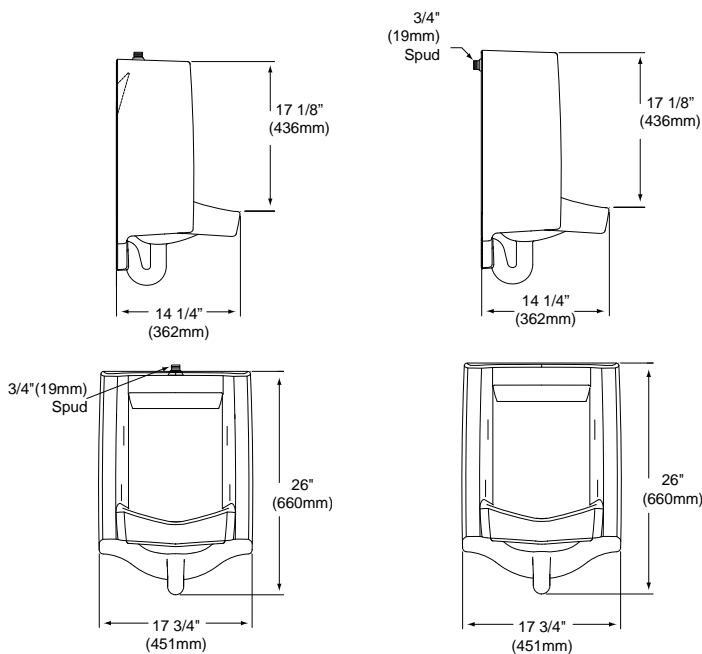

For more information on dimensions please refer to product spec sheet.

**AVAILABLE
COLORS**



COMMERCIAL URINALS

OVERVIEW

WASHOUT HIGH-EFFICIENCY URINAL
0.5 GPF
 UT447E

WASHOUT HIGH-EFFICIENCY URINAL
0.5 GPF
 UT447EV

WASHOUT HIGH-EFFICIENCY URINAL
0.5 GPF
 UT104E

WASHOUT HIGH-EFFICIENCY URINAL
0.5 GPF
 UT104EV



- ▶ Full size urinal with concealed integral trap
- ▶ Washout flush action with 3/4" top spud inlet
- ▶ 0.5 GPF
- ▶ For compatible flush valves, see page 26

- ▶ Full size urinal with concealed integral trap
- ▶ Washout flush action with 3/4" back spud inlet
- ▶ 0.5 GPF
- ▶ For compatible flush valves, see page 26

- ▶ Compact urinal with concealed integral trap
- ▶ Washout flush action with 3/4" top spud inlet, 0.5 GPF
- ▶ For compatible flush valves, see page 26

- ▶ Compact urinal with concealed integral trap
- ▶ Washout flush action with 3/4" back spud inlet, 0.5 GPF
- ▶ For compatible flush valves, see page 26

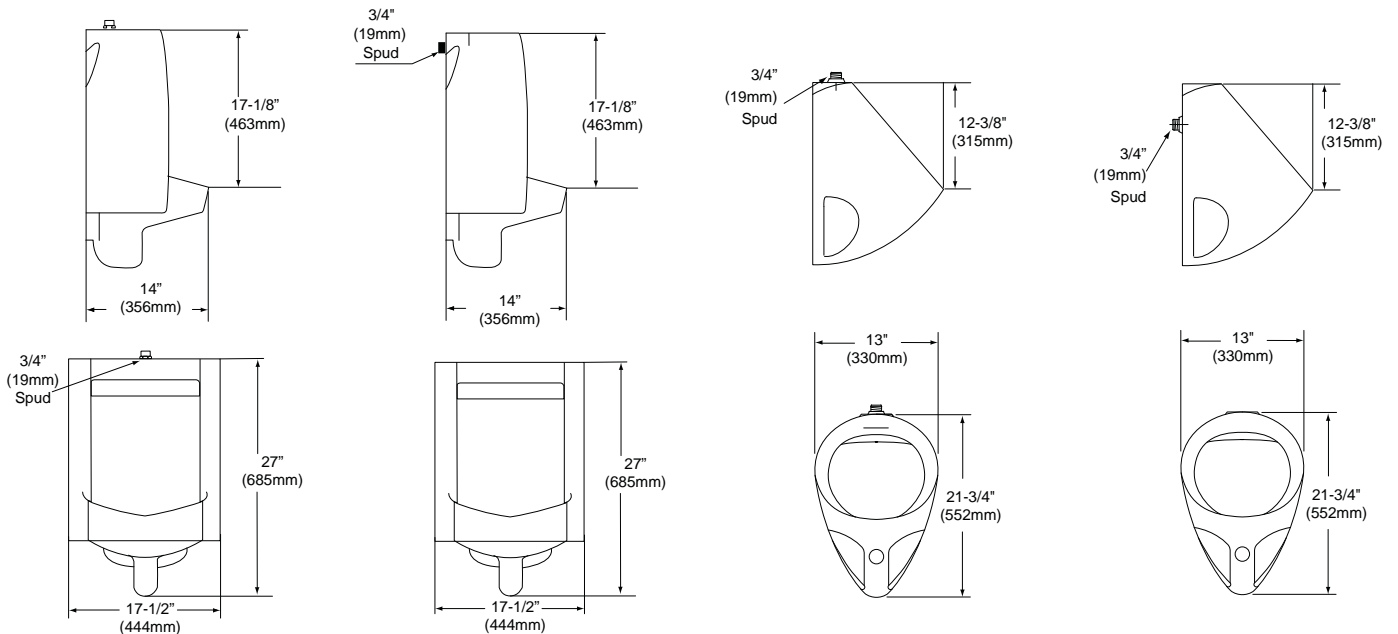

AVAILABLE COLORS



For more information on dimensions please refer to product spec sheet.

URINAL FLUSH VALVES

OVERVIEW

ECOPOWER® ULTRA
HIGH-EFFICIENCY URINAL
FLUSH VALVE
0.125 GPF
 TEU2UN11



ECOPOWER ULTRA
HIGH-EFFICIENCY URINAL
FLUSH VALVE
0.125 GPF
 TEU3UN11



ECOPOWER ULTRA
HIGH-EFFICIENCY URINAL
FLUSH VALVE
0.125 GPF
 TEU1UN12



- ▶ Hydropower self-generating system
 - ▶ Electronic flush valve complete with 3/4" angle stop and 3/4" vacuum breaker set
 - ▶ 0.125 GPF or less
 - ▶ Back spud - concealed 14" x 12" cover plate
 - ▶ 12 hour automatic flush for trap seal protection
 - ▶ For compatible urinals, see page 26
- ▶ Hydropower self-generating system
 - ▶ Electronic flush valve complete with 3/4" angle stop and 3/4" vacuum breaker set
 - ▶ 0.125 GPF or less
 - ▶ Back spud - concealed 4" x 4" cover plate
 - ▶ 12 hour automatic flush for trap seal protection
 - ▶ For compatible urinals, see page 26
- ▶ Hydropower self-generating system
 - ▶ Electronic flush valve, neutral rough-in, complete with 3/4" angle stop and 3/4" vacuum breaker set
 - ▶ 0.125 GPF or less
 - ▶ Manual override button
 - ▶ 12 hour automatic flush for trap seal protection
 - ▶ For compatible urinals, see page 26

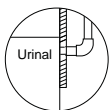
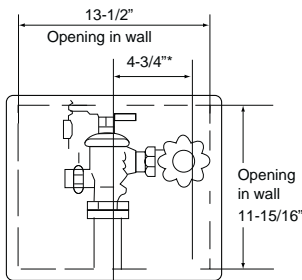

TEU2UN#SS
Back Spud

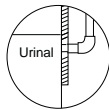
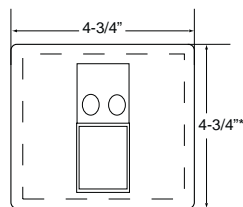

TEU3UN#SS
Back Spud

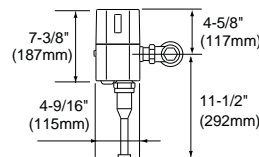

URINAL FLUSH VALVES

OVERVIEW

ECOPOWER HIGH-EFFICIENCY URINAL FLUSH VALVE
0.5 GPF
 TEU2LN11 / TEU2LN21

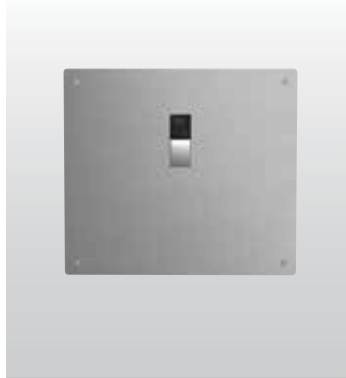

ECOPOWER® HIGH-EFFICIENCY URINAL FLUSH VALVE
0.5 GPF
 TEU3LN11 / TEU3LN21



ECOPOWER HIGH-EFFICIENCY URINAL FLUSH VALVE
0.5 GPF
 TEU1LN12 / TEU1LN22



MANUAL HIGH-EFFICIENCY URINAL FLUSH VALVE
0.5 GPF
 TMU1LN12 / TMU1LN22



- ▶ Hydropower self-generating system
- ▶ Electronic flush valve complete with 3/4" angle stop and 1-1/4" or 3/4" vacuum breaker set(see below)
- ▶ 0.5 GPF or less
- ▶ Back spud - concealed 14" x 12" cover plate
- ▶ 12 hour automatic flush for trap seal protection
- ▶ For compatible urinals, see page 26

- ▶ Hydropower self-generating system
- ▶ Electronic flush valve complete with 3/4" angle stop and 1-1/4" or 3/4" vacuum breaker set (see below)
- ▶ 0.5 GPF or less
- ▶ Back spud - concealed 4" x 4" cover plate
- ▶ 12 hour automatic flush for trap seal protection
- ▶ For compatible urinals, see page 26

- ▶ Hydropower self-generating system
- ▶ Electronic flush valve, neutral rough-in, complete with 3/4" angle stop and 1-1/4" or 3/4" vacuum breaker set
- ▶ 0.5 GPF or less
- ▶ Manual override button
- ▶ 12 hour automatic flush for trap seal protection
- ▶ For compatible urinals, see page 26

- ▶ Manual operated, non-hold open, urinal flush valve complete with 3/4" angle stop and 3/4" or 1-1/4" vacuum breaker set
- ▶ Piston valve action with 0.5 GPF
- ▶ Left/right rough-in
- ▶ For compatible urinals, see page 26

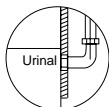
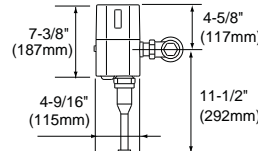
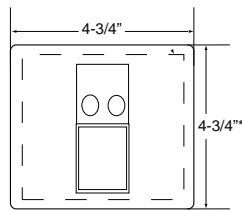
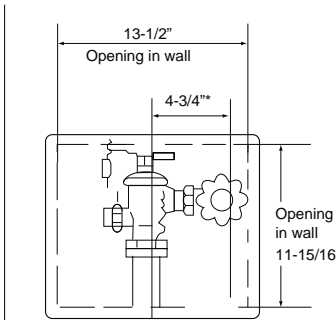

TEU2LN#SS
 Back Spud
 1-1/4"

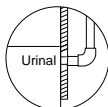

TEU2UL#SS
 Back Spud
 3/4"

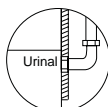

TEU3LN#SS
 Back Spud
 1-1/4"

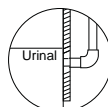

TEU3UL#SS
 Back Spud
 3/4"

**ECOPOWER URINAL
FLUSH VALVE**
1.0 GPF

TEU1GNC-12 / TEU1GNC-22



**MANUAL URINAL
FLUSH VALVE**
1.0 GPF

TMU1NNC-12 / TMU1NNC-22



- ▶ Hydropower self-generating system
- ▶ Electronic flush valve, neutral rough-in, complete with 3/4" angle stop and 1-1/4" or 3/4" vacuum breaker set
- ▶ 1.0 GPF or less
- ▶ Manual override button
- ▶ 24 hour automatic flush for trap seal protection
- ▶ For compatible urinals, see page 26

- ▶ Manual operated, non-hold open, urinal flush valve complete with 3/4" angle stop and 3/4" or 1-1/4" vacuum breaker set
- ▶ Piston valve action with 1.0 GPF
- ▶ Left/right rough-in
- ▶ For compatible urinals, see page 26

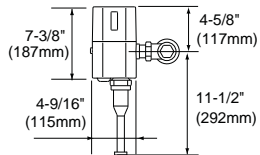



Products shown: Atherton™ Lavatory and
Axiom® EcoPower® Faucet

COMMERCIAL LAVATORIES

Innovation & Technology Highlights

TOTO lavatories deliver the ideal combination of design and functionality. Available in a variety of styles from undercounter to self-rimming, our lavatories offer comfortable use for everyone, regardless of age or physical ability. They're the perfect choice for any commercial space, from hotels to public facilities.



**ADA
COMPLIANT**

The American Disability Act (ADA) was enacted in 1990 to establish design codes to serve people of all ages and abilities. A core principle behind TOTO Total Design, ADA standards consider the needs of everyone, no matter their needs, without additional adaptation or specialization, optimizing the bathroom experience for all generations.



VESSEL LAVATORIES OVERVIEW

LUMINIST®
LIGHT ROUND VESSEL
LAVATORY
LLT152#63-BL

LUMINIST
LIGHT ROUND VESSEL
LAVATORY
LLT152#63-WH

LUMINIST
RECTANGLE VESSEL
LAVATORY
LLT151

LUMINIST
ROUND VESSEL
LAVATORY
LLT150



- ▶ ø15-5/8" Dia. H 2-3/8"
- ▶ Basin ø14" Dia.
- ▶ Luminist is a semi-clear epoxy resin that displays exceptional strength and is highly scratch and impact resistant
- ▶ LED lighting system
- ▶ Without overflow
- ▶ Complete with installation template, hardware and chrome drain fitting

- ▶ ø15-5/8" Dia. H 2-3/8"
- ▶ Basin ø14" Dia.
- ▶ Luminist is a semi-clear epoxy resin that displays exceptional strength and is highly scratch and impact resistant
- ▶ LED lighting system
- ▶ Without overflow
- ▶ Complete with installation template, hardware and chrome drain fitting

- ▶ W 19-11/16" x D 12-5/8" x H 3-9/16"
- ▶ Basin W 17-7/8" x D 10-13/16"
- ▶ Luminist is a semi-clear epoxy resin that displays exceptional strength and is highly scratch and impact resistant
- ▶ Without overflow
- ▶ Complete with installation template, hardware and chrome drain fitting

- ▶ ø15-3/4" Dia. H 3-9/16"
- ▶ Basin ø14-7/8" Dia.
- ▶ Luminist is a semi-clear epoxy resin that displays exceptional strength and is highly scratch and impact resistant
- ▶ Without overflow
- ▶ Complete with installation template, hardware and chrome drain fitting

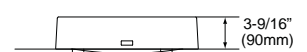
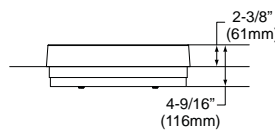
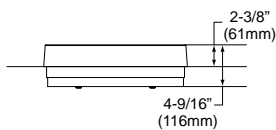
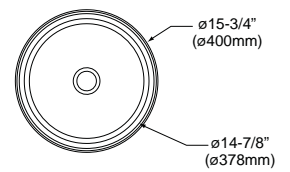
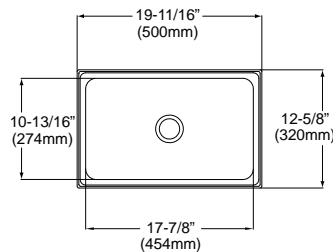
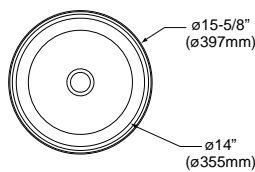
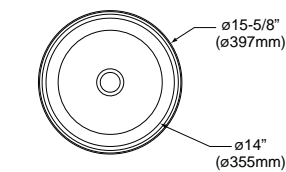

**AVAILABLE
COLORS**



For more information on dimensions please refer to product spec sheet.

SELF-RIMMING LAVATORIES

OVERVIEW

SELF-RIMMING LAVATORY
LT540

SELF-RIMMING LAVATORY
LT402

SELF-RIMMING LAVATORY
LT501

SELF-RIMMING LAVATORY
LT502



- ▶ 17-3/4" x 20-3/4"
- ▶ Oval Self-rimming Lavatory
- ▶ ADA compliant
- ▶ Available in cotton (#01) only
- ▶ Vitreous china
- ▶ Complete with installation template and sealing compound
- ▶ Concealed front overflow
- ▶ Faucet not included

- ▶ 19-1/2" diameter
- ▶ Round Self-rimming Lavatory
- ▶ ADA compliant
- ▶ Available in cotton (#01) only
- ▶ Vitreous china
- ▶ Complete with installation template and sealing compound
- ▶ Concealed front overflow
- ▶ Faucet not included

- ▶ 20" x 17"
- ▶ Oval Self-rimming Lavatory
- ▶ ADA compliant
- ▶ Vitreous china
- ▶ Concealed front overflow
- ▶ Complete with installation template and sealing compound
- ▶ Faucet not included

- ▶ 19" diameter
- ▶ Round Self-rimming Lavatory
- ▶ ADA compliant
- ▶ Vitreous china
- ▶ Concealed front overflow
- ▶ Complete with installation template and sealing compound
- ▶ Faucet not included

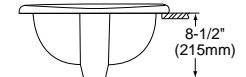
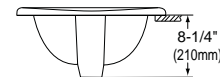
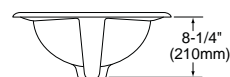
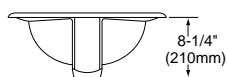
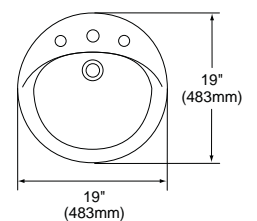
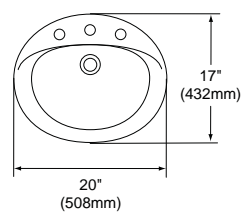
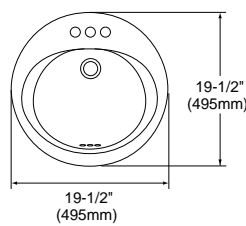
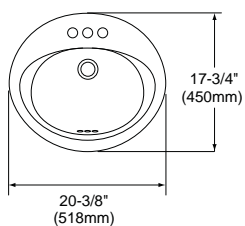

SELF-RIMMING LAVATORIES

CONT. OVERVIEW

VERNICA® SELF-RIMMING
LAVATORY
LT155



- ▶ 20" x 18"
- ▶ Rear overflow
- ▶ Fired clay
- ▶ ADA compliant
- ▶ Complete with installation template

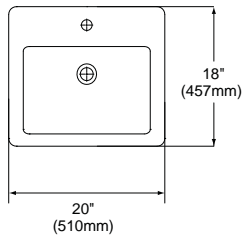

UNDERCOUNTER LAVATORIES

OVERVIEW

ATHERTON™
UNDERCOUNTER LAVATORY
LT221

ATHERTON
UNDERCOUNTER LAVATORY
LT231

ATHERTON
UNDERCOUNTER LAVATORY
LT233

UNDERCOUNTER
LAVATORY
LT569



- ▶ 17" x 13"
- ▶ Rectangular Undercounter Lavatory
- ▶ ADA compliant
- ▶ Vitreous china
- ▶ Mounting assembly complete with installation template and mounting screw set
- ▶ Front overflow
- ▶ Available in cotton (#01) only

- ▶ 17" x 14"
- ▶ Oval Undercounter Lavatory
- ▶ ADA compliant
- ▶ Vitreous china
- ▶ Mounting assembly complete with installation template and mounting screw set
- ▶ Front overflow
- ▶ Available in cotton (#01) only

- ▶ 19" x 15"
- ▶ Oval Undercounter Lavatory
- ▶ ADA compliant
- ▶ Vitreous china
- ▶ Mounting assembly complete with installation template and mounting screw set
- ▶ Front overflow
- ▶ Available in cotton (#01) only

- ▶ 17" x 14"
- ▶ Oval Undercounter Lavatory
- ▶ ADA compliant
- ▶ Vitreous china
- ▶ Concealed front overflow
- ▶ Mounting assembly complete with installation template, mounting screw set

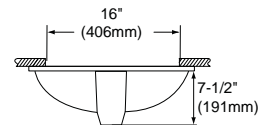
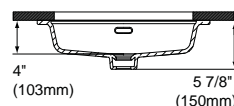
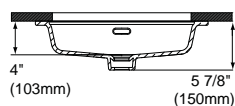
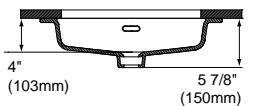
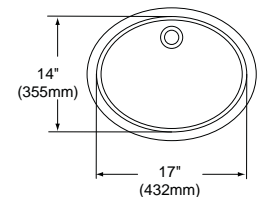
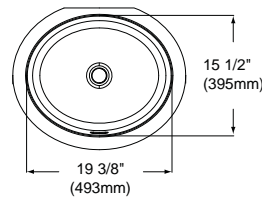
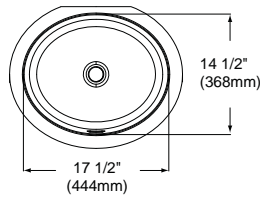
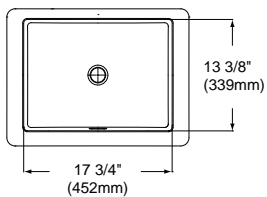

For more information on dimensions please refer to product spec sheet.

AVAILABLE
COLORS

- #01 Cotton
- #12 Sedona Beige
- #03 Bone

UNDERCOUNTER LAVATORIES

CONT. OVERVIEW

UNDERCOUNTER LAVATORY
LT587

RECTANGLE UNDERCOUNTER LAVATORY
LT540G

RECTANGLE UNDERCOUNTER LAVATORY
LT542G

RECTANGLE UNDERCOUNTER LAVATORY
LT191(G)



- ▶ 19" x 15"
- ▶ Oval Undercounter Lavatory
- ▶ ADA compliant
- ▶ Vitreous china
- ▶ Concealed front overflow
- ▶ Mounting assembly complete with installation template, mounting screw set
- ▶ Available in cotton (#01), sedona beige (#12) and bone (#03) only

- ▶ 21-1/4" x 14-3/8"
- ▶ CeFiONtect™ ceramic glaze
- ▶ Front overflow
- ▶ Mounting assembly complete with installation template and mounting screw set
- ▶ Available in cotton (#01) and sedona beige (#12) only

- ▶ 19" x 12-3/8"
- ▶ CeFiONtect ceramic glaze
- ▶ Front overflow
- ▶ Mounting assembly complete with installation template and mounting screw set
- ▶ Available in cotton (#01) and sedona beige (#12) only

- ▶ 20-1/2" x 12-3/8"
- ▶ Rear overflow
- ▶ Optional CeFiONtect ceramic glaze
- ▶ Vitreous china
- ▶ Mounting assembly complete with installation template and mounting screw set

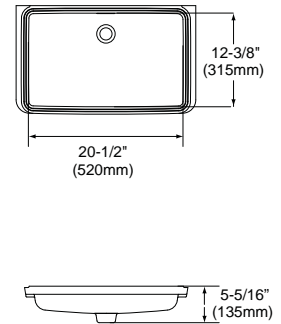
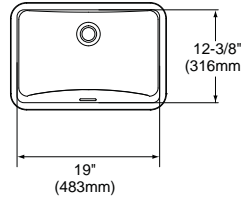
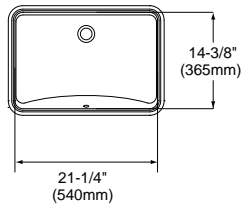
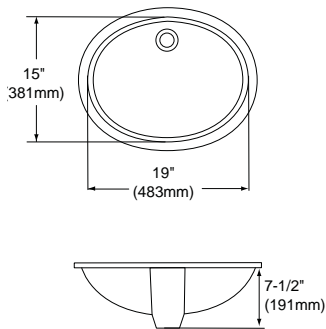

AVAILABLE COLORS



For more information on dimensions please refer to product spec sheet.

WHEELCHAIR USER'S LAVATORIES

OVERVIEW

UNDERCOUNTER LAVATORY
LT156

WALL-HUNG LAVATORY
LT307

UNDERCOUNTER LAVATORY
LT308



- ▶ 19-3/4" x 13"
- ▶ Rear overflow
- ▶ Fired clay
- ▶ Mounting assembly complete with installation template and mounting screw set
- ▶ Available in cotton (#01) only

- ▶ 21" x 18-1/4" lavatory with back splash
- ▶ ADA compliant
- ▶ Vitreous china
- ▶ Punching for concealed arm carrier
- ▶ Wall support concealed arms not supplied by TOTO
- ▶ Includes wall hanger
- ▶ Soap dispenser hole optional
- ▶ Faucet and soap dispenser not included

- ▶ 20-1/2" x 27"
- ▶ ADA compliant
- ▶ Vitreous china
- ▶ Punching for concealed arm carrier
- ▶ Wall support concealed arms not supplied by TOTO
- ▶ No hardware included
- ▶ Faucet not included

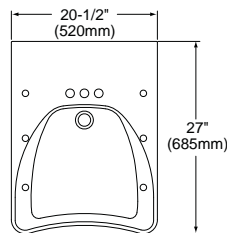
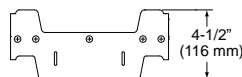
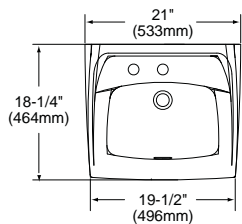
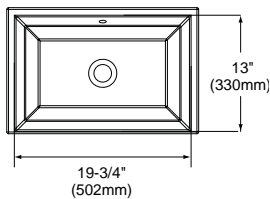

For more information on dimensions please refer to product spec sheet.

AVAILABLE COLORS





Product shown: TOTO Standard Soap Dispenser

COMMERCIAL SOAP DISPENSERS

Innovation Highlights

THE TOTO ADVANTAGE

TOTO's soap dispensers offer automatic, touchless operation for a more hygienic and comfortable experience. Designed for high-traffic commercial spaces, our soap dispensers are available in industry-standard polished chrome, and for more decorative installations, brushed and polished nickel finishes.

- ▶ Made from durable material for heavy use in commercial applications
- ▶ Biodegradable, Green Seal™ certified soap available
- ▶ Foaming soap for efficient cleansing*
- ▶ Auto-purge cycle to prevent soap from clogging the spout
- ▶ Micro-sensor under the spout for accurate hand detection*
- ▶ Low soap indicator
- ▶ Low battery indicator*
- ▶ Easy-to-refill soap reservoir

**Function available on specific models.*

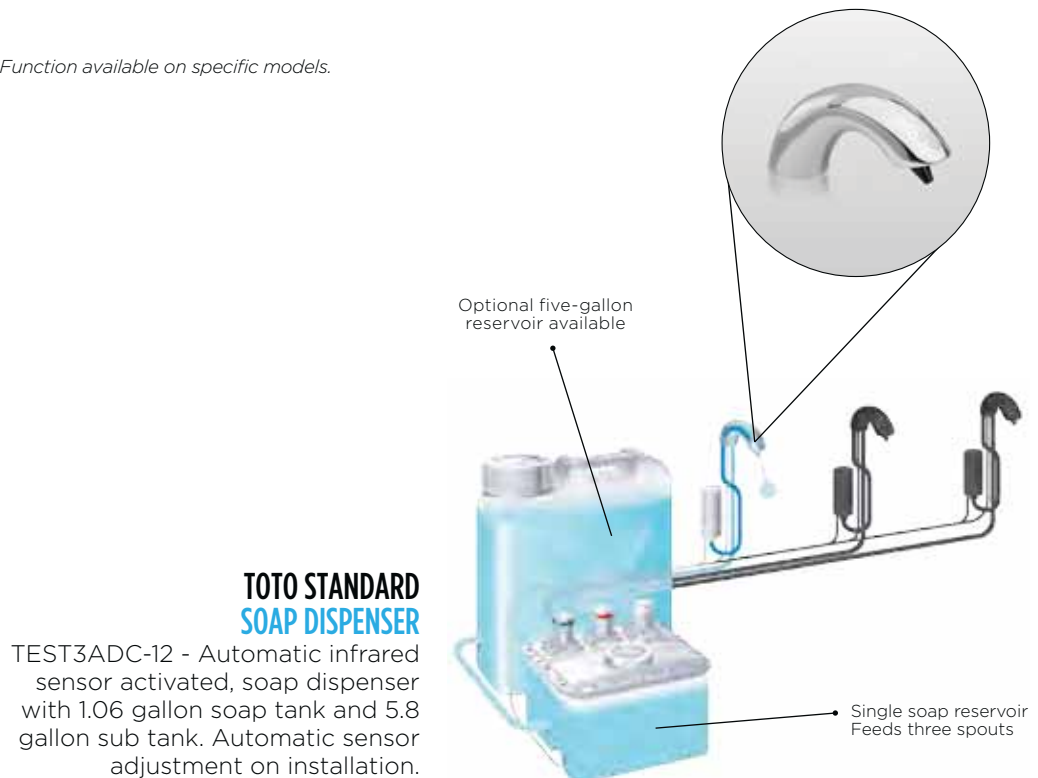

TOTO STANDARD SOAP DISPENSER

TEST3ADC-12 - Automatic infrared sensor activated, soap dispenser with 1.06 gallon soap tank and 5.8 gallon sub tank. Automatic sensor adjustment on installation.

SENSOR OPERATED SOAP DISPENSER & TOTO SOAP

OVERVIEW

SENSOR OPERATED SOAP DISPENSER
TES1ADC



SENSOR OPERATED SOAP DISPENSER
TES100AA
TES100DA



TOTO® SOAP 1 GALLON PACKAGE OF 4, 1 GAL. EACH
TSFB1

TOTO SOAP 5 GALLON PACKAGE AS 1, 5 GAL. CONTAINER
TSFB5

MULTI-UNIT SYSTEM



NEW

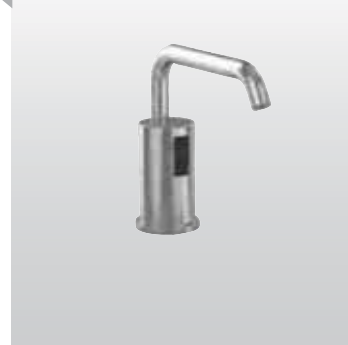

- ▶ Sensor operated foaming soap dispenser
- ▶ Self-adjusting sensor spout with base unit, mounted hardware and supply lines
- ▶ Chrome plated
- ▶ Single-hole mount
- ▶ Multiple unit configurations available*
- ▶ Required to use TOTO Soap

- ▶ Sensor operated soap dispenser
- ▶ Sleek and compact modern design
- ▶ Solid brass spout and body
- ▶ Removable Soap Tank for easy access and effortless soap refill
- ▶ Vandal resistant spout
- ▶ Two power options: AC or DC
- ▶ Available in polished chrome (#CP) only

- ▶ Specially formulated antibacterial soap
- ▶ Approved by the FDA for use in Class I & Class II hospital applications
- ▶ Warranty requires use of TOTO soap with dispenser

- ▶ Specially formulated antibacterial soap
- ▶ Approved by the FDA for use in Class I & Class II hospital applications
- ▶ Warranty requires use of TOTO soap with dispenser

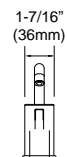
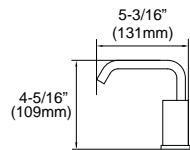
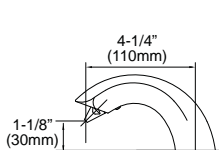

AVAILABLE FINISHES

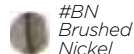

* Refer to TOTO specification sheet for more details
For more information on dimensions please refer to product spec sheet.

TOTO® SOAP 55 GALLONS
PACKAGED AS 1, 55 GAL.
DRUM
 TSFB55

TOTO SCENTED SOAP
1 GALLON
GREEN SEAL™ CERTIFIED
PACKAGE OF 4, 1 GAL. EACH
 TSFB1-GS

TOTO SCENTED SOAP
5 GALLON
GREEN SEAL CERTIFIED
PACKAGE AS 1, 5 GAL.
CONTAINER
 TSFB5-GS



- ▶ Specially formulated antibacterial soap
- ▶ Approved by the FDA for use in Class I & Class II hospital applications
- ▶ Warranty requires use of TOTO soap with dispenser

- ▶ Green Seal GS-41 certified
- ▶ No triclosan
- ▶ Biodegradable
- ▶ Helps qualify for LEED credits

- ▶ Green Seal GS-41 certified
- ▶ No triclosan
- ▶ Biodegradable
- ▶ Helps qualify for LEED credits



Product shown: HDR120#WH Clean Dry® Hand Dryer

COMMERCIAL CLEAN DRY® HAND DRYERS

Innovation & Technology Highlights

TOTO's Clean Dry hand dryers offer high-speed air for an effective, economical solution. Infrared sensor-operated, Clean Dry offers innovative air wicking technology that dries the user's hands in under 12 seconds.



TOTO COMMERCIAL PERFORMANCE

Clean Dry hand dryers reduce energy use by 25 percent over traditional electronic hand dryers that sometimes fail to dry hands completely. Further, Clean Dry dryers are extremely quiet during operation with a low decibel rating between 55 and 62 dB

DECIBEL RATING

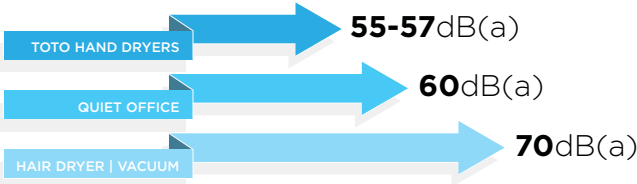

TOTO HAND DRYER BENEFITS

- ▶ Unobtrusive designs that blend into any bathroom décor
- ▶ Environmentally friendly - no paper waste
- ▶ Eliminates the cost of providing paper towels, including the man-power needed to restock paper and discard trash
- ▶ Double-sided fan simultaneously dries hands from both sides, greatly reducing drying time*
- ▶ Washable trays to eliminate water splashing and prevent slip and fall accidents
- ▶ Vandal resistant designs

TOTO HAND DRYERS HELP THE ENVIRONMENT



*Function available on specific models.

COMMERCIAL HAND DRYERS OVERVIEW

**CLEAN DRY®
HIGH SPEED HAND DRYER**
HDR130#SV

**CLEAN DRY
HIGH SPEED HAND DRYER**
HDR101#WH

**CLEAN DRY®
HIGH SPEED HAND DRYER**
HDR120#WH

**CLEAN DRY
HIGH SPEED HAND DRYER**
HDR111#SS



- ▶ High speed hand dryer
- ▶ Hygienic, touch-free operation
- ▶ Durable aluminium construction
- ▶ Low Operating noise 55dB(A)
- ▶ Energy Efficient 390 watts
- ▶ AC powered
- ▶ Available in silver (#SV)

- ▶ High speed hand dryer
- ▶ Hygienic, touch-free operation
- ▶ Splash resistant
- ▶ Water tray to prevent slip and fall
- ▶ Space saving, compact design
- ▶ Low Operating noise 57dB(A)
- ▶ Energy Efficient 390 watts
- ▶ AC powered
- ▶ Available in white (#WH)

- ▶ Hygienic sensor-activated hand dryer
- ▶ Double-sided blowers for faster dry time
- ▶ Sleek and compact design
- ▶ 208 mph of air speed
- ▶ Side panels and water tray to prevent water from trickling to the floor
- ▶ Low operating noise 57dB(A)
- ▶ Energy efficient
- ▶ Available in white (#WH)

- ▶ High speed hand dryer
- ▶ Hygienic, touch-free operation
- ▶ Splash resistant
- ▶ Space saving, in-wall design
- ▶ Vandal proof water tray
- ▶ Low Operating noise 56dB(A)
- ▶ Energy Efficient 390 watts
- ▶ AC powered
- ▶ Stainless Steel Cover
- ▶ Flush mount
- ▶ ADA compliant
- ▶ Available in stainless steel (#SS)

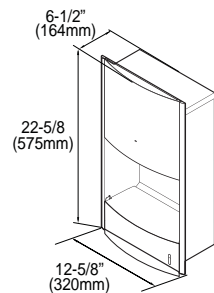
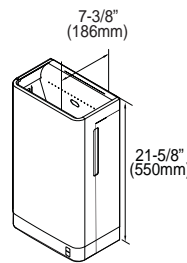
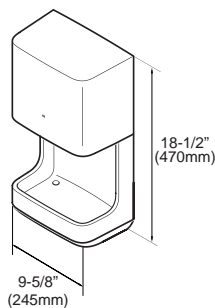
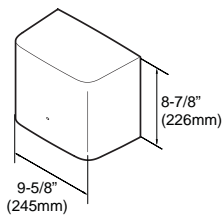

**AVAILABLE
FINISHES**



For more information on dimensions please refer to product spec sheet.

COLORS AND FINISHES

CHINA COLORS

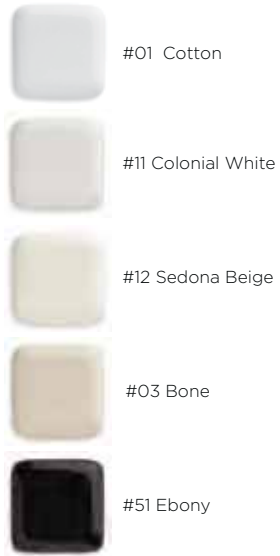

BRASS FINISHES



HAND DRYER COLORS



TECHNOLOGY GUIDE

TECHNOLOGY ICONS



ECOPOWER®



SMA THERMOSTATIC VALVE TECHNOLOGY



AUTO FUNCTIONS



1.0 GPF GRAVITY BASED FLUSHING SYSTEM



TORNADO FLUSH™ SYSTEM



E-MAX® FLUSHING SYSTEM



CEFIONTECT™ GLAZE



UNIVERSAL HEIGHT



SKIRTED DESIGN



ADA COMPLIANT



WATERSENSE



Meets CEC Water Regulations - Effective 2016