

WALL TERMINATION ANGLE/UNIVERSAL BLIND END

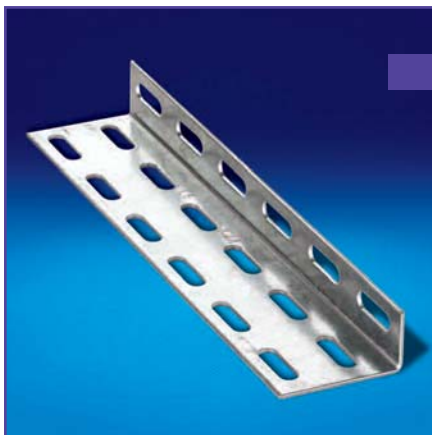

Dimensions

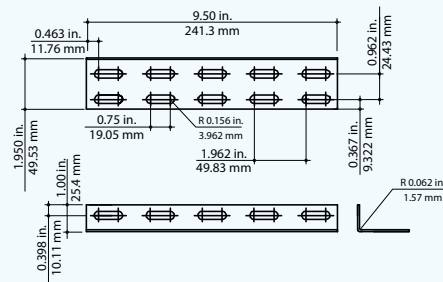

Support and terminate runs of cable tray with this wall termination angle. Can be used as a wall support, floor to ceiling support or to safely terminate any tray run. Adapts to any configuration and any width. Available in pre-galvanized steel. Mounting hardware sold separately.

EXPRESS TIP

Refer to page 58 for an application example.



Tool required: 10mm nut driver

Material	Catalogue number	Weight	
		lb/ea.	kg/ea.
Pre-galvanized Steel	ETA-WTA-PG	0.36	0.17

90 DEGREE BRACKET



Dimensions

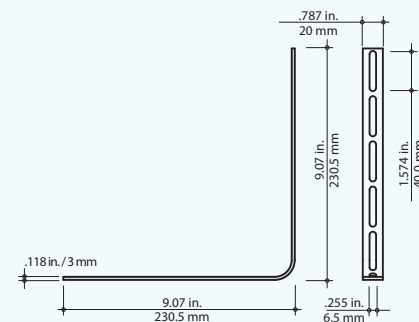

Create high strength tee, cross and other 90 degree configurations with this 90 degree bracket. Available in hot-dipped galvanized steel either as a single bracket or a kit including one (1) bracket, four (4) bracket clamps and one (1) hot-dipped galvanized universal splice.

EXPRESS TIP

Refer to page 49 for an application example.



Tool required: 10mm nut driver

Description	Catalogue number	Weight	
		lb/ea.	kg/ea.
Single 90 Degree Bracket	ETA-H90-HD	0.62	0.28
90 Degree Bracket Kit*	ETA-H90KIT-HD	0.69	0.31

* Kit includes — 1 90° bracket (ETA-H90-HD), 4 bracket clamps (ETH-WBC-HD) and 1 universal splice (ETH-SP-HD).



CABLE DROP-OUT



Dimensions

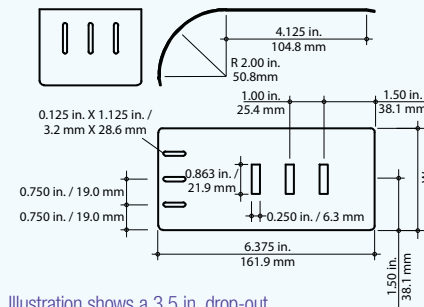

Illustration shows a 3.5 in. drop-out.

This 2 in. radius cable drop-out protects cables when exiting or entering tray by reducing the strain on the cables. The drop-out attaches to tray with built-in tabs. No hardware is required. Three different widths available in pre-galvanized steel. This drop-out is suitable for use with all tray widths and heights.

EXPRESS TIP

Refer to page 50 for application examples.

Width (W)		Catalogue number	Weight	
in.	mm		lb/ea.	kg/ea.
1.75	45	ETA-CDOU17-PG	0.16	0.07
3.50	90	ETA-CDOU35-PG	0.31	0.14
5.25	135	ETA-CDOU52-PG	0.49	0.22

LARGE CABLE DROP-OUT



Dimensions

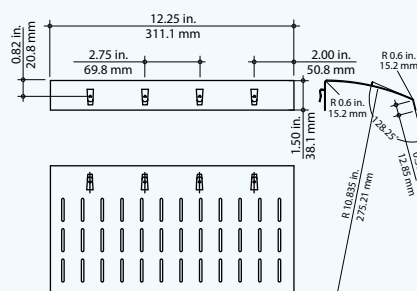

For larger cable tray widths and heavier cable loading, use the 7 in. radius large cable drop-out to protect cable exiting or entering tray runs. Available in pre-galvanized steel, the large cable drop-out has a versatile slotted design that enables the use of Ty-Rap® cable ties or Ty-Grip™ fasteners to attach the cable bundles to the drop-out.

Use built-in tabs to attach to siderails or universal clamp (see page 32) to attach to the end of cable runs.

EXPRESS TIP

Refer to page 50 for an application example.

Material	Catalogue number	Weight	
Pre-galvanized Steel	ETA-CDOUL-PG	lb/ea.	kg/ea.
		0.90	0.40

SIDE HANGER CLAMP



Dimensions

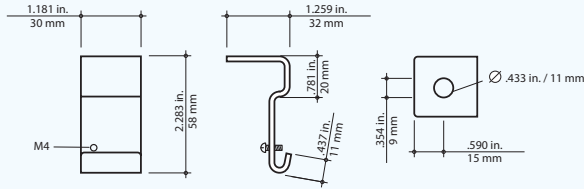

The side hanger clamp is used to construct trapeze supports using threaded rods. The offset support hole allows for trouble-free access to support nuts for height adjustment and the rod can continue downward to allow for multi-level (tiered) trapeze installations. A set screw holds tray firmly in position once installation is complete. Available in pre-galvanized steel. For use with 3/8" threaded rod.

EXPRESS TIP

Refer to page 54 for an application example.

20

Material	Catalogue number	Weight	
		lb/ea.	kg/ea.
Pre-galvanized Steel	ETH-SH-PG	0.13	0.06
Hot-dipped Galvanized Steel	ETH-SH-HD	0.13	0.06
Stainless Steel (Type 316)	ETH-SH-S6	0.18	0.08

UNIVERSAL CLAMP



Dimensions

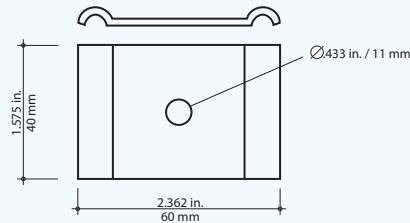

The universal clamp is used to secure large cable drop-outs to the end of a cable run as well as attaching bottom inserts to lengths of ExpressTray®.

EXPRESS TIP

Refer to pages 50 and 51 for application examples.

25

Material	Catalogue number	Weight	
		lb/ea.	kg/ea.
Pre-galvanized Steel	ETH-UNIVC-PG	0.09	0.04
Hot-dipped Galvanized Steel	ETH-UNIVC-HD	0.09	0.04
Stainless Steel (Type 304)	ETH-UNIVC-SS	0.09	0.04

Note: To hold down 2 in. x 2 in. wire basket tray, use 1 ETH-UNIVC-XX with bottom half of ETH-SP-XX. See page 20.

WALL CLAMP

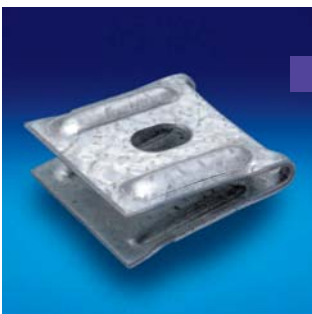

Dimensions

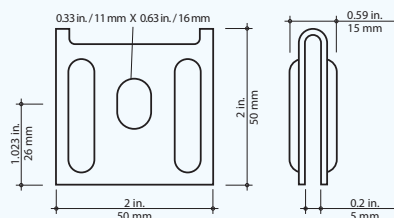

This wall clamp attaches the flange of U- and C-profile ExpressTray®, up to a maximum of 8" wide, to the wall surface. Available in pre-galvanized steel and stainless steel.

EXPRESS TIP

Refer to page 57 for an application example.

25

Material	Catalogue number	Weight	
		lb/ea.	kg/ea.
Pre-galvanized Steel	ETH-WC-PG	0.39	0.18
Stainless Steel (Type 304)	ETH-WC-SS	0.39	0.18

THREADED ROD CLAMP



Dimensions

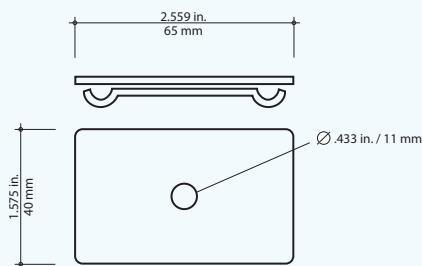

This clamp is used for center-hung applications to secure tray sections to threaded rod for ceiling mounting and can be used with U-profile tray in 4", 8" and 12" widths. This clamp is not designed for use with C-profile tray. Available in pre-galvanized steel, hot-dipped galvanized steel and stainless steel (Type 316).

For use with 3/8" threaded rod.

EXPRESS TIP

Refer to page 53 for application examples.

Material	Catalogue number	Weight	
		lb/ea.	kg/ea.
Pre-galvanized Steel	ETH-CHC-PG	0.18	0.08
Hot-dipped Galvanized Steel	ETH-CHC-HD	0.18	0.08
Stainless Steel (Type 316)	ETH-CHC-S6	0.18	0.08



SUPERSTRUT® THREADED ROD



Dimensions

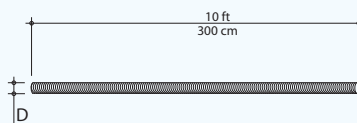

Used for overhead mounting of ExpressTray® with threaded rod clamp, side hanger clamps or strut. Available in 1/4" and 3/8" diameters, threaded rods are made of electro-galvanized steel.

Order nut and washer separately.
(See page 39).

EXPRESS TIP

Refer to pages 52, 53 and 54 for application examples.

Size (D)	Thread per in.	Catalogue number	Weight	
			lb/length	kg/length
1/4 in. dia.	20	H104-1/4X10EGC	1.25	0.57
3/8 in. dia.	16	H104-3/8X10EGC	1.25	0.57

SUPERSTRUT® (METAL FRAMING CHANNEL)



Dimensions

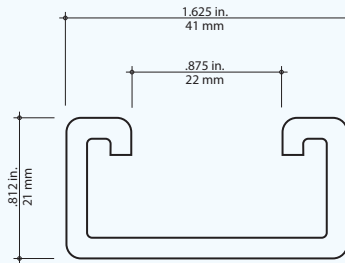

Superstrut® metal framing channel is sold in 10-foot lengths and the standard finish is pre-galvanized steel. Strut is unpunched (not perforated) and must be field-cut and drilled for customized supports with maximum economy. Other finishes and configurations are available, contact your Regional Sales Office for further information.

Material	Catalogue number	Weight	
		lb/ea.	kg/ea.
Pre-galvanized Steel	B120010PG	12.80	5.80

BARRIER STRIP



Dimensions

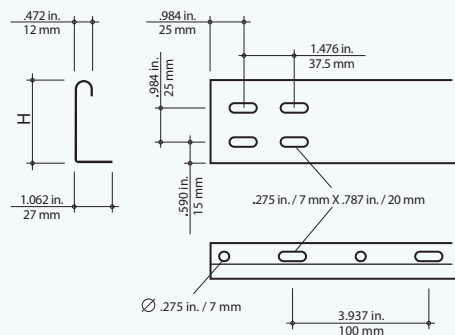

Used to separate bundles of power, communication and data cables. Barrier strips are sold in standard 10-foot lengths and are available in 1-3/4" and 3-3/8" heights. Available in pre-galvanized steel, hot-dipped galvanized and stainless steel (304 and 316).

For use with barrier strip connector and barrier strip clamp on page 35.

EXPRESS TIP

Refer to page 61 for an application example.

Height (H)		Material	Catalogue number	Weight	
in.	mm			lb/length	kg/length
1.750	450	Pre-galvanized Steel	ET-BS175-PG	3.15	1.43
1.750	450	Hot-dipped Galvanized Steel	ET-BS175-HD	3.30	1.50
1.750	450	Stainless Steel (Type 304)	ET-BS175-SS	3.37	1.53
1.750	450	Stainless Steel (Type 316)	ET-BS175-S6	3.37	1.53
3.375	850	Pre-galvanized Steel	ET-BS338-PG	3.15	1.43
3.375	850	Hot-dipped Galvanized Steel	ET-BS338-HD	3.15	1.43
3.375	850	Stainless Steel (Type 304)	ET-BS338-SS	3.15	1.43
3.375	850	Stainless Steel (Type 316)	ET-BS338-S6	3.15	1.43

BARRIER STRIP CONNECTOR



Dimensions

ET-BSH175

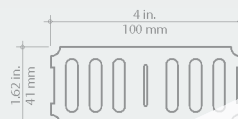

ET-BSH338



This connector is used to connect lengths of barrier strips and is available in two sizes for use with 1-3/4" and 3-3/8" barrier strips. Available in pre-galvanized steel, hot-dipped galvanized steel and stainless steel (304 and 316). Supplied complete with mounting hardware.

Replaced by New Product
ET-BSH-UNIV-SS

Height (H)		Material	Catalogue number	Weight lb/length
in.	mm			
1.620	41	Pre-galvanized Steel	ET-BSH175-PG	0.15
1.620	41	Hot-dipped Galvanized Steel	ET-BSH175-HD	0.15
1.620	41	Stainless Steel (Type 304)	ET-BSH175-SS	0.15
1.620	41	Stainless Steel (Type 316)	ET-BSH175-S6	0.15
3.187	81	Pre-galvanized Steel	ET-BSH338-PG	0.52
3.187	81	Hot-dipped Galvanized Steel	ET-BSH338-HD	0.52
3.187	81	Stainless Steel (Type 304)	ET-BSH338-SS	0.52
3.187	81	Stainless Steel (Type 316)	ET-BSH338-S6	0.52

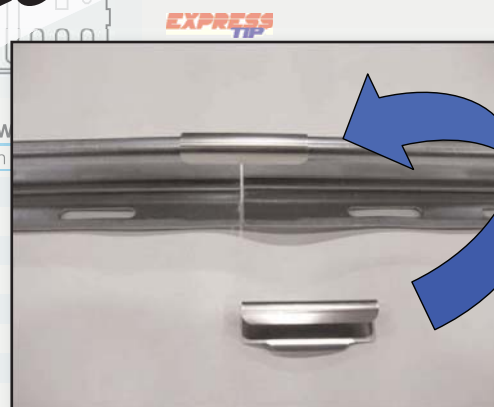

BARRIER STRIP CLAMP



Dimensions

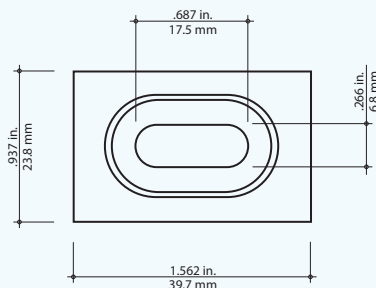

The barrier strip clamp is used to mount barrier strips to ExpressTray® profiles. Available in electro-galvanized steel, hot-dipped galvanized steel and stainless steel (304 and 316).

EXPRESS TIP

Refer to page 61 for an application example.

Material	Catalogue number	Weight	
		lb/ea.	kg/ea.
Electro-galvanized Steel	ETH-BSC-EG	0.07	0.03
Hot-dipped Galvanized Steel	ETH-BSC-HD	0.07	0.03
Stainless Steel (Type 304)	ETH-BSC-SS	0.07	0.03
Stainless Steel (Type 316)	ETH-BSC-S6	0.07	0.03

25

COVER and BOTTOM INSERT

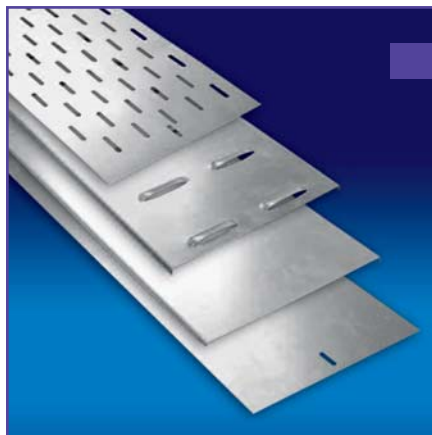

Dimensions

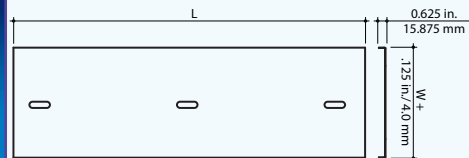

Solid Bottom Insert

ExpressTray® covers and bottom inserts protect cables from dust build-up and provide a physical barrier in environments where cables must be protected from machinery or vandalism.

Attach bottoms to tray using universal clamps (see page 32) and secure covers using cover clips (see page 37).

Available in pre-galvanized steel in widths from 2" to 24". Available in lengths of 120" or 40".

Available in solid or slotted design.



Refer to page 51 for an application example.

Description	Width (W)		Catalogue number Covers	Weight		Catalogue number Bottoms	Weight	
	in.	mm		lb/ea.	kg/ea.		lb/ea.	kg/ea.
Solid Covers and Bottoms 120 in. (3 meters) Length (L)	2	50	ETA-COV02PG-120	1.59	0.72	ETA-BIS02PG-120	1.51	0.68
	4	100	ETA-COV04PG-120	2.03	0.92	ETA-BIS04PG-120	1.93	0.87
	6	150	ETA-COV06PG-120	2.45	1.11	ETA-BIS06PG-120	2.33	1.05
	8	200	ETA-COV08PG-120	4.19	1.90	ETA-BIS08PG-120	3.98	1.81
	12	300	ETA-COV12PG-120	5.91	2.68	ETA-BIS12PG-120	5.61	2.55
	16	400	ETA-COV16PG-120	7.65	3.47	ETA-BIS16PG-120	7.27	3.30
	18	450	ETA-COV18PG-120	8.42	3.82	ETA-BIS18PG-120	8.00	3.63
	20	500	ETA-COV20PG-120	9.39	4.26	ETA-BIS20PG-120	8.92	4.05
	24	600	ETA-COV24PG-120	11.11	5.04	ETA-BIS24PG-120	10.55	4.79
Solid Covers and Bottoms 40 in. (1 meter) Length (L)	2	50	ETA-COV02PG-40	0.53	0.24	ETA-BIS02PG-40	0.50	0.23
	4	100	ETA-COV04PG-40	0.68	0.31	ETA-BIS04PG-40	0.64	0.29
	6	150	ETA-COV06PG-40	0.82	0.37	ETA-BIS06PG-40	0.78	0.35
	8	200	ETA-COV08PG-40	1.40	0.63	ETA-BIS08PG-40	1.33	0.60
	12	300	ETA-COV12PG-40	1.97	0.89	ETA-BIS12PG-40	1.87	0.85
	16	400	ETA-COV16PG-40	2.55	1.16	ETA-BIS16PG-40	2.42	1.10
	18	450	ETA-COV18PG-40	2.81	1.27	ETA-BIS18PG-40	2.67	1.21
	20	500	ETA-COV20PG-40	3.13	1.42	ETA-BIS20PG-40	2.97	1.35
	24	600	ETA-COV24PG-40	3.70	1.68	ETA-BIS24PG-40	3.52	1.60
Vented Covers and Bottoms 120 in. (3 meters) Length (L)	2	50	ETA-COV02PG-120	1.54	0.70	ETA-BIV02PG-120	1.47	0.66
	4	100	ETA-COV04PG-120	1.97	0.89	ETA-BIV04PG-120	1.87	0.85
	6	150	ETA-COV06PG-120	2.38	1.08	ETA-BIV06PG-120	2.26	1.02
	8	200	ETA-COV08PG-120	4.06	1.84	ETA-BIV08PG-120	3.86	1.75
	12	300	ETA-COV12PG-120	5.73	2.60	ETA-BIV12PG-120	5.45	2.47
	16	400	ETA-COV16PG-120	7.42	3.37	ETA-BIV16PG-120	7.05	3.20
	18	450	ETA-COV18PG-120	8.17	3.71	ETA-BIV18PG-120	7.76	3.52
	20	500	ETA-COV20PG-120	9.11	4.13	ETA-BIV20PG-120	8.65	3.93
	24	600	ETA-COV24PG-120	10.78	4.89	ETA-BIV24PG-120	10.24	4.64
Vented Covers and Bottoms 40 in. (1 meter) Length (L)	2	50	ETA-COV02PG-40	0.51	0.23	ETA-BIV02PG-40	0.49	0.22
	4	100	ETA-COV04PG-40	0.66	0.30	ETA-BIV04PG-40	0.62	0.28
	6	150	ETA-COV06PG-40	0.79	0.36	ETA-BIV06PG-40	0.75	0.34
	8	200	ETA-COV08PG-40	1.35	0.61	ETA-BIV08PG-40	1.29	0.58
	12	300	ETA-COV12PG-40	1.91	0.87	ETA-BIV12PG-40	1.82	0.82
	16	400	ETA-COV16PG-40	2.47	1.12	ETA-BIV16PG-40	2.35	1.07
	18	450	ETA-COV18PG-40	2.72	1.24	ETA-BIV18PG-40	2.59	1.17
	20	500	ETA-COV20PG-40	3.04	1.38	ETA-BIV20PG-40	2.88	1.31
	24	600	ETA-COV24PG-40	3.59	1.63	ETA-BIV24PG-40	3.41	1.55

COVER CLIP



Dimensions

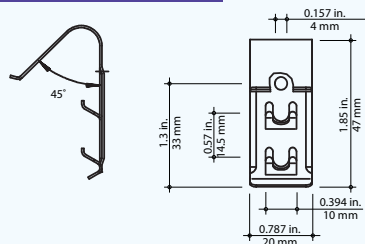

Secure covers to tray quickly with this cover clip. Available in stainless steel (type 316), the cover clip uses built-in tabs to secure the cover and to facilitate removal of the cover when required. No tools required.

EXPRESS TIP

Refer to page 51 for an application example.

20

Material	Catalogue number	Weight	
		lb/ea.	kg/ea.
Stainless Steel (Type 316)	ETA-CC-S6	0.10	0.05

BLACKBURN® GROUNDING CONNECTOR



Dimensions

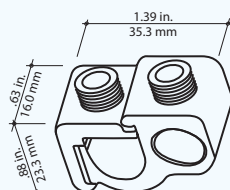

Note: To ensure electrical continuity, the Blackburn® GPT-2 grounding connector and ground wire **MUST** be used in all QuikLok™ Series tray applications.

EXPRESS TIP



Conductor Range	Catalogue number	Weight	
		lb/ea.	kg/ea.
#12 - #2 AWG	GPT-2	0.06	0.03

ETG LAY-IN GROUND LUG



E T G 2 4 - L L 2 1 4

ExpressTray® Ground **2"** through **4"** depth Lay in Lug #**2** AWG through #**14** AWG

- ◆ Lay in lug design easily installs onto any ExpressTray® 2" through 4" deep without any disassembly required.
- ◆ Approved for steel and stainless steel wire mesh trays.
- ◆ Accepts 12 AWG solid through 2 AWG stranded aluminum and 14 AWG solid/stranded through 2 AWG stranded copper conductors.
- ◆ "Slotted hook" design sits securely onto the ExpressTray® mesh intersections to restrict swiveling.
- ◆ **Must** be used on each length of QuikLok™ series tray applications to meet CSA requirements.



SUPERSTRUT® "BAT" CLIP



Attaches ExpressTray® to Stut

Material	Catalogue number	Weight	
		lb/100	kg/100
Spring Steel with zinc phosphate finish (black)	SSF-CK535	1.20	0.55

Specifications

- One piece construction
- No installation tools required
- Reduces installation time to the minimum
- For horizontal applications

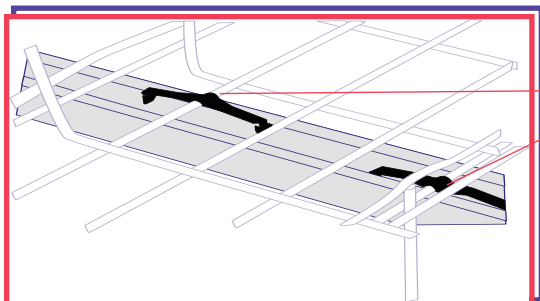

Position "BAT" Clip on outer wires of tray and opposing sides of the strut flanges

To install, just hook one wing under the strut flange and push down the other wing with your thumb to slip it under the strut flange.

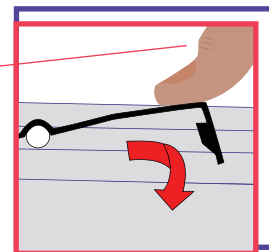

Note: "BAT" Clip should be used for horizontal tray/strut applications. For vertical tray/strut applications, the universal clamp (page 32) should be used to clamp ExpressTray® to strut using a bolt and spring nut (page 39).

BEAM CLAMP



Dimensions

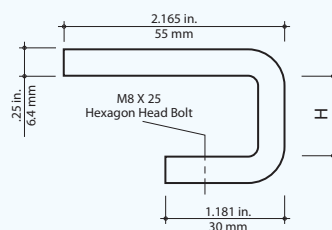

This clamp is used primarily to attach L-profile ExpressTray® to steel beams. It can also be used to attach U- and C-profiles onto structural steel. Available in 3/4" and 1-1/8" sizes in hot-dipped galvanized steel.

Height (H)		Catalogue number	Weight	
in.	mm		lb/ea.	kg/ea.
0.750	20	ETH-IBC3/4-HD	0.44	0.20
1.125	30	ETH-IBC1-HD	0.47	0.22

EXPRESS TIP

Refer to page 61 for an application example.

10

SUPERSTRUT® HEXAGONAL NUT



For use with Superstrut® threaded rod. Available in two sizes, 1/4" and 3/8", in electro-galvanized steel.

Size	Catalogue number	Weight	
		lb/ea.	kg/ea.
1/4 in. hex nut	E145-1/4EGC	0.01	0.004
3/8 in. hex nut	E145-3/8EGC	0.01	0.004

SUPERSTRUT® FLAT WASHER

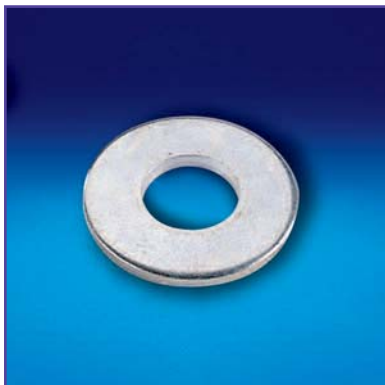

For use with Superstrut® threaded rod and hex nut. Available in 1/4" and 3/8" sizes, in electro-galvanized steel.

Size	Catalogue number	Weight	
		lb/ea.	kg/ea.
1/4 in. flat washer	E147-1/4EGC	0.03	0.02
3/8 in. flat washer	E147-3/8EGC	0.04	0.02

SUPERSTRUT® SPRING NUT



For use with B-Series metal framing channel, spring nuts are offered in 1/4" and 3/8" sizes in electro-galvanized steel.

Size	Catalogue number	Weight	
		lb/ea.	kg/ea.
1/4 in. spring nut	B100-1/4EGC	0.44	0.20
3/8 in. spring nut	B100-3/8EGC	0.46	0.20