

INSTALLATION AND APPLICATION INSTRUCTIONS
INSTRUCCIONES DE INSTALACIÓN Y EMPLEO - INSTRUCTIONS D'INSTALLATION ET D'UTILISATION

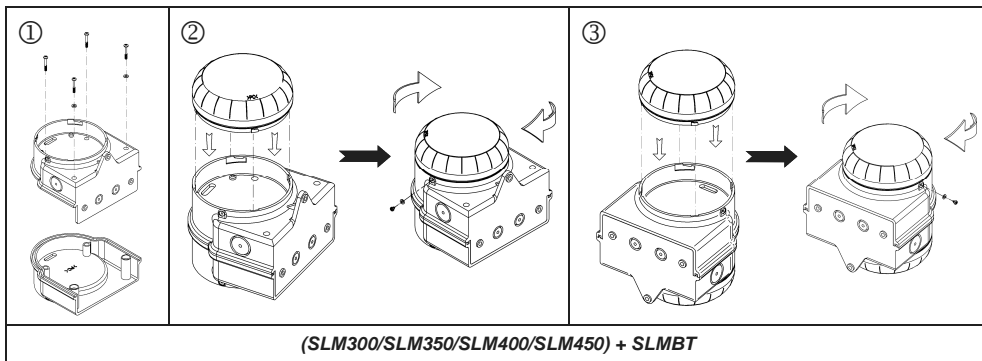

SLM300
SLM350
SLM400
SLM450

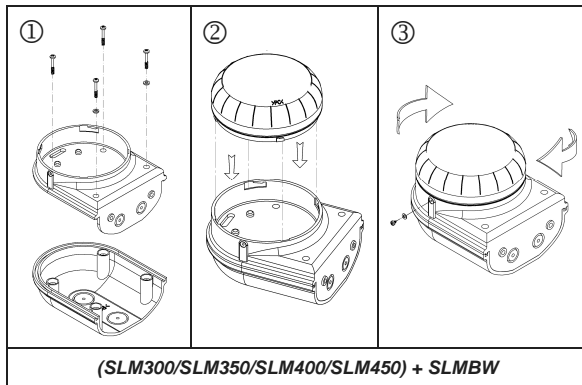
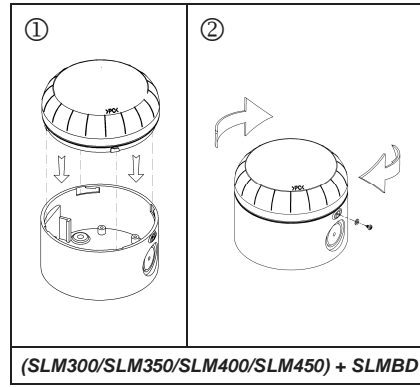
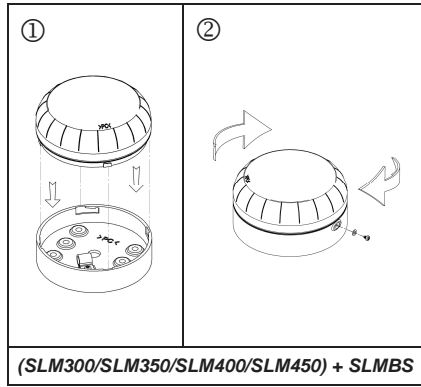
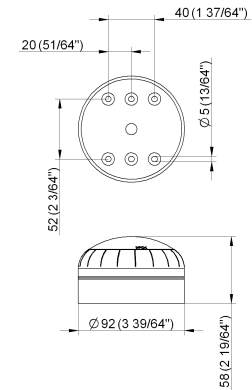
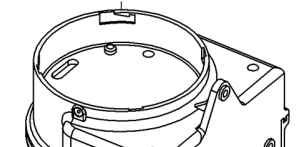
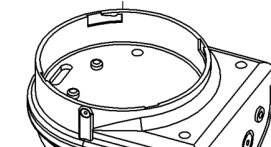
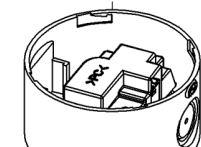
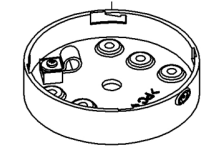
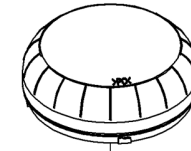

SLM300 + SLMBS
SLM350 + SLMBS
SLM400 + SLMBS
SLM450 + SLMBS

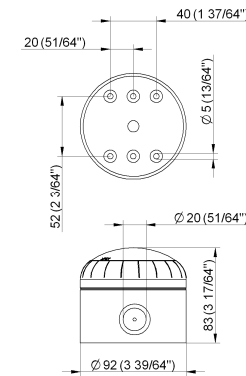

SLM300 + SLMBD
SLM350 + SLMBD
SLM400 + SLMBD
SLM450 + SLMBD

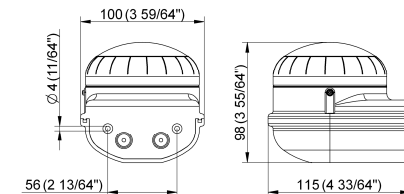

SLM300 + SLMBW
SLM350 + SLMBW
SLM400 + SLMBW
SLM450 + SLMBW

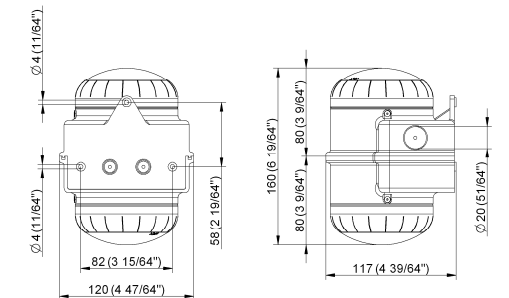

SLM300 + SLMBT
SLM350 + SLMBT
SLM400 + SLMBT
SLM450 + SLMBT

ATTENTION	The possibility exists that rapid flashing lights, under certain circumstances, might induce photosensitive epilepsy
ATENCIÓN	Existe la posibilidad que luces de intermitencia rápida, en determinadas circunstancias, podrían inducir epilepsia fotosensible
ATTENTION	Il est possible que des feux clignotants rapides, dans certaines circonstances, peuvent induire épilepsie photosensible

SLM300/SLM350		
V	12-24	
V		
mA	300	270

SLM300/SLM350		
V	120-240	
mA	80	50

SLM400/SLM450		
V	12-24	
V		
mA	370	310

SLM400/SLM450		
V	120-240	
mA	90	55

TO BE INSTALLED BY QUALIFIED PERSONNEL ONLY
LA INSTALACIÓN SÓLO DEBE SER REALIZADA POR PERSONAL CUALIFICADO - L'INSTALLATION DOIT ÊTRE EFFECTUÉE PAR PERSONNEL QUALIFIÉ

NOT TO BE DISPOSED OF AS COMMON WASTE - NO ELIMINAR COMO DESECHO URBANO - NE PAS ELIMINER COMME DECHET URBAIN

FUSE WIRE PROTECTION	On the power supply line the rating of the supply fuse must be according to the voltage
FUSIBLE DE PROTECCIÓN	En la línea de alimentación emplear fusibles de seguridad adecuados al voltaje
FUSIBLE DE PROTECTION	Sur la ligne d'alimentation utiliser des fusibles retardés dimensionnés selon la tension

ATTENTION	Disconnect power before servicing
ATENCIÓN	Desconecte la corriente antes de abrir el producto
ATTENTION	Débranchez l'alimentation avant de toute intervention sur le produit

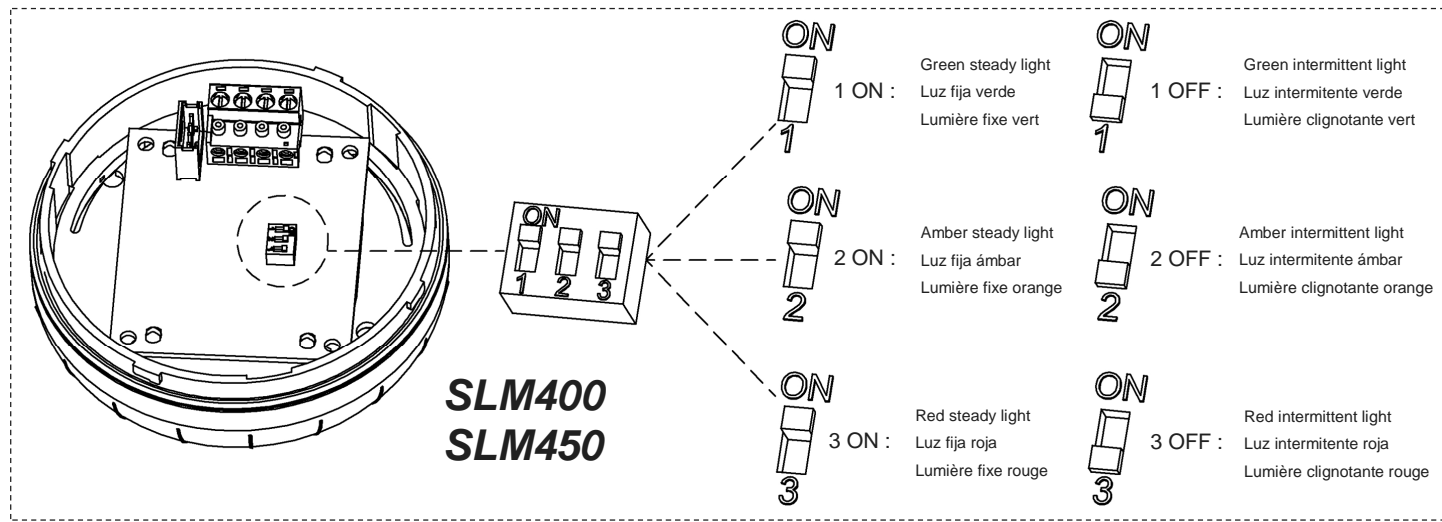

WIRING/CABLEADO/CÂBLAGE BASES LT (12-24V DC/AC)

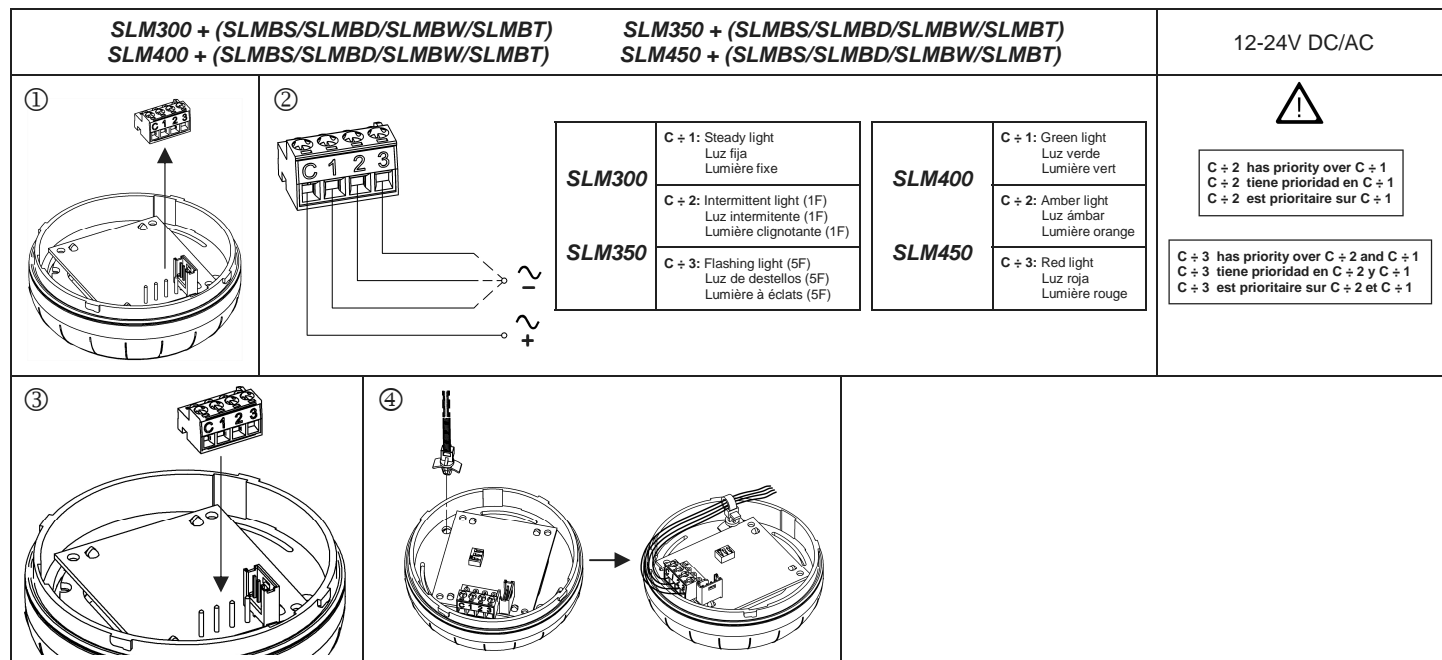

WIRING/CABLEADO/CÂBLAGE BASES HT (120-240V AC)

