



# Core & Coil (71A) MH 175W - 450W

## CORE & COIL HID 71A6393500DEE

The basic ballast is the open core and coil which is most often used as a component within a lighting luminaire. The core and coil also forms the nucleus of Philips Advance's five other ballast configurations.

### Product data

General Information	
ANSI Code	M144
Lamp Type	450W MH
Number Of Lamps	1 piece/unit
Circuit Type	SUPER-CWA
Ballast Type	Magnetic HID
Base Model	71A6393EE
Core Size	4 1/4 x 4 3/4 (2 coil)
Suitable For Outdoor Use	Yes
Ignitor Catalog Number	LI533-H4
Ignitor Temperature Rating	105°C
Capacitor Value	26.5 MFD
Capacitor Catalog Number	7C265P40R
Capacitor Requirements	400V
Capacitor Temperature Rating	105°C
Capacitor Diameter/Oval Dimensions	1.75 in
Capacitor Height	4.80 in
Automatic Restart	No

Operating and Electrical	
Input Voltage	120/208/240/277 V
Input Frequency	60 Hz
Input Current (Open Circuit)	2.15/1.25/1.1/1 A
Input Current (Starting)	3.2/1.8/1.6/1.4 A
Input Current (Short Circuit)	2.2-3.3/1.3-1.95/1.1-1.7/0.95-1.45 A
Secondary Short Circuit Current	3.85-4.75 A
Constant Wattage Deviation	10%
Ballast Factor (Nom)	1
Power Factor (Nom)	0.90
Open Circuit Voltage	257 V
Input Current (Nom)	4.25/2.5/2.15/1.85 A A
Input Power (Nom)	508 W
Rated Lamp Power	450 W

Wiring	
Wire Striplength	0.5 mm
Wire Length By Color	12"
Wire Type	Stranded
Remote Wiring Configuration Allowed	Yes

## Core & Coil (71A) MH 175W - 450W

Max Ballast-Lamp Distance Remote Wiring	5'
Recommended Fuse Value	10/8/5/5 A
<b>Approval and Application</b>	
Open Circuit Voltage Test (Volts)	230-280 V
Approval Marks	ULR CSA certificate EISA RoHS Compliant
Temperature Marking	C/C/C/C
UL Recognized	Yes
Hipot Test (1 Minute)	2000 V
Hipot Test (2 Seconds)	2500 V
UL Insulation Class	H(180°C)
UL Temperature Code	1029C

<b>Product Data</b>	
Order product name	CORE & COIL HID 71A6393500DEE
EAN/UPC - Product	781087078358
Order code	913710696802
Numerator - Quantity Per Pack	1
Numerator - Packs per outer box	4
Material Nr. (12NC)	913710696802
Net Weight (Piece)	6.364 kg

### Dimensional drawing

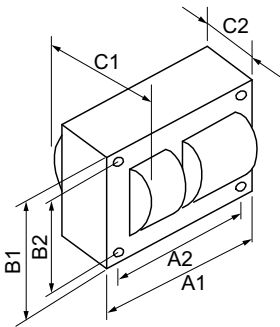

MH BAL 450W M144 QUAD C&C

Product	C1	C2	A1	A2	B1	B2
---------	----	----	----	----	----	----

