

Note: Bulkhead combination must be used on a flat surface of a NEMA Type 12 Enclosure to maintain rating.

Industrial Jack

IAEBH5E / IAEBH6 / IAEBH6X / IAEBH5ES / IAEBH6S / IAEBH6XS / IAEBH (jack module not included)

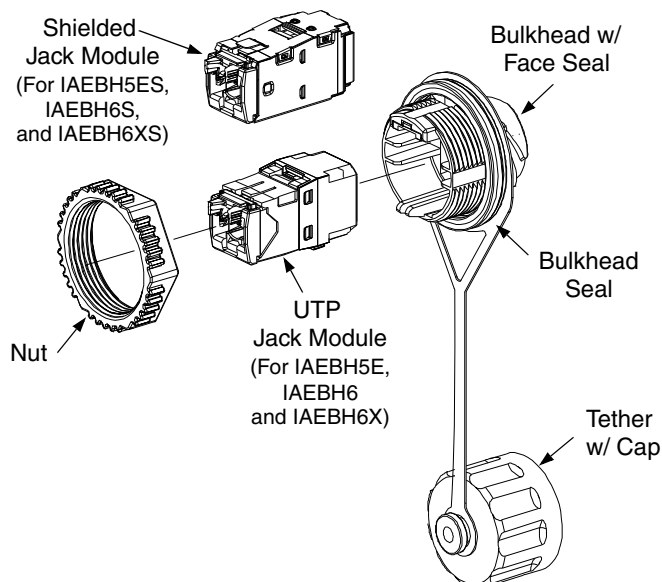

Industrial Plug

MPSI588T / MPI588T

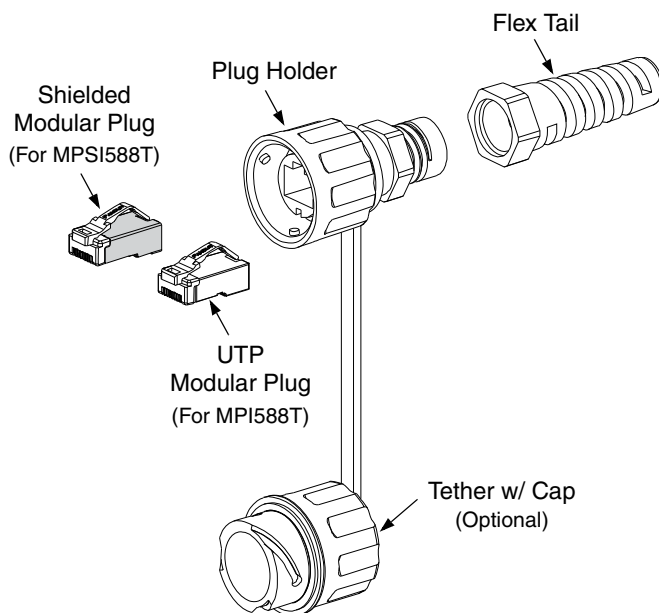

Installation for Industrial Jack Module

1

Bulkhead Opening Requirements

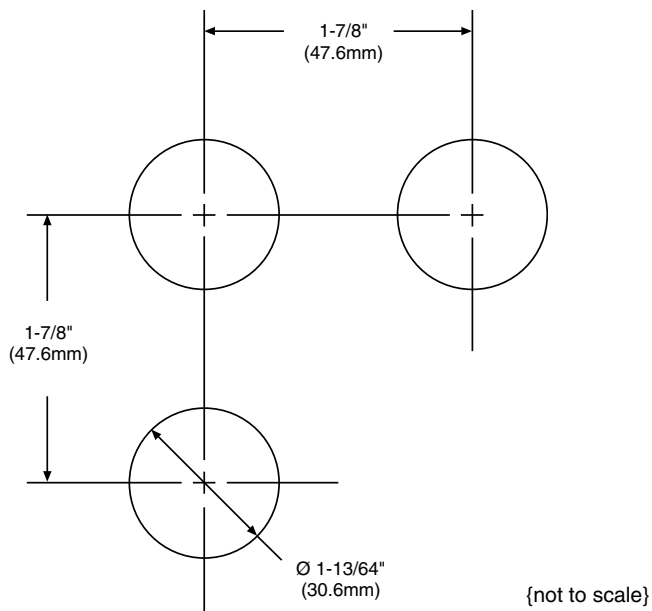

2

Inside of Enclosure

Outside of Enclosure

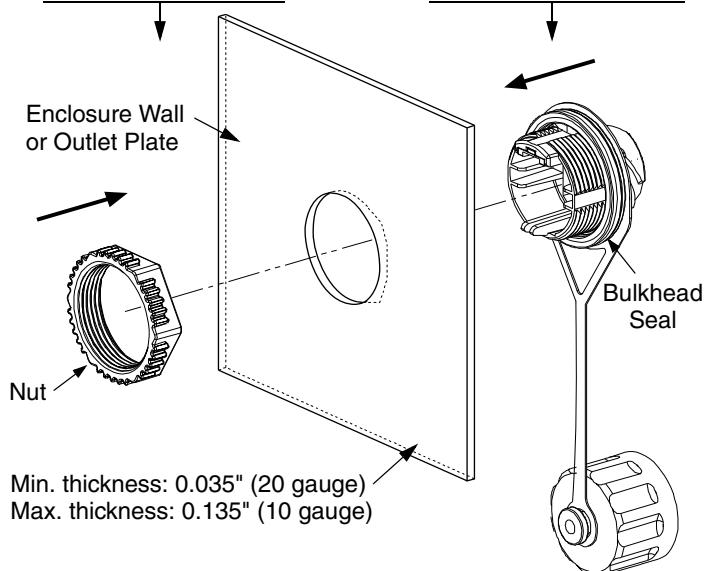

Insert Bulkhead into prepared opening from outside of enclosure. While holding Bulkhead in place, secure with Nut on inside of enclosure. Hand turn Nut 4-1/4 to 5 full turns. Be careful not to tighten to the point the Bulkhead Seal is over compressed and displaced from the enclosure wall and the Bulkhead.
Note: If using wrench, flats on Nut should be on the outside.

Installation for Industrial Jack Module

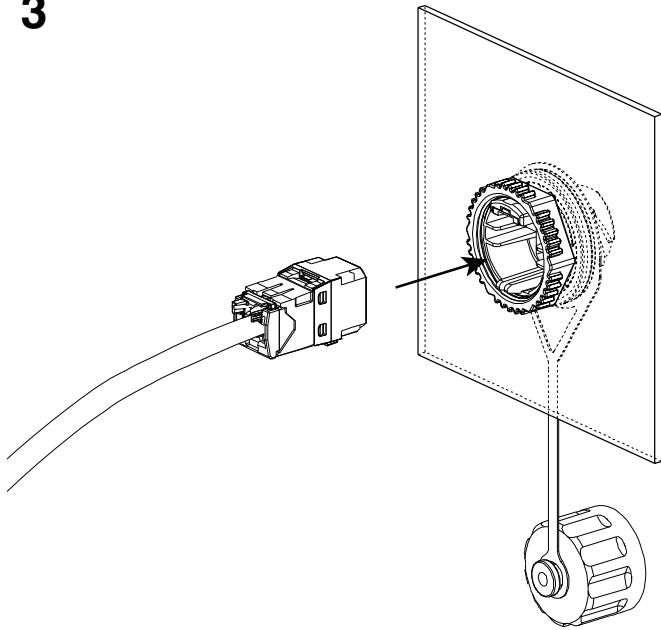
3

Terminate jack module.

See Panduit installation instruction PN403* for UTP jack module termination instructions and PN366* for shielded jack module.

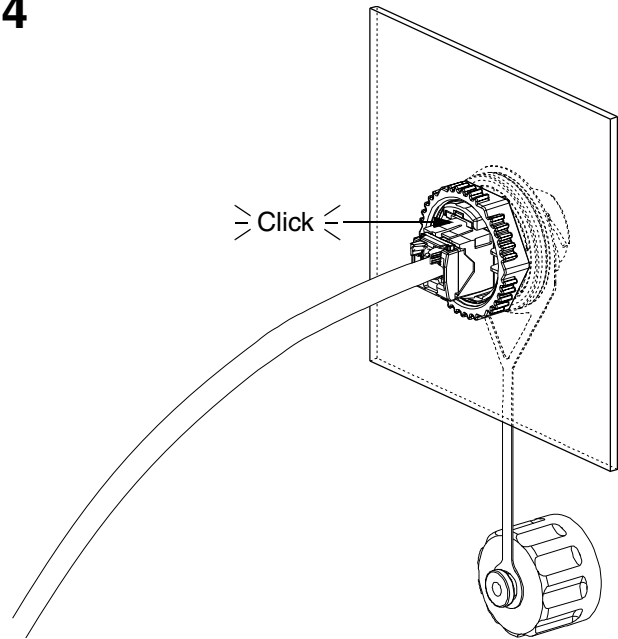
4

Properly orient jack module as shown and insert into bulkhead until it clicks into position.

5

(Enclosure wall removed from views for clarity)

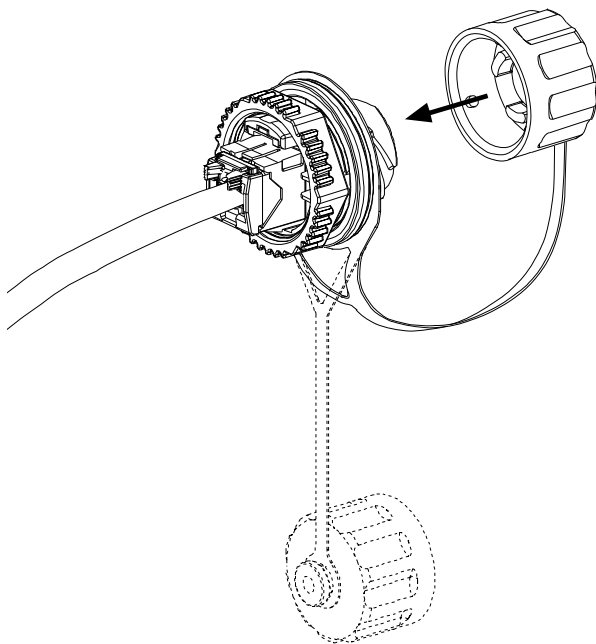
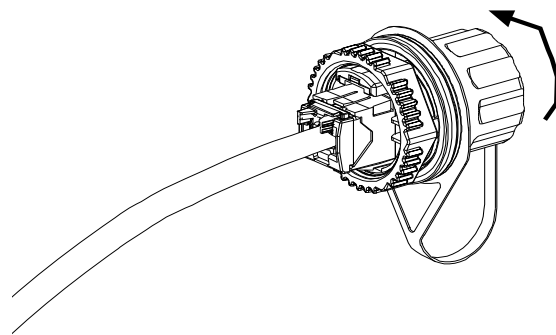
**6**

Tethered cap for sealing industrial jack module when not in use with industrial modular plug.

*Denotes revision level of installation instruction.

Installation for Industrial Modular Plug

1

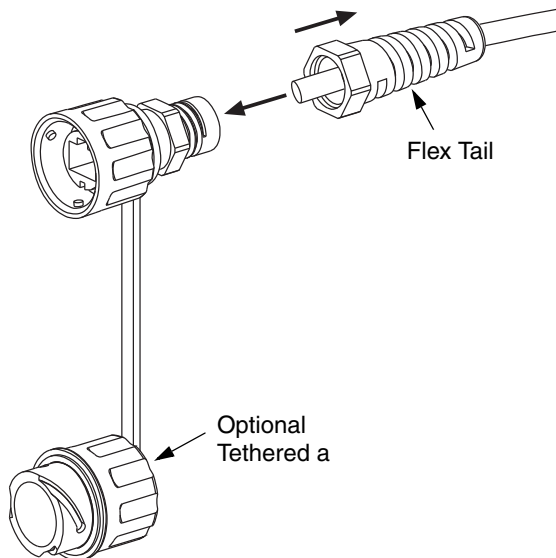

Slide flex tail onto cable and route cable through rear of modular plug housing.

2

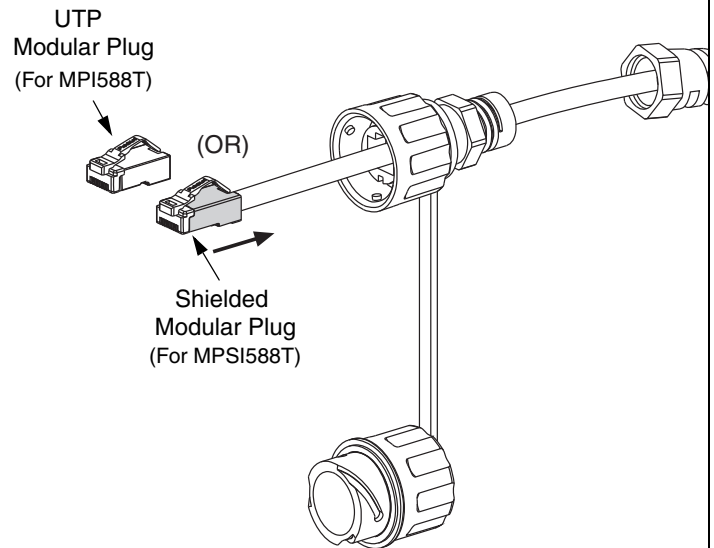

See Panduit installation instruction PN85* for termination instructions of UTP modular plug, or PN234* for shielded.

Test cord before installing into plug holder. After termination, align plug latch with notched opening in black plug holder. Depress latch and press plug module firmly into the plug holder until fully seated.

3

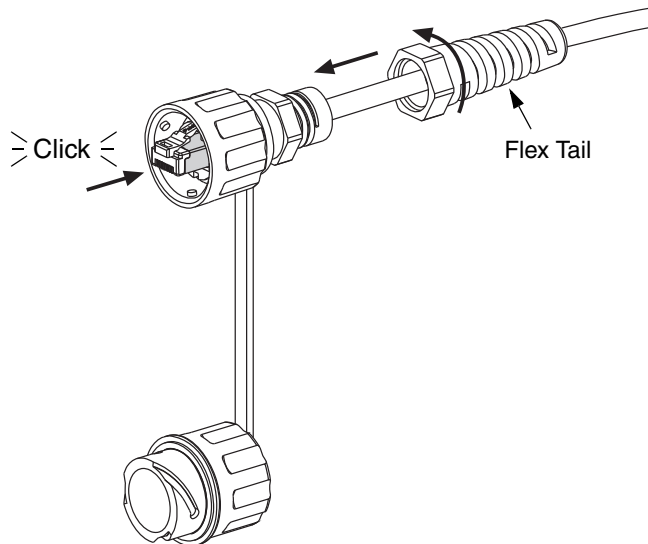

Tighten flex tail by hand a total of 3 to 3-1/4" full turns. For IP67 intrusion protection, cable must be circular in shape.

Note: Patch cord performance should be verified before a plug is pushed back into position, as the plug holder assembly is not intended to be reused.

4

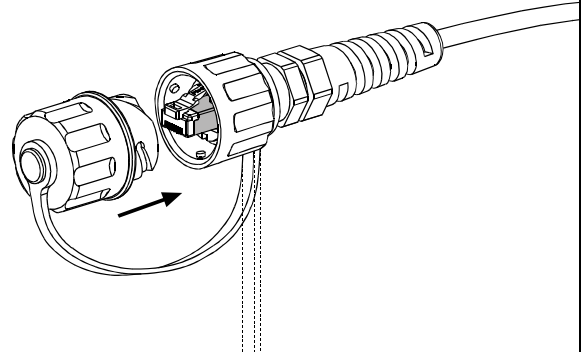

5

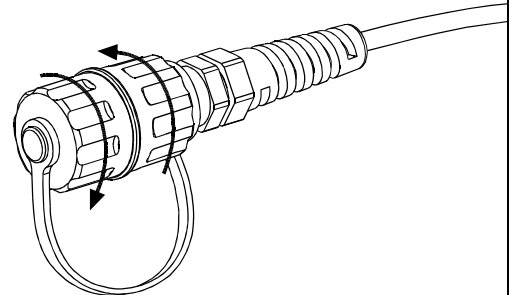

Tethered cap option for sealing industrial modular plug when not in use with industrial jack module.

*Denotes revision level of installation instructions.

Installation for Industrial Modular Plug to Industrial Jack Module

Note: Bulkhead combination must be used on a flat surface of a NEMA Type 12 Enclosure to maintain rating.

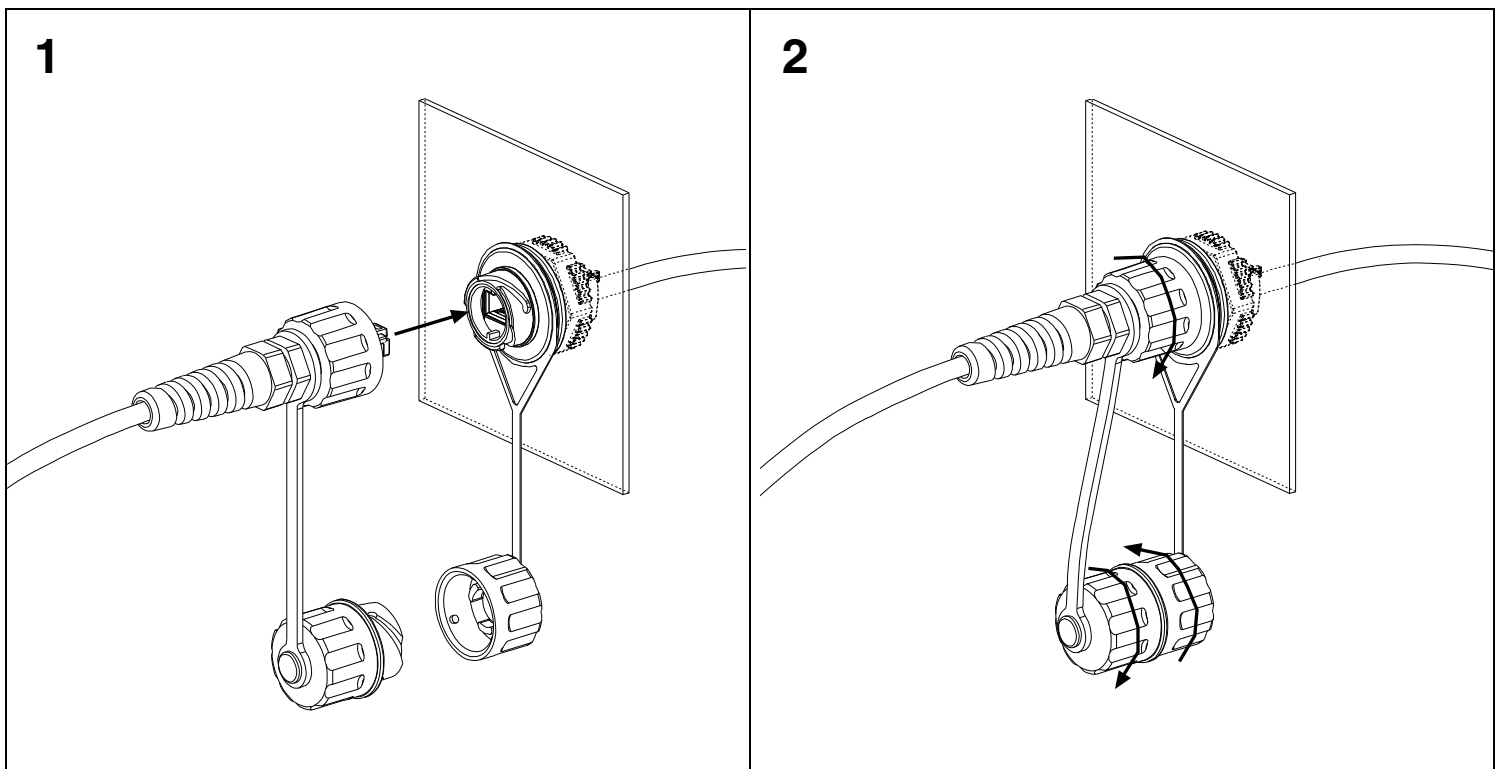
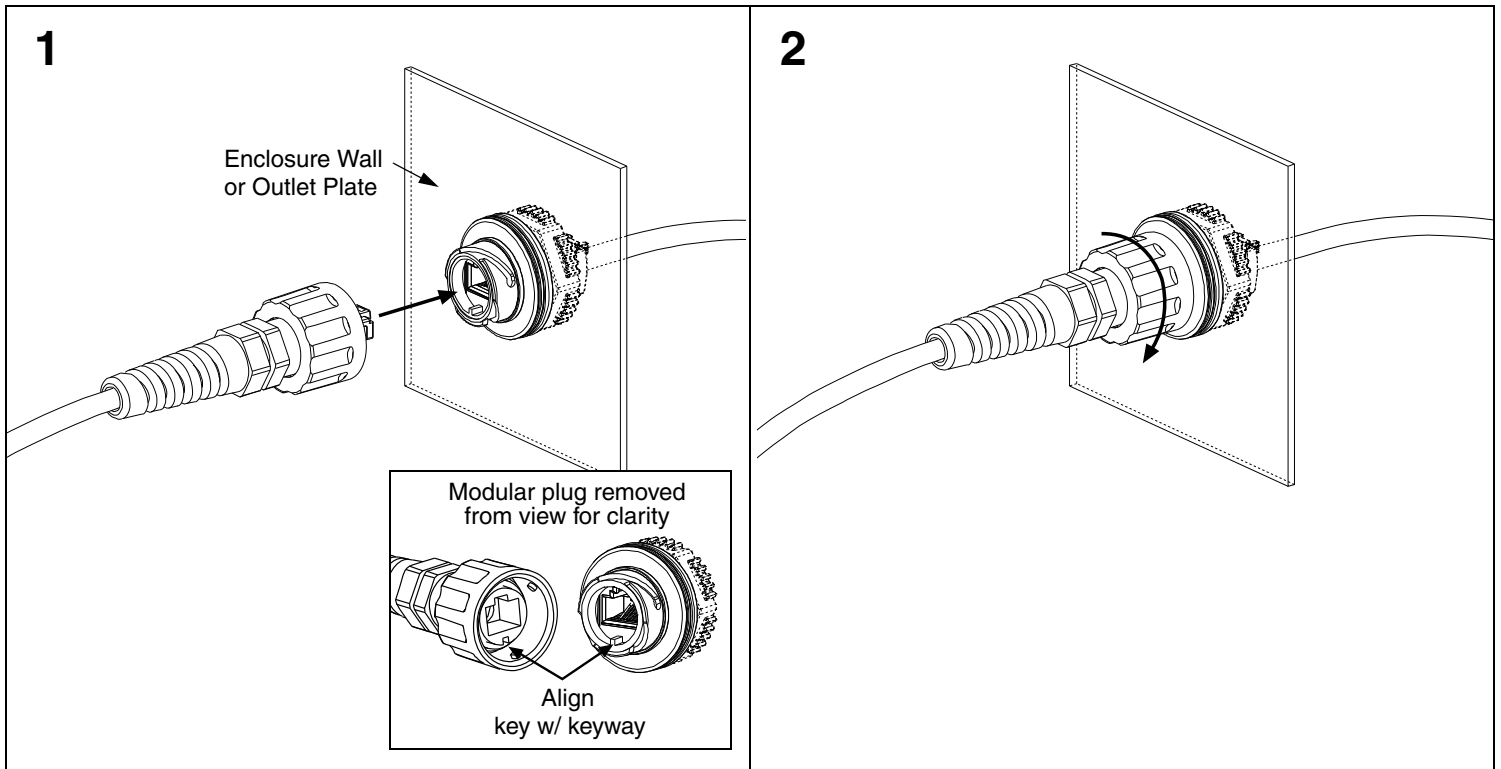

For Instructions in Local Languages
and Technical Support:

www.panduit.com/resources/install_maintain.asp

PANDUIT
www.panduit.com

E-mail:
techsupport@panduit.com

Phone:
866-405-6654