



Catalog Number: U4542-XL
Item Description: 200A 3PH 600V TERMINAL
UPC Code: 784572230552

Brand Name: Milbank

Type: Line to Load Distribution

Special Features: Single Position, Three Phase Four Wire, 10,000 Ampere Short Circuit Current Rating

Application: Termination Cabinet

Standard: UL Listed

Number Of Conductors: 6

Conductor Material: Copper, Aluminum

Size: 4.125L x 14.813W x 23H

Voltage Rating: Up to 600 Volts Alternating Current

Temperature Rating: No Temperature Rating

Insulation Material: Polypropylene

Jacket Material: No Jacket Material

Color: ANSI 61 Gray

Connection: 6 AWG to 350 kcmil Line Side Lugs, 6 AWG to 350 kcmil Load Side Lugs

Construction: Type 3R, G90 Galvanized Steel

Length: 4.125



Utility requirements may vary. Always consult the serving utility for their requirements prior to ordering or installing this equipment. This product must always be installed by a licensed electrician. Installation of this equipment may require local electrical inspector approval.

FEATURE TABLE		
ITEM	QTY	DESCRIPTION
A	4	STD. MNTG. EMBOSS
B	1	¼, ½ CONC. K.O.
C	1	1, 1¼ CONC. K.O.
D	3	¾, 1, 1¼, 1½, 2, 2½ CONC. K.O.

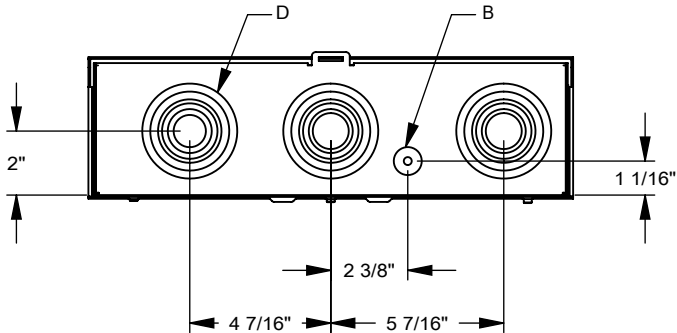
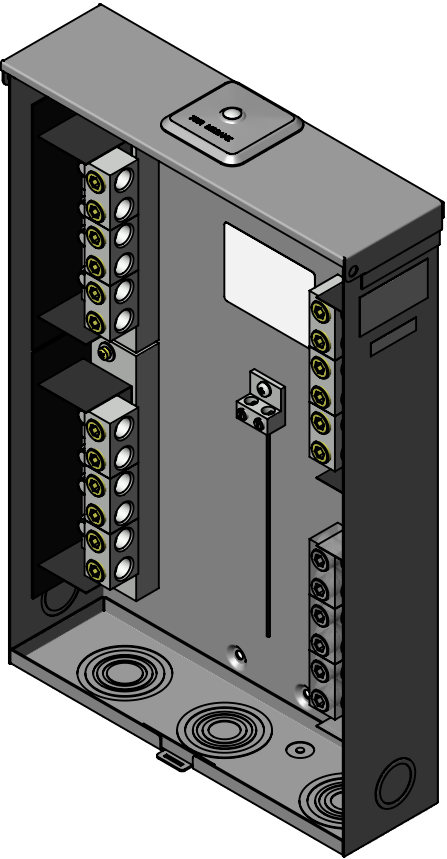
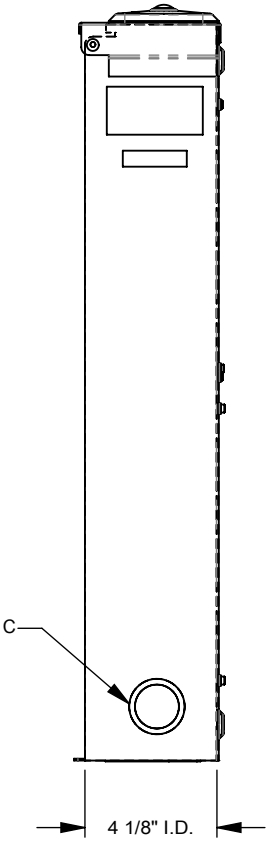
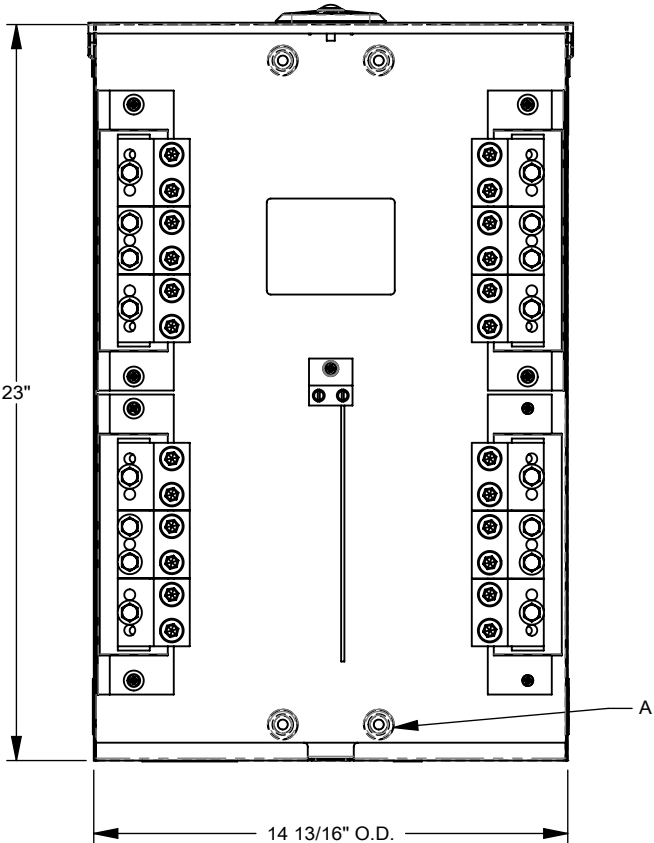

Version:

1

All dimensions are +/- 1/16".
Drawing views are not to scale.
Utility requirements for this equipment may vary. Always consult the serving utility for their requirements prior to ordering or installing this equipment. This product must be installed by a licensed electrician. Installation of this equipment may require local electrical inspector approval.