

A Pentair Company

### AL2, AL3 Latch Kit

### Installation Instruction For Single-Point Latch Kit Catalog Numbers: AL2A, AL2ACCW, AL3

1. Locate and drill holes for handle as shown below. Do not drill holes for rod guides.
2. Assemble latch kit as shown.

### Installation Instruction For Three-Point Latch Kit Catalog Numbers: AL2BR, AL2CR, AL2DR, AL2BCCW, AL2CCW, AL2DCCW, AL3BR, AL3CR, AL3DR

1. Locate and drill holes in door from outside edges using dimensions shown.
2. Install nylon washers and handle gasket on outside of door to obtain proper sealing. The latch rods are made to fit different size enclosures. If latch rod is too long, select proper hole and cut latch rods approximately 3/8 inch from center of hole. Be sure of hole selection before cutting. Place roller pin in hole shown and secure with retaining ring. If gasket compression is too great, simply move roller pin one hole at a time until proper gasket compression is attained. Washers are provided to position latch by spacing it in or out as required.

**Hoffman Enclosures Inc.**  
2100 Hoffman Way  
Anoka, MN 55303-1745  
(763) 422-2211  
[www.hoffmanonline.com](http://www.hoffmanonline.com)

**Pentair Electronic Packaging**  
170 Commerce Drive  
Warwick, RI 02886  
(401) 732-3770  
[www.pentair-ep.com](http://www.pentair-ep.com)

**Mexico**  
Pentair Enclosures, S. de R.L. de C.V.  
Federico T. de la Chica No. 8 Piso 4 A  
Circuito Comercial Plaza Satélite  
Ciudad Satélite,  
Naucalpan, México C.P. 53100  
011-52-55-5393-8263

**Canada**  
Hoffman-Schroff  
111 Grangeway Avenue, Suite 504  
Scarborough, Ontario M1H 3E9  
(416) 289-2770  
1-800-668-2500 (Canada only)

**Germany**  
Schroff GmbH  
Langenalber Str. 96-100  
75334 Straubenhardt  
49 (07082) 794-0 [www.schroff.de](http://www.schroff.de)

**Great Britain**  
Schroff UK Ltd.  
Maylands Avenue  
Hemel Hempstead, Herts HP2 7DE  
44 (01442) 240471 [www.schroff.co.uk](http://www.schroff.co.uk)

**Sweden**  
Schroff Scandinavia AB  
Box 2003  
12821 Skarpnäck  
46 08683 61 00 [www.schroff.se](http://www.schroff.se)

**France**  
Schroff Sas  
Z.I., 4 rue du Marais  
67660 Betschdorf  
33 03 88 90 64 90 [www.schroff.fr](http://www.schroff.fr)

**Italy**  
Schroff srl  
Viale Milano, 119  
21013 Gallarate (Varese)  
39 0331 79 40 03

**Singapore**  
Hoffman-Schroff Pte. Ltd.  
#01-68/71 German Centre  
25 International Business Park  
Singapore 609916  
65 5 62-78 90

**Japan**  
Schroff K.K.  
Nisso No. 13 Bldg. 4F  
2-5-1 Shinyokohama  
Kohoku-Ku, Yokohama shi  
Kanagawa 222-0033  
81 (045) 476-02 81

**Finland**  
Schroff Scandinavia AB  
Peräsimentie 8  
03100 Nummela  
358 09 222 68 00

**Norway**  
Schroff Scandinavia AB  
Bjøernerudveien 24  
1266 Oslo  
47 022 76 33 60

**⚠ WARNING**

To avoid electric shock, do not energize any circuits before all internal and external electrical and mechanical clearances are checked to assure that all assembled equipment functions safely and properly.

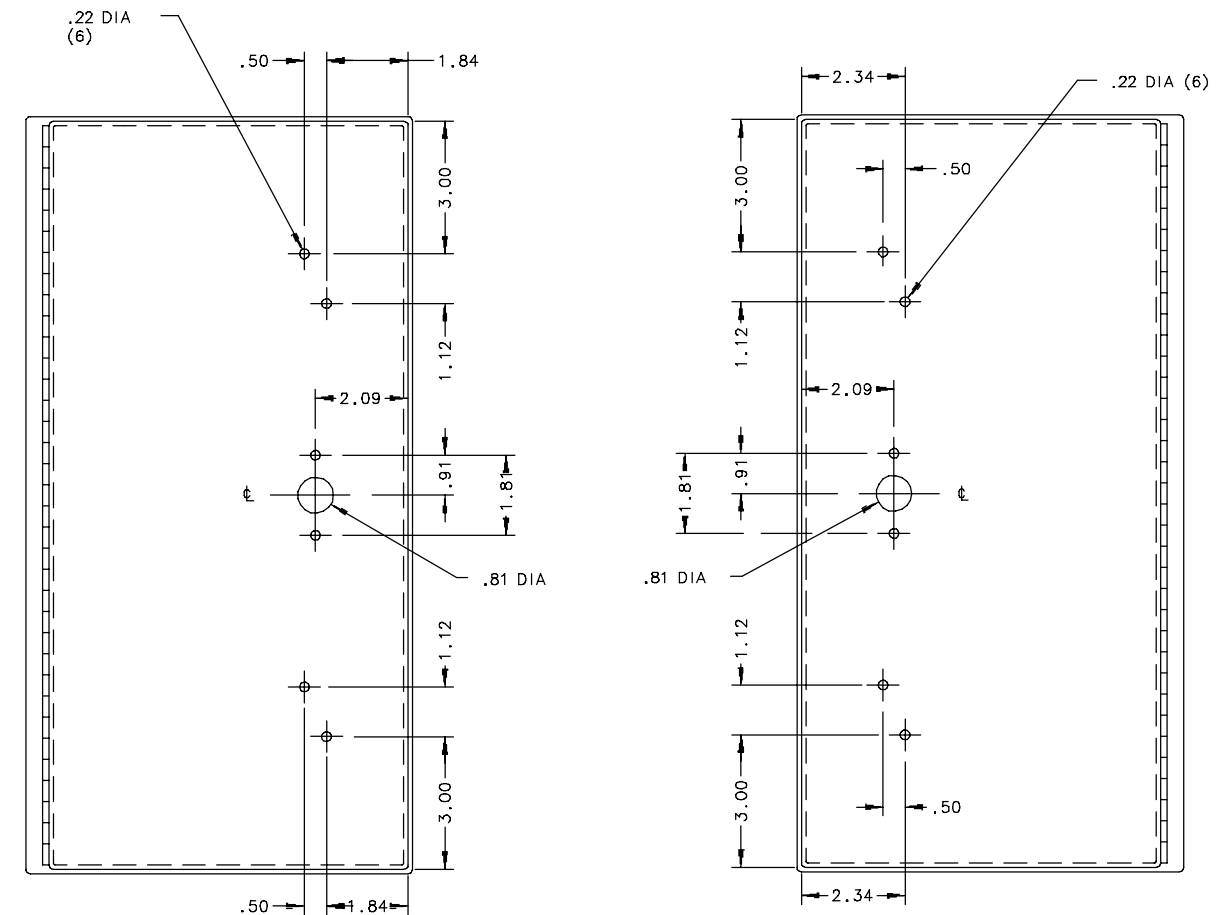
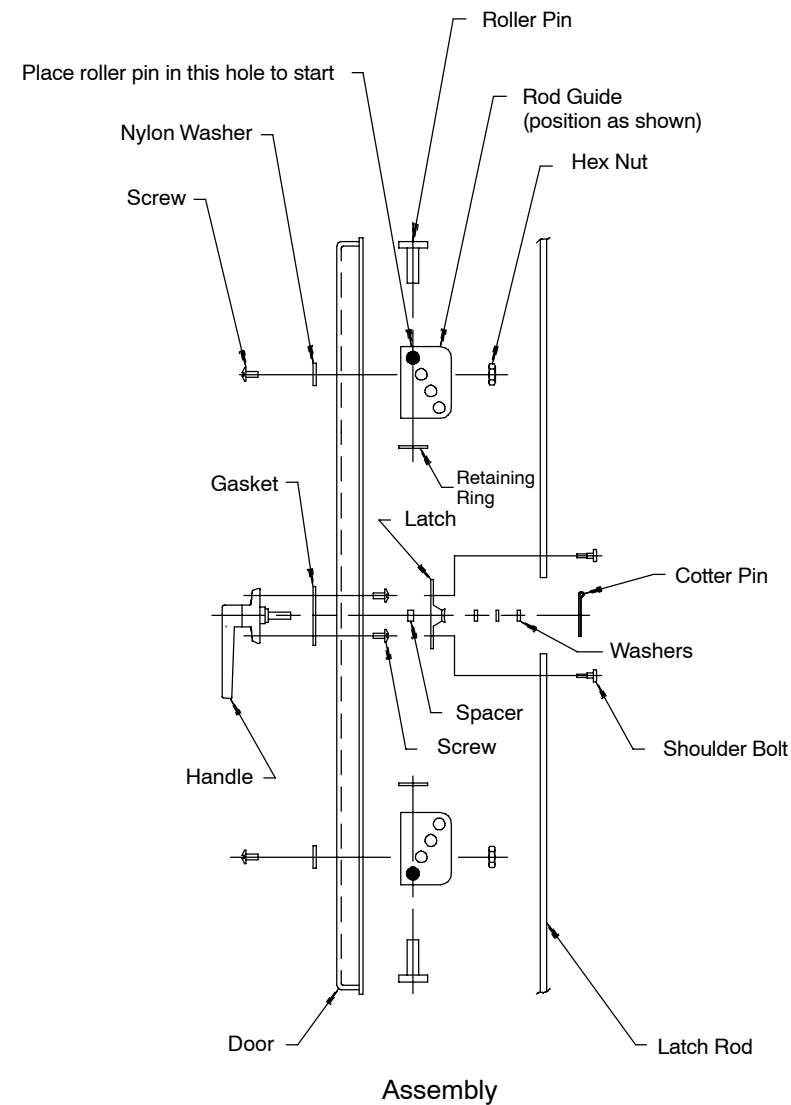

Door Hinged On Left

Door Hinged On Right