



Core & Coil (71A) MH 175W - 450W

CORE & COIL HID MH BAL 175W M137/M152 QUAD C&C

The basic ballast is the open core and coil which is most often used as a component within a lighting luminaire. The core and coil also forms the nucleus of Philips Advance's five other ballast configurations.

Product data

General Information	
ANSI Code	M137-M152
Lamp Type	175W MH
Number of Lamps	1 piece/unit
Circuit Type	SUPER-CWA
Ballast Type	Magnetic HID
Base Model	71A5591EE
Core Size	4 1/4 x 4 3/4 (2 coil)
Suitable For Outdoor Use	Yes
Ignitor Catalog Number	LI533-H4
Ignitor Temperature Rating	105°C
Capacitor Value	11 MFD
Capacitor Catalog Number	7C110M40
Capacitor Requirements	370V
Capacitor Temperature Rating	105°C
Capacitor Diameter/Oval	1.65 in
Dimensions	
Capacitor Height	3.75 in
Automatic Restart	No

Operating and Electrical	
Input Voltage	120/208/240/277 V
Input Frequency	60 Hz
Input Current (Open Circuit)	1.3/0.72/0.65/0.57 A
Input Current (Starting)	0.83/0.51/0.44/0.37 A
Input Current (Short Circuit)	0.66-1/0.41-0.61/0.35-0.53/0.3-0.44 A
Secondary Short Circuit Current	1.56-1.91 A
Constant Wattage Deviation	10%
Ballast Factor (Nom)	1
Power Factor (Nom)	0.90
Open Circuit Voltage	285 V
Input Current (Nom)	1.66/0.95/0.83/0.71 A A
Input Power (Nom)	198 W
Rated Lamp Power	175 W
Wiring	
Wire Striplength	0.5 mm
Wire Length by Color	12"
Wire Type	Stranded

Core & Coil (71A) MH 175W - 450W

Remote Wiring Configuration Allowed	Yes
Max Ballast-Lamp Distance	2'
Remote Wiring	
Recommended Fuse Value	5/3/3/3 A

Approval and Application

Open Circuit Voltage Test (Volts)	254-310 V
Approval Marks	ULR CSA certificate RoHS Compliant
Temperature Marking	A/A/A/A
UL Recognized	Yes
Hipot Test (1 Minute)	2000 V
Hipot Test (2 Seconds)	2500 V
UL Insulation Class	H(180°C)

UL Temperature Code	1029A
---------------------	-------

Product Data

Order product name	CORE & COIL HID MH BAL 175W M137/M152 QUAD C&C
EAN/UPC - Product	781087070260
Order code	913710664902
Numerator - Quantity Per Pack	1
Numerator - Packs per outer box	4
Material Nr. (12NC)	913710664902
Net Weight (Piece)	4.750 kg

Dimensional drawing

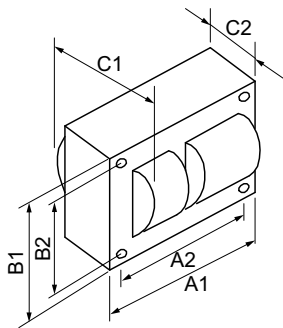

MH BAL 175W M137/M152 QUAD C&C

Product	C1	C2	A1	A2	B1	B2
CORE & COIL HID 71A5591500DEE	3.30 in	1.65 in	4.8 in	4.4 in	4.3 in	3.9 in

