

Issue Date: 11/12/2012

Page: 1 of 2

File: PSS- K150T

15/25kV	200A Deadbreak Tee Splice	w/o Test Point	K150T
---------	---------------------------	----------------	-------



Features:

- 15/25kV, 200 Amp Deadbreak Tee Splice
- Fully shielded, fully submersible molded rubber housing
- 100% peroxide-cured construction includes insulation and conductive EPDM materials
- Wide cable range with minimum number of sizes

K150T Deadbreak Tee Splice

Applications:

Elastimold® K150T tee splices are fully shielded, fully submersible, separable insulated connectors designed to provide a three-way, disconnectible cable connection. The disconnectible feature can be used only when the circuit is de-energized. The K150T is suitable for use on both 15 and 25 kV systems. The K150T is designed with two plug ends and one receptacle end. The K150T plug ends mate with the following Elastimold® 15/25kV products:

- 156LR elbow connector
- K151SR straight receptacle
- K150DR dead-end receptacle
- K180 series bushings

The K150T Receptacle end mates with the following Elastimold® Products:

- K151SP
- K150DP

Ratings:

Meets ANSI/IEEE Standard 386, Latest Revision

For 15kV Voltage Class:

8.3kV Max Phase-to-Ground – Operating Voltage
 14.4kV Max Phase-to-Phase
 95kV BIL – Impulse Withstand (1.2 x 50 microsecond wave)
 34kV AC – One minute withstand
 53kV DC – 15 minutes withstand
 11kV AC – Corona Extinction @ 3pC sensitivity
 200 Amp – Continuous
 10kA Sym – 10 Cycles Momentary

For 25kV Voltage Class:

15.2kV Max Phase-to-Ground – Operating Voltage
 26.3kV Max Phase-to-Phase
 125kV BIL – Impulse Withstand (1.2 x 50 microsecond wave)
 40kV AC – One minute withstand
 78kV DC – 15 minutes withstand
 19kV AC – Corona Extinction @ 3pC sensitivity
 200 Amp – Continuous
 10kA Sym – 10 Cycles Momentary

Issue Date: 11/12/2012

Page: 2 of 2

File: PSS-K150T

15/25kV	200A Deadbreak Tee Splice	w/o Test Point	K150T
---------	---------------------------	----------------	-------

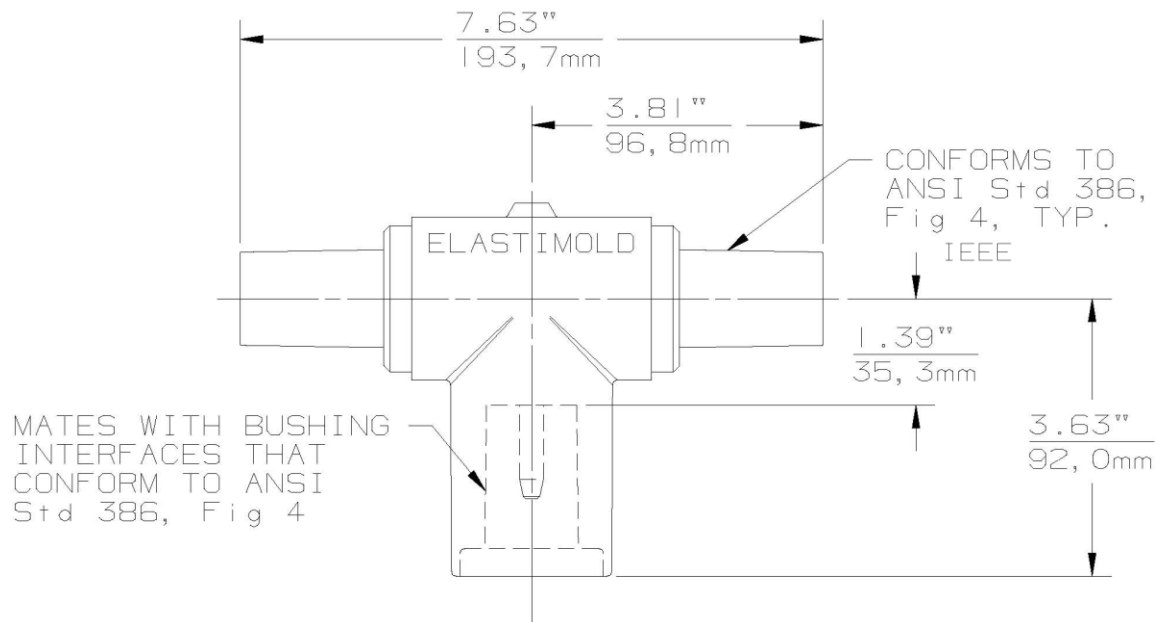

CATALOG NUMBER SELECTION

To order, specify **K150T** for tee splice.

Each kit contains the following:

1 Tee Splice	K150T
2 Protective Shipping Cap	180-PCC
1 Protective Shipping Cap	1600-13-3
1 Lubricant	82-08
1 Installation Instruction	IS-0059

Notes:

* Copper compression lug suitable for all copper conductors only.