

Issue Date: 10/04/2012

Page: 1 of 2

File: PSS-K151SOP

15/25kV	200A Deadbreak Insulated Parking Bushing	K151SOP
---------	------------------------------------------	---------



Features:

- 15/25kV, 200 Amp Deadbreak Rated
- Peroxide-cured insulation and jacket
- Fully shielded, fully submersible
- Mounts in Deadbreak parking stand
- Provides “dead-end” for circuit

K151SOP Deadbreak Insulated Parking Bushing

Applications:

The Elastimold® K151SOP insulated parking bushing is a fully shielded, fully submersible parking bushing designed for de-energized operation. It is suitable for use on 15kV and 25kV class systems and is used to “dead-end” the following Elastimold® mating products:

- 156LR Elbow
- K151SR Straight Receptacle

Ratings:

Meets ANSI/IEEE Standard 386, Latest Revision

For 15kV Voltage Class:

8.3kV Max Phase-to-Ground – Operating Voltage
 14.4kV Max Phase-to-Phase
 95kV BIL – Impulse Withstand (1.2 x 50 microsecond wave)
 34kV AC – One minute withstand
 53kV DC – 15 minutes withstand
 11kV AC – Corona Extinction @ 3pC sensitivity
 200 Amp – Continuous
 10kA Sym – 10 Cycles Momentary & Fault Close

For 25kV Voltage Class:

15.2kV Max Phase-to-Ground – Operating Voltage
 26.3kV Max Phase-to-Phase
 125kV BIL – Impulse Withstand (1.2 x 50 microsecond wave)
 40kV AC – One minute withstand
 78kV DC – 15 minutes withstand
 19kV AC – Corona Extinction @ 3pC sensitivity
 200 Amp – Continuous
 10kA Sym – 10 Cycles Momentary & Fault Close

Issue Date: 10/04/2012

Page: 2 of 2

File: PSS-K151SOP

15/25kV	200A Deadbreak Insulated Parking Bushing	K151SOP
---------	-------------------------------------------------	---------

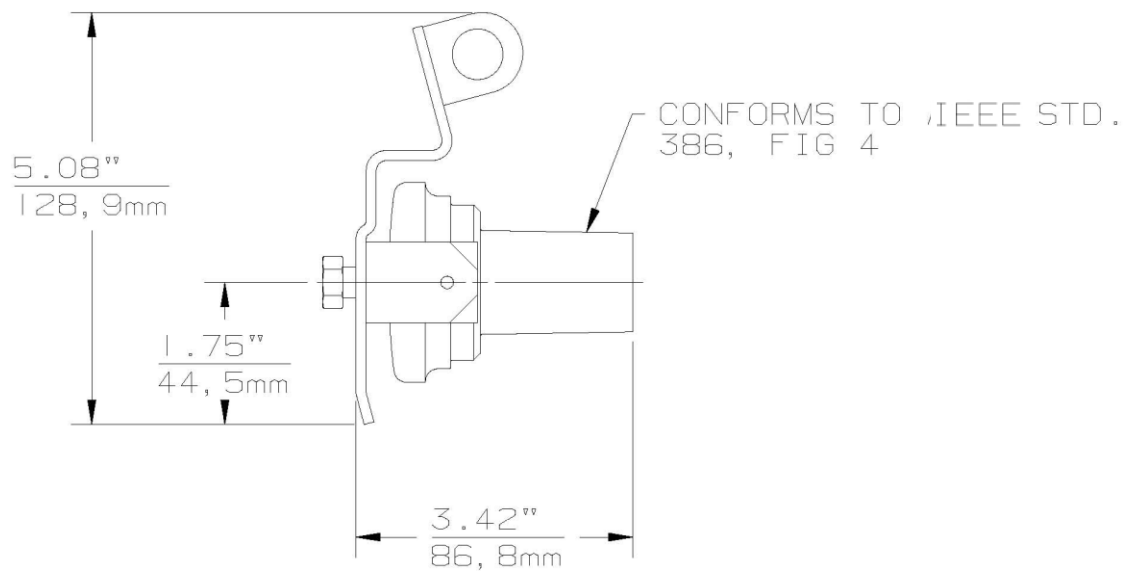

Ordering Instructions:

To order, specify number **K151SOP** insulated parking bushing.

Each kit contains the following:

1	Insulated Cap	K151SOP
1	Lubricant	82-08
1	Installation Instruction	IS-0235
1	Protective shipping cap	180-PPC

Notes:

Balls are required but not included. Order separately.