

Issue Date: 10/11/2012

Page: 1 of 2

File: PSS-376DRG

35kV	200A Loadbreak Insulated Cap	w/ Ground Lead and Insulated Cuff and Test Point	376DRG
------	------------------------------	--	--------



Features:

- 35kV, 200 Amp Loadbreak Rated
- Molded EPDM Rubber
- Includes all brass probe
- Provision for hotstick operation
- Ground lead wire #14 AWG attached
- Insulated cuff for extra protection
- Non-corrosive capacitive test point

376DRG Loadbreak Insulated Cap (with Ground Lead and Insulated Cuff and Test Point)

Applications:

Elastimold® 376DRG insulated caps w/ ground lead and insulated cuff are fully shielded, fully submersible, hot stick operable, separable connectors designed for energized operation. They are suitable for use on 35kV class loadbreak 1Ø and 3Ø systems. The 376DRG has an integral ground lead as part of the assembly, it is used to "dead-end" the following Elastimold® mating products:

- 3701A3/A4 bushing insert
- 373FT feed thru
- 3702A1 feed-thru insert
- 373 series junctions

Ratings:

Meets ANSI/IEEE Standard 386, Latest Revision

For 35kV Voltage Class 1Ø and 3Ø:

21.1kV Max Phase-to-Ground – Operating Voltage
 36.6kV Max Phase-to-Phase
 150kV BIL – Impulse Withstand (1.2 x 50 microsecond wave)
 50kV AC – One minute withstand
 103kV DC – 15 minutes withstand
 26kV AC – Corona Extinction @ 3pC sensitivity
 200 Amp – Continuous and Loadbreak
 10kA Sym – 10 Cycles Momentary & Fault Close

35kV	200A Loadbreak Insulated Cap	w/ Ground Lead and Insulated Cuff and Test Point	376DRG
------	------------------------------	--	--------

MATES WITH BUSHING
INTERFACES THAT
CONFORM TO ANSI
Std 386, Fig 7

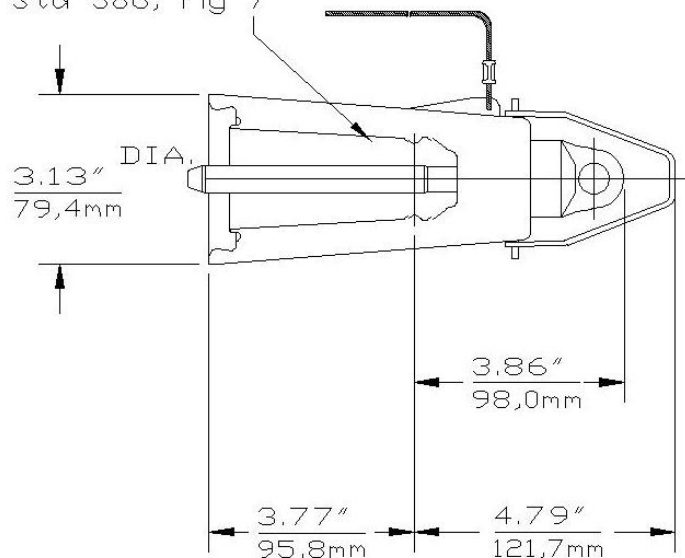

Ordering Instructions:

To order, specify number **376DRG** insulating cap.

Each kit contains the following:

1	Insulated cap	376DRG
1	Lubricant	82-08
1	Installation Instruction	IS-0272

Notes:

- Equipped with insulated cuff.