

Issue Date: 11/12/2012

Page: 1 of 2

File: PSS- K151SR-W0X

15/25kV	200A Deadbreak Straight Receptacle	w/o Test Point	K151SR-W0X
---------	------------------------------------	----------------	------------



Features:

- 15/25kV, 200 Amp Deadbreak Straight Receptacle
- Fully shielded, fully submersible molded rubber housing
- 100% peroxide-cured construction includes insulation and conductive EPDM materials
- Provision for ground wire connection
- Wide cable range with minimum number of sizes

K151SR Deadbreak Straight Receptacle

Applications:

The Elastimold® K151SR Straight Receptacle is a fully shielded, fully submersible, separable insulated connector designed to connect a cable to another cable or apparatus. They require the use of an appropriate Elastimold® mating product installed on the other cable or apparatus. The disconnectible feature can be used only when the circuit is de-energized. The K151SR is suitable for use on both 15 and 25kV systems. The K151SR is designed to terminate UD cable having concentric neutral and extruded insulation shielding. It can be used to terminate other types of cable when installed with the proper Elastimold® cable shield adapter. The K151SR will accommodate conductor sizes of No. 4 solid through 4/0 stranded and cable insulation diameters from .575" through 1.220".

Ratings:

Meets ANSI/IEEE Standard 386, Latest Revision

For 15kV Voltage Class:

8.3kV Max Phase-to-Ground – Operating Voltage
14.4kV Max Phase-to-Phase
95kV BIL – Impulse Withstand (1.2 x 50 microsecond wave)
34kV AC – One minute withstand
53kV DC – 15 minutes withstand
11kV AC – Corona Extinction @ 3pC sensitivity
200 Amp – Continuous
10kA Sym – 10 Cycles Momentary

For 25kV Voltage Class:

15.2kV Max Phase-to-Ground – Operating Voltage
26.3kV Max Phase-to-Phase
125kV BIL – Impulse Withstand (1.2 x 50 microsecond wave)
40kV AC – One minute withstand
78kV DC – 15 minutes withstand
19kV AC – Corona Extinction @ 3pC sensitivity
200 Amp – Continuous
10kA Sym – 10 Cycles Momentary

15/25kV	200A Deadbreak Straight Receptacle	w/o Test Point	K151SR-W0X
---------	------------------------------------	----------------	------------

CATALOG NUMBER SELECTION

Step 1 (W)

Determine the insulation diameter of the cable.

Select the insulation letter code that best straddles the insulation diameter from W table below. Insert code into catalog number.

Step 2

Insert conductor material code from the Material Code table.

Step 3 (X)

Choose the proper compression lug code according to the conductor size from the Conductor Code Table. Insert code into catalog number.

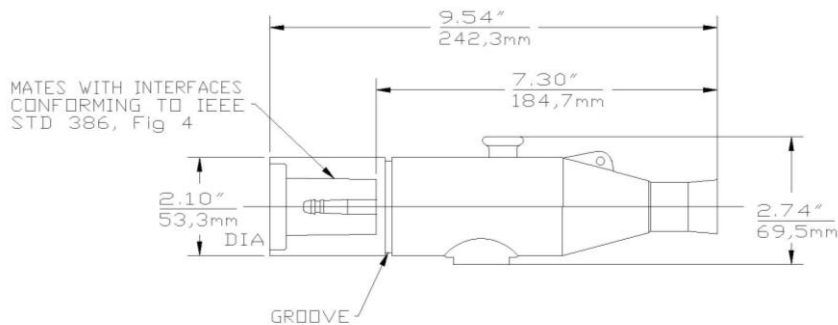

Aluminum	0
Copper*	2

K151SR

W Code

XXX Code

Example:

The ordering number for a straight receptacle for a 1/0 stranded, 175 mil wall cable with a minimum insulation diameter of .725" and a maximum of .810" is K151SR-B0240.

Cable Insulation Diameter in inches		Cable Insulation Diameter in millimeters		Symbol for W
MIN.	MAX.	MIN.	MAX.	
0.575	0.740	14.605	18.796	A
0.635	0.905	16.129	22.987	B
0.805	1.060	20.447	26.924	C
0.890	1.220	22.606	30.988	D

X Code	Conductor Size AWG or kcmil			Connector Only	
	Strand. / Compr.	Solid/ Compact	mm ²	Bi-Metal	Copper*
190		#4	16.76	01500190	01502190
200	#4	#3	21.14	01500200	01502200
210	#3	#2	26.67	01500210	01502210
220	#2	#1	33.62	01500220	01502220
230	#1	1/0	42.41	01500230	01502230
240	1/0	2/0	53.49	01500240	01502240
250	2/0	3/0	67.43	01500250	01502250
260	3/0	4/0	85.01	01500260	01502260
270	4/0	250	26.67	01500270	01502270

Each kit contains the following:

1	Straight Recep. Housing	K151BSR-W
1	Receptacle pin connector	01500XXX
1	Tube, lubricant	82-08
1	Installation instruction	IS-0060
1	Crimp chart	CC-0023

Notes:

* Copper compression lug suitable for all copper conductors only.