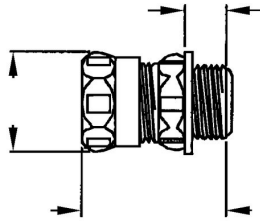

**EMT COMPRESSION CONNECTORS**

Compression Connectors, Steel

B05

Catalog #: 2916

APPLICATIONS

For use to bond EMT conduit to a box or enclosure.
 RACO Compression connectors are suitable for applications above 600V.

PRODUCT FEATURES

1/2 in. to 4 in. connectors provide concrete-tight connections
 All steel construction ensures mechanical protection for the raceway
 All components are zinc electroplated for corrosion protection
 UPC bar coded fittings are individually polybagged with a preprinted UPC-A bar code, and packaged in pre-scored tear top cartons for an attractive presentation.

CULUS

Standard 514B, UL Listed E195970, C22.2 No. 1

COMPLIANCES

MSDS
www.hubbell-rtb.com/certifications/Hubbell-RACO_MSDS_for_WP_Boxes_and_Fittings,January_2015.pdf

GENERAL PRODUCT INFORMATION

Sub Class: Insulated
 Trade Size: 1-1/2 in.

DRAWING DIMENSIONS

Dimension A: 2.25 in.
 Dimension B: .70 in.
 Dimension C: 2.27 in.

PACKAGING

Package Type: Carton
 Ship Carton Qty.: 20
 Product UPC-A Labeled: No
 Weight (Lbs. Per/C): 47.60
 Ship Carton Length (in.): 11.50
 Ship Carton Width (in.): 6.63
 Ship Carton Height (in.): 5.06
 Ctn Weight (Lbs.): 9.52
 UPC Number: 050169029169
 I2of5: 50050169029164