

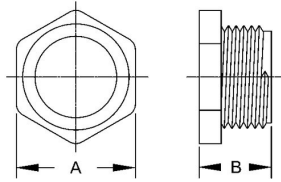

**NIPPLES**

Uninsulated Chase Nipples Die Cast Zinc  
N/A

**B90**



Catalog #: 1670

**APPLICATIONS**

For use with a conduit coupling to connect conduit to a box, or with a locknut to connect two boxes.  
N/A

**PRODUCT FEATURES**

Rugged metallic construction

**UL LISTED**

Standard 514B, File E195969

**CSA**

C22.2 No. 18

**GENERAL PRODUCT INFORMATION**

Trade Size: 2-1/2 in.

**DRAWING DIMENSIONS**

Dimension A: 3-7/32 in.

Dimension B: 1-7/16 in.

**PACKAGING**

Package Type:	Carton
Std. Pkg.:	10
Ship Carton Qty.:	40
Product UPC-A Labeled:	No
Weight (Lbs. Per/C):	41.20
Ship Carton Length (in.):	24.21
Ship Carton Width (in.):	11.14
Ship Carton Height (in.):	6.29
Ctn Weight (Lbs.):	16.48
UPC Number:	050169016701
I2of5:	50050169016706