

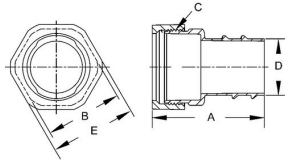

COMBINATION COUPLINGS - DIE CAST ZINC

Flex to EMT Couplings, Screw-in/Compression Die Cast Zinc
N/A

B67



Catalog #: 1483

APPLICATIONS

Use RACO catalog numbers 1941 to 1943, or 1482 to 1484 when coupling flexible metal conduit to EMT
N/A

PRODUCT FEATURES

Rugged metallic construction insures mechanical protection

UL LISTED

File E195969

GENERAL PRODUCT INFORMATION

Trade Size: 3/4 in.

DRAWING DIMENSIONS

Dimension A:	1-51/64 in.
Dimension B:	1-1/8 in.
Thread Spec. C:	1-5/64 in. - 18 UNS
Dimension D:	13/16 in.
Dimension E:	1-7/32 in.

PACKAGING

Package Type:	Carton
Std. Pkg.:	25
Ship Carton Qty.:	250
Product UPC-A Labeled:	No
Weight (Lbs. Per/C):	11.00
Ship Carton Length (in.):	19.00
Ship Carton Width (in.):	10.62
Ship Carton Height (in.):	5.31
Ctn Weight (Lbs.):	27.50
UPC Number:	050169014837
I2of5:	50050169014832