

Contents:

- 1 - Panel
- 4 - #12-24 mounting screws
- 4 - M6 mounting screws
- 2 - Trilobular #12-24 grounding screws
- 2 - Trilobular M6 grounding screws

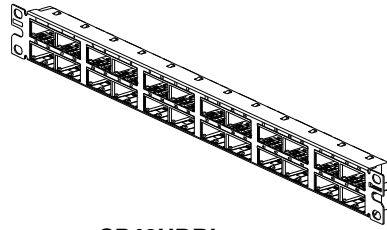

CP48HDBL

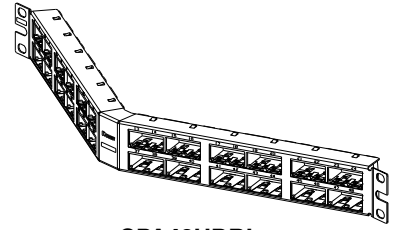

CPA48HDBL

Note: Rear mounted faceplates are not intended for removal.

Module Installation

1.

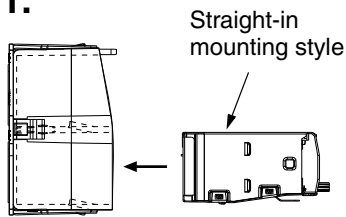

IMPORTANT: Module must be oriented properly.

2.

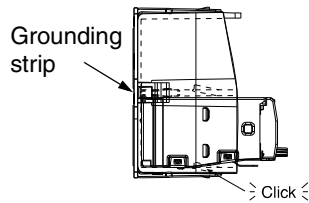

Module Removal (screwdriver required)

3.

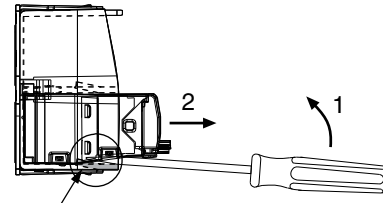

Release tab

4.

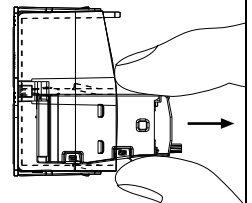

Straight pull removal of module

Grounding Options

Use 1 to 2 included #12-24 or M6 trilobular grounding screws to properly ground the panel to the rack.

Trilobular grounding screw(s) can be installed in place of a mounting screw or in the slot in between on either side of the panel.

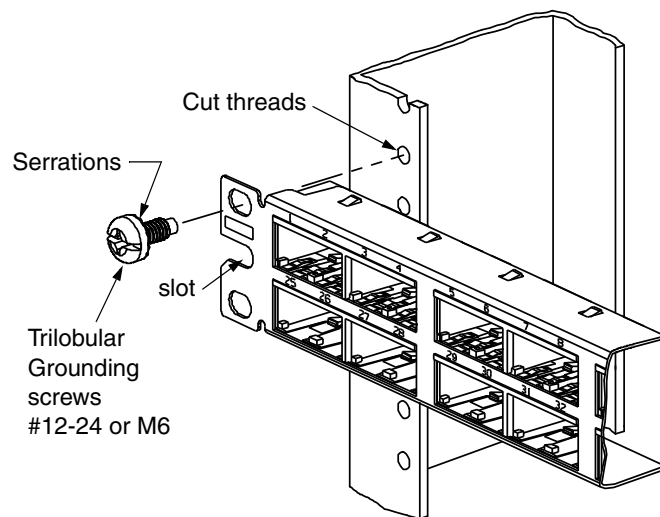

For Instructions in Local Languages and Technical Support:

www.panduit.com/resources/install_maintain.asp

PANDUIT

www.panduit.com

E-mail: techsupport@panduit.com

Phone: 866-405-6654