

---

 TECHNICAL DATA SHEET

# Conduit bodies and covers

## Form 9 Aluminum

### T&B® Fittings

The T&B® Fitting form 9 sand case aluminum conduit bodies



01



02



03

#### Certifications / Standards:



01 Conduit body  
02 Cover  
03 Gasket

#### Features:

- Tapered (NPT) threads and integral bushings to protect wire insulation
- Bodies and Covers are interchangeable with other manufacturers' form 9 bodies and covers (Mark 9, FM 9)

#### Applications:

##### Conduit bodies are installed in conduit systems to:

- Connect conduit sections
- Act as pull outlets when conductors are being installed
- Provide easy access for splices in branch conductors
- Make 90° bends in conduit runs
- Provide access to conductors for maintenance and future system changes

#### Conforms to:

- UL514B
- C22.2 No. 18
- Suitable for wet locations when used with gasket

#### Materials / Finishes:

- Bodies: sand-cast copper-free aluminum alloy natural finish
- Covers: copper-free sheet aluminum stamped finish
- Gaskets: neoprene
- Screws: stainless steel

## Conduit bodies

### Form 9 aluminum

- Product selection tables

#### Product selection

Drawing (dimensions shown are +/- 0.020)

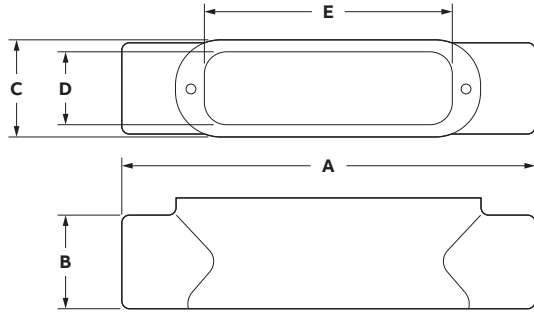

Part no:	Hub size	A	B	C	D	E	Cu. in.
C19SA	½"	5.858"	1.500"	1.392"	1.018"	3.307"	4.5
C29SA	¾"	6.480"	1.780"	1.560"	1.186"	3.898"	7.5
C39SA	1"	7.578"	1.975"	1.756"	1.382"	4.559"	11.5
C49SA	1¼"	8.593"	2.315"	2.200"	1.826"	5.197"	22.3
C59SA	1½"	9.238"	2.800"	2.500"	1.788"	5.892"	34.0
C69SA	2"	11.578"	3.560"	3.189"	2.349"	8.110"	80.0
C789SA	2½"	15.522"	4.575"	5.040"	4.290"	10.827"	212.0
C889SA	3"	15.680"	4.575"	5.040"	4.290"	10.827"	216.0
C989SA	3½"	18.452"	5.535"	6.338"	5.538"	13.438"	408.0
C1089SA	4"	18.498"	5.535"	6.339"	5.538"	13.438"	440.0

Note: Product must be installed in accordance with applicable national and local electrical codes.

#### Product selection

Drawing (dimensions shown are +/- 0.020)

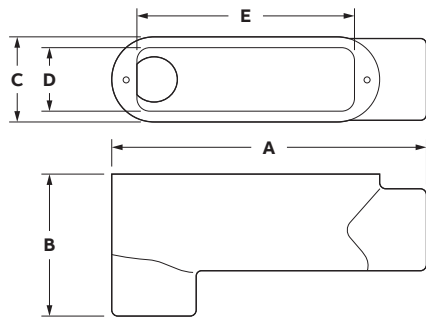

Part no:	Hub size	A	B	C	D	E	Cu. in.
LB19SA	½"	5.034"	2.231"	1.392"	1.018"	3.307"	4.5
LB29SA	¾"	5.640"	2.620"	1.560"	1.186"	3.898"	7.5
LB39SA	1"	6.569"	2.984"	1.756"	1.382"	4.550"	11.5
LB49SA	1¼"	7.767"	3.344"	2.200"	1.826"	5.197"	22.3
LB59SA	1½"	8.209"	3.829"	2.500"	2.100"	5.906"	34.0
LB69SA	2"	10.533"	4.605"	3.228"	2.388"	7.941"	80.0
LB789SA	2½"	13.961"	6.011"	5.040"	4.290"	10.827"	212.0
LB889SA	3"	14.040"	6.215"	5.040"	4.290"	10.827"	216.0
LB989SA	3½"	16.751"	7.236"	6.339"	5.576"	13.437"	408.0
LB1089SA	4"	16.774"	7.259"	6.339"	5.573"	13.438"	440.0

Note: Product must be installed in accordance with applicable national and local electrical codes.

#### Product selection

Drawing (dimensions shown are +/- 0.020)

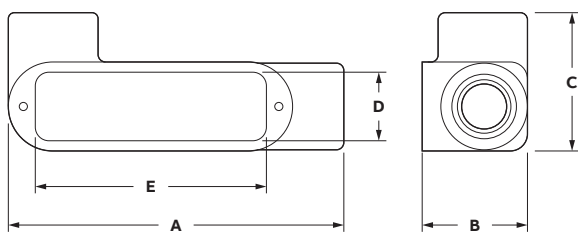

Part no:	Hub size	A	B	C	D	E	Cu. in.
LL19SA	½"	5.034"	1.500"	2.213"	1.018"	3.280"	4.5
LL29SA	¾"	5.640"	1.780"	2.400"	1.186"	3.898"	7.5
LL39SA	1"	6.569"	1.975"	2.765"	1.382"	4.550"	11.5
LL49SA	1¼"	7.564"	2.315"	3.229"	1.826"	5.197"	22.3
LL59SA	1½"	8.591"	2.800"	3.529"	2.126"	5.906"	34.0
LL69SA	2"	10.714"	3.560"	4.234"	2.349"	8.110"	80.0
LL789SA	2½"	13.961"	4.575"	6.601"	4.290"	10.827"	212.0
LL889SA	3"	14.040"	4.575"	6.680"	4.290"	10.827"	216.0
LL989SA	3½"	16.563"	5.535"	8.040"	5.577"	13.437"	408.0
LL1089SA	4"	16.774"	5.535"	8.063"	5.577"	13.438"	440.0

Note: Product must be installed in accordance with applicable national and local electrical codes.

## Conduit bodies

### Form 9 aluminum

- Product selection tables

#### Product selection

Drawing (dimensions shown are +/- 0.020)

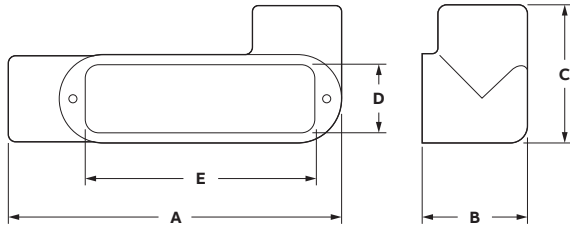

Part no:	Hub size	A	B	C	D	E	Cu. in.
LR19SA	½"	5.034"	1.500"	2.213"	1.018"	3.280"	4.5
LR29SA	¾"	5.640"	1.780"	2.400"	1.186"	3.898"	7.5
LR39SA	1"	6.569"	1.975"	2.765"	1.382"	4.550"	11.5
LR49SA	1¼"	7.564"	2.315"	3.229"	1.826"	5.197"	22.3
LR59SA	1½"	8.591"	2.800"	3.529"	2.126"	5.906"	34.0
LR69SA	2"	10.714"	3.560"	4.234"	2.349"	8.110"	80.0
LR789SA	2½"	13.961"	4.575"	6.601"	4.290"	10.827"	212.0
LR889SA	3"	14.040"	4.575"	6.680"	4.290"	10.827"	216.0
LR989SA	3½"	16.563"	5.535"	8.040"	5.577"	13.437"	408.0
LR1089SA	4"	16.774"	5.535"	8.063"	5.577"	13.438"	440.0

Note: Product must be installed in accordance with applicable national and local electrical codes.

#### Product selection

Drawing (dimensions shown are +/- 0.020)

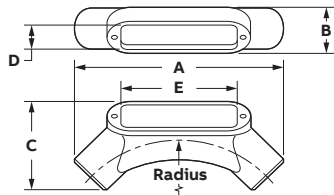

Part no:	Hub size	A	B	C	D	E	Radius	Cu. in.
LU19SA	½"	6.210"	2.701"	1.500"	1.018"	3.280"	4.415"	5.3
LU29SA	¾"	6.970"	3.047"	1.698"	1.186"	3.898"	4.920"	8.0
LU39SA	1"	8.276"	3.651"	2.020"	1.445"	4.559"	6.143"	14.0
LU49SA	1¼"	9.902"	4.266"	2.362"	1.826"	5.290"	7.666"	30.8
LU59SA	1½"	10.256"	5.127"	2.609"	2.126"	5.906"	8.214"	41.0
LU69SA	2"	13.968"	6.153"	3.421"	2.815"	7.941"	8.500"	97.0

Note: Product must be installed in accordance with applicable national and local electrical codes.

#### Product selection

Drawing (dimensions shown are +/- 0.020)

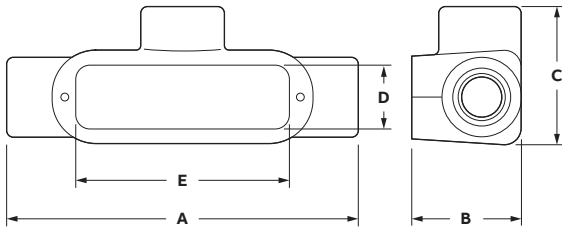

Part no:	Hub size	A	B	C	D	E	Cu. in.
T19SA	½"	5.958"	1.775"	2.393"	1.078"	3.307"	6.3
T29SA	¾"	6.455"	2.000"	2.591"	1.185"	3.925"	9.3
T39SA	1"	7.578"	2.275"	2.765"	1.382"	4.559"	14.0
T49SA	1¼"	8.593"	2.315"	3.229"	1.826"	5.197"	22.0
T59SA	1½"	9.243"	2.800"	3.529"	2.126"	5.906"	34.8
T69SA	2"	11.578"	3.560"	4.234"	2.815"	8.110"	80.5
T789SA	2½"	15.522"	4.575"	6.601"	4.250"	10.827"	175.0
T889SA	3"	15.680"	4.575"	6.680"	4.250"	10.827"	236.0
T989SA	3½"	18.452"	5.535"	8.040"	5.539"	13.437"	435.0
T1089SA	4"	18.498"	5.535"	8.063"	5.539"	13.438"	450.0

Note: Product must be installed in accordance with applicable national and local electrical codes.

#### Product selection

Drawing (dimensions shown are +/- 0.020)

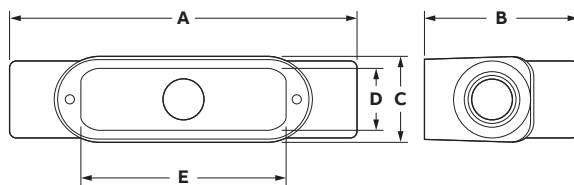

Part no:	Hub size	A	B	C	D	E	Cu. in.
TB19SA	½"	5.958"	2.596"	1.556"	1.018"	3.307"	6.3
TB29SA	¾"	6.600"	2.840"	1.715"	1.186"	3.898"	9.3
TB39SA	1"	7.644"	3.284"	1.756"	1.382"	4.559"	14.0
TB49SA	1¼"	8.788"	3.344"	2.200"	1.826"	5.197"	22.0
TB59SA	1½"	9.996"	3.604"	2.500"	1.784"	5.883"	34.8
TB69SA	2"	11.578"	4.605"	3.189"	2.815"	8.110"	80.5

Note: Product must be installed in accordance with applicable national and local electrical codes.

## Conduit bodies

### Form 9 aluminum

- Product selection tables

#### Product selection

Drawing (dimensions shown are +/- 0.020)

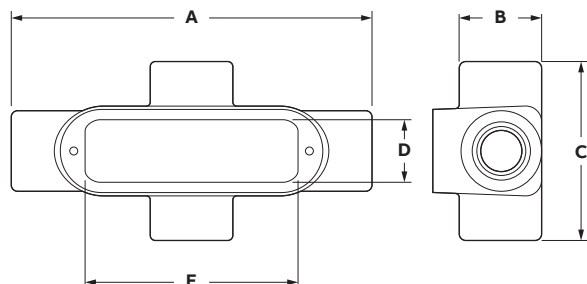

Part no:	Hub size	A	B	C	D	E	Cu. in.
X19SA	½"	5.958"	1.775"	3.094"	1.018"	3.280"	6.3
X29SA	¾"	6.610"	2.000"	3.370"	1.186"	3.898"	9.3
X39SA	1"	7.578"	2.275"	3.774"	1.382"	4.559"	14.0

Note: Product must be installed in accordance with applicable national and local electrical codes.

## Covers

- Product selection tables

#### Product selection

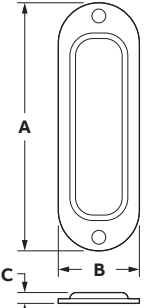
Drawing	Part no:	Hub size	A	B	C
	190SA**	½"	4.213"	1.392"	0.225"
	290SA**	¾"	4.800"	1.560"	0.225"
	390SA**	1"	5.560"	1.756"	0.225"
	490SA**	1¼"	6.535"	2.200"	0.225"
	590SA**	1½"	7.180"	2.500"	0.350"
	690SA**	2"	9.488"	3.189"	0.400"
	889SA	2½"	12.400"	5.040"	0.665"
		3"			
	989SA	3½"	15.050"	6.339"	0.760"
		4"			

Note: Product must be installed in accordance with applicable national and local electrical codes.

Dimension shown are +/- 0.020

## Gasket

- Product selection tables

#### Product selection

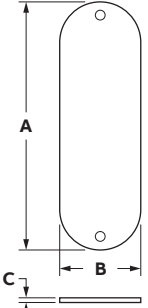
Drawing	Part no:	Hub size	A	B	C
	GASK1941	½"	4.213"	1.392"	0.0600"
	GASK1942	¾"	4.800"	1.560"	0.0600"
	GASK1943	1"	5.56"	1.756"	0.0600"
	GASK1944	1¼"	6.535"	2.200"	0.0600"
	GASK1945	1½"	7.180"	2.500"	0.0600"
	GASK1946	2"	9.488"	3.189"	0.0600"
	GASK808N	2½"	12.400"	5.040"	0.0600"
		3"			
	GASK809N	3½"	15.050"	6.339"	0.0600"
		4"			

Note: Product must be installed in accordance with applicable national and local electrical codes.

Dimension shown are +/- 0.020