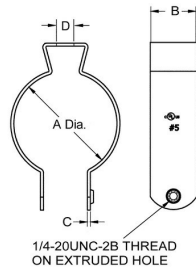
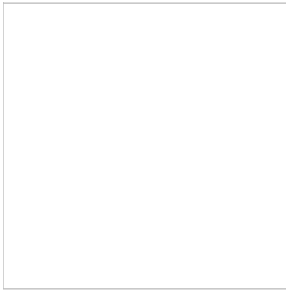

**CONDUIT HANGERS****Conduit Hangers with Threaded Hole, Steel**  
N/A**B84**

Catalog #: 2041TH

**APPLICATIONS**For use in wet or dry locations to support runs of rigid/IMC and EMT conduit from ceilings and walls  
N/A**PRODUCT FEATURES**Hangers are supplied with a retained bolt and threaded hole eliminating the need for a nut  
The design allows for quick and easy installation using a screwdriver or nut driver  
Pregalvanized finish provides corrosion protection**CULUS**

UL Listed E195968

**GENERAL PRODUCT INFORMATION**Trade Size: 2-1/2  
EMT Size: 1-1/4 in.  
Max Load Lbs.: 75**DRAWING DIMENSIONS**Dimension A: 1.52 in.  
Dimension B: .88 in.  
Dimension C: .055 - .062 in.  
Dimension D: .26 in.**PACKAGING**Package Type: Carton  
Ship Carton Qty.: 100  
Product UPC-A Labeled: No  
Weight (Lbs. Per/C): 10.20  
Ship Carton Length (in.): 10.40  
Ship Carton Width (in.): 10.40  
Ship Carton Height (in.): 4.80  
Ctn Weight (Lbs.): 10.60  
UPC Number: 050169911938  
I2of5: 50050169911933