

Raceway Channel	See Fig.	Electrical Cables			Data Grade Cables					
		14	12	10	24 AWG	24 AWG	24 AWG	24 AWG	24 AWG	24 AWG
		THN/THWN/T90			Cat 6	Cat 6A	Cat 6A (SD)	Cat 6A (SD)	Cat 6A (SD)	Cat 6A (SD)
		0.111	0.13	0.164	0.24	0.3	0.24	0.24	0.24	0.24
		Fill			Fill	Fill	Fill	Fill	Fill	Fill
		Max	Max	Max	Spec	Max	Spec	Max	Spec	Max
		UL Temp Rise Test			40%	60%	40%	60%	40%	60%
Outer Channels (with screws installed)	A	21	15	10	3	4	2	3	3	4
Inner Channels	B	24	17	11	3	5	2	3	3	5

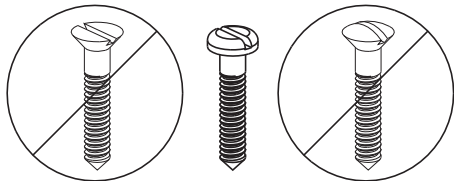

The mounting hardware used to secure the raceway shall be appropriate for the mounting surface.

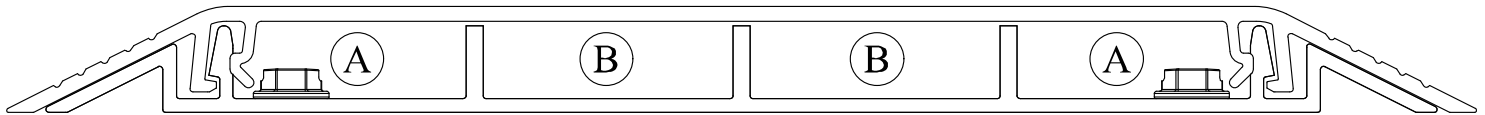

Screws provided with raceway are intended for installation on a concrete surface.

NOTES:

- An adhesive strip may serve only as a positioning aid during the installation process. The raceway shall be secured by mechanical fastening means.
- Holes for mounting raceway and associated fittings should be predrilled into infrastructure prior to the installation of the mounting hardware.
- A 5/32" concrete drill bit is needed for the provided concrete screws.

BASE & COVER

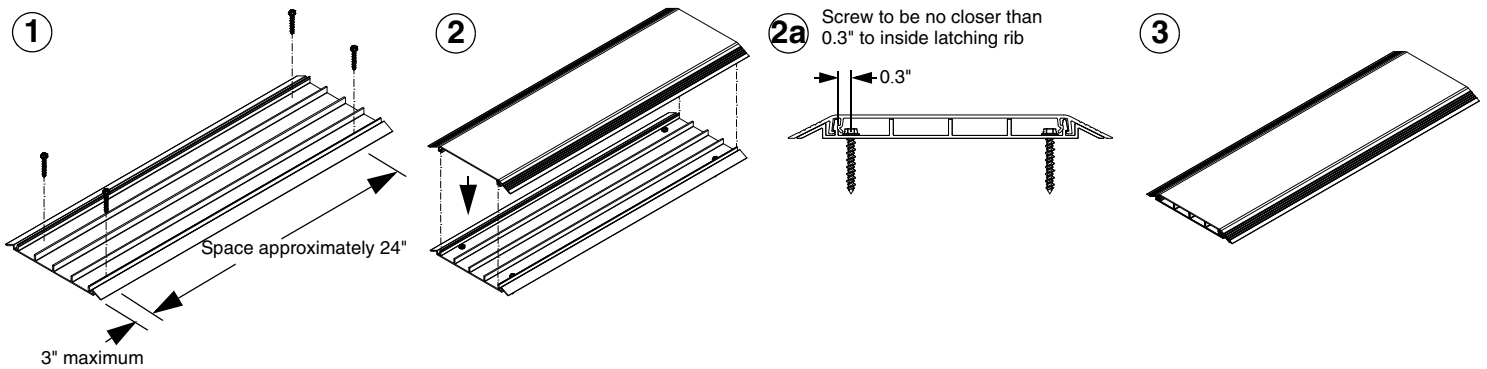

COUPLER

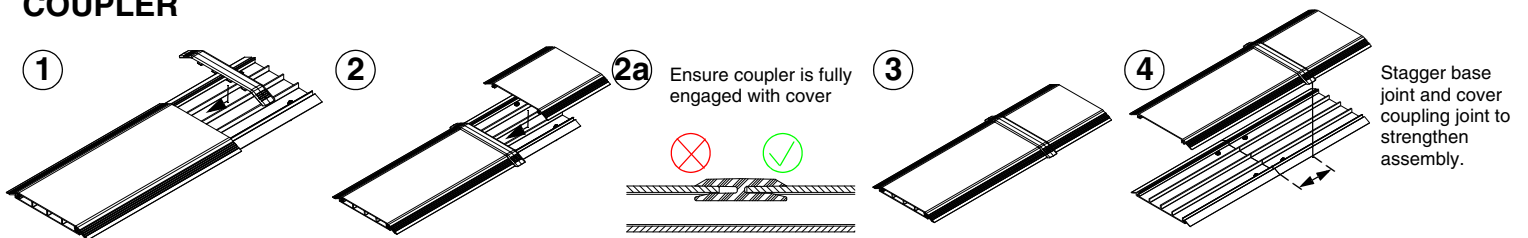

RIGHT ANGLE

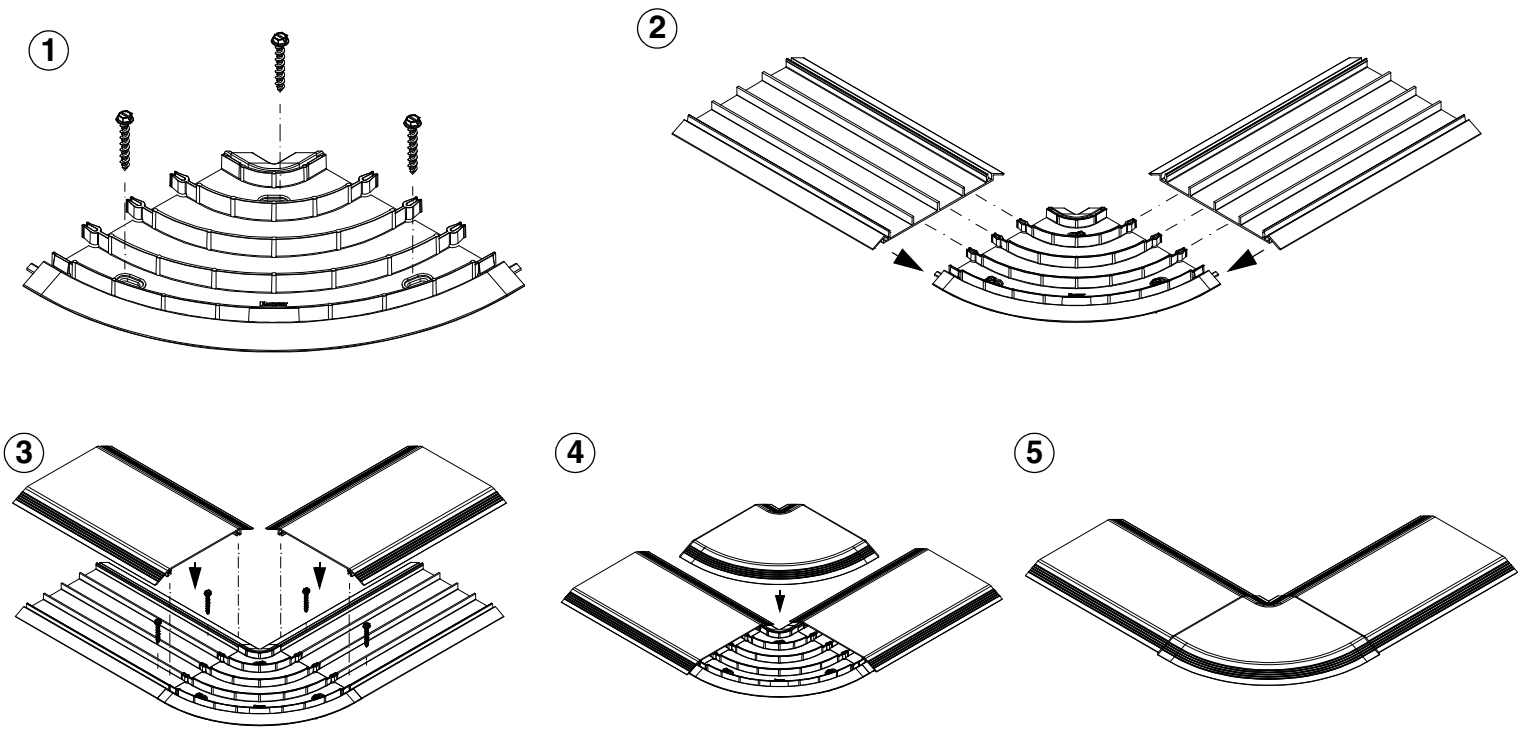

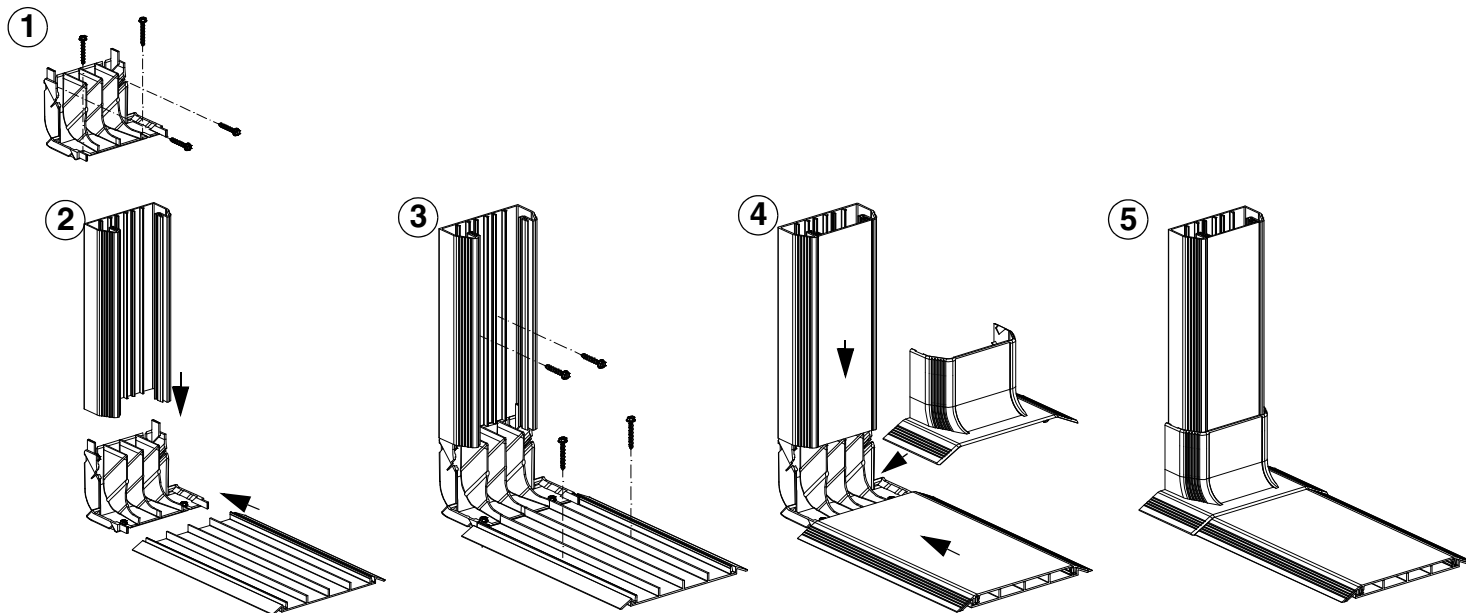
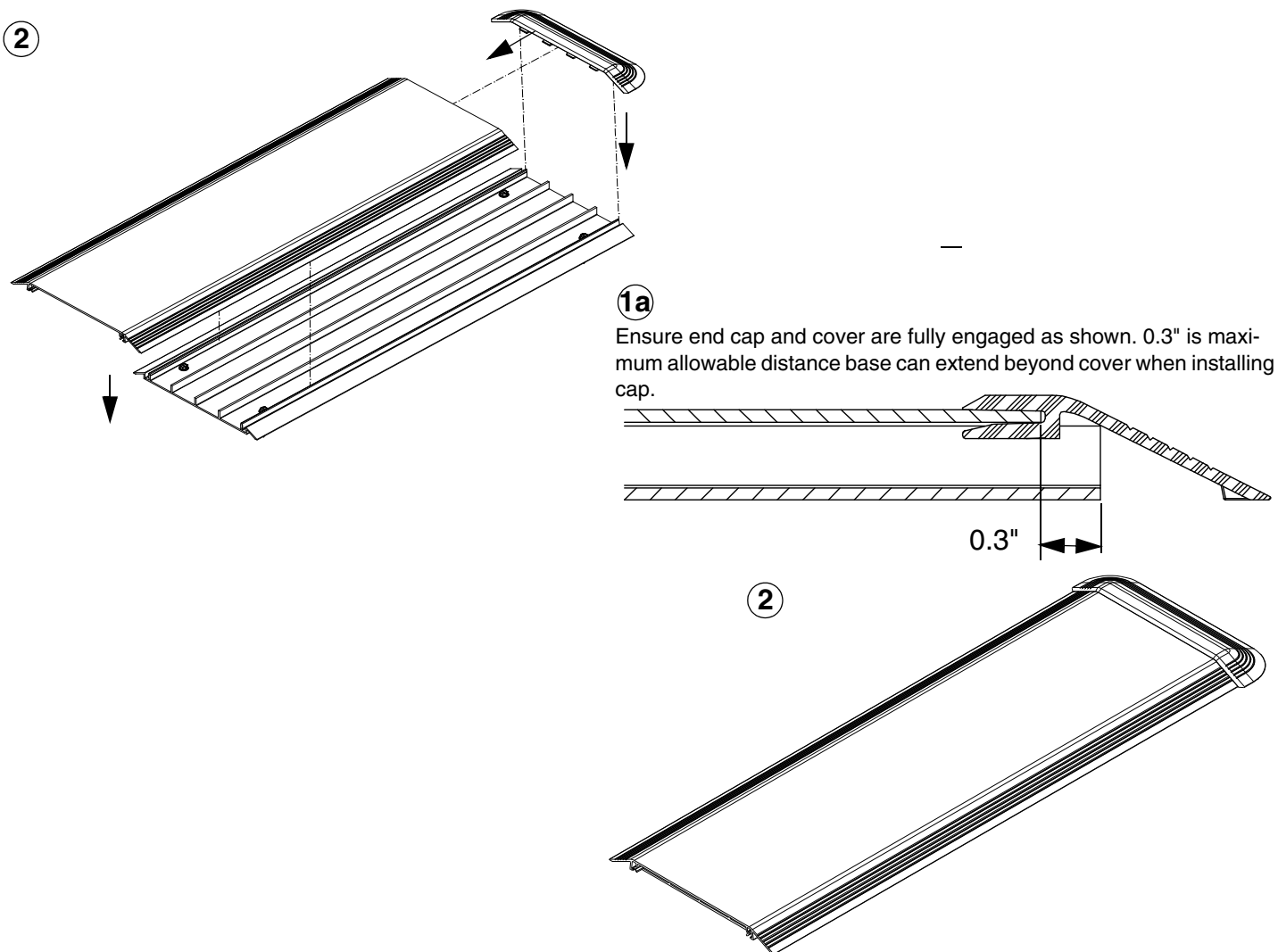
TRANSITION TO T70**END CAP**

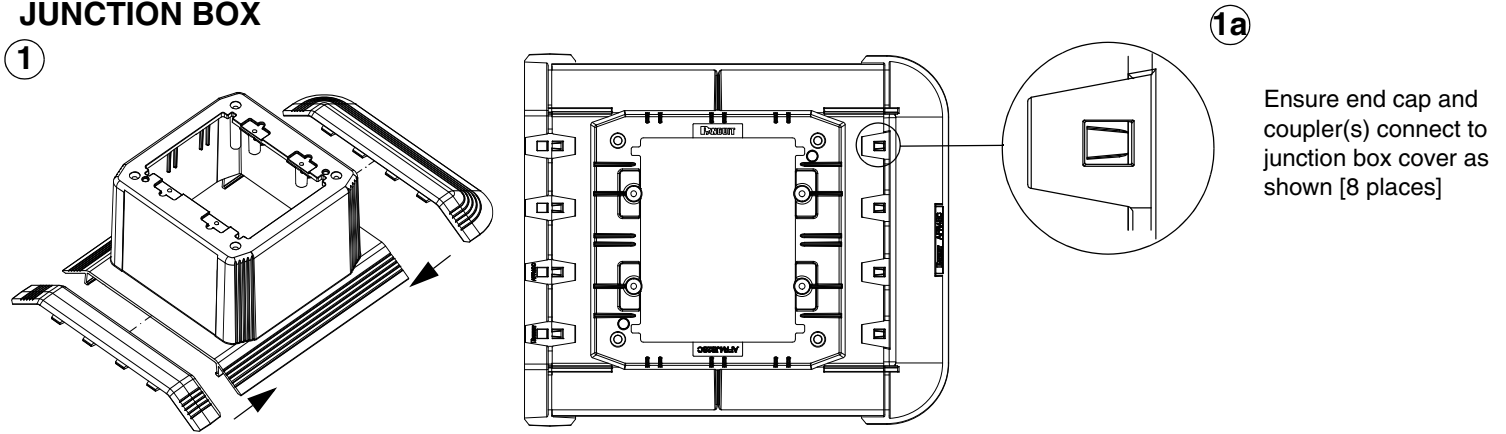
JUNCTION BOX

Note: Junction Box can be assembled between two raceway paths with the use of two coupler fittings. End cap installation shown as reference.

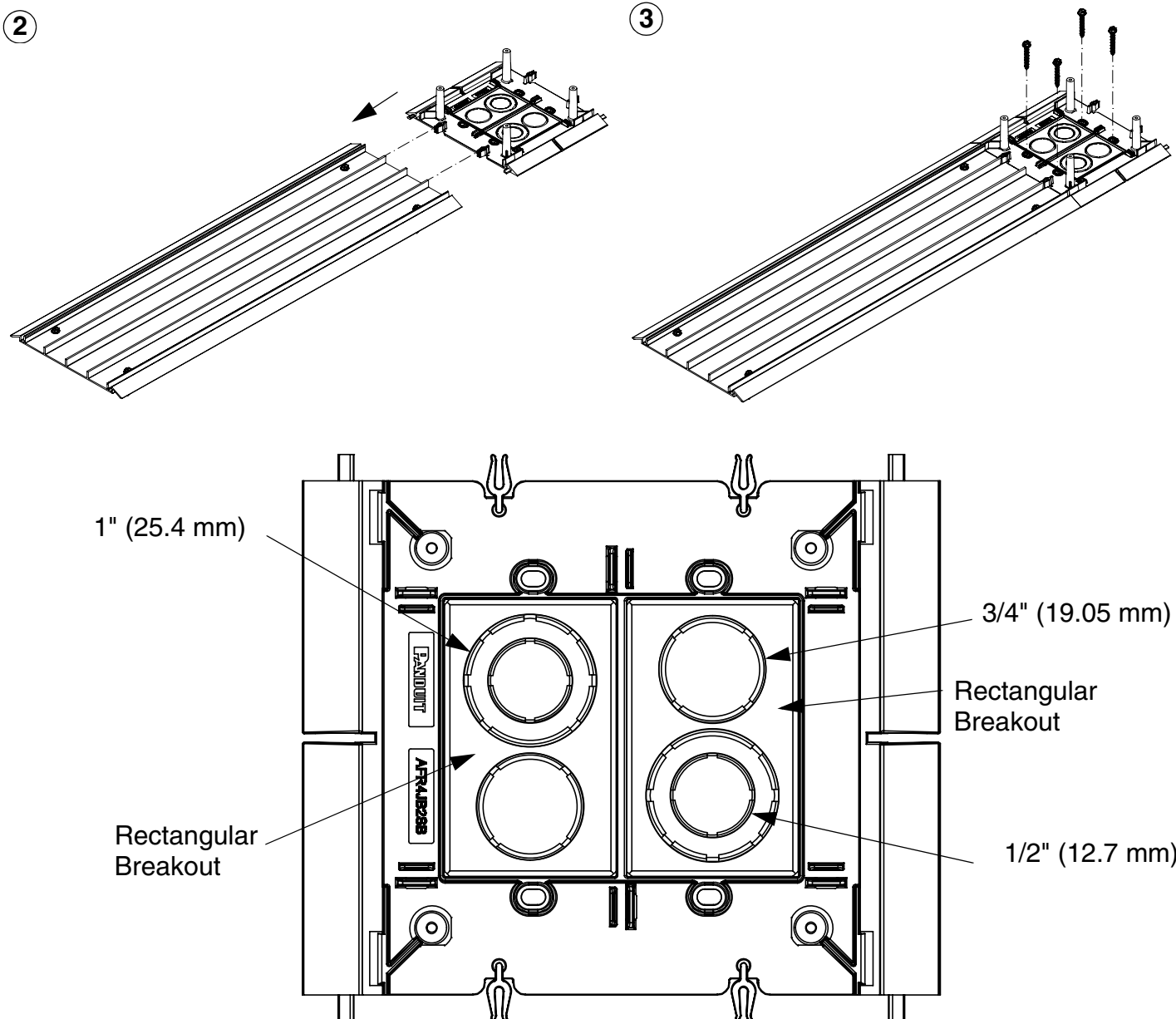

Breakouts for conduit applications

DIVIDED INSERT APPLICATION

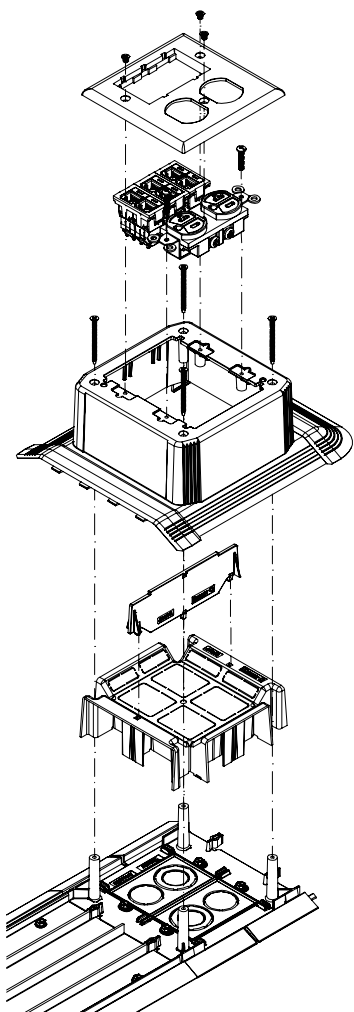

POWER/DATA APPLICATION

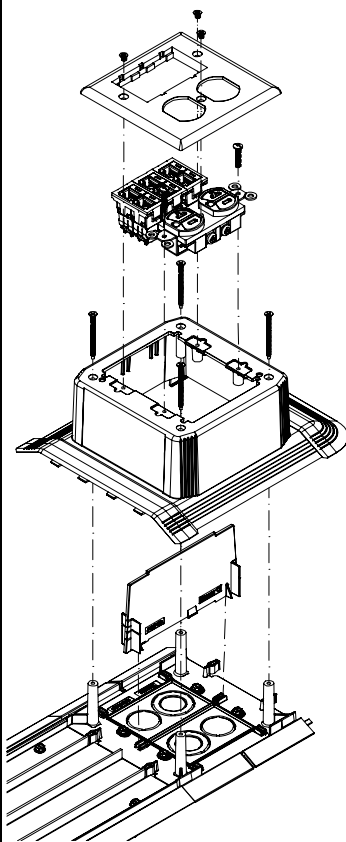

DATA APPLICATION

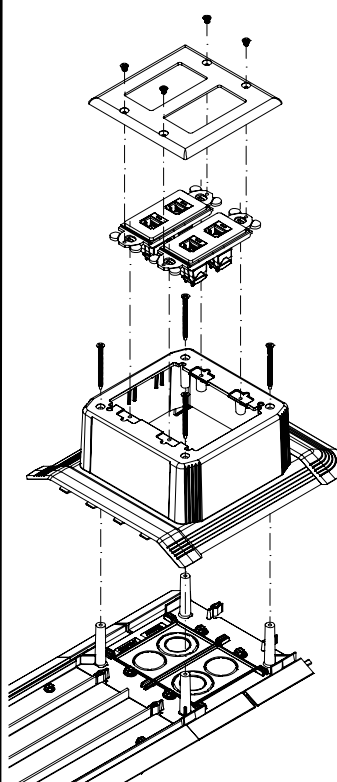

POWER APPLICATION

4

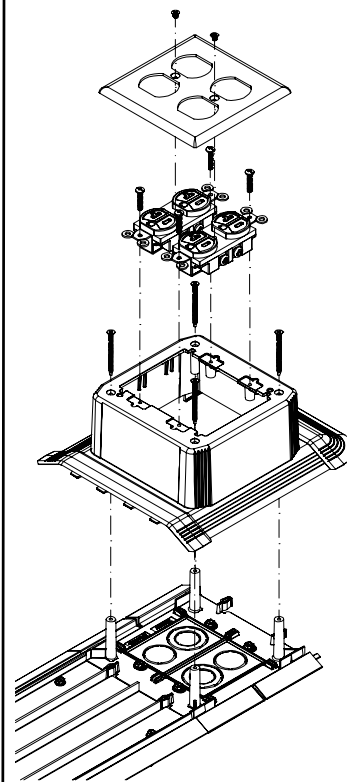

5

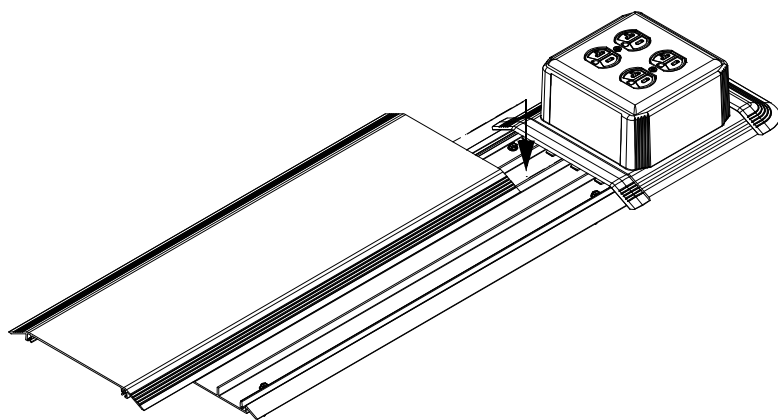

6

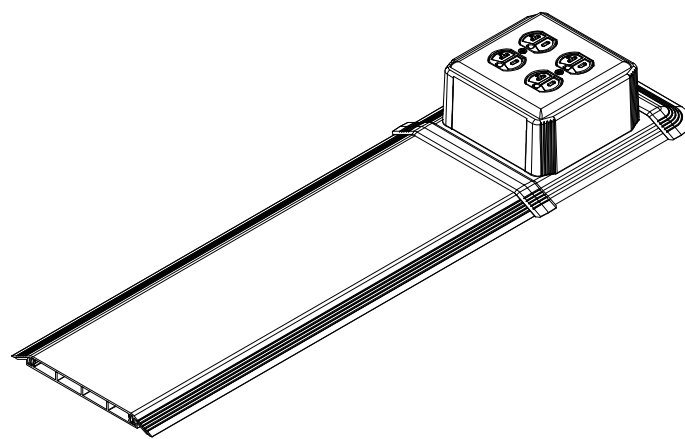

For Instructions in Local Languages
and Technical Support:

www.panduit.com/resources/install_maintain.asp

PANDUIT
www.panduit.com

E-mail:
techsupport@panduit.com

Phone:
866-405-6654