

THIS COPY IS PROVIDED ON A RESTRICTED BASIS AND IS NOT TO BE USED IN ANY WAY DETRIMENTAL TO THE INTERESTS OF PANDUIT CORP.

PART NUMBER	TAB SIZE	WIRE RANGE AWG	DIMENSIONS in.		
			A ^{±.03}	B ^{±.02}	C ^{±.02}
D10-250C	.250 X .032 (6.4 X 0.81)	12-10	.720 (18.29)	.30 (7.62)	.12 (3.05)

NOTES:

- 302° F (150° C) MAX TEMPERATURE RATING. STRANDED COPPER WIRE ONLY.
- MATERIAL:
A. STAMPING: CDA-260 BRASS, TIN PLATED
- DIMENSIONS IN BRACKETS ARE IN MILLIMETERS.
- WIRE STRIP LENGTH $9/32^{+1/32}_{-0}$ (7.1^{+0.8}₋₀)
- PACKAGE QUANTITY: -L = 50
-D = 500
- INSTALLATION TOOLS: CT-100, CT-160, CT-200, CT-260, CT-570, CT-1570, CT-2457CH

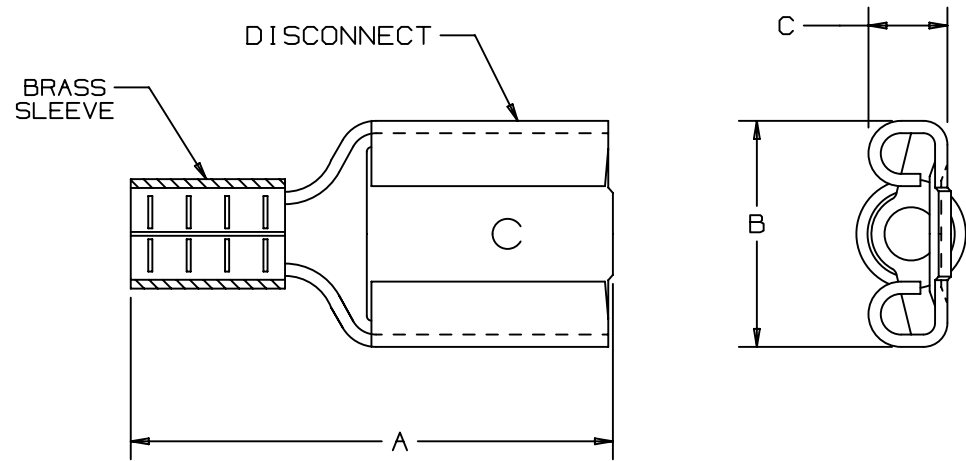

A41731_00

PANDUIT CORP.

TINLEY PARK, ILLINOIS

NON-INSULATED, SLEEVED BARREL
FEMALE DISCONNECT FOR COMPRESSOR TABS
D10-250 SERIES

REV	DATE	BY	CHK	DESCRIPTION	ECN #	PM	CUST	DRAWN BY	CHK'D	SCALE	DRAWING NO./CAD FILENAME
00	12/05	DAW		RELEASED	TRO0060			DAW		NONE	A41731