

# Cable Connectors

For Armored Cable, Flexible Metal Conduit, Interlocked AC-38 Cables, NM and SE Cable

**NEC/CEC:**  
Listed for Ordinary Locations

## Applications

- To ground and secure Armored Cable, Flexible Metal Conduit and Interlocked Metal Clad Cables to boxes and enclosures.
- To secure NM and SE Cables to boxes and enclosures.

## Features

- Available with insulated throats.
- Male hub threads — NPS.
- All center stopped.
- Provided with locknuts.

## Standard Materials

- Malleable iron

## Standard Finishes

- Zinc electroplated

## NEC/CEC Certifications and Compliances

- KC-50, KC-50T, KC-51 UL Listed for metal clad, armored cable, flexible metal conduit, sheathed cable, SE cable: E-11852
- KC-75, KC-75T, KC-76 UL Listed for, armored cable, flexible metal conduit, sheathed cable, SE cable: E-11852
- KC-100, KC-100T, KC-125, KC-125T UL Listed for flexible metal conduit: E-11853
- KC-100, KC-100T, KC-125, KC-125T UL Listed for sheathed cable: E-23237
- KC-100, KC-100T, KC-125, KC-125T UL Listed for SE cable: E-11858
- KC-150 through KC-400 and KC-150T through KC-400T UL Listed for flexible metal conduit: E-11853
- KC-500 and KC-500T: UL and CSA Listing is not applicable
- UL Standard: ANSI/UL 514B
- CSA Standard C22.2 No. 18
- CSA Certified: 009795
- NEMA: FB-1

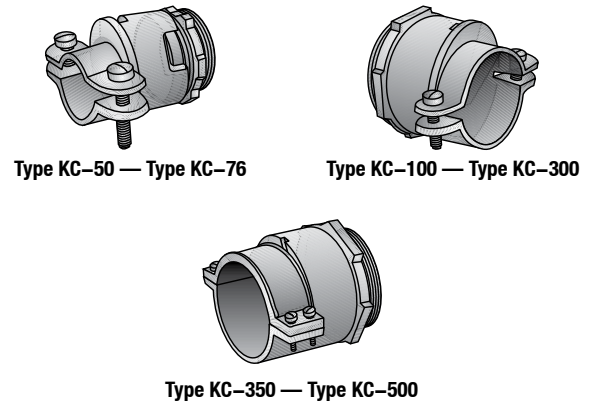

## Illustrated Dimensions

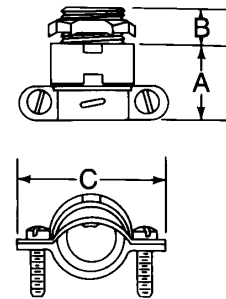

Trade Size (Inches)	Dimensions in Millimeters (Inches)			Flex Opening Millimeters (Inches) Min. – Max.	Catalog Number	Insulated Throat Catalog Number
	A	B	C			
1/2	28.70 (1.13)	11.18 (0.44)	47.75 (1.88)	12.70 - 23.11 (0.50 - 0.91)	KC-50	KC-50T
1/2 (3/4 KO)	28.70 (1.13)	11.18 (0.44)	47.75 (1.88)	12.70 - 23.88 (0.50 - 0.94)	KC-51	—
3/4	30.23 (1.19)	12.70 (0.50)	54.10 (2.13)	22.35 - 27.69 (0.88 - 1.09)	KC-75	KC-75T
3/4 (1 KO)	30.23 (1.19)	12.70 (0.50)	54.10 (2.13)	21.34 - 27.69 (0.84 - 1.09)	KC-76	—
1	31.75 (1.25)	14.22 (0.56)	61.98 (2.44)	26.92 - 35.05 (1.06 - 1.38)	KC-100	KC-75T
1-1/4	33.27 (1.31)	14.22 (0.56)	71.37 (2.81)	32.51 - 41.4 (1.28 - 1.63)	KC-125	KC-125T
1-1/2	45.97 (1.81)	19.05 (0.75)	87.38 (3.44)	35.05 - 50.80 (1.38 - 2.00)	KC-150	KC-150T
2	54.10 (2.13)	22.35 (0.88)	107.95 (4.25)	54.10 - 63.50 (2.13 - 2.50)	KC-200	KC-200T
2-1/2	66.80 (2.63)	22.35 (0.88)	127.00 (5.00)	61.98 - 76.20 (2.44 - 3.00)	KC-250	KC-250T
3	77.72 (3.06)	26.92 (1.06)	139.70 (5.50)	74.68 - 88.90 (2.94 - 3.50)	KC-300	KC-300T
3-1/2	90.42 (3.56)	31.75 (1.25)	165.10 (6.50)	94.49 - 101.60 (3.72 - 4.00)	KC-350	KC-350T
4	93.73 (3.69)	31.75 (1.25)	177.80 (7.00)	103.12 - 112.78 (4.06 - 4.44)	KC-400	KC-400T
5	127.00 (5.00)	38.10 (1.50)	212.85 (8.38)	134.87 - 139.7 (5.31 - 5.50)	KC-500	KC-500T

# Cable Connectors

For Armored Cable and Flexible Metal Conduit

NEC/CEC:  
Listed for Ordinary Locations

## Application

- To ground and secure Armored Cable and Flexible Metal Conduit to boxes and enclosures.

## Feature

- Male hub threads — NPS
- Available with insulated throat.
- Furnished with locknuts.

## Standard Materials

- Malleable iron

## Standard Finishes

- Zinc electroplated

## NEC/CEC Certifications and Compliances

- C-5 through C-8 UL Listed for armored cable: E-11852
- C-8, 24-34 through 24-300 UL Listed for flexible metal conduit: E-11853
- UL Listed flexible metal conduit fittings are suitable for use in Hazardous Location under NEC 501-4(b), Class I, Division 2, and suitable as a grounding means under NEC 350-5.
- CSA Certified for Armored Cable: 009795

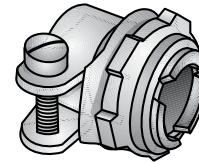

Type C-5  
End Stopped

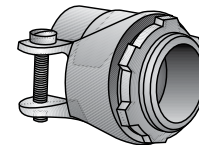

Type C-8 — Type 24-125  
Center Stopped

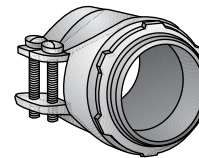

Type 24-150 — Type 24-300  
Center Stopped

Trade Size (Inches)	Dimensions in Millimeters (Inches)				Catalog Number	Insulated Throat Catalog Number
	Body Length	Thread Length	Max. Width	Flex. Opening		
3/8 (1/2 KO)	14.22 (0.56)	11.18 (0.44)	28.70 (1.13)	12.70 - 14.99 (0.50 - 0.59)	C-5	—
1/2	23.88 (0.94)	12.70 (0.50)	39.62 (1.56)	19.81 - 23.88 (0.78 - 0.94)	C-8	C-8T
3/4	28.7 (1.13)	12.70 (0.50)	44.45 (1.75)	23.11 - 27.43 (0.91 - 1.08)	24-34	24-34T
1	30.23 (1.19)	14.22 (0.56)	55.63 (2.19)	32.51 - 36.58 (1.28 - 1.44)	24-100	24-100T
1-1/4	31.75 (1.25)	16.00 (0.63)	63.50 (2.50)	36.58 - 41.4 (1.44 - 1.63)	24-125	24-125T
1-1/2	47.75 (1.88)	17.53 (0.69)	66.80 (2.63)	41.40 - 47.75 (1.63 - 1.88)	24-150	24-150T
2	50.80 (2.00)	19.05 (0.75)	84.07 (3.31)	55.63 - 60.45 (2.19 - 2.38)	24-200	24-200T
2-1/2	52.32 (2.06)	23.88 (0.94)	103.12 (4.06)	68.58 - 74.93 (2.70 - 2.95)	24-250	24-250T
3	57.15 (2.25)	23.88 (0.94)	117.6 (4.63)	79.50 - 88.90 (3.13 - 3.50)	24-300	24-300T

# Cable Connectors

For Armored Cable

NEC/CEC:  
Listed for Ordinary Locations

## Applications

- To ground and secure armored cable to boxes and enclosures.

## Features

- Male hub threads — NPS.
- Cable stop.
- UL Listed for armored cable.
- Furnished with locknuts..

## Standard Materials

- Malleable iron

## Standard Finishes

- Zinc electroplated

## NEC/CEC Certifications and Compliances

- UL Standard: ANSI/UL 514B
- UL Listed: E-11852
- CSA Standard C22.2 No. 18
- CSA Certified: 009795
- NEMA: FB-1

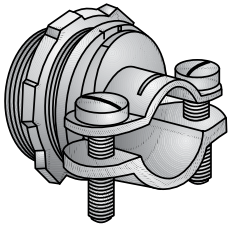

Type C-15L

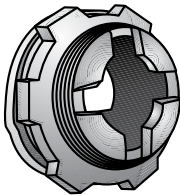

Front View

## Illustrated Dimensions

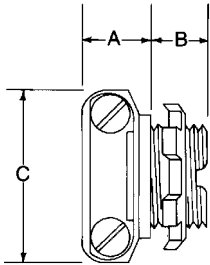

Trade Size (Inches)	Dimensions in Millimeters (Inches)			Cable Opening	Catalog Number
	A	B	C		
3/8 (1/2 KO)	14.22 (0.56)	12.70 (0.50)	35.05 (1.38)	9.65 - 16.00 (0.38 - 0.63)	<b>C-15L</b>

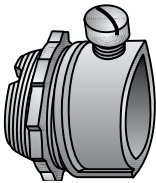

Type C1Z

Trade Size (Inches)	Dimensions in Millimeters (Inches)				Catalog Number
	Body Length	Thread Length	Max. Width	Flex. Opening	
3/8 (1/2 KO)	14.22 (0.56)	10.41 (0.41)	25.40 (1.00)	10.67 - 16.00 (0.42 - 0.63)	<b>C-1Z</b>