



High Output T12

F60T12/CW/HO/ALTO 15PK

Philips T12 fluorescent lamps provide high performance in a wide range of sizes, shapes, and types.

Product data

| General Information | |
|-----------------------|--------------------|
| Cap-Base | R17D [R17d (RDC)] |
| Life 3-Hr Start [Hrs] | 12000 h |
| Features | ALTO® (ALTO) |

| Light Technical | |
|------------------------------------|-----------------|
| Color Code | 33 |
| Initial lumen (Nom) | 4945 lm |
| Color Designation | Cool White (CW) |
| Design Mean Lumens | 4500 lm |
| Correlated Color Temperature (Nom) | 4100 K |
| Color Rendering Index (Nom) | 82 |

| Operating and Electrical | |
|--------------------------|------|
| Power (Rated) (Nom) | 75 W |

| Mechanical and Housing | |
|------------------------|------------|
| Cap-Base Information | Green Base |

| | |
|-----------------------|----|
| Nominal Length (Inch) | 60 |
|-----------------------|----|

| Approval and Application | |
|----------------------------|--------|
| Mercury (Hg) Content (Nom) | 6.8 mg |

| Product Data | |
|---------------------------------|-------------------|
| Order product name | F60T12 CW HO ALTO |
| EAN/UPC - Product | 046677234317 |
| Order code | 234310 |
| Numerator - Quantity Per Pack | 1 |
| Numerator - Packs per outer box | 15 |
| Material Nr. (12NC) | 927891303301 |
| Net Weight (Piece) | 0.001 kg |

Warnings and Safety

- Lamp contains mercury. Manage in Accord with Disposal Laws. See: www.lamprecycle.org or 1-800-555-0050

High Output T12

Dimensional drawing

Product

F60T12 CW HO ALTO

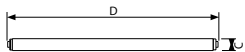

T12 Revised Double Contact

F60T12 75W/33 HO ALTO®

